

ELECTRICAL LOAD REQUIREMENT :-

= 5 KVA

TITLE :-

PROPOSED FACTORY BUILDING FOR M/S.  
"ISHITA ELECTRONICS" PROP. M.M. AGARWAL  
AT PLOT NO. 43, SECTOR -8A', IIE, SIDCUL,  
HARIDWAR, UTTARANCHAL.

SIGN OF THE  
APPLICANT

SIGN OF THE  
ARCHITECT

FOR ISHITA ELECTRONICS

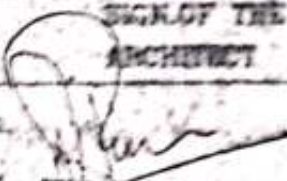
  
AP. VIGRAH SINGH PUNDIA  
B.Arch. MoCA  
CA/2000/25

M.M. AGARWAL

ARCHITECTS & ENGINEERS :-

**SHILANYAS CONSULTANTS**

SHOP NO.3 2ND FLOOR CITY COMPLEX

CHANDRACHARYA CHOWK, HARIDWAR

PH. 01311-277111

= 5 KVA

TITLE :-

PROPOSED FACTORY BUILDING FOR M/S.  
"ISHITA ELECTRONICS" PROP. M.M. AGAR  
AT PLOT NO. 43, SECTOR -8A', IIE, SIDCUL  
HARIDWAR, UTTARANCHAL.

SIGN OF THE  
APPLICANT

SIGN OF THE  
ARCHITECT

M/S. ISHITA ELECTRONICS

AP. VIKAL SINGH P  
B.Arch, MoCA  
CA/2000/20

प्लॉट नं- 6/फाउण्डेशन/07  
खिलाफ- जून 15 2007 के द्वारा  
अनुमोदित।

M.M. AGARWAL

ARCHITECTS & ENGINEERS :-

**SHILANYAS CONSULTANTS**

SHOP NO.3 2ND FLOOR CITY COMPLEX  
CHANDRACHARYA CHOWK HARIDWAR

PH - 01324-377101

शिवशिव शर्मा अधिकारी  
हरिद्वार

## PLANTATION AREA CALCULATIONS :-

PLANTATION AREA REQUIRED AS PER SIDCUL NORMS

= 25 % OF AREA UNDER SETBACKS

= 25 % QF (  $5m \times 20m + 3m \times 20m + 3m \times 50m + 1.5m \times 50m$  )

= 96.25 sq. m.

PROVIDED PLANTATION = 100 SQ. M. > 96.25 SQ. M.

( AS SHOWN IN DRAWING )

## AREA STATEMENT :-

TOTAL PLOT AREA

= 1000 SQ. M. (  $20.0M \times 50.0M$  )

GROUND FLOOR COVERED AREA OF MAIN BUILDING

= 507.0 SQ. M. (  $13.0M \times 39.0M$  )

GAURD ROOM COVERED AREA

= 7.29 SQ. M. (  $2.7M \times 2.7M$  )

TOTAL COVERED AREA ON GROUND

=  $507.0 + 7.29 = 514.29$  SQ. M.

GROUND COVERAGE = 51.4 %

TOTAL COVERED AREA = 514.29 SQ. M.

F.A.R =  $514.29 / 1000 = 0.51$

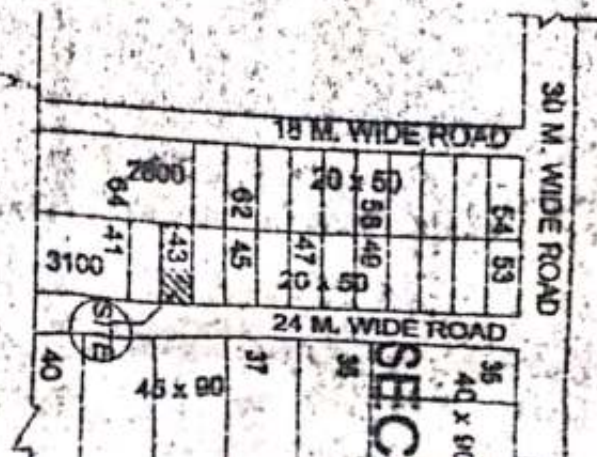

**WATER HARVESTING PIT CAPACITY CALCULATIONS :-**

PIT CAPACITY REQUIRED AS PER SIDCUL NORMS  
= (GROUND FLOOR COVERAGE - 225) / 50 X 5 cum + 20 cum  
= (514.29 - 225) / 50 X 5 cum + 20 cum  
= 48.92 cum

PROVIDED PIT CAPACITY = 50 CU. M > 48.92 CU. M.  
( AS SHOWN IN DRAWING )

**PARKING AREA CALCULATIONS :-**

PARKING AREA REQUIRED AS PER SIDCUL NORMS  
= 514.29 / 80 X 0.50 X 10 sq. m.  
= 57.85 sq. m.

PROVIDED PARKING IN DRAWING :  
= 80 sq. m. > 57.85 sq. m.

**LANDSCAPE AREA CALCULATIONS :-**

LANDSCAPE AREA REQUIRED AS PER SIDCUL NORMS  
= 50 % OF (total plot area - ground floor covd area)  
= 50 % OF ( 1000 - 514.29 ) SQ. M.  
= 242.85 sq. m.

AS PER SIDCUL NORMS FOR EVERY 80 SQ. M.  
LANDSCAPE AREA NO. OF TREE PROVIDED SHALL BE = 1 NO.  
THUS FOR THIS SITE NO. OF TREES SHALL BE  
= 242.85 / 80 = 3.03 TREES OR 4 ( AS SHOWN IN DRAWING )

**ELECTRICAL LOAD REQUIREMENT :-**

**= 5 KVA**

TITLE :-

**PROPOSED FACTORY BUILDING FOR M/S. ...**

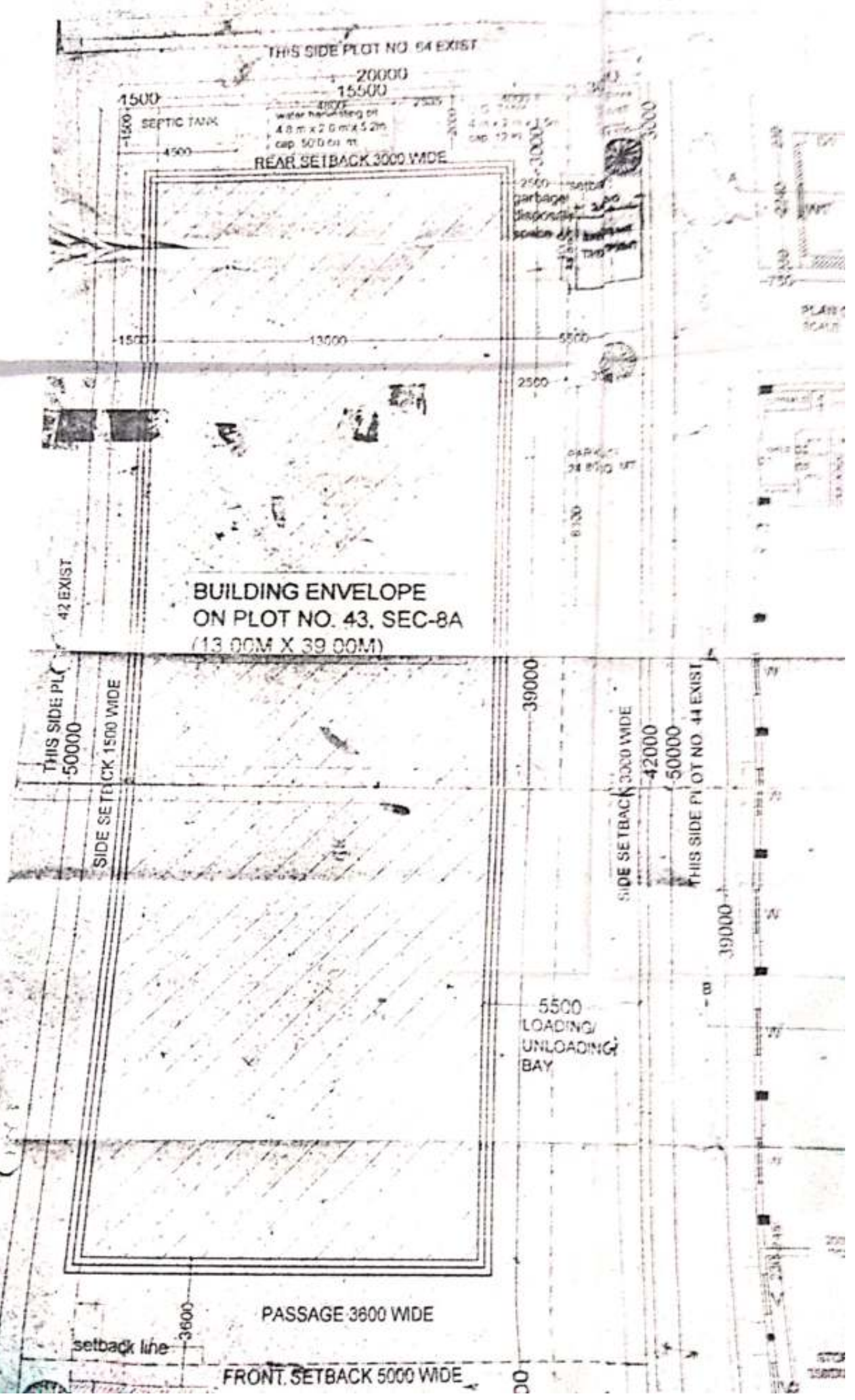

PLAN OF GAURD ROOM  
SCALE 1:50

