

File No.	RKA/DNCR/...../.....
Date of Receiving	Deepak Joshi
File Receiver Name	30/June/20

CASE COLLECTION FORM

(Version 5.0)

Date of implementation: 9.02.2011 | Last Revision: 30.01.2020 | Latest Revision: 31.10.2020

Items	Assigned To	Assigned to Date	To be completed by date	Submitted On date	Grade	HOD Engg. Signature
File Received By	Deepak Joshi	NA	NA			
Survey	Remainder	06/July/21	08/July/21			
Preparation						

A - Very Good, B - Satisfactory, C - Average, D - Poor, E - Extremely Poor

File Returned to HOD Engg. unprepared due to reason	<input type="checkbox"/> Survey not done properly, <input type="checkbox"/> Survey Form not properly filled, <input type="checkbox"/> Market survey for rates is not properly done, <input type="checkbox"/> Identification is not clearly done, <input type="checkbox"/> Measurement is not properly done, <input type="checkbox"/> Photographs not clearly taken, <input type="checkbox"/> Selfie/ Owner or owner representative photo not taken, <input type="checkbox"/> Owner/ owner representative signature not taken, <input type="checkbox"/> Google Map not taken, <input type="checkbox"/> Survey summary sheet not filled
---	---

In case File is returned by the preparer - HOD Engg. comment & Signature	<input type="checkbox"/> Minor defects in the survey hence approved for preparation with warning to Surveyor. Report preparer to collect the missing information on his own. <input type="checkbox"/> Major defects in the survey. Survey has to be done again.
--	--

GENERAL DETAILS

1.	Proposal/ Work Order or Ref. No.			
2.	Type of Service	<input checked="" type="checkbox"/> Valuation Report, <input type="checkbox"/> Construction cost estimate, <input type="checkbox"/> Cost vetting certificate <input type="checkbox"/> Other CE Certificates, <input type="checkbox"/> TEV Report, <input type="checkbox"/> LIE		
3.	Type of customer	<input checked="" type="checkbox"/> Bank <input type="checkbox"/> PSU <input type="checkbox"/> NBFC <input type="checkbox"/> Corporate <input type="checkbox"/> Company <input type="checkbox"/> Private client <input type="checkbox"/> Direct client through Bank		
4.	Bank/ FI/ Organization Name & Address	Bank of Baroda, Buddvihav branch, Moradabad.		
5.	Case Allotment Officer/ Fees paying party Details	Name	Contact Number	Email Id
		Prashant Mainee (HOD)	8477009407	morbud@bankofbaroda.com
6.	Case Type	<input type="checkbox"/> Case for Fresh Account <input checked="" type="checkbox"/> Case for exiting account/ customer		
7.	Fees Details	Amount of Fees	Advance Amount if any	Fees will be paid by
		6000 + GST		<input checked="" type="checkbox"/> Bank <input type="checkbox"/> Customer
8.	Billing Details	Billed To Party Name		GSTIN

CASE DETAILS

1.	Type of Property	Builder floor (Grouns)		
2.	Purpose of Valuation/ Assignment	<input type="checkbox"/> Value assessment of the asset for creating new collateral mortgage <input type="checkbox"/> Periodic Re-Valuation for Bank, <input checked="" type="checkbox"/> Distress sale for NPA A/c., <input type="checkbox"/> For DRT Recovery purpose, <input type="checkbox"/> Capital Gains Wealth Tax purpose <input type="checkbox"/> Partition purpose, <input type="checkbox"/> General Value Assessment <input type="checkbox"/> Any other:		
3.	Owner/ Applicant Details	Name	Contact Number	Email Id
		Niranjana Singh	-	9897404021
4.	Account Name	- - - - -		
5.	Property Address	H-183, Kashi Ram ji, nagar, Marolab.		
6.	Who will coordinate on site for the site survey	Name	Contact Number	
		Niranjana Singh	9897404021	
7.	Preferred time of survey	Date	08/ July/21	Time 01:10:pm
8.	Documents Received (Any one ownership document and approved site plan/ map is must)	1. Ownership Documents: <input checked="" type="checkbox"/> Sale Deed, <input type="checkbox"/> Power of Attorney, <input type="checkbox"/> Registered Will, <input type="checkbox"/> Relinquishment Deed, <input type="checkbox"/> Transfer Deed, <input type="checkbox"/> Conveyance Deed, <input type="checkbox"/> Allotment Letter, <input type="checkbox"/> Possession Letter 2. Map: <input type="checkbox"/> Cizra Map, <input type="checkbox"/> Approved Map, <input type="checkbox"/> Site Plan 3. Utility Bills: <input type="checkbox"/> Electricity Bill & payment receipt, <input type="checkbox"/> Water Bill & payment receipt, <input type="checkbox"/> House Tax demand & payment receipt 4. Any Other document: <input type="checkbox"/> CLU, <input checked="" type="checkbox"/> TIR Report, <input type="checkbox"/> Agreement to Sale, <input checked="" type="checkbox"/> Old Valuation Report 5. No documents provided: <input type="checkbox"/>		
9.	Documents received from	Mr. Prashant		
10.	Special Instructions if any:			
11.	I agree to pay the amount mentioned above for the preparation of Valuation Report. I agree that I'll not put pressure on Valuer firm to distort any facts and would not try to influence any member or official of the firm in the ill spirit or vested interest and to benefit any individual or organization by any means illegitimately. Customer Signature:			

File No. RKA/DNCR/...../.....

FILE RECEIVER CASE COLLECTION PROCESS COMPLIANCE CHECKLIST
(To be filled by Surveyor)

S.NO.	COMPLIANCE CHECKLIST	STATUS	APPROVER SIGNATURE/ REMARKS IN CASE OF ANY (X)
1.	Is Case collection Form properly filled by Receiver?	<input checked="" type="checkbox"/>	
2.	Is purpose of the assignment understood clearly by the receiver?	<input checked="" type="checkbox"/>	
3.	Has receiver checked if this is a new case or existing case of the Bank?	<input checked="" type="checkbox"/>	
4.	Has receiver fixed the fees with the manager/ client and sent quotation properly or have taken approval of the work over email?	<input checked="" type="checkbox"/>	
5.	Has receiver taken proper Work Order/ Email/ CESA form formality?	<input checked="" type="checkbox"/>	
6.	In case of private case or for fresh case 50% advance is received?	<input checked="" type="checkbox"/>	
7.	Is document checklist email sent to the customer?	<input checked="" type="checkbox"/>	
8.	Has the received documents is having 'documents provided by stamp'?	<input checked="" type="checkbox"/>	

IMPORTANT INSTRUCTIONS TO SURVEYOR

1.	Please fill the above compliance checklist before moving for the survey.
2.	Please do not do the survey if you do not have proper documents.
3.	For Vacant Plot/ Land – Cizra Map/ Master/ Zonal/ Site Plan is must to identify the Plot. For Agriculture or converted land from agriculture – Mutation documents, CLU is must.
4.	Firstly please first study the documents of the property which needs to get surveyed.
5.	Mark the Owner/ Area/ Boundaries mentioned in the ownership documents with bold florescent marker pen before moving for the survey. During site survey if any difference is found in the above fields from the ownership documents then please contact the owner immediately to know the reason for the difference.
6.	Confirm ongoing property rates in the subject location through public domain, property sites and contact dealers to show you the available properties in that area during your survey.
7.	Identify the Property clearly by matching the boundaries and area mentioned in the property papers.
8.	Do sample physical or google measurements of the property.
9.	PHOTOGRAPH INSTRUCTIONS: a. Take owner/ representative photograph along with the property. b. Take your selfie along with the property and the owner/ representative. c. Take full scale photo of the property with gate. d. Take photo of the property along with abutting road, towards left, right and center. e. Take multiple photos of inside-out of the property. f. Take nearby photographs of the Property. g. Take a short video to cover property and neighborhood.
10.	Take Google Map location.
11.	Check main road name & width and approach road width and distance of property from main road.
12.	Check Jurisdiction Municipal Limits & Ward Name.
13.	Fill each column of survey form diligently in detail and tick the appropriate option clearly.
14.	Check any defects or negativity in the property and comment in detail on survey form.
15.	Do extensive market rate enquiries and confirm for any recent past transactions.
16.	In case customer appears to be providing misleading information to you or trying to influence you by money or cash then immediately report to the Management & Bank.

SURVEY PROCESS COMPLIANCE CHECKLIST

(To be submitted by Surveyor with each Survey)

S.NO.	COMPLIANCE CHECKLIST POINTS	STATUS
1.	Did you take proper property documents to carry out the survey?	<input checked="" type="checkbox"/>
2.	Have you properly studied & highlighted Owner/ Area/ Boundaries in the property documents with bold florescent before moving for the survey?	<input checked="" type="checkbox"/>
3.	Did you check prominent landmark nearby the subject property and mentioned in the survey form?	<input checked="" type="checkbox"/>
4.	Did you Identified the Property clearly by matching the boundaries and area mentioned in the property papers?	<input checked="" type="checkbox"/>
5.	Did you check if property is merged with any other property or it is an independent property?	<input checked="" type="checkbox"/>
6.	Did you do sample physical or google measurements of the property in case of property more than 2500 sq.mtr?	<input checked="" type="checkbox"/>
7.	Did you check for any building violations in the property?	<input checked="" type="checkbox"/>
8.	Did you check municipal limits/ jurisdiction/ ward?	<input checked="" type="checkbox"/>
9.	Did you take Google Map location and shared it to Maps whatsapp group?	<input checked="" type="checkbox"/>
10.	Did you check Main road name & width and its distance from the subject property?	<input checked="" type="checkbox"/>
11.	Did you check approach Lane width on which property is located?	<input checked="" type="checkbox"/>
12.	Have you taken property full scale photograph with gate?	<input checked="" type="checkbox"/>
13.	Have you taken owner/ representative photograph with the property?	<input checked="" type="checkbox"/>
14.	Have you taken your selfie with the property along with owner/ representative?	<input checked="" type="checkbox"/>
15.	Have you taken photograph of the property along with abutting road and towards left and right of the property?	<input checked="" type="checkbox"/>
16.	Have you taken multiple photographs of the property from inside-out?	<input checked="" type="checkbox"/>
17.	Did you check nearby development and whereabouts and commented on survey form?	<input checked="" type="checkbox"/>
18.	Did you check any defects or negativity in the property in terms of location, legality, disputes, marketability, salability, etc. and commented on survey form in detail?	<input checked="" type="checkbox"/>
19.	Have you filled all the columns of survey form including survey summary sheet properly?	<input checked="" type="checkbox"/>
20.	Did you draw site key plan (location map)?	<input checked="" type="checkbox"/>
21.	Did you draw rough site sketch plan?	<input checked="" type="checkbox"/>
22.	Have you taken self-attested documents from owner/ representative and stamped "documents provided by stamp"?	<input checked="" type="checkbox"/>
23.	Did you check any defects or negativity in the property in terms of location, legality, disputes, marketability, salability, etc. and commented on survey form in detail?	<input checked="" type="checkbox"/>
24.	Have you confirmed any recent past transactions during market enquiries and enquired property rates locally very rigorously?	<input checked="" type="checkbox"/>
25.	Did you take signatures of the owner/ representative on undertaking and survey summary sheet?	<input checked="" type="checkbox"/>
26.	Did you signed the undertaking?	<input checked="" type="checkbox"/>

For File No.	
Surveyor Name	Memant Kumar
Signature	
Date	08/ July/2021

GENERAL SURVEY FORM (FOR PROPERTIES OTHER THAN FLATS)

(Version 5.0)

Date of Implementation: 9.02.2011 | Last Revision: 04.01.2018 | Latest Revision: 31.10.2020

File No. RKA/DNCR/...../.....

Date: 08/July/2021

Time: 01:10 PM

GENERAL DETAILS

1.	Name of the Surveyor	Hemant Kumar	
2.	Property shown by	<input checked="" type="checkbox"/> Owner, <input type="checkbox"/> Representative, <input type="checkbox"/> No one was available, <input type="checkbox"/> Property is locked, survey could not be done from inside	
		Name	Contact No.
		Niraj Singh	9892404021
3.	Survey Type	<input checked="" type="checkbox"/> Full survey (inside-out with measurements & photographs) <input type="checkbox"/> Half Survey (Measurements from outside & photographs) <input type="checkbox"/> Only photographs taken (No measurements)	
4.	Reason for Half survey or only photographs taken	<input type="checkbox"/> Property was locked, <input type="checkbox"/> Possessee didn't allow to inspect the property, <input type="checkbox"/> NPA property so couldn't be surveyed completely	
5.	How Property is Identified	<input type="checkbox"/> From schedule of the properties mentioned in the deed, <input type="checkbox"/> From name plate displayed on the property, <input checked="" type="checkbox"/> Identified by the owner/owner representative, <input checked="" type="checkbox"/> Enquired from nearby people, <input type="checkbox"/> Identification of the property could not be done, <input type="checkbox"/> Survey was not done	
6.	Type of Property	<input type="checkbox"/> Flat in Multistoried Apartment, <input type="checkbox"/> Residential House, <input type="checkbox"/> Low Rise Apartment, <input checked="" type="checkbox"/> Residential Builder Floor, <input type="checkbox"/> Commercial Land & Building, <input type="checkbox"/> Commercial Office, <input type="checkbox"/> Commercial Shop, <input type="checkbox"/> Commercial Floor, <input type="checkbox"/> Shopping Mall, <input type="checkbox"/> Hotel, <input type="checkbox"/> Industrial, <input type="checkbox"/> Institutional, <input type="checkbox"/> School Building, <input type="checkbox"/> Vacant Residential Plot, <input type="checkbox"/> Vacant Industrial Plot, <input type="checkbox"/> Agricultural Land	
7.	Property Measurement	<input checked="" type="checkbox"/> Self-measured, <input type="checkbox"/> Sample measurement only, <input type="checkbox"/> No measurement	
8.	Reason for no measurement	<input type="checkbox"/> It's a flat in multi storey building so measurement not required <input type="checkbox"/> Property was locked, <input type="checkbox"/> Owner/ possessee didn't allow it, <input type="checkbox"/> NPA property so didn't enter the property, <input type="checkbox"/> Very Large Property, practically not possible to measure the entire area <input type="checkbox"/> Any other Reason:	
9.	Purpose of Valuation	<input type="checkbox"/> Value assessment of the asset for creating new collateral mortgage <input type="checkbox"/> Periodic Re-Valuation for Bank, <input checked="" type="checkbox"/> Distress sale for NPA A/c., <input type="checkbox"/> For DRT Recovery purpose, <input type="checkbox"/> Capital Gains Wealth Tax purpose <input type="checkbox"/> Partition purpose, <input type="checkbox"/> General Value Assessment	
10.	Type of Loan	<input checked="" type="checkbox"/> Housing Loan, <input type="checkbox"/> Housing Take Over Loan, <input type="checkbox"/> Home Improvement Loan, <input type="checkbox"/> Loan against Property, <input type="checkbox"/> Construction Loan, <input type="checkbox"/> Educational Loan, <input type="checkbox"/> Car Loan, <input type="checkbox"/> Project Loan, <input type="checkbox"/> Term Loan, <input type="checkbox"/> CC Limit enhancement, <input type="checkbox"/> Cash Credit Limit, <input type="checkbox"/> Industrial Loan, <input type="checkbox"/> NA	
11.	Loan Amount		

OWNERSHIP DETAILS

1.	Legal Owner Name/s	Mrunal Singh			
2.	Property Purchaser Name	Mrunal Singh			
3.	Property Address under Valuation	H-183, Road No. 1, Sector 1, Mayapuri			
4.	Present Residence Address of the Owner/ Purchaser	— Govt			
5.	Property constitution	<input checked="" type="checkbox"/> Free Hold, <input type="checkbox"/> Lease Hold			

LOCATION DETAILS

LOCATION DETAILS							
1.	Adjoining Properties (Match it with papers with the help of compass or Sun direction and also confirm it with nearby people)	East	West	North	South		
2.	Property Facing	North Plot.	Proposed H-182	Proposed Plot	Proposed		
3.	Landmark	Shankar diya road					
4.	Ward Name/ No.						
5.	Zone Name	Munesh					
6.	Main Road Name & Width	Name	Width	Distance from property			
7.	Approach Road Name & Width	Delhi road	20 ft				
8.	Location consideration of the Society	<input type="checkbox"/> Within Main city, <input type="checkbox"/> Within Good Urban developed Area, <input type="checkbox"/> Within developing area, <input type="checkbox"/> Highly posh locality, <input type="checkbox"/> Very Good, <input type="checkbox"/> Good, <input type="checkbox"/> Ordinary, <input type="checkbox"/> In interiors, <input type="checkbox"/> Remote area, <input type="checkbox"/> Backward, <input type="checkbox"/> Average, <input type="checkbox"/> Poor					
9.	Special Location consideration of the property	<input type="checkbox"/> Park Facing, <input type="checkbox"/> Pool Facing, <input checked="" type="checkbox"/> Road Facing, <input type="checkbox"/> Entrance North-East Facing, <input type="checkbox"/> Sunlight facing					
10.	Characteristics of the locality	<input type="checkbox"/> Urban developed, <input checked="" type="checkbox"/> Urban developing, <input type="checkbox"/> Semi Urban, <input type="checkbox"/> Rural, <input type="checkbox"/> Backward, <input type="checkbox"/> Industrial, <input type="checkbox"/> Institutional					
11.	Category of Society/ locality	<input type="checkbox"/> High End, <input checked="" type="checkbox"/> Normal, <input type="checkbox"/> Affordable Group Housing, <input type="checkbox"/> EWS, <input type="checkbox"/> MIG, <input type="checkbox"/> MIG, <input type="checkbox"/> LIG					
12.	Utilities/ Facilities in the locality	<input type="checkbox"/> Lifts, <input type="checkbox"/> Garden, <input type="checkbox"/> Landscaping, <input type="checkbox"/> Swimming Pool, <input type="checkbox"/> Gym, <input type="checkbox"/> Club House, <input type="checkbox"/> Walk Trails, <input type="checkbox"/> Kids play zone, <input type="checkbox"/> 100% Power Backup					
13.	Proximity to civic amenities	School	Hospital	Market	Metro	Railway Station	Airport
14.	Any new development in surrounding area	300m	500m	300m	300m	300m	—
		250m NE of it					

15.	Jurisdiction limits	<input checked="" type="checkbox"/> Nagar Nigam, <input type="checkbox"/> Nagar Panchayat, <input type="checkbox"/> Gram Panchayat, <input type="checkbox"/> Naga <input type="checkbox"/> Palika Parishad, <input type="checkbox"/> Area not within any municipal limits
16.	Jurisdiction Development Authority Name	<input type="checkbox"/> DDA, <input type="checkbox"/> GDA, <input type="checkbox"/> NOIDA, <input type="checkbox"/> GNIDA, <input type="checkbox"/> YEIDA, <input type="checkbox"/> HUDA, <input type="checkbox"/> KMDA, <input type="checkbox"/> MDDA, <input type="checkbox"/> Any other Development Authority: <u>BANDS</u> <input type="checkbox"/> Area not within any development authority limits
17.	Municipal Corporation Name	<input type="checkbox"/> NDMC, <input type="checkbox"/> SDMC, <input type="checkbox"/> EDMC, <input type="checkbox"/> Ghaziabad Municipal Corporation, <input type="checkbox"/> Gurgaon Municipal Corporation, <input type="checkbox"/> Faridabad Municipal Corporation, <input type="checkbox"/> Kolkata Municipal Corporation, <input type="checkbox"/> Dehradun Municipal Corporation, <input type="checkbox"/> Area not within any municipal limits, <input type="checkbox"/> Any other Municipal Corporation/ Municipality: <u>MDA</u>

PHYSICAL DETAILS			
	As per Title deed	As per Map	As per site survey
1.	Land Area		
2.	Any conversion to the land use	NO	
3.	Land Type	<input checked="" type="checkbox"/> Solid, <input type="checkbox"/> Rocky, <input type="checkbox"/> Marsh Land, <input type="checkbox"/> Reclaimed Land, <input type="checkbox"/> Water logged, <input type="checkbox"/> Land locked	
4.	Shape of the Land	<input type="checkbox"/> Square, <input type="checkbox"/> Rectangular, <input type="checkbox"/> Trapezium, <input type="checkbox"/> Triangular, <input type="checkbox"/> Trapezoid, <input type="checkbox"/> Irregular, <input type="checkbox"/> NA	
5.	Level of Land	<input checked="" type="checkbox"/> On road level, <input type="checkbox"/> Below road level, <input type="checkbox"/> Above road level, <input type="checkbox"/> NA	
6.	Frontage to depth ratio	<input checked="" type="checkbox"/> Normal frontage, <input type="checkbox"/> Less frontage, <input type="checkbox"/> Large frontage, <input type="checkbox"/> NA	
7.	Are Boundaries matched	<input checked="" type="checkbox"/> Yes, <input type="checkbox"/> No, <input type="checkbox"/> No relevant papers available to match the boundaries, <input type="checkbox"/> Boundaries not mentioned in available documents	
8.	Is Independent access available to the property	<input checked="" type="checkbox"/> Clear independent access is available, <input type="checkbox"/> Access available in sharing of other adjoining property, <input type="checkbox"/> No clear access is available, <input type="checkbox"/> Access is closed due to dispute	
9.	Is property clearly demarcated with permanent boundaries?	<input checked="" type="checkbox"/> Yes, <input type="checkbox"/> No, <input type="checkbox"/> Only with Temporary boundaries	
10.	Is the property merged or colluded with any other property	NO	
11.	Property possessed by at the time of survey	<input checked="" type="checkbox"/> Owner, <input type="checkbox"/> Vacant, <input type="checkbox"/> Lessee, <input type="checkbox"/> Under Construction, <input type="checkbox"/> Couldn't be Surveyed, <input type="checkbox"/> Property was locked, <input type="checkbox"/> Bank sealed, <input type="checkbox"/> Court sealed	
12.	Current activity carried out in the property	<input checked="" type="checkbox"/> Residential purpose, <input type="checkbox"/> Commercial purpose, <input type="checkbox"/> Godown, <input type="checkbox"/> Office, <input type="checkbox"/> Industrial, <input type="checkbox"/> Vacant, <input type="checkbox"/> Locked, <input type="checkbox"/> Any other use:	

BUILDING/ CONSTRUCTION/ UTILITY DETAILS	
1.	Construction Status
	<input checked="" type="checkbox"/> Built-up property in use, <input type="checkbox"/> Under construction, <input type="checkbox"/> No construction

2.	Covered Built-up Area (Tick one on the basis of which valuation is to be calculated)	<input type="checkbox"/> Covered Area, <input type="checkbox"/> Floor Area, <input type="checkbox"/> Super Area, <input type="checkbox"/> Carpet Area		
		As per Title deed	As per Map	As per site survey
		5888m	—	(16x31) ft
3.	Total Number of Floors in the Building	9 + 1st		
4.	Floor on which property is situated	9th floor		
5.	Type of Unit/ Number of Rooms/ Cabins/ Cubicles	3 rooms + 2 balconies + 2 kitchen		
6.	Building Type	<input checked="" type="checkbox"/> RCC Framed Structure, <input type="checkbox"/> Load bearing Pillar Beam column, <input type="checkbox"/> Ordinary brick wall structure, <input type="checkbox"/> Iron trusses & Pillars, <input type="checkbox"/> Scrap abandoned structure		
7.	Roof	a. Make: <input type="checkbox"/> RBC, <input checked="" type="checkbox"/> RCC, <input type="checkbox"/> GI Shed, <input type="checkbox"/> Tin Shed, <input type="checkbox"/> Stone Patla		
		b. Height: 10 ft		
		c. Finish: <input type="checkbox"/> Simple plaster, <input checked="" type="checkbox"/> POP Punning, <input type="checkbox"/> POP False Ceiling, <input type="checkbox"/> Coved roof, <input type="checkbox"/> No plaster		
8.	Flooring	<input checked="" type="checkbox"/> Vitrified tiles, <input type="checkbox"/> Ceramic Tiles, <input type="checkbox"/> Simple marble, <input type="checkbox"/> Marble chips, <input type="checkbox"/> Mosaic, <input type="checkbox"/> Granite, <input type="checkbox"/> Italian Marble, <input type="checkbox"/> Kota stone, <input type="checkbox"/> Wooden, <input type="checkbox"/> PCC, <input type="checkbox"/> Imported Marble, <input type="checkbox"/> Pavers, <input type="checkbox"/> Chequered Tiles, <input type="checkbox"/> Brick Tiles, <input type="checkbox"/> No Flooring, <input type="checkbox"/> Under construction, <input type="checkbox"/> Any other type:		
9.	Appearance/ Condition of the Building	Internal - <input type="checkbox"/> Excellent, <input type="checkbox"/> Very Good, <input checked="" type="checkbox"/> Good, <input type="checkbox"/> Ordinary, <input type="checkbox"/> Average, <input type="checkbox"/> Poor <input type="checkbox"/> Under construction, <input type="checkbox"/> No Survey		
		External - <input type="checkbox"/> Excellent, <input type="checkbox"/> Very Good, <input type="checkbox"/> Good, <input type="checkbox"/> Ordinary, <input type="checkbox"/> Average, <input type="checkbox"/> Poor <input type="checkbox"/> Under construction		
10.	Maintenance of the Building	<input type="checkbox"/> Very Good, <input checked="" type="checkbox"/> Average, <input type="checkbox"/> Poor, <input type="checkbox"/> Under construction		
11.	Interior decoration	<input type="checkbox"/> Excellent, <input type="checkbox"/> Very Good, <input checked="" type="checkbox"/> Good, <input type="checkbox"/> Simple, <input type="checkbox"/> Ordinary, <input type="checkbox"/> Average, <input type="checkbox"/> Below average, <input type="checkbox"/> Under construction, <input type="checkbox"/> No Survey		
12.	Interior Finishing	<input type="checkbox"/> Simple plastered walls, <input type="checkbox"/> Brick walls without plaster, <input type="checkbox"/> Designer textured walls, <input checked="" type="checkbox"/> POP punning, <input type="checkbox"/> Coved roof, <input type="checkbox"/> Under construction, <input type="checkbox"/> No Survey		
13.	Exterior Finishing	<input checked="" type="checkbox"/> Simple plastered walls, <input type="checkbox"/> Brick walls without plaster, <input type="checkbox"/> Architecturally designed or elevated, <input type="checkbox"/> Brick tile Cladding, <input type="checkbox"/> Structural glazing, <input type="checkbox"/> Aluminum composite panel cladding, <input type="checkbox"/> Glass façade, <input type="checkbox"/> Domb, <input type="checkbox"/> Porch, <input type="checkbox"/> Under construction		
14.	Kitchen	<input type="checkbox"/> Simple with no cupboard, <input checked="" type="checkbox"/> Ordinary with cupboard, <input type="checkbox"/> Normal Modular with chimney, <input type="checkbox"/> High end Modular with chimney, <input type="checkbox"/> Under construction, <input type="checkbox"/> No Survey		
15.	Class of Electrical fittings	<input type="checkbox"/> External, <input checked="" type="checkbox"/> Internal		
		<input checked="" type="checkbox"/> Ordinary fixtures & fittings, <input type="checkbox"/> Fancy lights, <input type="checkbox"/> Chandeliers, <input type="checkbox"/> Concealed lightning, <input type="checkbox"/> Under construction, <input type="checkbox"/> No Survey		
16.	Class of Sanitary/ Plumbing & water supply fittings	<input type="checkbox"/> External, <input checked="" type="checkbox"/> Internal		
		<input type="checkbox"/> Excellent, <input type="checkbox"/> Very Good, <input checked="" type="checkbox"/> Good, <input type="checkbox"/> Simple, <input type="checkbox"/> Average, <input type="checkbox"/> Below average, <input type="checkbox"/> Under construction, <input type="checkbox"/> No Survey		
17.	Water arrangements	<input type="checkbox"/> Jet pump, <input type="checkbox"/> Submersible, <input checked="" type="checkbox"/> Jal board supply		
18.	Fixed Wooden Work	<input type="checkbox"/> Excellent, <input type="checkbox"/> Very Good, <input type="checkbox"/> Good, <input checked="" type="checkbox"/> Simple, <input type="checkbox"/> Ordinary, <input type="checkbox"/> Average, <input type="checkbox"/> Below Average, <input type="checkbox"/> No wooden work, <input type="checkbox"/> No survey		
19.	Age of Building/ Recent Improvements done	6 years		
20.	Maintenance of the Building	<input type="checkbox"/> Very Good, <input checked="" type="checkbox"/> Average, <input type="checkbox"/> Poor		

21.	Any defects in the building	<input type="checkbox"/> Maintenance issues, <input type="checkbox"/> Finishing issues, <input type="checkbox"/> Seepage issues, <input type="checkbox"/> Water supply issues, <input type="checkbox"/> Electricity issues, <input type="checkbox"/> Structural issues, <input type="checkbox"/> Visible cracks in the building			
22.	Any violation done in the property	<input type="checkbox"/> Construction done without Map, <input type="checkbox"/> Construction not as per approved Map, <input type="checkbox"/> Extra covered without sanctioned Map, <input type="checkbox"/> Joined adjacent property, <input type="checkbox"/> Encroached adjacent area illegally			
23.	Boundary Wall (Only for individual property)	<input checked="" type="checkbox"/> Yes, <input type="checkbox"/> No, <input type="checkbox"/> Common boundary wall of a complex			
		Running Mtr.	Height	Width	Finish
		N/S	N/S	N/S	
24.	Lift/ elevators	<input type="checkbox"/> Passenger/ <input type="checkbox"/> Commercial Make: Capacity:			
25.	Power backup	<input checked="" type="checkbox"/> Inverter, <input type="checkbox"/> DG Set Make: Capacity:			
26.	Garden/ Landscaping	<input type="checkbox"/> Yes, <input type="checkbox"/> No, <input type="checkbox"/> Beautiful, <input type="checkbox"/> Ordinary			
27.	Parking facilities	<input type="checkbox"/> Available within the property <input type="checkbox"/> On Ground, <input type="checkbox"/> In Basement, <input type="checkbox"/> On stilt <input type="checkbox"/> Not available within the property <input type="checkbox"/> On road, <input type="checkbox"/> Acute parking problem			
28.	Special Comments/ Observations, if any	No comments			

MARKETABILITY/ SELABILITY/ UTILITY DETAILS	
1.	Any issues in marketability of the property?
	<input type="checkbox"/> Yes, <input type="checkbox"/> No Reason in case of No: <input type="checkbox"/> Location, <input type="checkbox"/> Surrounding, <input type="checkbox"/> Legal aspects, <input type="checkbox"/> Demand, <input type="checkbox"/> Shape, <input type="checkbox"/> Any Other:
2.	How is Demand & Supply condition in the Market of such properties?
	Demand <input type="checkbox"/> Very Good, <input type="checkbox"/> Good, <input type="checkbox"/> Average, <input type="checkbox"/> Low, <input type="checkbox"/> Poor Supply <input type="checkbox"/> Very Good, <input type="checkbox"/> Good, <input type="checkbox"/> Average, <input type="checkbox"/> Low, <input type="checkbox"/> Poor
3.	Is property easily sellable & marketable?
	<input checked="" type="checkbox"/> Yes, <input type="checkbox"/> No Comments: Property is located in MDA colony.
4.	How is the current utility of the property?
	<input type="checkbox"/> Excellent, <input type="checkbox"/> Very Good, <input checked="" type="checkbox"/> Good, <input type="checkbox"/> Average, <input type="checkbox"/> Low, <input type="checkbox"/> Poor
5.	At what True rate Owner bought this Property?
	Year of purchase: 2016 Purchase Price: 15 Lakh
6.	Present expected Sale Value of the overall property?
	18 - 20 Lakh for floor

$$\begin{array}{l} \text{Covered area of floor} \\ \Rightarrow 16' \times 31' = \boxed{496 \text{ ft}^2} \end{array}$$

$$\text{height of floor} = \underline{11 \text{ ft.}}$$

21.	Any defects in the building	<input type="checkbox"/> Maintenance issues, <input checked="" type="checkbox"/> Finishing issues, <input type="checkbox"/> Seepage issues, <input type="checkbox"/> Water supply issues, <input type="checkbox"/> Electricity issues, <input type="checkbox"/> Structural issues, <input type="checkbox"/> Visible cracks in the building											
22.	Any violation done in the property	<input type="checkbox"/> Construction done without Map, <input type="checkbox"/> Construction not as per approved Map, <input type="checkbox"/> Extra covered without sanctioned Map, <input type="checkbox"/> Joined adjacent property, <input type="checkbox"/> Encroached adjacent area illegally											
23.	Boundary Wall (Only for individual property)	<input checked="" type="checkbox"/> Yes, <input type="checkbox"/> No, <input type="checkbox"/> Common boundary wall of a complex <table border="1"> <thead> <tr> <th>Running Mtr.</th> <th>Height</th> <th>Width</th> <th>Finish</th> </tr> </thead> <tbody> <tr> <td>N/A</td> <td>N/A</td> <td>N/A</td> <td></td> </tr> </tbody> </table>				Running Mtr.	Height	Width	Finish	N/A	N/A	N/A	
Running Mtr.	Height	Width	Finish										
N/A	N/A	N/A											
24.	Lift/ elevators	<input type="checkbox"/> Passenger/ <input type="checkbox"/> Commercial Make: Capacity:											
25.	Power backup	<input checked="" type="checkbox"/> Inverter, <input type="checkbox"/> DG Set Make: 1 Capacity: 1 kw											
26.	Garden/ Landscaping	<input type="checkbox"/> Yes, <input type="checkbox"/> No, <input type="checkbox"/> Beautiful, <input type="checkbox"/> Ordinary											
27.	Parking facilities	<input type="checkbox"/> Available within the property <input type="checkbox"/> On Ground, <input type="checkbox"/> In Basement, <input type="checkbox"/> On stilt <input checked="" type="checkbox"/> Not available within the property <input checked="" type="checkbox"/> On road, <input type="checkbox"/> Acute parking problem											
28.	Special Comments/ Observations, if any	No comments											

MARKETABILITY/ SELABILITY/ UTILITY DETAILS						
1.	Any issues in marketability of the property?	<input type="checkbox"/> Yes, <input checked="" type="checkbox"/> No Reason in case of No: <input type="checkbox"/> Location, <input checked="" type="checkbox"/> Surrounding, <input type="checkbox"/> Legal aspects, <input type="checkbox"/> Demand, <input type="checkbox"/> Shape, <input type="checkbox"/> Any Other:				
2.	How is Demand & Supply condition in the Market of such properties?	<table border="1"> <tr> <td>Demand</td> <td><input type="checkbox"/> Very Good, <input checked="" type="checkbox"/> Good, <input type="checkbox"/> Average, <input type="checkbox"/> Low, <input type="checkbox"/> Poor</td> </tr> <tr> <td>Supply</td> <td><input type="checkbox"/> Very Good, <input checked="" type="checkbox"/> Good, <input type="checkbox"/> Average, <input type="checkbox"/> Low, <input type="checkbox"/> Poor</td> </tr> </table>	Demand	<input type="checkbox"/> Very Good, <input checked="" type="checkbox"/> Good, <input type="checkbox"/> Average, <input type="checkbox"/> Low, <input type="checkbox"/> Poor	Supply	<input type="checkbox"/> Very Good, <input checked="" type="checkbox"/> Good, <input type="checkbox"/> Average, <input type="checkbox"/> Low, <input type="checkbox"/> Poor
Demand	<input type="checkbox"/> Very Good, <input checked="" type="checkbox"/> Good, <input type="checkbox"/> Average, <input type="checkbox"/> Low, <input type="checkbox"/> Poor					
Supply	<input type="checkbox"/> Very Good, <input checked="" type="checkbox"/> Good, <input type="checkbox"/> Average, <input type="checkbox"/> Low, <input type="checkbox"/> Poor					
3.	Is property easily sellable & marketable?	<input checked="" type="checkbox"/> Yes, <input type="checkbox"/> No Comments: Property is located in MDA colony.				
4.	How is the current utility of the property?	<input type="checkbox"/> Excellent, <input type="checkbox"/> Very Good, <input checked="" type="checkbox"/> Good, <input type="checkbox"/> Average, <input type="checkbox"/> Low, <input type="checkbox"/> Poor				
5.	At what True rate Owner bought this Property?	<table border="1"> <tr> <td>Year of purchase</td> <td>2016</td> </tr> <tr> <td>Purchase Price</td> <td>15 lakh</td> </tr> </table>	Year of purchase	2016	Purchase Price	15 lakh
Year of purchase	2016					
Purchase Price	15 lakh					
6.	Present expected Sale Value of the overall property?	18-20 lakh for floor				

covered area of floor

$$\Rightarrow 16' \times 31' = \boxed{496 \text{ ft}^2}$$

$$\text{height of floor} = \underline{11 \text{ ft}}$$

DRAW SITE KEY PLAN & SKETCH PLAN

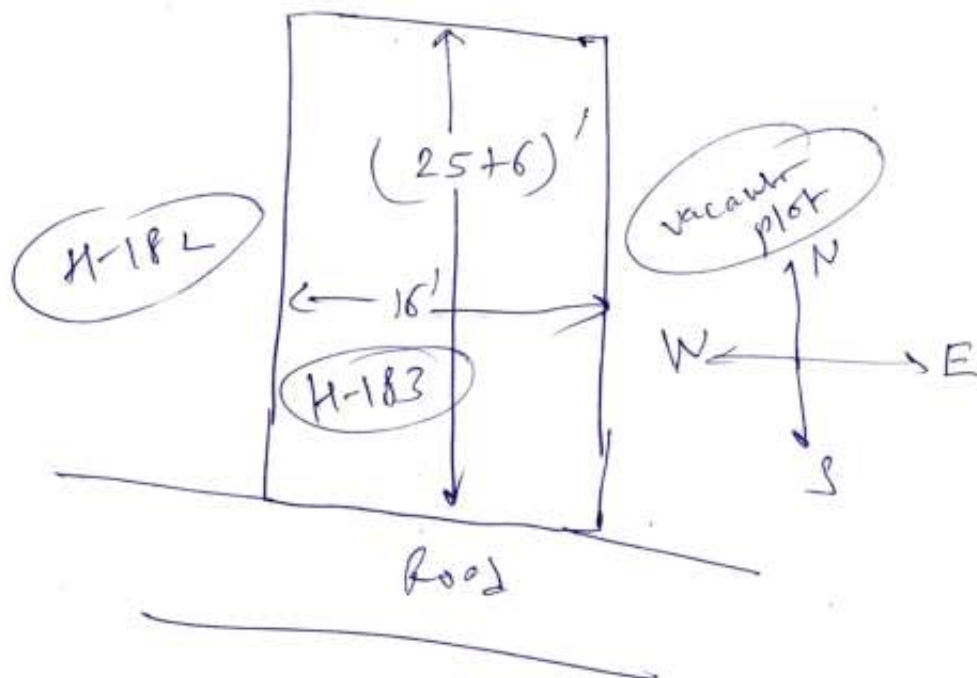
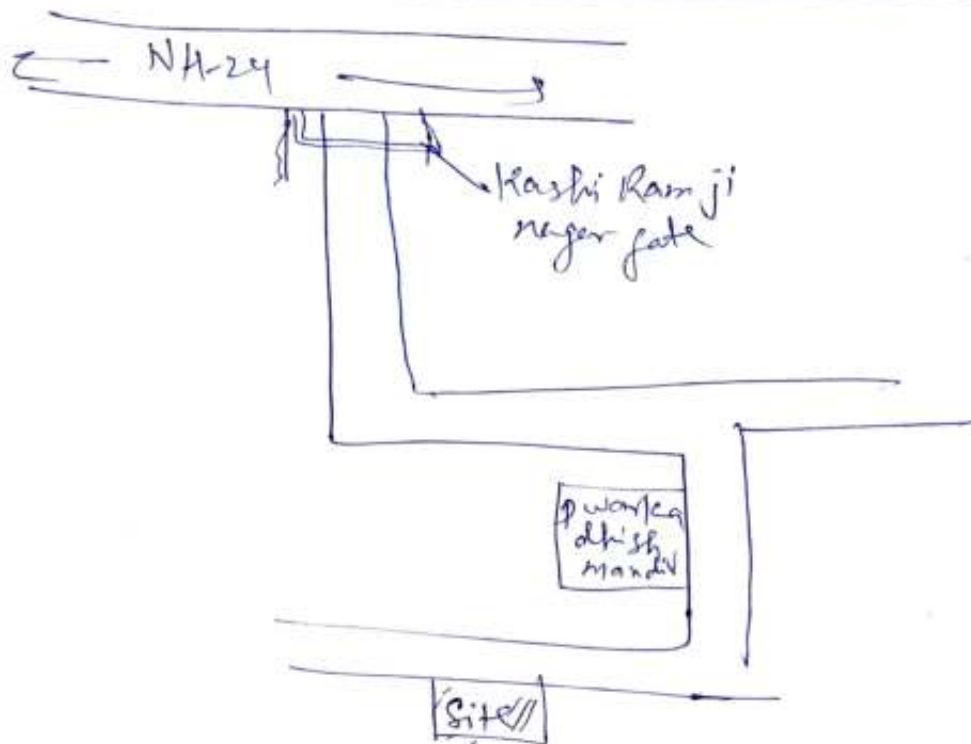

PROPERTY MARKET COMPARABLE RATE INFORMATION DETAILS (Available for Sale or Transaction already happened in past)

S.No	Particulars	Subject Property	Comparable 1	Comparable 2	Comparable 3
1.	Name (source of information)	NA			
2.	Contact No.	NA	Amarnath	properties	
3.	Type of source of information (Seller/ Property dealer/ nearby people)	NA	98377	22958	
4.	Rates/ Price informed (in Rs. with unit)	NA	Property dealer		
5.	Rates Type (Sale/ Buy)	NA		2800-3000/ft ²	
6.	Shape of the Property (Square, Rectangular, Irregular)		Buy		
7.	Area/ Size of the Property		Rectangular		
8.	Legal Status (clear, negative, weak)/ No. of owners		70 yds ²		
9.	Location/ surrounding/ neighborhood comparison with the subject property (Similar, Lower, Better, Highly Better than the subject Property)	Base Case	Clear		
10.	Distance from the subject Property	0	Similar		
11.	Other factors (Corner, 2 side open, North-East facing, Park facing, Legal/ Financial encumbrance, etc.)		100 m		
12.	Approach road width		Road facing		
13.	Level of Land (Below/ On/ Above road level)		25 ft		
14.	Frontage to depth ratio (Normal, Less, Large)		on road		
15.	Present Use		Normal		
16.	Any other details/ Discussion held	NA	Residential		
17.	Present expected Sale Value of the overall property?		No		
			18-20 lacs		

UNDERTAKING BY THE CUSTOMER

I confirm that I have made the inspection of the subject property to the surveyor of R.K Associates, which is correct property in question for which the documents have been provided/ submitted by me. I further confirm that I am aware of all the information related to the subject property and I have provided all its information to the surveyor true to the best of my knowledge. I understand that any false or manipulative information provided by me will be considered as cheating with the professional organization since it will lead to incorrect valuation report and I'd be solely responsible for this unlawful act and will bear the charges for the changes/modifications which have to undergo due to the false information. I also undertake that I have not given any cash or in kind to any member of R.K Associates to influence the Value of the Property or favor any individual or organization and the same is not accepted or asked by the member of R.K Associates. Any such act will lead to cancellation of the material prepared by R.K Associates with forfeiting of the fees and i'll be completely responsible for its repercussions and legal actions taken for it.

IMPORTANT: We have not authorized any of our person/ Surveyor to take Cash or kind from the customers in any situation. In case Surveyor or any member of R.K Associates asks for any money or kind from you then kindly please inform on number +91-9958632707, 0120-4110117. Our Valuation process is very stringent and have multiple check points to ensure correct & error free reports to keep the lending agency risk free. In case Surveyor claims that he would be able to arbitrary effect the Valuation figures unfairly or as per your requirement & need, then he is making a false claim to you and we request you to complaint such act immediately on the number provided above.

Name	Nirajan Singh
Relationship with owner	Self
Signature	Nirajan Singh
Mobile No.	9897404021
Date	08/ July/ 2021

UNDERTAKING BY THE SURVEYOR

I confirm that I have carried out the Survey of the property properly as per the fair professional best practices and Valuation & Survey policy guidelines issued by R.K Associates. I have not taken any cash or kind from the customer nor have I come into any kind of influence of the customer / bank for arbitrary providing the Property Valuation as per one's need. I further state that I have not given any assurances to the customer nor given any wrong or false information or statement. In case at any point of time it is found that I have done any kind of fraudulent activity in this case and misled the company then I understand its legal consequences and appropriate penal action which company can take against me. Also in regard to it any monetary or reputation loss will be recovered from me by the company.

For File No.	
Surveyor Name	Hement Kumar
Signature	Hement Kumar
Date	08/ July/ 2021

SURVEY SUMMARY SHEET

(TO BE ENCLOSED WITH VALUATION REPORT)

(Version 1.0) | Date of implementation: 10.04.2017

Every Valuation report at R.K Associates is prepared based on the thorough survey of the property carried out by our Engineering Surveyor. This Survey Summary Sheet is for the information of Banker/ concerned interested organization. Detailed Survey Form can also be made available to the interested organization in case it is required to cross check what information our surveyor has given in site inspection report based on which Valuation report is prepared.

1.	File No.			
2.	Name of the Surveyor	Hemant Kumar		
3.	Borrower Name	Nirajan Singh		
4.	Name of the Owner	Same		
5.	Property Address which has to be valued	H-183, Kashi Ramji Nagar - Muradabad		
6.	Property shown & identified by at spot	<input checked="" type="checkbox"/> Owner, <input type="checkbox"/> Representative, <input type="checkbox"/> No one was available, <input type="checkbox"/> Property is locked, survey could not be done from inside <div style="display: flex; justify-content: space-between;"> <div>Name Nirajan Singh</div> <div>Contact No. 9892404021</div> </div>		
7.	How Property is Identified by the Surveyor	<input type="checkbox"/> From schedule of the properties mentioned in the deed, <input type="checkbox"/> From name plate displayed on the property, <input checked="" type="checkbox"/> Identified by the owner/ owner representative, <input type="checkbox"/> Enquired from nearby people, <input type="checkbox"/> Identification of the property could not be done, <input type="checkbox"/> Survey was not done		
8.	Are Boundaries matched	<input checked="" type="checkbox"/> Yes, <input type="checkbox"/> No, <input type="checkbox"/> No relevant papers available to match the boundaries, <input type="checkbox"/> Boundaries not mentioned in available documents		
9.	Survey Type	<input checked="" type="checkbox"/> Full survey (inside-out with measurements & photographs) <input type="checkbox"/> Half Survey (Measurements from outside & photographs) <input type="checkbox"/> Only photographs taken (No measurements)		
10.	Reason for Half survey or only photographs taken	<input type="checkbox"/> Property was locked, <input type="checkbox"/> Possessee didn't allow to inspect the property, <input type="checkbox"/> NPA property so couldn't be surveyed completely		
11.	Type of Property	<input type="checkbox"/> Flat in Multistoried Apartment, <input type="checkbox"/> Residential House, <input checked="" type="checkbox"/> Low Rise Apartment, <input type="checkbox"/> Residential Builder Floor, <input type="checkbox"/> Commercial Land & Building, <input type="checkbox"/> Commercial Office, <input type="checkbox"/> Commercial Shop, <input type="checkbox"/> Commercial Floor, <input type="checkbox"/> Shopping Mall, <input type="checkbox"/> Hotel, <input type="checkbox"/> Industrial, <input type="checkbox"/> Institutional, <input type="checkbox"/> School Building, <input type="checkbox"/> Vacant Residential Plot, <input type="checkbox"/> Vacant Industrial Plot, <input type="checkbox"/> Agricultural Land		
12.	Property Measurement	<input checked="" type="checkbox"/> Self-measured, <input type="checkbox"/> Sample measurement, <input type="checkbox"/> No measurement		
13.	Reason for no measurement	<input type="checkbox"/> It's a flat in multi storey building so measurement not required <input type="checkbox"/> Property was locked, <input type="checkbox"/> Owner/ possessee didn't allow it, <input type="checkbox"/> NPA property so didn't enter the property, <input type="checkbox"/> Very Large Property, practically not possible to measure the area within limited time <input type="checkbox"/> Any other Reason:		
14.	Land Area of the Property	As per Title deed	As per Map	As per site survey
15.	Covered Built-up Area	As per Title deed	As per Map	As per site survey
16.	Property possessed by at the time of survey	<input checked="" type="checkbox"/> Owner, <input type="checkbox"/> Vacant, <input type="checkbox"/> Lessee, <input type="checkbox"/> Under Construction, <input type="checkbox"/> Couldn't be Surveyed, <input type="checkbox"/> Property was locked, <input type="checkbox"/> Bank sealed, <input type="checkbox"/> Court sealed		
17.	Any negative observation of the			

	property during survey	
18.	Is Independent access available to the property	<i>finishing segue</i> <input checked="" type="checkbox"/> Clear independent access is available, <input type="checkbox"/> Access available in sharing of other adjoining property, <input type="checkbox"/> No clear access is available, <input type="checkbox"/> Access is closed due to dispute
19.	Is property clearly demarcated with permanent boundaries?	<input checked="" type="checkbox"/> Yes, <input type="checkbox"/> No, <input type="checkbox"/> Only with Temporary boundaries
20.	Is the property merged or colluded with any other property	<i>NO</i>
21.	Local Information References on property rates	Please refer attached sheet named 'Property rate Information Details.'

Endorsement:

1. Signature of the Person who was present from the owner side to identify the property:

Undertaking: I have shown the correct property and provided the correct information about the property to the surveyor of R.K Associates to the best of my knowledge for which Valuation has to be prepared. In case I have shown wrong property or misled the valuer company in any way then I'll be solely responsible for this unlawful act.

- a. Name of the Person: *Niranjana Singh*
b. Relation: *Son*
c. Signature: *[Signature]*
d. Date: *08/ July/ 2021*

In case not signed then mention the reason for it: ☐ No one was available, ☐ Property is locked, ☐ Owner/ representative refused to sign it, ☐ Any other reason:

2. Surveyor Signature who did site inspection:

Undertaking: I have inspected the property and cross verified the property details at site to the extent of a. Matching boundaries of the property, b. Sample measurement of its area, c. Physical condition, d. Property rates as per local information with what is mentioned in the property documents provided to me by the Bank/ interested organization. I have not come under influence of anyone during site inspection and have only recorded the true and factual details in the survey form which I come across during the site survey. I understand that giving any manipulative information in the survey form will lead to incorrect Valuation report which is an unlawful act and I'll be solely responsible for doing it.

- a. Name of the Surveyor: *Hemant Kumar*
b. Signature: *[Signature]*
c. Date: *08/ July/ 2021*