

REPORT FORMAT: V-L2 (L&B) | Version: 9.0\_2019

FILE NO.: VIS(2021-22)-PL374-334-424

DATED:06/09/2021

# VALUATION ASSESSMENT OF INDUSTRIAL LAND & BUILDING

SITUATED AT

PLOT NO. A-19 & A-20 UPSIDC INDUSTRIAL AREA, SIKANDARABAD,  
BULANDSAHAR, UTTAR PRADESH

OWNER/S

M/S. APL APOLLO TUBES LIMITED

A/C M/S. APL APOLLO TUBES LIMITED

REPORT PREPARED FOR

STATE BANK OF INDIA, IFB BRANCH, NEW DELHI

- Corporate Valuers
- Business/ Enterprise/ Equity Valuations
- Lender's Independent Engineers (LIE)
- Techno Economic Viability Consultants (TEV)
- Agency for Specialized Account Monitoring (ASAM)
- Project Techno-Financial Advisors

■ Chartered Engineers

■ Industry/ Trade Rehabilitation Consultants

■ NPA Management

■ Panel Valuer & Techno Economic Consultants for PSU  
Banks

*Important - In case of any query/ issue/ concern or escalation you may please contact Incident Manager @*

*Incident Manager (ASAM). We will appreciate your feedback in order to improve our services.*

*Valuation TDR is available at [www.rkassociates.org](http://www.rkassociates.org) for reference.*

*NOTE: As per IBA Guidelines please provide your feedback on the report within 15 days of its submission after which report  
will be considered to be correct.*

**CORPORATE OFFICE:**

D-39, 2nd floor, Sector 2, Noida-201301

Ph - +91-0120-4110117, 4324647, +91 - 9958632707

E-mail - [valuers@rkassociates.org](mailto:valuers@rkassociates.org) | Website: [www.rkassociates.org](http://www.rkassociates.org)

## VALUATION ASSESSMENT AS PER SBI FORMAT

Name & Address of Branch:	State Bank of India, IFB Branch, New Delhi
Name Of Customer (S)/ Borrower Unit	M/s. APL Apollo Tubes Limited

I.		GENERAL		
1.	Purpose for which the valuation is made	For Periodic Re-valuation of the mortgaged property		
2.	a) Date of inspection	28/08/2021		
	b) Date on which the valuation is made	06/09/2021		
3.	List of documents produced for perusal	<b>Documents Requested</b>	<b>Documents Provided</b>	<b>Documents Reference No.</b>
		Total 06 Documents requested.	Total 04 Documents provided.	04
		Property Title document	2 Lease Deed	Dated: 06/10/1986 & 21/07/2014
		Approved Map	Architect Map	---
		Fire NOC	Fire NOC	Dated: 05/02/2021
		Last paid Electricity Bill	Last paid Electricity Bill	Dated: 01/08/2021
		Last paid Municipal Tax Receipt	None	---
		Copy of TIR	None	---
4.	Name of the owner/s	M/s. APL Apollo Tubes Limited		
	Address and Phone no. of the owner/s	M/s. APL Apollo Tubes Limited, Plot No. A-19 & A-20 Sikandarabad, Bulandsahar, Uttar Pradesh		
5.	Brief description of the property	<p>This opinion on valuation report is prepared for the Industrial Land &amp; Building situated at the aforesaid address having total land area admeasuring 39979.55 sq.yds/ 33428 sq.mtr as per the copy of lease deeds provide to us by the bank.</p> <p>During site survey our team observed that owner have merged three plot i.e. A-19, A-20 &amp; A-21 each having area of 16,714 sq. mtr. to form one big land chunk of 50142 sq.mtr. over which the entire unit is set-up. However, it is possible to separate plot no. A-19 &amp; A-20 (plots for which we have to do valuation) from plot no. A-21(merged from the east side of property) by creating a wall in between</p>		





	<p>them.</p> <p>As per the copy of lease deeds dated: 06/10/1986 &amp; 21/07/2014, provided to us originally, Plot No. A-19 is allotted by UPSIDC in favor of M/s. Bihar Tubes Pvt. Ltd. &amp; Plot No. A-20 was allotted by UPSIDC in favor of M/s. APL Apollo Tubes Limited. As per the company representative the company name of M/s. Bihar Tubes Pvt. Ltd. change into M/s. APL Apollo Tubes Limited. So at present the subject property is in ownership of M/s. APL Apollo Tubes Limited.</p> <p>The identification of the subject property is only done via the owner's representative and nameplate displayed on the subject property. The valuation is done on as-is-where-is basis and what we have observed on site.</p> <p>The subject property comprised of various industrial sheds and RCC roofed structures. We have not been provided with approved map with area statement chart and as the structures are very large so all the covered area details are taken as per the architectural map provided to us by the company in good faith. The architect plan provided to us is for complete plot no. A-19, A-20 &amp; A-21 only &amp; for valuation we have taken the covered area details of structures present on plot no. A-19 &amp; A-20 only.</p> <p>Also as per the verbal information provided by the owner's representative during site survey and later on telephonic conversation, all the RCC construction of about 998.78 sq.mtr/ 10750.8 sq.ft. is located at plot no. A-19 &amp; A-20 only.</p> <p>The covered area details of the subject property is tabulated below: -</p>
--	---



BUILDING/ CIVIL STRUCTURES						
S. No.	Block Name	Total Slabs/ Floors	Type of construction	Structure condition	Area (in sq. mtr.)	Area (in sq. ft.)
1	New G.I. Shed	Ground Floor	GI shed roof mounted on iron pillars, trusses frame structure	Average	1646.95	17727.61
2	Shed	Ground Floor	GI shed roof mounted on iron pillars, trusses frame structure	Average	890.27	9582.78
3	Miscellaneous Structure (including P.P. Ring Room, Boiler, Store etc.)	Ground Floor	GI shed roof mounted on iron pillars, trusses frame structure	Average	413.45	4450.33
4	Tube Mill No.3	Ground Floor	GI shed roof mounted on iron pillars, trusses frame structure	Average	2826.1	30419.86
5	Tube Mill No.6	Ground Floor	GI shed roof mounted on iron pillars, trusses frame structure	Average	2505.90	26973.26
6	Quality test Room & Office	Ground Floor	RCC framed pillar beam column structure on RCC slab	Average	78.86	848.94
7	Work Shop D. G. Room	Ground Floor	GI shed roof mounted on iron pillars, trusses frame structure	Average	443.10	4769.48
8	Store, C.N.C. Room, Room, maintenance Room, Milk Parnal	Ground Floor	GI shed roof mounted on iron pillars, trusses frame structure	Average	895.63	9640.69
9	Picking Shed	Ground Floor	GI shed roof mounted on iron pillars, trusses frame structure	Average	458.59	4936.22
10	Old G.I. Shed	Ground Floor	GI shed roof mounted on iron pillars, trusses frame structure	Average	2855.79	30729.44
11	Tube Mill No.2	Ground Floor	GI shed roof mounted on iron pillars, trusses frame structure	Average	3020.55	32512.90
12	Tube Mill No.1	Ground Floor	GI shed roof mounted on iron pillars, trusses frame structure	Average	2808.30	30228.26
13	China Sleeting Shed	Ground Floor	GI shed roof mounted on iron pillars, trusses frame structure	Average	2808.30	30228.26
14	Office Area & Other miscellaneous RCC Structure	G+1 Floor	RCC framed pillar beam column structure on RCC slab	Average	919.92	9901.93
<b>TOTAL</b>					<b>22571.73</b>	<b>242959.84</b>

The subject property is used for manufacturing of steel products like Pre-Galvanized Tubes, Structural Steel Tubes, Galvanized Tubes, MS Black Pipes and Hollow Sections.

The subject property is located in developed Industrial area of Sikandrabad. The property is clearly approached by Tibegampur Road which is ~50 ft wide



This report only contains general assessment & opinion on the Guideline Value and the indicative, estimated Market Value of the property found on as-is-where basis on site for which the Bank/ customer has shown & asked us to conduct the Valuation for which photographs is also



		attached with the report. No legal aspects in terms of ownership or any other legal aspect is taken into consideration. It doesn't contain any due-diligence other than the valuation assessment of the property shown to us on site. Information/ data/ documents given to us by Bank/ client has been relied upon in good faith. This report doesn't contain any other recommendations of any sort.		
6.	Location of property			
	a)	Plot No. / Survey No.	A-19 & A-20	
	b)	Door No.	NA	
	c)	T. S. No. / Village	Tehsil - Sikandrabad	
	d)	Ward / Taluka	---	
	e)	Mandal / District	District – Bulandsahar	
	f)	Date of issue and validity of layout of approved map / plan	Approved Map Not provided to us.	
	g)	Approved map / plan issuing authority	Cannot comment since approved map is not provided to us.	
	h)	Whether genuineness or authenticity of approved map / plan is verified	Map not provided to us	
i)	Any other comments by our empanelled Valuers on authenticity of approved plan	No		
7.	Postal address of the property		Plot No. A-19 & A-20 UPSIDC Industrial Area, Sikandarabad, Bulandsahar, Uttar Pradesh	
8.	a)	City / Town	Tehsil - Sikandrabad	
	b)	Residential Area	No	
	c)	Commercial Area	No	
	d)	Industrial Area	Yes	
9.	Classification of the area			
	a)	High / Middle / Poor	Middle	
	b)	Urban / Semi Urban / Rural	Urban	
10.	Coming under Corporation limit/ Village Panchayat / Municipality		UPSIDC	
11.	Whether covered under any State / Central Govt. enactments (e.g. Urban and Ceiling Act) or notified under agency area / scheduled area / cantonment area		No	
12.	In case it is an agricultural land, any conversion to house site plots is contemplated		.NA	
13.	Dimensions of the property			
	Are Boundaries matched		Different Boundaries for different plots.	
	Directions	As per Sale Deed/TIR	Actual found at Site	



	North	NA	Road
	South	NA	Oriental bell Industries
	East	NA	Another property of owner A-21
	West	NA	Plot No.A-18
14.2	Latitude, Longitude & Co-Ordinates Of Industrial Property		28°28'52.8"N 77°38'48.3"E
15.	Extent of the site		39979.55 sq.yds./ 33428 sq.mtr
16.	Extent of the site considered for valuation (least of 14 A & 14 B)		39979.55 sq.yds./ 33428 sq.mtr
17.	Whether occupied by the owner / tenant?		Owner Occupied
	If occupied by tenant, since how long?		Not applicable
	Rent received per month.		Not applicable

II. CHARACTERISTICS OF THE SITE		
1.	Classification of locality	Urban developing
2.	Development of surrounding areas	Old established notified Industrial Area
3.	Possibility of frequent flooding / submerging	NA
4.	Feasibility to the Civic amenities like school, hospital, bus stop, market etc.	Yes, civic amenities are available at some distance from subject property.
5.	Number of Floors	Refer to the sheet attached below
6.	Type of Structure	Refer to the sheet attached below
7.	Type of use to which it can be put	Industrial
8.	Any usage restriction	For industrial use only
9.	Is plot in town planning approved layout?	Yes
10.	Corner plot or intermittent plot?	Intermittent Plot
11.	Road facilities	Yes
12.	Type of road available at present	Bituminous
13.	Width of road – is it below 20 ft. or more than 20 ft.	More than 20 ft.
14.	Is it a land – locked land?	No
15.	Water potentiality	Yes
16.	Underground sewerage system	Yes
17.	Is power supply available at the site?	Yes
18.	Advantage of the site	The property lies in an Industrial area maintained by U.P.S.I.D.C.
19.	Special remarks, if any, like threat of acquisition of land for public service purposes, road widening or applicability of CRZ provisions etc. (Distance from sea-coast / tidal level must be incorporated)	None





**PART B****VALUATION OF LAND**

1.	Size of Plot	39979.55 sq. yds./ 33428 sq.mtr
	North & South	175 mtr as measured from Google map
	East & West	180 mtr as measured from Google map
2.	Total extent of the plot	39979.55 sq.yds./ 33428 sq.mtr
	Area adopted on the basis of	Property documents & site survey both
	Remarks & observations, if any	None
3.	Prevailing market rate (Along with details /reference of at least two latest deals/transactions with respect to adjacent properties in the areas)	<p><b>References on prevailing market Rate/ Price trend of the property and Details of the sources from where the information is gathered (from property search sites &amp; local information)</b></p> <p><b>1. Name:</b> Mr. Shuvam (Property Consultant)  <b>Contact No.:</b> +91-9810075634  <b>Size of the Property:</b> Approx. 25,000 sq.mtr  <b>Rates/ Price informed:</b> Rs.5,000/- to Rs.5,500/- sq.mtr.  <b>Comment:</b> As per the discussion held with the above mentioned property dealer we came to know that the rates in the concerned area is Rs.5,000/- to Rs.5,500/- sq. mtr. for industrial land.</p> <p><b>2. Name:</b> SR Properties (Property Consultant)  <b>Contact No.:</b> +91-9810877866  <b>Size of the Property:</b> Approx. 30,000 sq. mtr  <b>Rates/ Price informed:</b> Rs.4,000/- to Rs.5,000/- sq.mtr.  <b>Comment:</b> As per the discussion held with the above mentioned property dealer we came to know that the rates in the concerned area is 4,500/- to Rs.5,000/- per sq. mtr. for industrial land away from main G.T. road and on main G.T. road the rates are about Rs.7,000/- to Rs.8,000/- per sq.mtr.</p> <p>As per our discussion with market participants and habitants of the subject locality we came to know the following information: -</p> <ol style="list-style-type: none"> <li>1. The prevailing land rate in the subject locality depends on the size, shape, frontage, approach road width, location.</li> <li>2. The subject locality is an old established industrial area of U.P.S.I.D.C, Sikandrabad.</li> </ol>



		<p>3. The prevailing market rate for the industrial land located within vicinity of subject land is ranging in between Rs.4,000/- to Rs.5,000/- per sq.mtr.</p> <p>4. The supply of the Industrial land in this area is good while demand is average as well.</p> <p>5. The circle rate in the subject locality is Rs.3,400/- per sq.mtr.</p> <p>As the subject property has very large land area and can be clearly approached from 50 ft. wide road. Therefore, considering all the above mentioned facts like size, shape, demand &amp; Supply gap, location, we are on the view that market rate for the subject land parcel would be Rs.4,500/- per sq.mtr. which we seems is reasonable.</p>
3.	Guideline rate obtained from the Registrar's office (an evidence thereof to be enclosed)	Guideline value: Land: 33428 sq.mtr X Rs.3,400/- per sq.mtr <b>= Rs.11,36,55,200/-</b>
4.	Assessed / adopted rate of valuation	<b>Rs.4,500/- per sq.mtr</b>
5.	Estimated value of land (A)	Market Value: Land: 33428 sq.mtr X Rs.4,500/- per sq.mtr <b>= Rs.15,04,26,000/-</b>





**PART C****VALUATION OF BUILDING**

1.	Technical details of the building		Construction done using professional contractor workmanship based on architect plan.
	a)	Type of Building (Residential / Commercial/ Industrial)	Industrial
	b)	Type of construction (Load bearing / RCC/ Steel Framed)	Please refer to the attached specifications annexure
	c)	Year of construction	Please refer to the table attached below.
	d)	Number of floors and height of each floor including basement, if any	Please refer to the table attached below
	e)	Plinth area floor-wise	Please refer to the table attached below
	f)	Condition of the building	Average
	i.	Interior Finishing	Neatly plastered and putty coated walls
	ii.	Exterior Finishing	Neatly plastered & putty coated walls
2.	Status of Building Plans/ Maps		Cannot comment since no approved map given to us
	g)	Date of issue and validity of layout of approved map / plan	NA
	h)	Is Building as per approved Map	Cannot comment since no approved map given to us
	i)	Whether genuineness or authenticity of approved map / plan is verified	Cannot comment since approved map is not provided to us.
	j)	Any other comments by our empaneled valuers on authentic of approved plan	No
	k)	Details of alterations/ deviations/ illegal construction/ encroachment noticed in the structure from the original approved plan	NA
3.	Valuation of Structure		
	a)	Market Value of Structure	<b>Rs.16,43,45,809/-</b>
	b)	Government Guideline Value of Structure	<b>Not Available in Public domain.</b>

# VALUATION ASSESSMENT

M/S. APL APOLLO TUBES LTD. | SIKANDRABAD PLANT |



## BUILDING/ CIVIL STRUCTURES VALUATION | M/S APL APOLLO TUBES PVT. LTD. | PLOT NO.- A-19, A-20 U.P.S.I.D.C. INDUSTRIAL AREA | SIKANDRABAD PLANT UTTAR PRADESH

S. No.	Block Name	Total Slabs/ Floors	Year of construction	Type of construction	Structure condition	Area (in sq. mtr.)	Area (in sq. ft.)	Rates Adopted (per sq.ft)	Fair Market value (Rs.)
1	New G.I. Shed	Ground Floor	2017	Brickwall structure with G.I. Sheet roof mounted over Iron trusses	Average	1646.95	17727.61	₹ 800.00	₹ 1,41,82,084
2	Shed	Ground Floor	2015	Brickwall structure with G.I. Sheet roof mounted over Iron trusses	Average	890.27	9582.78	₹ 650.00	₹ 62,28,805
3	Miscellaneous Structure (including P.P. Ring Room, Boiler, Store etc.)	Ground Floor	2015	Brickwall structure with G.I. Sheet roof mounted over Iron trusses	Average	413.45	4450.33	₹ 650.00	₹ 28,92,717
4	Tube Mill No.3	Ground Floor	2015	Brickwall structure with G.I. Sheet roof mounted over Iron trusses	Average	2826.1	30419.86	₹ 650.00	₹ 1,97,72,908
5	Tube Mill No.6	Ground Floor	2015	Brickwall structure with G.I. Sheet roof mounted over Iron trusses	Average	2505.90	26973.26	₹ 650.00	₹ 1,75,32,617
6	Quality test Room & Office	Ground Floor	2015	RCC framed pillar beam column structure on RCC slab	Average	78.86	848.84	₹ 1,000.00	₹ 8,48,841
7	Work Shop D. G. Room	Ground Floor	2015	Brickwall structure with G.I. Sheet roof mounted over Iron trusses	Average	443.10	4769.48	₹ 650.00	₹ 31,00,165
8	Store, C.N.C. Room, Room, maintenance Room, Milk Pannal	Ground Floor	2015	Brickwall structure with G.I. Sheet roof mounted over Iron trusses	Average	895.65	9640.69	₹ 650.00	₹ 62,66,447
9	Picking Shed	Ground Floor	2015	Brickwall structure with G.I. Sheet roof mounted over Iron trusses	Average	458.59	4936.22	₹ 650.00	₹ 32,08,541
10	Old G.I. Shed	Ground Floor	2015	Brickwall structure with G.I. Sheet roof mounted over Iron trusses	Average	2855.79	30739.44	₹ 650.00	₹ 1,99,80,635
11	Tube Mill No.2	Ground Floor	2015	Brickwall structure with G.I. Sheet roof mounted over Iron trusses	Average	3020.55	32512.90	₹ 650.00	₹ 2,11,33,384
12	Tube Mill No.1	Ground Floor	2015	Brickwall structure with G.I. Sheet roof mounted over Iron trusses	Average	2808.30	30228.26	₹ 650.00	₹ 1,96,48,369
13	China Sletting Shed	Ground Floor	2015	Brickwall structure with G.I. Sheet roof mounted over Iron trusses	Average	2808.30	30228.26	₹ 650.00	₹ 1,96,48,369
14	Office Area & Other miscellaneous RCC Structure	G +1 Floors	2016	RCC framed pillar beam column structure on RCC slab	Average	919.92	9901.93	₹ 1,000.00	₹ 99,01,927
Total						22571.73	242959.84		₹ 16,43,45,809

### REMARKS:-

1. All these civil structures are located in the premises of M/s. APL Apollo Tubes Pvt. Ltd. Situated at A-19, A-20, U.P.S.I.D.C. Industrial Area, Sikandrabad, Uttar
2. The covered area of the subject property is taken as per the architect map provided by the company and sample checked at the site
3. The valuation of the property has been done on the basis of depreciated replacement cost approach.





6. SPECIFICATIONS OF CONSTRUCTION (FLOOR-WISE) IN RESPECT OF			
S.No.	Description	Ground floor	Other floors
1.	Foundation	Yes	NA
2.	Ground Floor	Yes	Yes
3.	Superstructure	Yes	Yes
4.	Joinery / Doors & Windows (please furnish details about size of frames, shutters, glazing, fitting etc. and specify the species of timber)	Steel Shutters	Glass door
5.	RCC works	Yes	Yes
6.	Plastering	Yes	Yes
7.	Flooring, Skirting, dadoing	Yes	Yes
8.	Special finish as marble, granite, wooden paneling, grills, etc.	Yes	Yes
9.	Roofing including weather proof course	Yes	Yes
10.	Drainage	Yes	Yes

S.No.	Description	Ground floor	Other floors
1.	Compound wall	Yes	NA
	Height	Approx. 10 ft.	NA
	Length	800 mtr. (approx.)	NA
	Type of construction	RCC	NA
2.	Electrical installation		
	Type of wiring	NA	NA
	Class of fittings (superior / ordinary / poor)	NA	NA
	Number of light points	NA	NA
	Fan points	NA	NA
	Spare plug points	NA	NA
	Any other item	NA	NA
3.	Plumbing installation		
	a) NA	NA	NA
	b) NA	NA	NA
	c) NA	NA	NA
	d) NA	NA	NA
	e) NA	NA	NA



f)	NA	NA	NA
----	----	----	----

**PART D****EXTRA ITEMS**

1.	Portico	NA
2.	Ornamental front door	NA
3.	Sit out/ Verandah with steel grills	NA
4.	Overhead water tank	NA
5.	Extra steel/ collapsible gates	NA
6.	<b>Total (C)</b>	NA

**PART E****AMENITIES**

1.	Wardrobes	NA
2.	Glazed tiles	NA
3.	Extra sinks and bath tub	NA
4.	Marble / Ceramic tiles flooring	NA
5.	Interior decorations	NA
6.	Architectural elevation works	NA
7.	Paneling works	NA
8.	Aluminum works	NA
9.	Aluminum hand rails	NA
10.	False ceiling	NA
	<b>Total (D)</b>	NA

**PART F****MISCELLANEOUS**

1.	Separate toilet room	NA
2.	Separate lumber room	NA
3.	Separate water tank/ sump	NA
4.	Trees, gardening	NA
	<b>Total (E)</b>	NA





**PART G****SERVICES**

1.	Water supply arrangements	NA
2.	Drainage arrangements	NA
3.	Compound wall	Rs.20,00,000/-
4.	C. B. deposits, fittings etc.	NA
5.	Pavement	Rs.20,00,000/-
	<b>Total (F)</b>	<b>Rs.40,00,000/-</b>

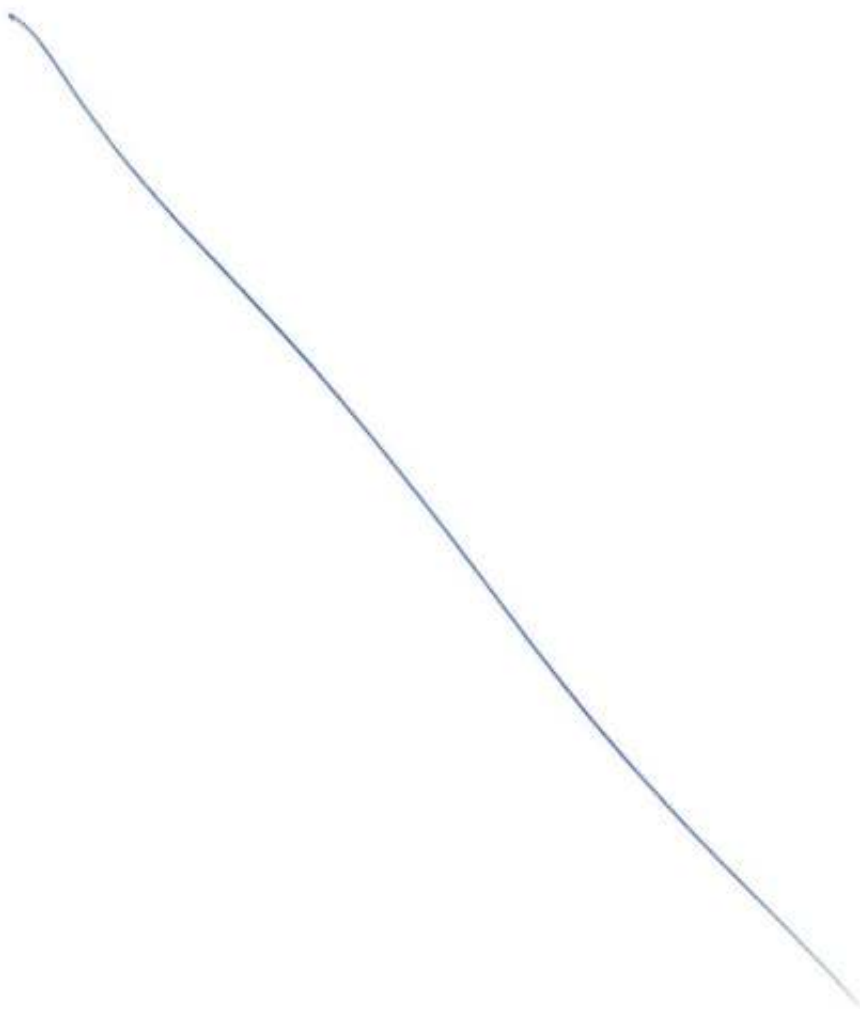

**PART H****CONSOLIDATED VALUATION ASSESSMENT OF THE INDUSTRY**

S.No.	Particulars	Govt. Circle/ Guideline Value	Indicative & Estimated Prospective Fair Market Value
1.	Land (A)	Rs.11,36,55,200/-	Rs.15,04,26,000/-
2.	Structure Construction Value (B)	Not Available in Public domain.	Rs.16,43,45,809/-
3.	Extra Items (C)	---	Rs. 40,00,000/-
4.	Amenities (D)	---	---
5.	Miscellaneous (E)	---	---
6.	Services (F)	---	---
7.	<b>Total Add (A+B+C+D+E+E+F)</b>	<b>Rs.11,36,55,200/-</b>	<b>Rs.31,87,71,809/-</b>
8.	Additional Premium if any	---	---
	Details/ Justification	---	---
9.	Deductions charged if any	---	---
	Details/ Justification	---	---
10.	<b>Total Indicative &amp; Estimated Prospective Fair Market Value<sup>#</sup></b>	---	<b>Rs.31,87,71,809/-</b>
11.	<b>Rounded Off</b>	----	<b>Rs.32,00,00,000/-</b>
12.	<b>Expected Realizable Value<sup>^</sup> (@ ~15% less)</b>	----	<b>Rs.27,20,00,000/-</b>
13.	<b>Expected Forced Distress Sale Value<sup>*</sup> (@ ~25% less)</b>	----	<b>Rs.24,00,00,000/-</b>

**(RUPEES THIRTY TWO CRORES ONLY)**

i.	<b>Justification for more than 20% difference in Market &amp; Circle Rate</b>	<p>Circle rates are determined by the District administration as per their own theoretical internal policy and Market rates are adopted based on current practical market dynamics which is explained clearly in Valuation Assessment Factors</p> <p>Circle rates are determined by the District administration as per their own theoretical internal policy and Market rates are adopted based on current practical market dynamics which is explained clearly in Valuation Assessment Factors</p>
ii.	<b>Concluding comments &amp; Disclosures if any</b>	<ol style="list-style-type: none"> <li>During site survey our team observed that owner have merged three plot i.e. A-19, A-20 &amp; A-21 each having area of 16,714 sq. mtr. to form one big land chunk of 50142 sq.mtr. over which the entire unit is set-up. However, it is possible to separate plot no. A-19 &amp; A-20 (plots for which we have to do valuation) from plot no. A-21(merged from the east side of property) by creating a wall in between them.</li> <li>The subject property comprised of various industrial sheds and RCC roofed structures. We have not been provided with approved map with area statement chart and as the structures</li> </ol>

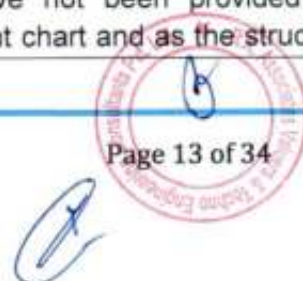





are very large so all the covered area details are taken as per the architectural map provided to us by the company in good faith only.

3. Presently the property market is not under a free market condition due to Covid Pandemic disruption. Currently, as per the micro & macro market research, the demand for property is weak and the enquiries and the transactions are negligible. In these uncertain times, people are likely to be very cautious in their expenditures in general and are and will be averse to lock up their available liquidity in the acquisition of fixed assets like property. A potential buyer of property if any, may consider acquiring a property only if he gets a really good bargain, at a substantial discount to the rates prevailing before the Covid Pandemic. Thus the Realizable Value in this Report has been adopted based on this consideration.
4. This Valuation report is prepared based on the copies of the documents/ information which interested organization or customer could provide to us out of the standard checklist of documents sought from them and further based on our assumptions and limiting conditions. All such information provided to us has been relied upon in good faith and we have assumed that it is true and correct.
5. Legal aspects for eg. Investigation of title, ownership rights, lien, charge, mortgage, lease, verification of documents from originals, etc. has to be taken care by legal experts/ Advocates.
6. This report only contains technical & market information which came to knowledge during course of the assignment. It doesn't contain any recommendations.
7. This report is prepared following our Standard Operating Procedures & Best Practices, Limitations, Conditions, Remarks, Important Notes, Valuation TOR.



DECLARATION BY VALUER FIRM																														
i.	As a result of my appraisal and analysis, it is my considered opinion that the present fair market value of the above property in the prevailing condition with aforesaid specifications is <b>Rs.32,00,00,000/- (Rupees Thirty Two Crores Only)</b> . The Realizable value of the above property is <b>Rs.27,20,00,000/- (Rupees Twenty Seven Crores Twenty Lakhs only)</b> . The book value of the above property as of <u>XXX</u> is Rs. <u>          </u> only) and the distress value is <b>Rs.24,00,00,000/- (Rupees Twenty Four Crores only)</b> .																													
ii.	<b>Name &amp; Address of Valuer company</b>	M/s R.K. Associates Valuers & Techno Engineering Consultants Pvt. Ltd. D- 39, 2nd floor, Sector- 2, Noida																												
iii.	<b>Enclosed Documents</b>	<table border="1"> <thead> <tr> <th>S.No</th> <th>Documents</th> <th>No. of Pages</th> </tr> </thead> <tbody> <tr> <td>i.</td> <td>General Details</td> <td>02</td> </tr> <tr> <td>ii.</td> <td>Screenshot of the price trend references of the similar related properties available on public domain</td> <td>01</td> </tr> <tr> <td>iii.</td> <td>Google Map</td> <td>01</td> </tr> <tr> <td>iv.</td> <td>Photographs</td> <td>07</td> </tr> <tr> <td>v.</td> <td>Copy of Circle Rate</td> <td>01</td> </tr> <tr> <td>vi.</td> <td>Survey Summary Sheet</td> <td>02</td> </tr> <tr> <td>vii.</td> <td>Valuer's Remark</td> <td>02</td> </tr> <tr> <td>viii.</td> <td>Copy of relevant papers from the property documents referred in the Valuation</td> <td>05</td> </tr> </tbody> </table>	S.No	Documents	No. of Pages	i.	General Details	02	ii.	Screenshot of the price trend references of the similar related properties available on public domain	01	iii.	Google Map	01	iv.	Photographs	07	v.	Copy of Circle Rate	01	vi.	Survey Summary Sheet	02	vii.	Valuer's Remark	02	viii.	Copy of relevant papers from the property documents referred in the Valuation	05	
S.No	Documents	No. of Pages																												
i.	General Details	02																												
ii.	Screenshot of the price trend references of the similar related properties available on public domain	01																												
iii.	Google Map	01																												
iv.	Photographs	07																												
v.	Copy of Circle Rate	01																												
vi.	Survey Summary Sheet	02																												
vii.	Valuer's Remark	02																												
viii.	Copy of relevant papers from the property documents referred in the Valuation	05																												
iv.	<b>Total Number of Pages in the Report with Enclosures</b>	34																												
v.	<b>Engineering Team worked on the report</b>	<b>SURVEYED BY:</b> AE Harshit  <b>PREPARED BY:</b> AE Zaid Ebne Mairaj  <b>REVIEWED BY:</b> HOD Valuations	  																											
DECLARATION BY BANK																														
i.	The undersigned has inspected the property detailed in the Valuation Report dated <u>          </u> on <u>          </u> . We are satisfied that the fair and reasonable market value of the property is Rs. <u>          </u> (Rs. <u>          </u> only).																													
ii.	<b>Name of Bank of Manager</b>																													
iii.	<b>Name of Branch</b>																													
iv.	<b>Signature</b>																													





### ANNEXURE: I- ASSUMPTIONS | REMARKS | LIMITING CONDITIONS

i.	Qualification in TIR/Mitigation Suggested, if any: <b>Cannot comment since copy of TIR not provided to us by the bank.</b>
ii.	Is property SARFAESI compliant: <b>Yes</b>
iii.	Whether property belongs to social infrastructure like hospital, school, old age home etc.: <b>No</b>
iv.	Whether entire piece of land on which the unit is set up / property is situated has been mortgaged or to be mortgaged: <b>Yes, already mortgaged</b>
v.	Details of last two transactions in the locality/area to be provided, if available: <b>No such information found.</b>
vi.	Any other aspect which has relevance on the value or marketability of the property: This report is prepared following our standard operating procedures & best practices, limitations, conditions, remarks, Important Notes, Valuation TOR.
	1. This Valuation report is prepared based on the copies of the documents/ information which interested organization or customer could provide to us out of the standard checklist of documents sought from them and further based on our assumptions and limiting conditions. All such information provided to us has been relied upon in good faith and we have assumed that it is true and correct. Verification or cross checking of the copy of the documents provided to us from the originals has not been done at our end.
	2. Legal aspects for e.g. investigation of title, ownership rights, lien, charge, mortgage, lease, etc. are not considered in this report. It is assumed and taken into account that the concerned Bank/ Financial Institution has got the legal verification cleared by the competent Advocate while requesting for the Valuation report.
	3. Value varies with the Purpose/ Date/ Condition prevailing in the market. We recommend not to refer the Value of the asset given in this report if any of these points are different from the one mentioned aforesaid in the Report. We also recommend that the indicative estimated Value in the Valuation Report holds good only upto the period of 3 months from the date of Valuation.

### R.K ASSOCIATES IMPORTANT NOTES

**DEFECT LIABILITY PERIOD** - In case of any query/ issue or escalation you may please contact Incident Manager by writing at [valuers@rkassociates.org](mailto:valuers@rkassociates.org). We try our level best to ensure maximum accuracy in the Calculations done, Rates adopted and various other data points & information mentioned in the report but still can't rule out typing, human errors or any other mistakes. In case you find any mistake, variation, discrepancy or inaccuracy in any data point of the report, please help us by bringing all such points into our notice in writing at [valuers@rkassociates.org](mailto:valuers@rkassociates.org) within 30 days of the report delivery, to get these rectified timely, failing which R.K Associates won't be held responsible for any inaccuracy in any manner. Also if we will not hear back anything from you within 30 days, we will assume that report is correct in all respect and no further claim of any sort will be entertained thereafter. We would welcome and appreciate your feedback & suggestions in order to improve our services.

Our **DATA RETENTION POLICY** is of **ONE YEAR**. After this period we remove all the concerned records related to the assignment from our repository. No clarification or query can be answered after this period due to unavailability of the data.

**COPYRIGHT FORMAT** - This report is prepared on the copyright format of R.K Associates to serve our clients in the best possible way. Legally no one can copy or distribute this format without prior approval from R.K Associates. It is meant only for the organization as mentioned on the cover page of this report. Distribution or use of this format other than R.K Associates will be seen as unlawful act and necessary legal action can be taken against the defaulters.

### IF REPORT IS USED FOR BANK/ FIs

**NOTE:** As per IBA Guidelines in case the valuation report submitted by the valuer is not in order, the banks / FIs shall bring the same to the notice of the valuer within 15 days of submission for rectification and resubmission. In case no such communication is received, it shall be presumed that the valuation report has been accepted.

At our end we have not verified the authenticity of any documents provided to us. Bank is advised to verify the genuineness of the property documents before taking any credit decision.



**ANNEXURE: II- REFERENCES ON PRICE TREND OF THE SIMILAR RELATED PROPERTIES  
AVAILABLE ON PUBLIC DOMAIN**

---

(No specific price trend references for the properties having same characteristics is not found on public domain)



A handwritten signature in blue ink, located at the bottom right of the page.



## ANNEXURE: III – GOOGLE MAP LOCATION

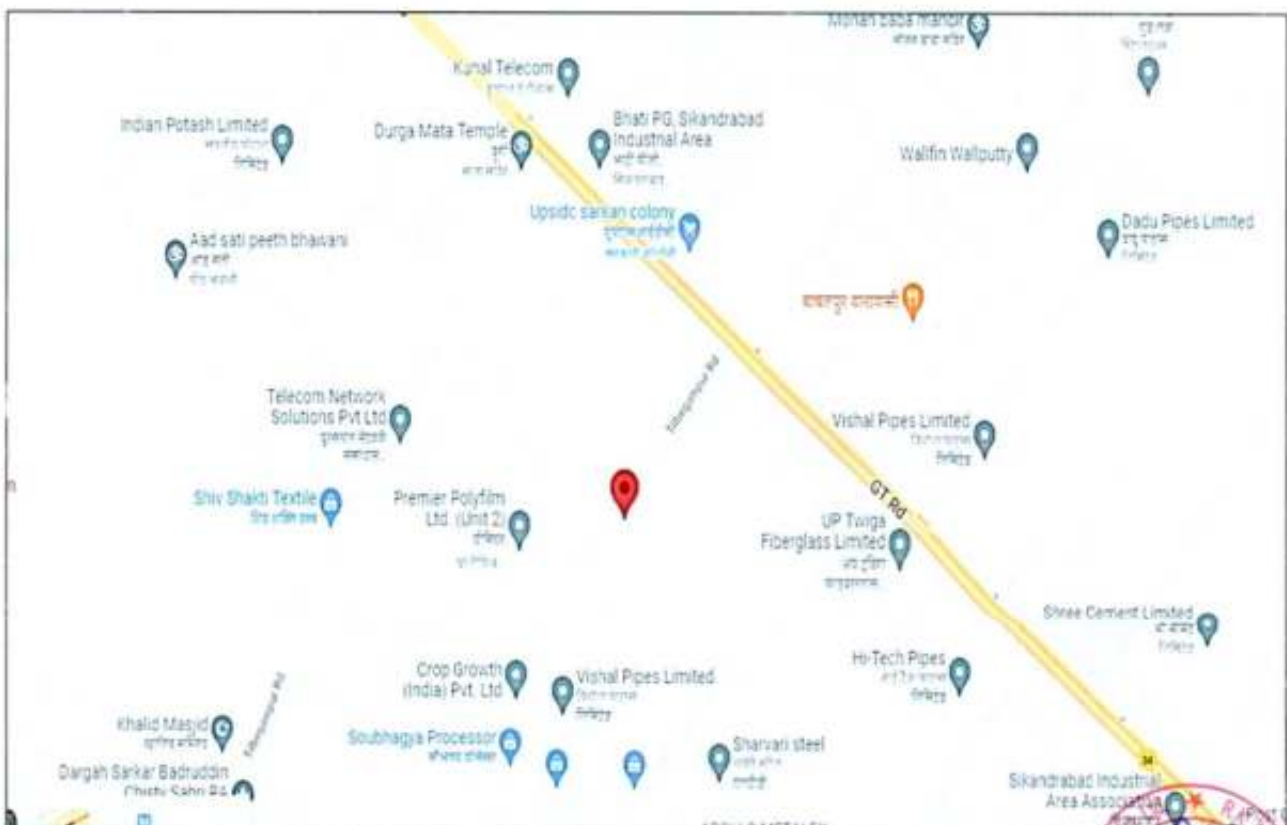





## ANNEXURE: IV – PHOTOGRAPHS OF THE PROPERTY





























## ANNEXURE: V – COPY OF CIRCLE RATE

110	Agro Park Phase-2 (Barabanki)	F	4000
111	Chauch(urva) LakhimpurKheri	F	2000
112	Amausi	F	4120
113	Chinhai	F	4700
114	Sarojini Nagar	F	4120
115	Chatoh Ind.Est.	F	1030
116	Deeh(Parshadepur)	F	1030
117	Jale	F	1030
118	Lalgaon	F	1030
119	Maharajganj	F	1030
120	Rasbanshi-4	F	2000
121	Rasbanshi-II	F	2000
122	Salon Ind.Est.	F	1030
123	Singhpur Ind.Est	F	1030
124	Tiloi	F	1030
125	Sandila Residential	F	2500
126	Kursi Road Residential	F	7210
127	Partapur Meerut	VF	6500
128	S.G.Complex Meerut	VF	10000
129	Udyog Pura, Meerut	VF	6500
130	Pikhan- Saharanpur	F	3142
131	Bagrajpur (Muzaffar Nagar)	F	4000
132	Surajpur- (EPIP)	VF	6500
133	Surajpur Site-A	VF	upto 1000 sq mtr. Rs. 8100, 1001 to 4000 sq mtr. Rs. 7800, above 4000 sq mtr. Rs. 7500
134	Surajpur Site-B	VF	upto 1000 sq mtr. Rs. 8100, 1001 to 4000 sq mtr. Rs. 7800, above 4000 sq mtr. Rs. 7500
135	Surajpur Site-C-	VF	upto 1000 sq mtr. Rs. 8100, 1001 to 4000 sq mtr. Rs. 7800, above 4000 sq mtr. Rs. 7500
136	Surajpur Site-4	VF	upto 1000 sq mtr. Rs. 11640, 1001 to 4000 sq mtr. Rs. 11330, above 4000 sq mtr. Rs. 11125
137	Surajpur Site-5	VF	upto 1000 sq mtr. Rs. 8000, 1001 to 4000 sq mtr. Rs. 8300, above 4000 sq mtr. Rs. 8035
138	Khurga Junction Road	F	3500
139	Sikandrabad Industrial	VF	3400
140	Sikandrabad Ind.(Gopalpur)	VF	3400
141	Surajpur-III - Residential	VF	16300
142	Sikandrabad - Residential	VF	7004
143	Chola	-	-
144	TDS City Industrial Sectors General	VF	14550

145	TDS City Industrial Sectors (Non Polluting)	VF	13550
146	TDS City Industrial Sectors (Polluting)	VF	13750
147	IA Baghpat	F	4230
148	TDS City Residential Sectors/Group Housing	VF	24000
149	Sidhwan (Jaunpur)	F	1854
150	Ram Nagar Chandauli	F	3400
151	Ram Nagar Extn/IDC (Chandauli)	F	3300
152	Karkhyaon (varanasi)	S	2000

(मनीज सिंह)  
प्रबन्ध निदेशक

- संख्या 595-598/एसआईसीटी-आईए-1/2015-16 दि. 23-5-16
- प्रतिनिधि निम्न की सुचनाएं एवं आवश्यक कार्रवाही की जायेगी।
1. मुख्य अभियंता, उ०प्र०रा०सी०वि०नि०, मुख्यलय, कानपुर।
  2. सचिव/समस्त अनुभागप्रदाता, समस्त क्षेत्रीय प्रबन्धक, परिसीजन अभियंता, क्षेत्र प्रबन्धक, उ०प्र०रा०सी०वि०नि०, कानपुर।
  3. श्री एसपी० मुख्या, मुख्य प्रबन्धक (परि०)/कानपुर, उ०प्र०रा०सी०वि०नि०, मुख्यलय, कानपुर को निम्न की वेबसाइट पर आज ही अपलोड कराने हेतु।
  4. समस्त अभियंता/कार्यकारी, उ०प्र०रा०सी०वि०नि० (औ०सी०), मुख्यलय, कानपुर

(मनीज सिंह)  
प्रबन्ध निदेशक



**ANNEXURE: VI- DECLARATION-CUM-UNDERTAKING**

- a I am a citizen of India.
- b No employee or member of R.K Associates has any direct/ indirect interest in the property or become so interested at any time during a period of three years prior to my appointment as valuer or three years after the valuation of assets was conducted by me.
- c The information furnished in our valuation report dated 6/9/2021 is true and correct to the best of my knowledge and belief and we have made an impartial and true valuation of the property.
- d Our authorized associate/ surveyor AE. Harshit Mayank have personally inspected the property on 28/8/2021 the work is not subcontracted to any other valuer and is carried out by us.
- e Valuation report is submitted in the format as prescribed by the Bank.
- f We have not been depanelled / delisted by any other bank and in case any such depanelment by other banks during my empanelment with you, we will inform you within 3 days of such depanelment.
- g We have not been removed/ dismissed from service/employment earlier.
- h We have not been convicted of any offence and sentenced to a term of imprisonment.
- i We have not been found guilty of misconduct in professional capacity.
- j I have not been declared to be unsound mind.
- k We are not undischarged bankrupt, or has not applied to be adjudicated as a bankrupt;
- l We are not an undischarged insolvent.
- m I have not been levied a penalty under section 271J of Income-tax Act, 1961 (43 of 1961) and time limit for filing appeal before Commissioner of Income tax (Appeals) or Income-tax Appellate Tribunal, as the case may be has expired, or such penalty has been confirmed by Income-tax Appellate Tribunal, and five years have not elapsed after levy of such penalty.
- n I have not been convicted of an offence connected with any proceeding under the Income Tax Act 1961, Wealth Tax Act 1957 or Gift Tax Act 1958 and
- o Our PAN Card number/ GST number as applicable is **AAHCR0845G/09AAHCR0845G1ZP**
- p We undertake to keep you informed of any events or happenings which would make me ineligible for empanelment as a valuer.
- q We have not concealed or suppressed any material information, facts and records and I have made a complete and full disclosure.
- r We have read the Handbook on Policy, Standards and procedure for Real Estate Valuation, 2011 of the IBA and this report is in conformity to the "Standards" enshrined for valuation in the Part-B of the above handbook to the best of my ability.





- s We have read the International Valuation Standards (IVS) and the report submitted to the Bank for the respective asset class is in conformity to the "Standards" as enshrined for valuation in the IVS in "General Standards" and "Asset Standards" as applicable.
- t I abide by the Model Code of Conduct for empanelment of valuer in the Bank.
- u I am registered under Section 34 AB of the Wealth Tax Act, 1957. (Strike off, if not applicable).
- v I am valuer registered with Insolvency & Bankruptcy Board of India (IBBI) (Strike off, if not applicable).
- w My CIBIL Score and credit worthiness is as per Bank's guidelines.
- x I am the proprietor / partner / authorized official of the firm / company, who is competent to sign this valuation report.
- y I will undertake the valuation work on receipt of Letter of Engagement generated from the system (i.e. LLMS/LOS) only.
- z Further, I hereby provide the following information.

S. No.	Particulars	Valuer comment	
1.	Background information of the asset being valued	This is an Industrial property located at address: Property Bearing M/s. Apl Apollo Tubes Limited, Plot No. A-19 & A-20 Sikandarabad, Buland Shahar, Uttar Pradesh having total land area 39979.55 sq.yds. 33428 sq.mtr as per the documents/ information provided to us by the Bank/ client.	
2.	Purpose of valuation and appointing authority	Please refer to Page No.01 of the Report.	
3.	Identity of the Valuer and any other experts involved in the valuation	<b>Survey Analyst: AE Harshit Mayank</b> <b>Engineering Analyst: AE. Zaid Ebne Mairaj</b> <b>Valuer/ Reviewer: (HOD Engg.)</b>	
4.	Disclosure of valuer interest or conflict, if any	No relationship with the borrower or any kind of conflict of interest.	
5.	Date of appointment, valuation date and date of report	<b>Date of Appointment:</b>	<b>26/8/2021</b>
		<b>Date of Survey:</b>	<b>28/8/2021</b>
		<b>Valuation Date:</b>	<b>6/9/2021</b>
		<b>Date of Report:</b>	<b>6/9/2021</b>
6.	Inspections and/or investigations undertaken	Yes, by our authorized AE Harshit Mayank bearing knowledge of that area on 28/8/2021. Property was shown and identified by owner's representative Mr. Nitish Gupta (☎- +91-7055582221)	
7.	Nature and sources of the information used or relied upon	Please refer to Page No. 04 of the Report.	
8.	Procedures adopted in carrying out the valuation and valuation standards followed	Land Value is calculated on the basis of 'Market Comparable Sales approach' and Building construction value is calculated on the basis of 'Depreciated Replacement Cost approach'	
9.	Restrictions on use of the report, if any	Value varies with the Purpose/ Date/ Market & Asset Condition & Situation prevailing in the market. We recommend not to refer the indicative & estimated prospective Value of the asset given in this report if any	



		<p>of these points are different from the one mentioned aforesaid in the Report.</p> <p>This report has been prepared for the purposes stated in the report and should not be relied upon for any other purpose. Our client is the only authorized user of this report and is restricted for the purpose indicated in the engagement letter. I/we do not take any responsibility for the unauthorized use of this report.</p> <p>During the course of the assignment we have relied upon various information, data, documents provided by Bank/ client in good faith. If at any point of time in future it comes to knowledge that the information given to us is untrue, fabricated, misrepresented then the use of this report at very moment will become null &amp; void.</p> <p>This report only contains general assessment &amp; opinion on the indicative, estimated Market Value of the property for which Bank has asked to conduct the Valuation and found as per the information given in the copy of documents, information, data provided to us and/ or confirmed by the owner/ owner representative to us at site which has been relied upon in good faith. It doesn't contain any other recommendations of any sort including but not limited to express of any opinion on the suitability or otherwise of entering into any transaction with the borrower.</p>
10.	Major factors that were taken into account during the valuation	Please refer to Page No. 4-8 of the Report.
11.	Major factors that were not taken into account during the valuation	NA
12.	Caveats, limitations and disclaimers to the extent they explain or elucidate the limitations faced by valuer, which shall not be for the purpose of limiting his responsibility for the valuation report.	Please see attached Annexure.

**Date: 6/9/2021****Place: Noida****Signature****(Authorized Person of R.K Associates Valuers & Techno Engg. Consultants (P) Ltd.)**



**ANNEXURE: VIII- MODEL CODE OF CONDUCT FOR VALUERS****Integrity and Fairness**

1. A valuer shall, in the conduct of his/its business, follow high standards of integrity and fairness in all his/its dealings with his/its clients and other valuers.
2. A valuer shall maintain integrity by being honest, straightforward, and forthright in all professional relationships.
3. A valuer shall endeavor to ensure that he/it provides true and adequate information and shall not misrepresent any facts or situations.
4. A valuer shall refrain from being involved in any action that would bring disrepute to the profession.
5. A valuer shall keep public interest foremost while delivering his services.

**Professional Competence and Due Care**

6. A valuer shall render at all times high standards of service, exercise due diligence, ensure proper care and exercise independent professional judgment.
7. A valuer shall carry out professional services in accordance with the relevant technical and professional standards that may be specified from time to time.
8. A valuer shall continuously maintain professional knowledge and skill to provide competent professional service based on up-to-date developments in practice, prevailing regulations/guidelines and techniques.
9. In the preparation of a valuation report, the valuer shall not disclaim liability for his/its expertise or deny his/its duty of care, except to the extent that the assumptions are based on statements of fact provided by the company or its auditors or consultants or information available in public domain and not generated by the valuer.
10. A valuer shall not carry out any instruction of the client insofar as they are incompatible with the requirements of integrity, objectivity and independence.
11. A valuer shall clearly state to his client the services that he would be competent to provide and the services for which he would be relying on other valuers or professionals or for which the client can have a separate arrangement with other valuers.

**Independence and Disclosure of Interest**

12. A valuer shall act with objectivity in his/its professional dealings by ensuring that his/its decisions are made without the presence of any bias, conflict of interest, coercion, or undue influence of any party, whether directly connected to the valuation assignment or not.
13. A valuer shall not take up an assignment if he/it or any of his/its relatives or associates is not independent in terms of association to the company.
14. A valuer shall maintain complete independence in his/its professional relationships and shall conduct the valuation independent of external influences.
15. A valuer shall wherever necessary disclose to the clients, possible sources of conflicts of duties and interests, while providing unbiased services.
16. A valuer shall not deal in securities of any subject company after any time when he/it first becomes aware of the possibility of his/its association with the valuation, and in

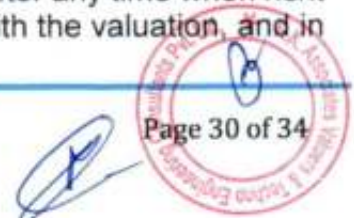



accordance with the Securities and Exchange Board of India (Prohibition of Insider Trading) Regulations, 2015 or till the time the valuation report becomes public, whichever is earlier.

17. A valuer shall not indulge in "mandate snatching or offering" convenience valuations" in order to cater to a company or client's needs.
18. As an independent valuer, the valuer shall not charge success fee.
19. In any fairness opinion or independent expert opinion submitted by a valuer, if there has been a prior engagement in an unconnected transaction, the valuer shall declare the association with the company during the last five years.

### Confidentiality

20. A valuer shall not use or divulge to other clients or any other party any confidential information about the subject company, which has come to his/its knowledge without proper and specific authority or unless there is a legal or professional right or duty to disclose.

### Information Management

21. A valuer shall ensure that he/ it maintains written contemporaneous records for any decision taken, the reasons for taking the decision, and the information and evidence in support of such decision. This shall be maintained so as to sufficiently enable a reasonable person to take a view on the appropriateness of his/its decisions and actions.
22. A valuer shall appear, co-operate and be available for inspections and investigations carried out by the authority, any person authorized by the authority, the registered valuers organization with which he/it is registered or any other statutory regulatory body.
23. A valuer shall provide all information and records as may be required by the authority, the Tribunal, Appellate Tribunal, the registered valuers organization with which he/it is registered, or any other statutory regulatory body.
24. A valuer while respecting the confidentiality of information acquired during the course of performing professional services, shall maintain proper working papers for a period of three years or such longer period as required in its contract for a specific valuation, for production before a regulatory authority or for a peer review. In the event of a pending case before the Tribunal or Appellate Tribunal, the record shall be maintained till the disposal of the case.

### Gifts and hospitality.

25. A valuer or his/its relative shall not accept gifts or hospitality which undermines or affects his independence as a valuer.

Explanation: For the purposes of this code the term 'relative' shall have the same meaning as defined in clause (77) of Section 2 of the Companies Act, 2013 (18 of 2013).

26. A valuer shall not offer gifts or hospitality or a financial or any other advantage to a public servant or any other person with a view to obtain or retain work for himself/





itself, or to obtain or retain an advantage in the conduct of profession for himself/itself.

**Remuneration and Costs.**

27. A valuer shall provide services for remuneration which is charged in a transparent manner, is a reasonable reflection of the work necessarily and properly undertaken, and is not inconsistent with the applicable rules.
28. A valuer shall not accept any fees or charges other than those which are disclosed in a written contract with the person to whom he would be rendering service.

**Occupation, employability and restrictions.**

29. A valuer shall refrain from accepting too many assignments, if he/it is unlikely to be able to devote adequate time to each of his/ its assignments.
30. A valuer shall not conduct business which in the opinion of the authority or the registered valuer organization discredits the profession.

**Miscellaneous**

31. A valuer shall refrain from undertaking to review the work of another valuer of the same client except under written orders from the bank or housing finance institutions and with knowledge of the concerned valuer.
32. A valuer shall follow this code as amended or revised from time to time

Signature of the Valuer: \_\_\_\_\_

Name of the Valuer: R.K Associates Valuers & Techno Engg. Consultants (P) Ltd.

Address of the Valuer: D-39, Sector-2, Noida-201301

Date: 6/9/2021

Place: Noida





## ENCLOSURE: IX – VALUER'S REMARKS

1.	This Valuation report is prepared based on the copies of the documents/ information which interested organization or customer could provide to us out of the standard checklist of documents sought from them and further based on our assumptions and limiting conditions. All such information provided to us has been relied upon in good faith and we have assumed that it is true and correct. Verification or cross checking of the documents provided to us from the originals has not been done at our end.
2.	Legal aspects for eg. Investigation of title, ownership rights, lien, charge, mortgage, lease, verification of documents, etc. have to be taken care by legal expert/ Advocate and same are not done at our end. It is assumed that the concerned Lender/ Financial Institution has asked for the valuation of that property for which the legal verification has been already taken and cleared by the competent Advocate before requesting for the Valuation report.
3.	Analysis and conclusions adopted in the report are limited to the reported assumptions, conditions and information came to our knowledge during the course of the work.
4.	Value varies with the Purpose/ Date/ Condition prevailing in the market. We recommend not to refer the indicative & estimated prospective Value of the asset given in this report if any of these points are different from the one mentioned aforesaid in the Report. We also recommend that the indicative estimated Value in the Valuation Report holds good only upto the period of 3 months from the date of Valuation.
5.	This report is having limited scope as per its fields & format <u>to provide only the general basic idea of the value of the property prevailing in the market</u> based on the documents/ data/ information provided by the client. The suggested indicative prospective estimated value should be considered only if transaction is happened <u>as free market transaction</u> .
6.	This Valuation report is prepared based on the facts of the property on the date of the survey. It is a well-known fact that the market value of any asset varies with time & socio-economic conditions prevailing in the country. In future property Market may go down, property conditions may change or may go worse, Property reputation may differ, Property vicinity conditions may go down or become worse, Property market may change due to impact of Govt. policies or effect of World economy, Usability prospects of the property may change, etc. Hence before financing, Banker/ FI should take into consideration all such future risk and should loan conservatively to keep the advanced money safe in case of the downward trend of the property value.
7.	Valuation of the same asset/ property can fetch different values in different situations. For eg. Valuation of a running/ operational shop/ hotel/ factory will fetch better value and in case of closed shop/ hotel/ factory it will have considerable lower value. Similarly an asset sold directly by an owner in the market will fetch better value and if the same asset/ property is sold by any financier due to encumbrance on it will fetch lower value. Hence before financing, Banker/ FI should take into consideration all such future risks and should loan conservatively to keep the advanced money safe in case of any such situation.
8.	Getting cizra map or coordination with revenue officers for site identification is not done at our end.
9.	Valuation is done for the property identified to us by the owner/ owner representative. At our end we have just cross verified the identification of the property with reference to the documents produced for perusal. Method by which identification of the property is carried out is also mentioned in the report clearly. Responsibility of identifying the correct property to the Valuer/ its authorized surveyor is solely of the client/ owner for which Valuation has to be carried out. It is requested from the Bank to cross check from their own records/ information if this is the same property for which Valuation has to be carried out to ensure that owner has not misled the Valuer company or misrepresented the property due to any vested interest.
10.	In India more than 70% of the geographical area is lying under rural/ remote/ non municipal/ unplanned area where the subject property is surrounded by vacant lands having no physical demarcation or having any display of property survey or municipal number / name plate on the property clearly. Even in old locations of towns, small cities & districts where property number is either not assigned or not displayed on the properties clearly and also due to the presence of multiple/ parallel departments due to which ownership/ rights/ illegal possession/ encroachment issues are rampant across India and due to these limitations at many occasions it becomes tough to identify the property with 100% surety from the available documents, information & site whereabouts and thus chances of error, misrepresentation by the borrower and margin of chances of error always persists in such cases. To avoid any such chances of error it is advised to the Bank to engage municipal/ revenue department officials to get the confirmation of the property to ensure that the property shown to Valuer/ Banker is the same as for which documents are provided.
11.	If this Valuation Report is prepared for the Flat/ dwelling unit situated in a Group Housing Society or Integrated Township then approvals, maps of the complete group housing society/ township is out of scope of this report and this report will be made for the specific unit based on the assumption that complete Group Housing Society/ Integrated Township must be approved in all respect.





## VALUATION ASSESSMENT

M/S. APL APOLLO TUBES LTD. | SIKANDRABAD PLANT |

12.	Due to fragmented & frequent change in building/ urban planning laws/ guidelines from time to time, different laws/ guidelines between regions/ states and no strict enforceability of Building Bye-Laws in India specially in non-metro and scale b & c cities & Industrial areas, property owners many times extend or make changes in the covered area/ layout from the approved/ applicable limits. There are also situations where properties are decades old when there was no formal Building Bye-Laws applicable when the construction must have been done. Due to such discrete/ unplanned development in many regions sometimes it becomes tough to determine the exact lawful situation on ground for the Valuer. In case nothing specific is noted on the covered built-up area considered in the Valuation Report, the covered area present on the site as per site survey will be considered in the Valuation.
13.	Valuation is a subjective field and opinion may differ from consultant to consultant. To check the right opinion, it is important to evaluate the methodology adopted and various data point/ information/ factors/ assumption considered by the consultant which became the basis for the Valuation report before reaching to any conclusion.
14.	Value analysis of any asset cannot be regarded as an exact science and the conclusions arrived at in many cases will, of necessity, be subjective and dependent on the exercise of individual judgment. Given the same set of facts and using the same assumptions, expert opinions may differ due to the number of separate judgment decisions, which have to be made. Therefore, there can be no standard formula to establish an indisputable exchange ratio. In the event of a transaction, the actual transaction value achieved may be higher or lower than our indicative analysis of value depending upon the circumstances of the transaction. The knowledge, negotiability and motivations of the buyers and sellers and the applicability of a discount or premium for control will also affect actual price achieved. Accordingly, our indicative analysis of value will not necessarily be the price at which any agreement proceeds. The final transaction price is something on which the parties themselves have to agree. However our Valuation analysis can definitely help the stakeholders to make them informed and wise decision about the Value of the asset and can help in facilitating the arm's length transaction.
15.	This report is prepared on the RKA V-L1 (Basic) Valuation format as per the client requirement and scope of work. This report is having limited scope as per its fields & format to provide only the general estimated & indicative basic idea of the value of the property prevailing in the market based on the information provided by the client. No detailed analysis, audit or verification has been carried out of the subject property.
16.	This is just an opinion report and doesn't hold any binding on anyone. It is requested from the concerned Client/ Bank/ Financial Institution which is using this report for mortgaging the property that they should consider all the different associated relevant & related factors & risks before taking any business decision based on the content of this report.
17.	All Pages of the report including annexures are signed and stamped from our office. In case any paper in the report is without stamp & signature then this should not be considered a valid paper issued from this office.
18.	Defect Liability Period is <b>30 DAYS</b> . We request the concerned authorized reader of this report to check the contents, data and calculations in the report within this period and intimate us in writing if any corrections are required or in case of any other concern with the contents or opinion mentioned in the report. Corrections only related to typographical, calculation, spelling mistakes will be entertained within the defect liability period. No request for any illegitimate value revision, date change or any other change will be entertained other than the one mentioned above.
19.	R.K Associates encourages its customers to give feedback or inform concerns over its services through proper channel at <b>valuers@rkassociates.org</b> in writing within 30 days of report delivery. After this period no concern/ complaint/ proceedings in connection with the Valuation Services can be entertained due to possible change in situation and condition of the property.
20.	Our Data retention policy is of <b>ONE YEAR</b> . After this period we remove all the concerned records related to the assignment from our repository. No clarification or query can be answered after this period due to unavailability of the data.
21.	This Valuation report is governed by our (1) Internal Policies, Processes & Standard Operating Procedures, (2) R.K Associates Quality Policy, (3) Valuation & Survey Best Practices Guidelines formulated by management of R.K Associates, (4) Information input given to us by the customer and (4) Information/ Data/ Facts given to us by our field/ office technical team. Management of R.K Associates never gives acceptance to any unethical or unprofessional practice which may affect fair, correct & impartial assessment and which is against any prevailing law. In case of any indication of any negligence, default, incorrect, misleading, misrepresentation or distortion of facts in the report then it is the responsibility of the user of this report to immediately or at least within the defect liability period bring all such act into notice of R.K Associates management so that corrective measures can be taken instantly.
22.	R.K Associates never releases any report doing alterations or modifications by pen. In case any information/ figure of this report is found altered with pen then this report will automatically become null & void.





# STATE INDUSTRIAL CORPORATION LIMITED GHAZIABAD.

PLAN OF PLOT NO. A-10

AT INDUSTRIAL AREA

SIKANDRABAD DIST. BULANDSHAHAR.

INDEX

SCALE:  $1" = 200'$  FT.

TOTAL AREA OF PLOT:	16714.06 Sq. M.
AREA OF PLOT TO BE HANDED OVER IN RED:	



PLOT No. B

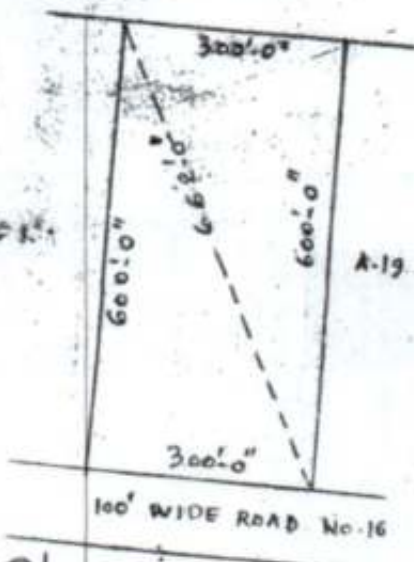

Area Manager  
UPSIDC Ltd  
Sikandrabad

For APL APOLLO TUNES LTD.

DRAWN BY: *[Signature]*  
CHECKED BY: *[Signature]*  
OVERSEER

L.A.C. ASSISTANT ENGINEER

EXECUTIVE ENGINEER



# LEASE-DEED

Industrial Area

Sikandrabad  
Bulandshahr

Plot No.

A-20

THIS LEASE-DEED made on the 21<sup>st</sup> day of July  
in the year two thousand and fourteen corresponding to Saka  
Samvat between U. P. State Industrial Development Corporation Limited,  
a Company within the meaning of the Companies Act, 1956 and having its registered office at  
A-1/4, Lakhimpur, Kanpur (hereinafter called the Lessor which expression shall, unless the context  
does not so admit, include its successors and assigns) of the one part, AND

Shri. S/o

R/o

proprietor of the single owner firm/Karta of Joint Hindu Family firm of

OR

1. Shri. aged years

S/o

R/o

2. Shri. aged years

S/o

R/o

3. Shri. aged years

S/o

R/o

4. Shri. aged years

S/o

R/o

Area Manager  
U.P.S.I.D.C Ltd  
Sikandrabad

For APLAPOUR INDUSTRIES LTD.

Auth. Signatory

5. Shri.....aged.....years

S/o.....

R/o.....

6. Shri.....aged.....years

S/o.....

R/o.....

7. Shri.....aged.....years

S/o.....

R/o.....

constituted the registered partnership firm of.....through

Shri.....aged.....years

S/o.....

R/o.....constituted

duly constituted attorney under the deed dated.....

OR

M/s APL Apollo Tubes Ltd

a company within the meaning of the Company Act, 1956 and having its registered office at  
37, Hargovind Enclave, Vikas Nagar, Delhi-92 through its ~~General~~ <sup>Managing</sup>

Director/Secretary/duly constituted attorney Shri. N.K. Malhotra

S/o. Late R. Kishori Lal

R/o. 28/54, Gal No-15, Vikas Nagar, Sahadara, Delhi-32

OR

a society registered under the Co-operative Societies Act,

M/s.....through its

Chairman/Secretary duly authorised attorney Shri.....S/o

Shri.....R/o

hereinafter called the Lessee

(which expression shall, unless the context does not so admit, include his heirs, executors,

Area Manager  
UPSIDC Ltd  
Bikanerabad

For APL APOLLO TUBES LTD

Auth. Signatory



# LEASE-DEED

Industrial Area.....*Sikondhahat*.....

Plot No.....*A-19*.....

THIS LEASE DEED made on the *24* day of *October* the year one thousand nine hundred and *Eighty Six* corresponding to Saka Samvat *1908* between U. P. State Industrial Development Corporation Limited, Kanpur a Company within the meaning of the Companies Act, 1956 and having its registered office at 117/130, Servodaya Nagar, Kanpur (hereinafter called the Lessor which expression shall, unless the context does not so admit, include its successors and assigns) of the one part, AND,

Shri.....*S/o*.....

r/o.....

proprietor of the single owner firm of/Karta of Joint Hindu family firm of.....

OR

1. Shri.....aged.....years

s/o.....r/o.....

2. Shri.....aged.....years

s/o.....r/o.....

3. Shri.....aged.....years

s/o.....r/o.....

4. Shri.....aged.....years

s/o.....r/o.....

5. Shri.....aged.....years

s/o.....r/o.....

Chief Manager  
U.P. State Industrial Development Corp. Ltd.  
GHAZIABAD

For U.P. State Industrial Development Corp. Ltd.  
*Sudesh Kumar*  
Director

( 2 )

6. Shri.....aged.....years

S/o.....

7. Shri.....aged.....years

S/o.....

Constituting the registered partnership firm of.....

through Shri.....aged.....years

S/o.....

duly constituted attorney under the deed dated.....

OR

*M/s. Bikaner Tula Private Ltd.*

a company within the meaning of the Companies Act, 1956 and having its registered office

at *2770, Ganga Nagar, Delhi-6*

through its Managing Director/Secretary duly constituted attorney *Sd/- [Signature]*

S/o *Sd/- [Signature]*

t/o *2770, Ganga Nagar, Delhi-6*

*Sd/- [Signature]* OR

a society registered under the Co-operative Societies Act, hereinafter called the Lessee (which

expression shall, unless the context does not so admit, include his heirs, executors, administrators,

representatives and permitted assigns/its successors and permitted assigns) of the other part.

WHEREAS the State of Uttar Pradesh has acquired land at *Sikar, Dist. Meerut*

under the Land Acquisition Act, 1894 and has handed over the same to U. P. State Industrial

Development Corporation Limited, Kanpur for the purpose of setting up an Industrial Area

and the said Corporation has sub-divided the above land into plots for industrial units for leasing

out such sub-divided plots to industrialists for erecting on each plot a factory according to the

factory bye-laws and building plans approved by the Lessor and, proper municipal and other

competent authorities.

AND WHEREAS the amount of premium mentioned in clause 1 hereinafter is provisional

and it is hereby agreed that the Lessee shall pay as provided in clause 2 (a) & 2 (b) the additional

premium as hereinafter mentioned.

AND WHEREAS the Lessee has requested and the Lessor has agreed to grant lease,

within the period of licence, notwithstanding the agreement cited above the plot of land

hereinafter described on the terms and conditions hereinafter appearing for the purpose of

constructing within the Industrial area *Plot No. 2, Ganga Nagar, Delhi-6* an industrial unit for manufacturing

*Handmade Paper* according to the design and building plan approved by the

proper municipal or other competent authority.

NOW THIS LEASE DEED WITNESSETH AS FOLLOWS:

1 In consideration of the payment by the Lessee of the provisional premium of

Rs. *40,000/-* (Rs. *Forty thousand only*)

the receipt whereof the Lessor hereby acknowledges and of the outstanding amount of provisional

premium of Rs. *Rs. 40,000/-* (Rs. *Forty thousand only*)

to be paid in eight/ten yearly instalments as follows along with interest @ *12%* per annum on

the total outstanding premium.

Chief Manager

U. P. State Industrial Development Corp. Ltd.

CHAZIABAD

For BIKANER TULA PVT. LTD.

*Sd/- [Signature]*

Director