

File No.	RKA/DNCR/...../.....
Date of Receiving	
File Receiver Name	

CASE COLLECTION FORM
 (Version 5.0)
 Date of implementation: 9.02.2011 | Last Revision: 30.01.2020 | Latest Revision: 31.10.2020

Items	Assigned To	Assigned to Date	To be completed by date	Submitted On date	Grade	HOD Engg. Signature
File Received By		NA	NA			
Survey						
Preparation						

A - Very Good, B - Satisfactory, C - Average, D - Poor, E - Extremely Poor

File Returned to HOD Engg. unprepared due to reason	<input type="checkbox"/> Survey not done properly, <input type="checkbox"/> Survey Form not properly filled, <input type="checkbox"/> Market survey for rates is not properly done, <input type="checkbox"/> Identification is not clearly done, <input type="checkbox"/> Measurement is not properly done, <input type="checkbox"/> Photographs not clearly taken, <input type="checkbox"/> Selfie/ Owner or owner representative photo not taken, <input type="checkbox"/> Owner/ owner representative signature not taken, <input type="checkbox"/> Google Map not taken, <input type="checkbox"/> Survey summary sheet not filled
---	---

In case File is returned by the preparer - HOD Engg. comment & Signature	<input type="checkbox"/> Minor defects in the survey hence approved for preparation with warning to Surveyor. Report preparer to collect the missing information on his own. <input type="checkbox"/> Major defects in the survey. Survey has to be done again.
--	--

GENERAL DETAILS

1. Proposal/ Work Order or Ref. No.			
2. Type of Service	<input checked="" type="checkbox"/> Valuation Report, <input type="checkbox"/> Construction cost estimate, <input type="checkbox"/> Cost vetting certificate <input type="checkbox"/> Other CE Certificates, <input type="checkbox"/> TEV Report, <input type="checkbox"/> LIE		
3. Type of customer	<input checked="" type="checkbox"/> Bank <input type="checkbox"/> Company	<input type="checkbox"/> PSU <input type="checkbox"/> Private client	<input type="checkbox"/> NBFC <input type="checkbox"/> Corporate <input type="checkbox"/> Direct client through Bank
4. Bank/ FI/ Organization Name & Address	Bank, SBI Overseas Branch, Kambur (U.P)		
5. Case Allotment Officer/ Fees paying party Details	Name	Contact Number	Email Id
6. Case Type	<input type="checkbox"/> Case for Fresh Account <input checked="" type="checkbox"/> Case for exiting account/ customer		
7. Fees Details	Amount of Fees	Advance Amount if any	Fees will be paid by
			<input type="checkbox"/> Bank <input type="checkbox"/> Customer
8. Billing Details	Billed To Party Name		GSTIN

CASE DETAILS

1.	Type of Property	Commercial & Residential		
2.	Purpose of Valuation/ Assignment	<input type="checkbox"/> Value assessment of the asset for creating new collateral mortgage <input checked="" type="checkbox"/> Periodic Re-Valuation for Bank, <input type="checkbox"/> Distress sale for NPA A/c., <input type="checkbox"/> For DRT Recovery purpose, <input type="checkbox"/> Capital Gains Wealth Tax purpose <input type="checkbox"/> Partition purpose, <input type="checkbox"/> General Value Assessment <input type="checkbox"/> Any other:		
3.	Owner/ Applicant Details	Name	Contact Number	Email Id
		Mohd. Salim		
4.	Account Name	MIS - Rustam Foods Pvt. Ltd.		
5.	Property Address	Part of Gata No. 500/1, Kasba Khampur, Mohd. Mo Pargana - Distt - Auraiya (U.P)		
6.	Who will coordinate on site for the site survey	Name	Contact Number	
		Mr. Esay.	8273878911	
7.	Preferred time of survey	Date	16/11/2021	Time
				2:53 PM.
8.	Documents Received (Any one ownership document and approved site plan/ map is must)	1. Ownership Documents: <input type="checkbox"/> Sale Deed, <input type="checkbox"/> Power of Attorney, <input type="checkbox"/> Registered Will, <input type="checkbox"/> Relinquishment Deed, <input type="checkbox"/> Transfer Deed, <input type="checkbox"/> Conveyance Deed, <input type="checkbox"/> Allotment Letter, <input type="checkbox"/> Possession Letter 2. Map: <input type="checkbox"/> Cizra Map, <input type="checkbox"/> Approved Map, <input type="checkbox"/> Site Plan 3. Utility Bills: <input type="checkbox"/> Electricity Bill & payment receipt, <input type="checkbox"/> Water Bill & payment receipt, <input type="checkbox"/> House Tax demand & payment receipt 4. Any Other document: <input type="checkbox"/> CLU, <input checked="" type="checkbox"/> TIR Report, <input type="checkbox"/> Agreement to Sale, <input type="checkbox"/> Old Valuation Report 5. No documents provided: <input type="checkbox"/>		
9.	Documents received from			
10.	Special Instructions if any:			
11.	I agree to pay the amount mentioned above for the preparation of Valuation Report. I agree that I'll not put pressure on Valuer firm to distort any facts and would not try to influence any member or official of the firm in the ill spirit or vested interest and to benefit any individual or organization by any means illegitimately. Customer Signature:			

FILE RECEIVER CASE COLLECTION PROCESS COMPLIANCE CHECKLIST*(To be filled by Surveyor)*

S.NO.	COMPLIANCE CHECKLIST	STATUS	APPROVER SIGNATURE/ REMARKS IN CASE OF ANY (X)
1.	Is Case collection Form properly filled by Receiver?	<input type="checkbox"/>	
2.	Is purpose of the assignment understood clearly by the receiver?	<input type="checkbox"/>	
3.	Has receiver checked if this is a new case or existing case of the Bank?	<input type="checkbox"/>	
4.	Has receiver fixed the fees with the manager/ client and sent quotation properly or have taken approval of the work over email?	<input type="checkbox"/>	
5.	Has receiver taken proper Work Order/ Email/ CESA form formality?	<input type="checkbox"/>	
6.	In case of private case or for fresh case 50% advance is received?	<input type="checkbox"/>	
7.	Is document checklist email sent to the customer?	<input type="checkbox"/>	
8.	Has the received documents is having 'documents provided by stamp'?	<input type="checkbox"/>	

IMPORTANT INSTRUCTIONS TO SURVEYOR

1.	Please fill the above compliance checklist before moving for the survey.
2.	Please do not do the survey if you do not have proper documents.
3.	For Vacant Plot/ Land – Cizra Map/ Master/ Zonal/ Site Plan is must to identify the Plot. For Agriculture or converted land from agriculture – Mutation documents, CLU is must.
4.	Firstly please first study the documents of the property which needs to get surveyed.
5.	Mark the Owner/ Area/ Boundaries mentioned in the ownership documents with bold florescent marker pen before moving for the survey. During site survey if any difference is found in the above fields from the ownership documents then please contact the owner immediately to know the reason for the difference.
6.	Confirm ongoing property rates in the subject location through public domain, property sites and contact dealers to show you the available properties in that area during your survey.
7.	Identify the Property clearly by matching the boundaries and area mentioned in the property papers.
8.	Do sample physical or googlemeasurements of the property.
9.	PHOTOGRAPH INSTRUCTIONS: a. Take owner/ representative photograph along with the property. b. Take your selfie along with the property and the owner/ representative. c. Take full scale photo of the property with gate. d. Take photo of the property along with abutting road, towards left, right and center. e. Take multiple photos of inside-out of the property. f. Take nearby photographs of the Property. g. Take a short video to cover property and neighborhood.
10.	Take Google Map location.
11.	Check main road name & width and approach road width and distance of property from main road.
12.	Check Jurisdiction Municipal Limits & Ward Name.
13.	Fill each column of survey form dilligently in detail and tick the appropriate option clearly.
14.	Check any defects or negativity in the property and comment in detail on survey form.
15.	Do extensive market rate enquiries and confirm for any recent past transactions.
16.	In case customer appears to be providing misleading information to you or trying to influence you by money or cash then immediately report to the Management & Bank.

GRADE	PARAMETERS/ CRITERIA
A	<p>In case all the points below are done properly, timely with full care and diligence:</p> <ol style="list-style-type: none"> 1. Survey started with proper work order and knowing the source of payment. 2. Survey done with proper documents. 3. Done complete homework and studied the documents properly with highlighting the main points before moving for the survey. 4. Chosen correct survey form as per the property type. 5. All fields of Survey form are properly filled. 6. All site special observations and negative and positive factors are clearly mentioned. 7. Self & client signatures taken on survey form. 8. Property rates information properly taken, mentioned and verified. 9. Site rough sketch plan made. 10. Proper photographs taken. 11. Selfie with property taken. 12. Selfie and owner photograph with property taken.
B	In case of 3 minor mistakes in any of the above points except Point 1, 2, 3, 4, 6, 8, 10, 11, 12 but all the points are covered.
C	In case of more than 3 minor mistakes and any 1 major mistake in any of the above points and if any points are completely missing except Point 1, 2, 3, 4, 6, 8, 10, 11, 12.
D	In case of 1 major mistake or missing of any 1 point out of 1, 2, 3, 4, 6, 8, 10, 11, 12.
E	In case of more than 1 major mistakes or missing of more than 1 point out of 1, 2, 3, 4, 6, 8, 10, 11, 12.

Note (Survey Grading Matrix):

1. For special assignments like LIE, Stock Valuation, etc. where till date survey format is not specified or released, in such cases point wise site observation report has to be submitted by the Surveyor duly signing it properly. Without signed Site Observation report, Point 4 will be considered as not done and will fall under Category E.
2. Similar Grading Matrix is issued for Case Collection & Report Preparation as well.

Note (Overall Grading Matrix):

1. In case client reports any careless mistake in the report for which revision has to be done in the report then in that case Grading Matrix may be revised and Grade E will be awarded.

SURVEY PROCESS COMPLIANCE CHECKLIST

(To be submitted by Surveyor with each Survey)

NO.	COMPLIANCE CHECKLIST POINTS	STATUS
1.	Did you take proper property documents to carry out the survey?	<input type="checkbox"/>
2.	Have you properly studied & highlighted Owner/ Area/ Boundaries in the property documents with bold florescent before moving for the survey?	<input checked="" type="checkbox"/>
3.	Did you check prominent landmark nearby the subject property and mentioned in the survey form?	<input checked="" type="checkbox"/>
4.	Did you identified the Property clearly by matching the boundaries and area mentioned in the property papers?	<input checked="" type="checkbox"/>
5.	Did you take Cizra Map/ Master/ Zonal/ Site Plan or Patwarl help to identify the vacant land/ Plot?	<input type="checkbox"/>
6.	Did you check if property is merged with any other property or it is an independent property?	<input checked="" type="checkbox"/>
7.	Did you do sample physical or google measurements of the property in case of property more than 2500 sq.mtr?	<input type="checkbox"/>
8.	Did you check municipal limits/ jurisdiction/ ward?	<input type="checkbox"/>
9.	Did you take Google Map location and shared it to Maps whatsapp group?	<input checked="" type="checkbox"/>
10.	Did you check Main road name & width and its distance from the subject property?	<input checked="" type="checkbox"/>
11.	Did you check approach Lane width on which property is located?	<input checked="" type="checkbox"/>
12.	Have you taken property full scale photograph with gate?	<input type="checkbox"/>
13.	Have you taken owner/ representative photograph with the property?	<input checked="" type="checkbox"/>
14.	Have you taken your selfie with the property along with owner/ representative?	<input checked="" type="checkbox"/>
15.	Have you taken photograph of the property along with abutting road and towards left and right of the property?	<input type="checkbox"/>
16.	Have you taken multiple photographs of the property from inside-out?	<input type="checkbox"/>
17.	Did you check nearby development and whereabouts and commented on survey form?	<input checked="" type="checkbox"/>
18.	Did you check any defects or negativity in the property in terms of location, legality, disputes, marketability, salability, etc. and commented on survey form in detail?	<input checked="" type="checkbox"/>
19.	Have you filled all the columns of survey form including survey summary sheet properly?	<input type="checkbox"/>
20.	Did you draw site key plan (location map)?	<input type="checkbox"/>
21.	Did you draw rough site sketch plan?	<input checked="" type="checkbox"/>
22.	Have you taken self-attested documents from owner/ representative and stamped "documents provided by stamp"?	<input checked="" type="checkbox"/>
23.	Did you check any defects or negativity in the property in terms of location, legality, disputes, marketability, salability, etc. and commented on survey form in detail?	<input type="checkbox"/>
24.	Have you confirmed any recent past transactions during market enquiries and enquired property rates locally very rigorously?	<input type="checkbox"/>
25.	Did you take signatures of the owner/ representative on undertaking and survey summary sheet?	<input checked="" type="checkbox"/>
26.	Did you signed the undertaking?	<input checked="" type="checkbox"/>

For File No.	
Surveyor Name	<i>Mahesh J. J. J.</i>
Signature	<i>Mahesh J. J. J.</i>
Date	16/11/2021,

VACANT LANDSURVEY FORM

(Version 5.0)

Date of implementation: 09.02.2017 | Date of Revision: 04.01.2018 | Latest Revision: 31.10.2020

File No. RKA/DNCR/...../.....

Date: 16/11/2021

Time: 2:53 PM

GENERAL DETAILS

1.	Name of the Surveyor	Mohit Singh	
2.	Property shown by	<input type="checkbox"/> Owner, <input checked="" type="checkbox"/> Representative, <input type="checkbox"/> No one was available	
		Name	Contact No.
		Ms. Egar	8273878911
3.	Survey Type	<input checked="" type="checkbox"/> Full survey (inside-out with measurements & photographs) <input type="checkbox"/> Half Survey (Measurements from outside & photographs) <input type="checkbox"/> Only photographs taken (No measurements)	
4.	Reason for Half survey or only photographs taken	<input type="checkbox"/> Property was locked, <input type="checkbox"/> Possessee didn't allow to inspect the property, <input type="checkbox"/> NPA property so couldn't be surveyed completely	
5.	How Property is Identified	<input type="checkbox"/> From schedule of the properties mentioned in the deed, <input type="checkbox"/> From name plate displayed on the property, <input checked="" type="checkbox"/> Identified by the owner/ owner representative, <input type="checkbox"/> Enquired from nearby people, <input type="checkbox"/> Identification of the property could not be done, <input type="checkbox"/> Survey was not done	
6.	Type of Land	<input checked="" type="checkbox"/> Vacant Residential Plot, <input checked="" type="checkbox"/> Commercial Plot, <input type="checkbox"/> Vacant Industrial Plot, <input type="checkbox"/> Agricultural Land, <input type="checkbox"/> Institutional Land, <input type="checkbox"/> Land for Group Housing Society, <input type="checkbox"/> Land for Hotel/ Resort, <input type="checkbox"/> Land for Farm House	
7.	Property Measurement	<input checked="" type="checkbox"/> Self-measured, <input type="checkbox"/> Sample measurement only, <input type="checkbox"/> No measurement	
8.	Reason for no measurement	<input type="checkbox"/> NPA property so didn't go near the property, <input type="checkbox"/> Land not demarcated <input type="checkbox"/> Very Large uneven land, practically not possible to measure the entire area <input type="checkbox"/> Any other Reason:	
9.	Purpose of Valuation	<input type="checkbox"/> Value assessment of the asset for creating collateral mortgage <input checked="" type="checkbox"/> Periodic Re-Valuation for Bank, <input type="checkbox"/> Distress sale for NPA A/c., <input type="checkbox"/> For DRT Recovery purpose, <input type="checkbox"/> Capital Gains Wealth Tax purpose, <input type="checkbox"/> Partition purpose, <input type="checkbox"/> General Value Assessment	
10.	Type of Loan	<input type="checkbox"/> Housing Loan, <input type="checkbox"/> Housing Take Over Loan, <input type="checkbox"/> Home Improvement Loan, <input type="checkbox"/> Loan against Property, <input type="checkbox"/> Construction Loan, <input type="checkbox"/> Educational Loan, <input type="checkbox"/> Car Loan, <input type="checkbox"/> Project Loan, <input type="checkbox"/> Term Loan, <input checked="" type="checkbox"/> CC Limit enhancement, <input type="checkbox"/> Cash Credit Limit, <input type="checkbox"/> Industrial Loan, <input type="checkbox"/> NA	
11.	Loan Amount		

OWNERSHIP DETAILS

1.	Legal Owner Name/s	Mohd. Salim S/o Hazi Gulam Kagan.
2.	Property Purchaser Name	
3.	Property Address under	Part of Gata No. 50011, Kasba Khampur.

Valuation	
4. Present Residence Address of the Owner/ Purchaser	Pargana & Distt. - Auraiya (U.P.) Kasba Khampur, Auraiya (U.P.)
5. Property constitution	<input checked="" type="checkbox"/> Free Hold, <input type="checkbox"/> Lease Hold

LOCATION DETAILS

1. Adjoining Properties <i>(Match it with papers with the help of compass or Sun direction and also confirm it with nearby people)</i>	North	South	East	West		
	अलीगढ़ सर सीलाद पविलक-रस्ता	Rasta & मन्दा हावु (साहा)	रस्ता & other plot.	Auraiya-शेरगढ़ एम रोड		
2. Property Facing	<input checked="" type="checkbox"/> East Facing, <input type="checkbox"/> North Facing, <input checked="" type="checkbox"/> West Facing, <input type="checkbox"/> South Facing, <input type="checkbox"/> North-East Facing, <input type="checkbox"/> South-West Facing, <input type="checkbox"/> South-East Facing, <input type="checkbox"/> North-West Facing					
3. Landmark	Near - Dr. Amurath Tripathi Degree College					
4. Ward Name/ No.						
5. Zone Name						
6. Main Road Name & Width and distance of the property from it	Name	Width	Distance from property			
	शेरगढ़ हावु रोड	40m	50m			
7. Approach Road Name & Width	Khampur - to shergarh Ghat Road 40m					
8. Location consideration of the Society	<input checked="" type="checkbox"/> Within Main city, <input type="checkbox"/> Within Good Urban developed Area, <input type="checkbox"/> Within developing area, <input type="checkbox"/> Highly posh locality, <input type="checkbox"/> Very Good, <input type="checkbox"/> Good, <input type="checkbox"/> Ordinary, <input type="checkbox"/> In interiors, <input type="checkbox"/> Remote area, <input type="checkbox"/> Backward, <input type="checkbox"/> Average, <input type="checkbox"/> Poor					
9. Location of the Flat	<input type="checkbox"/> Park Facing, <input type="checkbox"/> Pool Facing, <input type="checkbox"/> Road Facing, <input type="checkbox"/> Entrance North-East Facing, <input type="checkbox"/> Sunlight facing					
10. Characteristics of the Locality	<input type="checkbox"/> Urban developed, <input checked="" type="checkbox"/> Urban developing, <input type="checkbox"/> Semi Urban, <input type="checkbox"/> Rural, <input type="checkbox"/> Backward, <input type="checkbox"/> Industrial, <input type="checkbox"/> Institutional					
11. Category of Society/ Locality	<input checked="" type="checkbox"/> High End, <input type="checkbox"/> Normal, <input type="checkbox"/> Affordable Group Housing, <input type="checkbox"/> EWS, <input type="checkbox"/> HIG, <input type="checkbox"/> MIG, <input type="checkbox"/> LIG					
12. Utilities/ Facilities in the locality	<input type="checkbox"/> Lifts, <input type="checkbox"/> Garden, <input type="checkbox"/> Landscaping, <input type="checkbox"/> Swimming Pool, <input type="checkbox"/> Gym, <input type="checkbox"/> Club House, <input type="checkbox"/> Walk Trails, <input type="checkbox"/> Kids play zone, <input type="checkbox"/> 100% Power Backup					
13. Proximity to civic amenities	School	Hospital	Market	Metro	Railway Station	Airport
	50	50	1km	X	X	X
14. Any new development in surrounding area						
15. Jurisdiction limits	<input type="checkbox"/> Nagar Nigam, <input type="checkbox"/> Nagar Panchayat, <input type="checkbox"/> Gram Panchayat, <input checked="" type="checkbox"/> Nagar Palika Parishad, <input type="checkbox"/> Area not within any municipal limits					
16. Jurisdiction Development Authority Name	<input type="checkbox"/> DDA, <input type="checkbox"/> GDA, <input type="checkbox"/> NOIDA, <input type="checkbox"/> GNIDA, <input type="checkbox"/> YEIDA, <input type="checkbox"/> HUDA,					

		<input type="checkbox"/> KMDA, <input type="checkbox"/> MDDA, <input type="checkbox"/> Any other Development Authority: <input type="checkbox"/> Area not within any development authority limits
17.	Municipal Corporation Name	<input type="checkbox"/> NDMC, <input type="checkbox"/> SDMC, <input type="checkbox"/> EDMC, <input type="checkbox"/> Ghaziabad Municipal Corporation, <input type="checkbox"/> Gurgaon Municipal Corporation, <input type="checkbox"/> Faridabad Municipal Corporation, <input type="checkbox"/> Kolkata Municipal Corporation, <input type="checkbox"/> Dehradun Municipal Corporation, <input type="checkbox"/> Area not within any municipal limits, <input checked="" type="checkbox"/> Any other Municipal Corporation/ Municipality:

PHYSICAL DETAILS

1.	Land Area	As per Title deed	As per Map	As per site survey
	total 6 Sole Prop Area	3377.91 sq.m		3681.69 sq.m
2.	Any conversion to the land use			
3.	Land Type	<input checked="" type="checkbox"/> Solid, <input type="checkbox"/> Rocky, <input type="checkbox"/> Marsh Land, <input type="checkbox"/> Reclaimed Land, <input type="checkbox"/> Water logged, <input type="checkbox"/> Land locked		
4.	Shape of the Land	<input type="checkbox"/> Square, <input type="checkbox"/> Rectangular, <input type="checkbox"/> Trapezium, <input type="checkbox"/> Triangular, <input type="checkbox"/> Trapezoid, <input checked="" type="checkbox"/> Irregular, <input type="checkbox"/> Couldn't confirm since not bounded, <input type="checkbox"/> NA		
5.	Level of Land	<input checked="" type="checkbox"/> On road level, <input type="checkbox"/> Below road level, <input type="checkbox"/> Above road level, <input type="checkbox"/> NA		
6.	Frontage to depth ratio	<input checked="" type="checkbox"/> Normal frontage, <input type="checkbox"/> Less frontage, <input checked="" type="checkbox"/> Large frontage, <input type="checkbox"/> NA		
7.	Are Boundaries matched	<input checked="" type="checkbox"/> Yes, <input type="checkbox"/> No		
8.	Is Independent access available to the property?	<input checked="" type="checkbox"/> Clear independent access is available, <input type="checkbox"/> Access available in sharing of other adjoining property, <input type="checkbox"/> No clear access is available, <input type="checkbox"/> Access is closed due to dispute		
9.	Is property clearly demarcated with permanent boundaries?	<input checked="" type="checkbox"/> Yes, <input checked="" type="checkbox"/> No, <input type="checkbox"/> Only with Temporary boundaries		
10.	Is the property merged or colluded with any other property			
11.	Property currently possessed by	<input checked="" type="checkbox"/> Owner, <input type="checkbox"/> Vacant open land, <input type="checkbox"/> Lessee, <input type="checkbox"/> Under Construction, <input type="checkbox"/> Couldn't be Surveyed, <input type="checkbox"/> Property was locked, <input type="checkbox"/> Bank sealed, <input type="checkbox"/> Court sealed		
12.	Garden/ Landscaping	<input checked="" type="checkbox"/> Yes, <input type="checkbox"/> No, <input type="checkbox"/> Beautiful, <input type="checkbox"/> Ordinary		
13.	Boundary Wall (Only for individual property)	Height: 8'	Width: 9"	Finish:
14.	Guard Room	<input type="checkbox"/> Yes, <input checked="" type="checkbox"/> No, <input type="checkbox"/> Area:		
15.	Water arrangements	<input type="checkbox"/> Jet pump, <input type="checkbox"/> Submersible, <input type="checkbox"/> Jal board supply		
16.	Power connection	<input checked="" type="checkbox"/> No power line available within 5 Kms radius, <input type="checkbox"/> State owned power distribution company line available		
17.	Current activity carried out on the Land	<input checked="" type="checkbox"/> Vacant, <input type="checkbox"/> Farming, <input type="checkbox"/> Animal husbandry		
18.	Special comments if any	<p>घाघरी कॉलेज - बरेली नर Food पार्क स्थित है घाघरी के सामने डा अराबा निपाकी डिप्टी कॉलेज, सीरल बैंक, रशीदा मॉलिन्य आदि है</p>		

MARKETABILITY/ SELABILITY/ UTILITY DETAILS

Any issues in marketability of the property?	<input checked="" type="checkbox"/> Yes, <input type="checkbox"/> No	
	Reason in case of No: <input type="checkbox"/> Location, <input type="checkbox"/> Surrounding, <input type="checkbox"/> Legal aspects, <input type="checkbox"/> Demand, <input type="checkbox"/> Shape, <input type="checkbox"/> Any Other:	
2. How is Demand & Supply condition in the Market of such properties?	Demand	<input checked="" type="checkbox"/> Very Good, <input type="checkbox"/> Good, <input type="checkbox"/> Average, <input type="checkbox"/> Low, <input type="checkbox"/> Poor
	Supply	<input checked="" type="checkbox"/> Very Good, <input type="checkbox"/> Good, <input type="checkbox"/> Average, <input type="checkbox"/> Low, <input type="checkbox"/> Poor
3. Is property easily sellable & marketable?	<input checked="" type="checkbox"/> Yes, <input type="checkbox"/> No	
	Comments: On food, Bank, college Commercial Area	
4. How is the current utility of the property?	<input type="checkbox"/> Excellent, <input type="checkbox"/> Very Good, <input type="checkbox"/> Good, <input type="checkbox"/> Average, <input type="checkbox"/> Low, <input type="checkbox"/> Poor	
5. At what True rate Owner bought this Property?	Year of purchase	
	Purchase Price	

USE THIS SPACE FOR PROVIDING ANY ADDITIONAL DETAILS/ INFORMATION

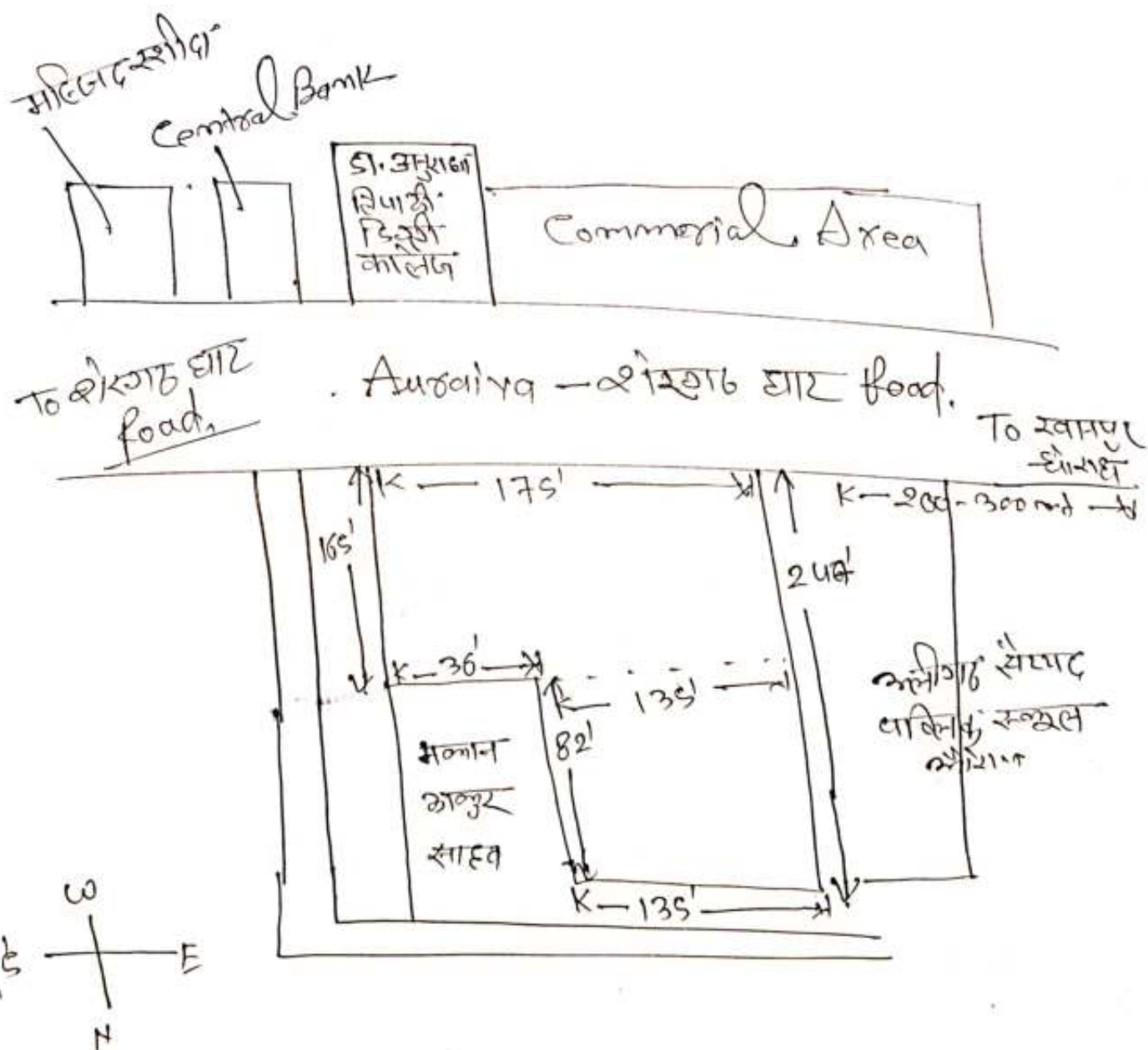

DRAW SITE KEY PLAN & SKETCH PLAN

Area As per TIR -

Grata No. 50011,

- (1) Sale Deed No. & Date,
- (2) " " "
- (3) " " "
- (4) " " "
- (5) " " "
- (6) " " "

Area
65.055 Sq.mt
815.181 Sq.mt
1463.754 Sq.mt
41.821 Sq.mt
731.877 Sq.mt
130.111 Sq.mt
130.111 Sq.mt

Total 6 TIR - Area =

3377.91 Sq.mt

As per Site measurement Area

=

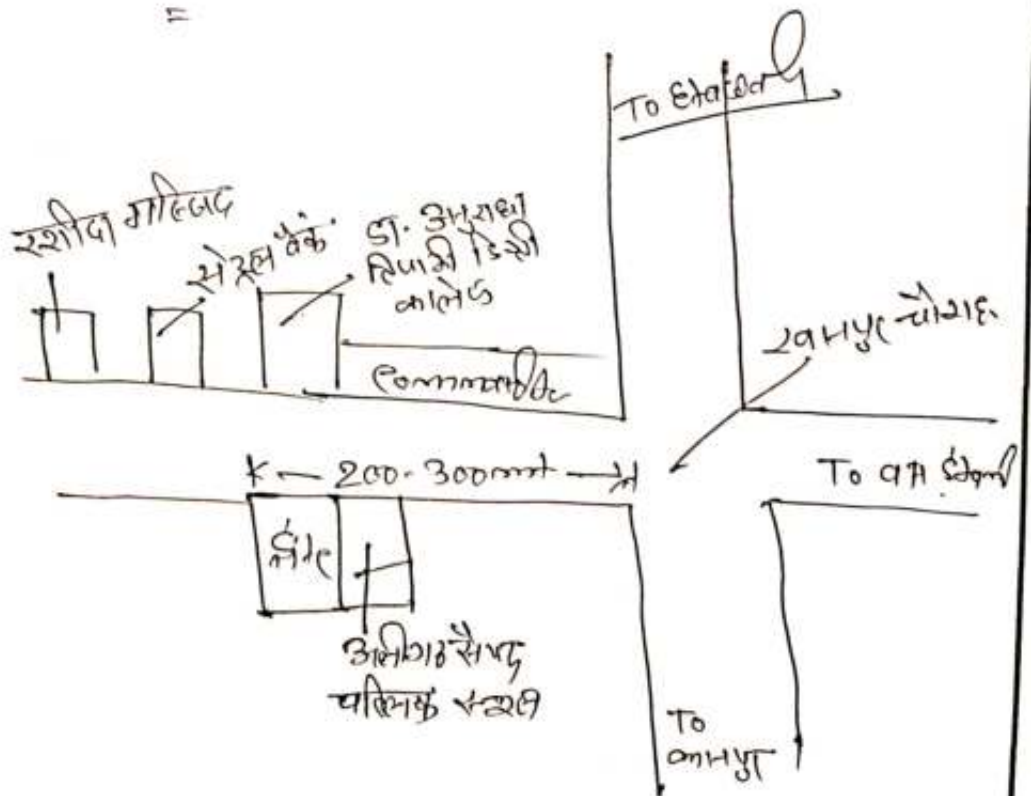

PROPERTY MARKET COMPARABLE RATE INFORMATION DETAILS

(Available for Sale or Transaction already happened in past)

No	Particulars	Subject Property	Comparable 1	Comparable 2	Comparable 3
1.	Name (source of information)	NA	श्री. श्री. श्री.		
2.	Contact No.	NA	9557541782		
3.	Type of source of information (Seller/ Property dealer/ nearby people)	NA	<u>Near People</u>		
4.	Rates/ Price informed	NA			
5.	Rates Type (Sale/ Buy)	NA			
6.	Shape of the Property (Square, Rectangular, Irregular)	<u>Irregular</u>			
7.	Area/ Size of the Property	3377.91 Sq.m ²			
8.	Legal Status (clear, negative, weak)/ No. of owners	(1)			
9.	Location/ surrounding/ neighborhood comparison with the subject property (Similar, Lower, Better, Highly Better than the subject Property)	Base Case <u>High.</u>			
10.	Distance from the subject Property	200m ²			
11.	Level of Land (Below/ On/ Above road level)	Food Level			
12.	Frontage to depth ratio (Normal, Less, Large)	Normal			
13.	Approach road width	4m ²			
14.	Present Use	only lands			
15.	Property Demarcation (Yes, No, Partly, Temporarily)	Yes.			
16.	Other factors (Corner, 2 side open, North-East facing, Park facing, Legal/ Financial encumbrance, etc.)				
17.	Any other details/ Discussion held	NA			
18.	Present expected Sale Value of the overall property?				

UNDERTAKING BY THE CUSTOMER

I confirm that I have made the inspection of the subject property to the surveyor of R.K Associates, which is correct property in question for which the documents have been provided/ submitted by me. I further confirm that I am aware of all the information related to the subject property and I have provided all its information to the surveyor true to the best of my knowledge. I understand that any false or manipulative information provided by me will be considered as cheating with the professional organization since it will lead to incorrect valuation report and I'd be solely responsible for this unlawful act and will bear the charges for the changes/modifications which have to undergo due to the false information. I also undertake that I have not given any cash or in kind to any member of R.K Associates to influence the Value of the Property or favor any individual or organization and the same is not accepted or asked by the member of R.K Associates. Any such act will lead to cancellation of the material prepared by R.K Associates with forfeiting of the fees and I'll be completely responsible for its repercussions and legal actions taken for it.

IMPORTANT: We have not authorized any of our person/ Surveyor to take Cash or kind from the customers in any situation. In case Surveyor or any member of R.K Associates asks for any money or kind from you then kindly please inform on number +91-9958632707, 0120-4110117. Our Valuation process is very stringent and have multiple check points to ensure correct & error free reports to keep the lending agency risk free. In case Surveyor claims that he would be able to arbitrary effect the Valuation figures unfairly or as per your requirement & need, then he is making a false claim to you and we request you to complaint such act immediately on the number provided above.

Name	
Relationship with owner	
Signature	
Mobile No.	
Date	

UNDERTAKING BY THE SURVEYOR

I confirm that I have carried out the Survey of the property properly as per the fair professional best practices and Valuation & Survey policy guidelines issued by R.K Associates. I have not taken any cash or kind from the customer nor have I come into any kind of influence of the customer / bank for arbitrary providing the Property Valuation as per one's need. I further state that I have not given any assurances to the customer nor given any wrong or false information or statement. In case at any point of time it is found that I have done any kind of fraudulent activity in this case and misled the company then I understand its legal consequences and appropriate penal action which company can take against me. Also in regard to it any monetary or reputation loss will be recovered from me by the company.

For File No.	
Surveyor Name	<i>Michael J. Sun</i>
Signature	<i>Michael J. Sun</i>
Date	16/11/2021

UNDERTAKING BY THE PREPARER

I confirm that this Valuation Report is prepared as per the fair professional best practices and Valuation & Survey Policy Guidelines issued by the organization. I also confirm that without any personal interest, partiality or prejudice, I have worked on this Valuation assignment. Rates adopted for the asset is based on various facts, information collected from the site came to my knowledge during the course of the assignment and I have taken all sincere efforts to review, cross check & confirm this data/ information from all different angles using my prudent approach without any biasedness or pressure. I have prepared the report based on true facts & information as per best of my knowledge & case facts. I understand that any false information provided by me will lead to the incorrect valuation report and I'd be solely responsible for it and will bear the losses which will be put on the Company in form of monetary or reputation loss by its client or statutory bodies.

I also undertake that I did not come into any influence by the customer, Bank representative (officer or agent), colleagues, coworkers or any other person to arbitrarily change the Valuation figures or facts unethically or illegitimately which may put the public money at risk which is in the form of Bank deposits.

In case at any point of time in future, if I am found guilty of illegitimately distorting the facts in the Valuation or any other professional services which company offers in the market on being influenced by the customer or Bank representative (officer or agent) or for whatsoever reason then I'd be solely responsible of any such act and I understand that the Company can take appropriate legal action against me which may include suspension from the current roles & responsibilities or termination from the employment with immediate effect.

I also undertake that I have not taken any cash, favor or in kind from the customer for favoring any individual or organization by unfair means.

I also undertake that I'll not prepare any report on incomplete Survey form which is not properly filled as per the Company guidelines and in case I am preparing it which is creating an incorrect report then I'd be responsible for its consequences.

For File No.	
Preparer Name	
Signature	
Date	