

File No.	RKA/DNCR/...../.....
Date of Receiving	12/6/22
File Receiver Name	Ravinder Singh



CASE COLLECTION FORM
(Version 5.0)
Date of Implementation: 9.02.2011 | Last Revision: 30.01.2020 | Latest Revision: 31.10.2020

Items	Assigned To	Assigned to Date	To be completed by date	Submitted On date	Grade	HOD Engg. Signature
File Received By	Ravinder Singh	NA	NA			
Survey	Ravinder Singh					
Preparation						

A - Very Good, B - Satisfactory, C - Average, D - Poor, E - Extremely Poor

File Returned to HOD Engg. unprepared due to reason	<input type="checkbox"/> Survey not done properly, <input type="checkbox"/> Survey Form not properly filled, <input type="checkbox"/> Market survey for rates is not properly done, <input type="checkbox"/> Identification is not clearly done, <input type="checkbox"/> Measurement is not properly done, <input type="checkbox"/> Photographs not clearly taken, <input type="checkbox"/> Selfie/ Owner or owner representative photo not taken, <input type="checkbox"/> Owner/ owner representative signature not taken, <input type="checkbox"/> Google Map not taken, <input type="checkbox"/> Survey summary sheet not filled
---	---

In case File is returned by the preparer - HOD Engg. comment & Signature	<input type="checkbox"/> Minor defects in the survey hence approved for preparation with warning to Surveyor. Report preparer to collect the missing information on his own. <input type="checkbox"/> Major defects in the survey. Survey has to be done again.
--	--

GENERAL DETAILS			
1.	Proposal/ Work Order or Ref. No.		
2.	Type of Service	<input checked="" type="checkbox"/> Valuation Report, <input type="checkbox"/> Construction cost estimate, <input type="checkbox"/> Cost vetting certificate <input type="checkbox"/> Other CE Certificates, <input type="checkbox"/> TE/ Report, <input type="checkbox"/> LIE	
3.	Type of customer	<input checked="" type="checkbox"/> Bank <input type="checkbox"/> PSU <input type="checkbox"/> NBFC <input type="checkbox"/> Corporate <input type="checkbox"/> Company <input type="checkbox"/> Private client <input type="checkbox"/> Direct client through Bank	
4.	Bank/ FI/ Organization Name & Address		
5.	Case Allotment Officer/ Fees paying party Details	Name Mayank Singh	Contact Number 952648 6828
6.	Case Type	<input type="checkbox"/> Case for Fresh Account <input checked="" type="checkbox"/> Case for exiting account/ customer	
7.	Fees Details	Amount of Fees 	Advance Amount if any
		Fees will be paid by <input checked="" type="checkbox"/> Bank <input type="checkbox"/> Customer	
8.	Billing Details	Billed To Party Name	GSTIN

CASE DETAILS

- Value Assessment of the asset for (real estate, business, etc.)
- ☐ For sale Re-Valuation for Bank ☐ For sale for bank
- ☐ For DRT Recovery purpose ☐ Capital Gains / Wealth Tax purpose
- ☐ Partition purpose ☐ General Value Assessment
- ☐ Any other

Owner's Name and Details

Name

Contact Number

Email Id

MR. Hazi Mohd.

Suleim / S/o Hazi Gulam Rasool

ABZ Agro Foods Limited

Plot NO. 8752-884 Min. area, 1000 sq. ft. approx.
Road, Mar. per Kali Mandir, 1000 sq. ft. approx.
Dist - Aurangabad

Who will coordinate on site for the site survey

Name

Contact Number

Ibrahim

8273878311

Preferred time of survey

Date

12/6/22

Time

3:00

Documents Received

☐ Ownership document
☐ Approved site plan/ map as per

1. Ownership Documents: ☐ Sale Deed, ☐ Power of Attorney
☐ Registered Will, ☐ Relinquishment Deed, ☐ Transfer Deed
☐ Conveyance Deed, ☐ Allotment Letter, ☐ Possession Letter
2. Map: ☐ Cizra Map, ☐ Approved Map, ☐ Site Plan
3. Utility Bills: ☐ Electricity Bill & payment receipt, ☐ Water Bill & payment receipt, ☐ House Tax demand & payment receipt
4. Any Other document: ☐ CLU, ☐ TIR Report, ☐ Agreement to Sale
☐ Old Valuation Report
5. No documents provided: ☐

Documents received from

By B.M.

Special instructions if any

NA

Customer Signature:



FILE RECEIVER CASE COLLECTION PROCESS COMPLIANCE CHECKLIST

(To be filled by Surveyor)

S.NO.	COMPLIANCE CHECKLIST	STATUS	APPROVER SIGNATURE/ REMARKS IN CASE OF ANY (X)
1.	Is Case collection Form properly filled by Receiver?	<input checked="" type="checkbox"/>	
2.	Is purpose of the assignment understood clearly by the receiver?	<input checked="" type="checkbox"/>	
3.	Has receiver checked if this is a new case or existing case of the Bank?	<input checked="" type="checkbox"/>	
4.	Has receiver fixed the fees with the manager/ client and sent quotation properly or have taken approval of the work over email?	<input checked="" type="checkbox"/>	
5.	Has receiver taken proper Work Order/ Email/ CESA form formality?	<input checked="" type="checkbox"/>	
6.	In case of private case or for fresh case 50% advance is received?	<input checked="" type="checkbox"/>	
7.	Is document checklist email sent to the customer?	<input checked="" type="checkbox"/>	
8.	Has the received documents is having 'documents provided by stamp'?	<input checked="" type="checkbox"/>	

IMPORTANT INSTRUCTIONS TO SURVEYOR

1.	Please fill the above compliance checklist before moving for the survey.
2.	Please do not do the survey if you do not have proper documents.
3.	For Vacant Plot/ Land – Cizra Map/ Master/ Zonal/ Site Plan is must to identify the Plot. For Agriculture or converted land from agriculture – Mutation documents, CLU is must.
4.	Firstly please first study the documents of the property which needs to get surveyed.
5.	Mark the Owner/ Area/ Boundaries mentioned in the ownership documents with bold florescent marker pen before moving for the survey. During site survey if any difference is found in the above fields from the ownership documents then please contact the owner immediately to know the reason for the difference.
6.	Confirm ongoing property rates in the subject location through public domain, property sites and contact dealers to show you the available properties in that area during your survey.
7.	Identify the Property clearly by matching the boundaries and area mentioned in the property papers.
8.	Do sample physical or google measurements of the property.
9.	PHOTOGRAPH INSTRUCTIONS: a. Take owner/ representative photograph along with the property. b. Take your selfie along with the property and the owner/ representative. c. Take full scale photo of the property with gate. d. Take photo of the property along with abutting road, towards left, right and center. e. Take multiple photos of inside-out of the property. f. Take nearby photographs of the Property. g. Take a short video to cover property and neighborhood.
10.	Take Google Map location.
11.	Check main road name & width and approach road width and distance of property from main road.
12.	Check Jurisdiction Municipal Limits & Ward Name.
13.	Fill each column of survey form diligently in detail and tick the appropriate option clearly.
14.	Check any defects or negativity in the property and comment in detail on survey form.
15.	Do extensive market rate enquiries and confirm for any recent past transactions.
16.	In case customer appears to be providing misleading information to you or trying to influence you by money or cash then immediately report to the Management & Bank.

SURVEY GRADING MATRIX

GRADE	PARAMETERS/ CRITERIA
A	<p>In case all the points below are done properly, timely with full care and diligence:</p> <ol style="list-style-type: none">1. Survey started with proper work order and knowing the source of payment.2. Survey done with proper documents.3. Done complete homework and studied the documents properly with highlighting the main points before moving for the survey.4. Chosen correct survey form as per the property type.5. All fields of Survey form are properly filled.6. All site special observations and negative and positive factors are clearly mentioned.7. Self & client signatures taken on survey form.8. Property rates information properly taken, mentioned and verified.9. Site rough sketch plan made.10. Proper photographs taken.11. Selfie with property taken.12. Selfie and owner photograph with property taken.
B	In case of 3 minor mistakes in any of the above points except Point 1, 2, 3, 4, 6, 8, 10, 11, 12 but all the points are covered.
C	In case of more than 3 minor mistakes and any 1 major mistake in any of the above points and if any points are completely missing except Point 1, 2, 3, 4, 6, 8, 10, 11, 12.
D	In case of 1 major mistake or missing of any 1 point out of 1, 2, 3, 4, 6, 8, 10, 11, 12.
E	In case of more than 1 major mistakes or missing of more than 1 point out of 1, 2, 3, 4, 6, 8, 10, 11, 12.

Note (Survey Grading Matrix):

1. For special assignments like LIE, Stock Valuation, etc. where till date survey format is not specified or released, in such cases point wise site observation report has to be submitted by the Surveyor duly signing it properly. Without signed Site Observation report, Point 4 will be considered as not done and will fall under Category E.
2. Similar Grading Matrix is issued for Case Collection & Report Preparation as well.

Note (Overall Grading Matrix):

1. In case client reports any careless mistake in the report for which revision has to be done in the report then in that case Grading Matrix may be revised and Grade E will be awarded.

SURVEY PROCESS COMPLIANCE CHECKLIST

(To be submitted by Surveyor with each Survey)

S.NO.	COMPLIANCE CHECKLIST POINTS	STATUS
1.	Did you take proper property documents to carry out the survey?	<input checked="" type="checkbox"/>
2.	Have you properly studied & highlighted Owner/ Area/ Boundaries in the property documents with bold florescent before moving for the survey?	<input checked="" type="checkbox"/>
3.	Did you check prominent landmark nearby the subject property and mentioned in the survey form?	<input checked="" type="checkbox"/>
4.	Did you identified the Property clearly by matching the boundaries and area mentioned in the property papers?	<input checked="" type="checkbox"/>
5.	Did you take Cizra Map/ Master/ Zonal/ Site Plan or Patwari help to identify the vacant land/ Plot?	<input checked="" type="checkbox"/>
6.	Did you check if property is merged with any other property or it is an independent property?	<input checked="" type="checkbox"/>
7.	Did you do sample physical or google measurements of the property in case of property more than 2500 sq.mtr?	<input checked="" type="checkbox"/>
8.	Did you check municipal limits/ jurisdiction/ ward?	<input checked="" type="checkbox"/>
9.	Did you take Google Map location and shared it to Maps whatsapp group?	<input checked="" type="checkbox"/>
10.	Did you check Main road name & width and its distance from the subject property?	<input checked="" type="checkbox"/>
11.	Did you check approach Lane width on which property is located?	<input checked="" type="checkbox"/>
12.	Have you taken property full scale photograph with gate?	<input checked="" type="checkbox"/>
13.	Have you taken owner/ representative photograph with the property?	<input checked="" type="checkbox"/>
14.	Have you taken your selfie with the property along with owner/ representative?	<input checked="" type="checkbox"/>
15.	Have you taken photograph of the property along with abutting road and towards left and right of the property?	<input checked="" type="checkbox"/>
16.	Have you taken multiple photographs of the property from inside-out?	<input checked="" type="checkbox"/>
17.	Did you check nearby development and whereabouts and commented on survey form?	<input checked="" type="checkbox"/>
18.	Did you check any defects or negativity in the property in terms of location, legality, disputes, marketability, salability, etc. and commented on survey form in detail?	<input checked="" type="checkbox"/>
19.	Have you filled all the columns of survey form including survey summary sheet properly?	<input checked="" type="checkbox"/>
20.	Did you draw site key plan (location map)?	<input checked="" type="checkbox"/>
21.	Did you draw rough site sketch plan?	<input checked="" type="checkbox"/>
22.	Have you taken self-attested documents from owner/ representative and stamped "documents provided by stamp"?	<input checked="" type="checkbox"/>
23.	Did you check any defects or negativity in the property in terms of location, legality, disputes, marketability, salability, etc. and commented on survey form in detail?	<input checked="" type="checkbox"/>
24.	Have you confirmed any recent past transactions during market enquiries and enquired property rates locally very rigorously?	<input checked="" type="checkbox"/>
25.	Did you take signatures of the owner/ representative on undertaking and survey summary sheet?	<input checked="" type="checkbox"/>
26.	Did you signed the undertaking?	<input checked="" type="checkbox"/>

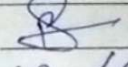
For File No.	
Surveyor Name	Ravindra Singh
Signature	
Date	12/6/22

VACANT LAND SURVEY FORM

(Version 5.0)

Date of implementation: 09.02.2017 | Date of Revision: 04.01.2018 | Latest Revision: 31.10.2020

File No. RKA/DNCR/...../.....

Date: 12/6/22

Time: 3:00

GENERAL DETAILS

1.	Name of the Surveyor	Ravindra Singh					
2.	Property shown by	<input type="checkbox"/> Owner, <input checked="" type="checkbox"/> Representative, <input type="checkbox"/> No one was available <table border="1"> <tr> <th>Name</th> <th>Contact No.</th> </tr> <tr> <td>Ishar</td> <td>8273878911</td> </tr> </table>		Name	Contact No.	Ishar	8273878911
Name	Contact No.						
Ishar	8273878911						
3.	Survey Type	<input checked="" type="checkbox"/> Full survey (inside-out with measurements & photographs) <input type="checkbox"/> Half Survey (Measurements from outside & photographs) <input type="checkbox"/> Only photographs taken (No measurements)					
4.	Reason for Half survey or only photographs taken	<input type="checkbox"/> Property was locked, <input type="checkbox"/> Possessee didn't allow to inspect the property, <input type="checkbox"/> NPA property so couldn't be surveyed completely					
5.	How Property is Identified	<input checked="" type="checkbox"/> From schedule of the properties mentioned in the deed, <input type="checkbox"/> From name plate displayed on the property, <input type="checkbox"/> Identified by the owner/ owner representative, <input type="checkbox"/> Enquired from nearby people, <input type="checkbox"/> Identification of the property could not be done, <input type="checkbox"/> Survey was not done					
6.	Type of Land	<input type="checkbox"/> Vacant Residential Plot, <input checked="" type="checkbox"/> Commercial Plot, <input type="checkbox"/> Vacant Industrial Plot, <input type="checkbox"/> Agricultural Land, <input type="checkbox"/> Institutional Land, <input type="checkbox"/> Land for Group Housing Society, <input type="checkbox"/> Land for Hotel/ Resort, <input type="checkbox"/> Land for Farm House					
7.	Property Measurement	<input checked="" type="checkbox"/> Self-measured, <input type="checkbox"/> Sample measurement only, <input type="checkbox"/> No measurement					
8.	Reason for no measurement	<input type="checkbox"/> NPA property so didn't go near the property, <input type="checkbox"/> Land not demarcated <input type="checkbox"/> Very Large uneven land, practically not possible to measure the entire area <input type="checkbox"/> Any other Reason:					
9.	Purpose of Valuation	<input type="checkbox"/> Value assessment of the asset for creating collateral mortgage <input checked="" type="checkbox"/> Periodic Re-Valuation for Bank, <input type="checkbox"/> Distress sale for NPA A/c., <input type="checkbox"/> For DRT Recovery purpose, <input type="checkbox"/> Capital Gains Wealth Tax purpose, <input type="checkbox"/> Partition purpose, <input type="checkbox"/> General Value Assessment					
10.	Type of Loan	<input type="checkbox"/> Housing Loan, <input type="checkbox"/> Housing Take Over Loan, <input type="checkbox"/> Home Improvement Loan, <input type="checkbox"/> Loan against Property, <input type="checkbox"/> Construction Loan, <input type="checkbox"/> Educational Loan, <input type="checkbox"/> Car Loan, <input type="checkbox"/> Project Loan, <input type="checkbox"/> Term Loan, <input type="checkbox"/> CC Limit enhancement, <input type="checkbox"/> Cash Credit Limit, <input type="checkbox"/> Industrial Loan, <input type="checkbox"/> NA					
11.	Loan Amount	NA					

OWNERSHIP DETAILS

1.	Legal Owner Name/s	MR. Hazi Mohd. Saleem S/o Hazi
2.	Property Purchaser Name	Gulam Rasool Same
3.	Property Address under	Akazi No-875 & 884 Min. auraiya - Kanpur Road Distt - auraiya

	Valuation	
4.	Present Residence Address of the Owner/ Purchaser	on deeds
5.	Property constitution	<input checked="" type="checkbox"/> Free Hold, <input type="checkbox"/> Lease Hold

LOCATION DETAILS							
		North	South	East	West		
1.	Adjoining Properties (Match it with papers with the help of compass or Sun direction and also confirm it with nearby people)	Field No. 9062804	Field no. 882883 885,889	auraiya Khanpur road	Field No. 851,853 8762877		
2.	Property Facing	<input type="checkbox"/> East Facing, <input type="checkbox"/> North Facing, <input type="checkbox"/> West Facing, <input type="checkbox"/> South Facing, <input type="checkbox"/> North-East Facing, <input type="checkbox"/> South-West Facing, <input type="checkbox"/> South-East Facing, <input type="checkbox"/> North-West Facing					
3.	Landmark	Dev Kali Mandir					
4.	Ward Name/ No.						
5.	Zone Name	Jalaun road					
6.	Main Road Name & Width and distance of the property from it	Name	Width	Distance from property			
		auraiya - Khanpur Khanpur - 15 feet road					
7.	Approach Road Name & Width						
8.	Location consideration of the Society	<input type="checkbox"/> Within Main city, <input type="checkbox"/> Within Good Urban developed Area, <input type="checkbox"/> <input type="checkbox"/> Within developing area, <input type="checkbox"/> Highly posh locality, <input type="checkbox"/> Very Good, <input checked="" type="checkbox"/> <input type="checkbox"/> Good, <input type="checkbox"/> Ordinary, <input type="checkbox"/> In interiors, <input type="checkbox"/> Remote area, <input type="checkbox"/> Backward, <input type="checkbox"/> Average, <input type="checkbox"/> Poor -					
9.	Location of the Flat	<input type="checkbox"/> Park Facing, <input type="checkbox"/> Pool Facing, <input type="checkbox"/> Road Facing, <input type="checkbox"/> Entrance <input type="checkbox"/> North-East Facing, <input type="checkbox"/> Sunlight facing					
10.	Characteristics of the Locality	<input type="checkbox"/> Urban developed, <input type="checkbox"/> Urban developing, <input type="checkbox"/> Semi Urban, <input type="checkbox"/> <input type="checkbox"/> Rural, <input type="checkbox"/> Backward, <input type="checkbox"/> Industrial, <input type="checkbox"/> Institutional					
11.	Category of Society/ Locality	<input checked="" type="checkbox"/> High End, <input type="checkbox"/> Normal, <input type="checkbox"/> Affordable Group Housing, <input type="checkbox"/> EWS, <input type="checkbox"/> HIG, <input type="checkbox"/> MIG, <input type="checkbox"/> LIG					
12.	Utilities/ Facilities in the locality NA	<input type="checkbox"/> Lifts, <input type="checkbox"/> Garden, <input type="checkbox"/> Landscaping, <input type="checkbox"/> Swimming Pool, <input type="checkbox"/> Gym, <input type="checkbox"/> Club House, <input type="checkbox"/> Walk Trails, <input type="checkbox"/> Kids play zone, <input type="checkbox"/> 100% Power Backup					
13.	Proximity to civic amenities	School	Hospital	Market	Metro	Railway Station	Airport
		2Km.	3Km.	3Km.	NA	5 Km.	NA
14.	Any new development in surrounding area						
15.	Jurisdiction limits	<input type="checkbox"/> Nagar Nigam, <input type="checkbox"/> Nagar Panchayat, <input checked="" type="checkbox"/> Gram Panchayat, <input type="checkbox"/> <input type="checkbox"/> Nagar Palika Parishad, <input type="checkbox"/> Area not within any municipal limits					
16.	Jurisdiction Development	<input type="checkbox"/> DDA, <input type="checkbox"/> GDA, <input type="checkbox"/> NOIDA, <input type="checkbox"/> GNIDA, <input type="checkbox"/> YEIDA, <input type="checkbox"/> HUDA,					

	Authority Name	<input type="checkbox"/> KMDA, <input type="checkbox"/> MDDA, <input type="checkbox"/> Any other Development Authority: <input type="checkbox"/> Area not within any development authority limits
17.	Municipal Corporation Name	<input type="checkbox"/> NDMC, <input type="checkbox"/> SDMC, <input type="checkbox"/> EDMC, <input type="checkbox"/> Ghaziabad Municipal Corporation, <input type="checkbox"/> Gurgaon Municipal Corporation, <input checked="" type="checkbox"/> Faridabad Municipal Corporation, <input type="checkbox"/> Kolkata Municipal Corporation, <input type="checkbox"/> Dehradun Municipal Corporation, <input type="checkbox"/> Area not within any municipal limits, <input type="checkbox"/> Any other Municipal Corporation/ Municipality:

PHYSICAL DETAILS				
		As per Title deed	As per Map	As per site survey
1.	Land Area			16550 Sq.mt 16550 Sq.mt 16550 Sq.mt
2.	Any conversion to the land use			
3.	Land Type	<input checked="" type="checkbox"/> Solid, <input type="checkbox"/> Rocky, <input type="checkbox"/> Marsh Land, <input type="checkbox"/> Reclaimed Land, <input type="checkbox"/> Water logged, <input type="checkbox"/> Land locked		
4.	Shape of the Land	<input type="checkbox"/> Square, <input type="checkbox"/> Rectangular, <input type="checkbox"/> Trapezium, <input type="checkbox"/> Triangular, <input type="checkbox"/> Trapezoid, <input type="checkbox"/> Irregular, <input type="checkbox"/> Couldn't confirm since not bounded, <input type="checkbox"/> NA		
5.	Level of Land	<input checked="" type="checkbox"/> On road level, <input type="checkbox"/> Below road level, <input type="checkbox"/> Above road level, <input type="checkbox"/> NA		
6.	Frontage to depth ratio	<input checked="" type="checkbox"/> Normal frontage, <input type="checkbox"/> Less frontage, <input type="checkbox"/> Large frontage, <input type="checkbox"/> NA		
7.	Are Boundaries matched	<input checked="" type="checkbox"/> Yes, <input type="checkbox"/> No		
8.	Is Independent access available to the property?	<input checked="" type="checkbox"/> Clear independent access is available, <input type="checkbox"/> Access available in sharing of other adjoining property, <input type="checkbox"/> No clear access is available, <input type="checkbox"/> Access is closed due to dispute		
9.	Is property clearly demarcated with permanent boundaries?	<input checked="" type="checkbox"/> Yes, <input checked="" type="checkbox"/> No, <input type="checkbox"/> Only with Temporary boundaries		
10.	Is the property merged or colluded with any other property			
11.	Property currently possessed by	<input checked="" type="checkbox"/> Owner, <input type="checkbox"/> Vacant open land, <input type="checkbox"/> Lessee, <input type="checkbox"/> Under Construction, <input type="checkbox"/> Couldn't be Surveyed, <input type="checkbox"/> Property was locked, <input type="checkbox"/> Bank sealed, <input type="checkbox"/> Court sealed		
12.	Garden/ Landscaping	<input type="checkbox"/> Yes, <input type="checkbox"/> No, <input type="checkbox"/> Beautiful, <input type="checkbox"/> Ordinary		
13.	Boundary Wall (Only for individual property)	Height:	Width:	Finish:
14.	Guard Room	<input checked="" type="checkbox"/> Yes, <input type="checkbox"/> No, <input type="checkbox"/> Area:		
15.	Water arrangements	<input type="checkbox"/> Jet pump, <input type="checkbox"/> Submersible, <input type="checkbox"/> Jal board supply		
16.	Power connection	<input type="checkbox"/> No power line available within 5 Kms radius, <input type="checkbox"/> State owned power distribution company line available		
17.	Current activity carried out on the Land	<input type="checkbox"/> Vacant, <input type="checkbox"/> Farming, <input type="checkbox"/> Animal husbandry		
18.	Special comments if any	NA		

MARKETABILITY/ SELABILITY/ UTILITY DETAILS						
1.	Any issues in marketability of the property?	<input type="checkbox"/> Yes, <input checked="" type="checkbox"/> No Reason in case of No: <input type="checkbox"/> Location, <input type="checkbox"/> Surrounding, <input type="checkbox"/> Legal aspects, <input type="checkbox"/> Demand, <input type="checkbox"/> Shape, <input type="checkbox"/> Any Other:				
2.	How is Demand & Supply condition in the Market of such properties?	<table border="1"> <tr> <td>Demand</td> <td><input checked="" type="checkbox"/> Very Good, <input type="checkbox"/> Good, <input type="checkbox"/> Average, <input type="checkbox"/> Low, <input type="checkbox"/> Poor</td> </tr> <tr> <td>Supply</td> <td><input type="checkbox"/> Very Good, <input type="checkbox"/> Good, <input type="checkbox"/> Average, <input type="checkbox"/> Low, <input type="checkbox"/> Poor</td> </tr> </table>	Demand	<input checked="" type="checkbox"/> Very Good, <input type="checkbox"/> Good, <input type="checkbox"/> Average, <input type="checkbox"/> Low, <input type="checkbox"/> Poor	Supply	<input type="checkbox"/> Very Good, <input type="checkbox"/> Good, <input type="checkbox"/> Average, <input type="checkbox"/> Low, <input type="checkbox"/> Poor
Demand	<input checked="" type="checkbox"/> Very Good, <input type="checkbox"/> Good, <input type="checkbox"/> Average, <input type="checkbox"/> Low, <input type="checkbox"/> Poor					
Supply	<input type="checkbox"/> Very Good, <input type="checkbox"/> Good, <input type="checkbox"/> Average, <input type="checkbox"/> Low, <input type="checkbox"/> Poor					
3.	Is property easily sellable & marketable?	<input type="checkbox"/> Yes, <input type="checkbox"/> No Comments:				
4.	How is the current utility of the property?	<input type="checkbox"/> Excellent, <input checked="" type="checkbox"/> Very Good, <input type="checkbox"/> Good, <input type="checkbox"/> Average, <input type="checkbox"/> Low, <input type="checkbox"/> Poor				
5.	At what True rate Owner bought this Property?	<table border="1"> <tr> <td>Year of purchase</td> <td></td> </tr> <tr> <td>Purchase Price</td> <td></td> </tr> </table>	Year of purchase		Purchase Price	
Year of purchase						
Purchase Price						

USE THIS SPACE FOR PROVIDING ANY ADDITIONAL DETAILS/ INFORMATION

DRAW SITE KEY PLAN & SKETCH PLAN

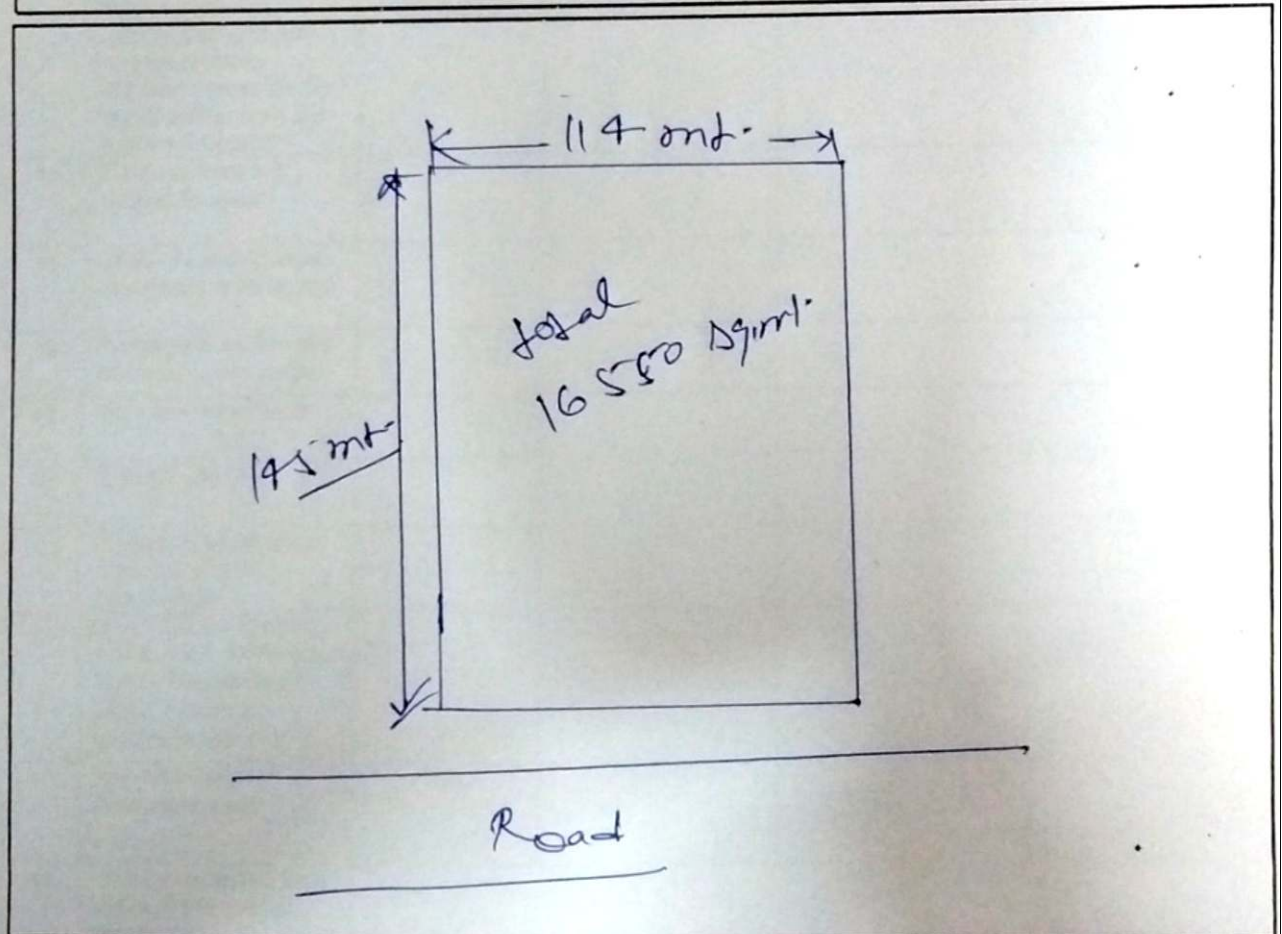
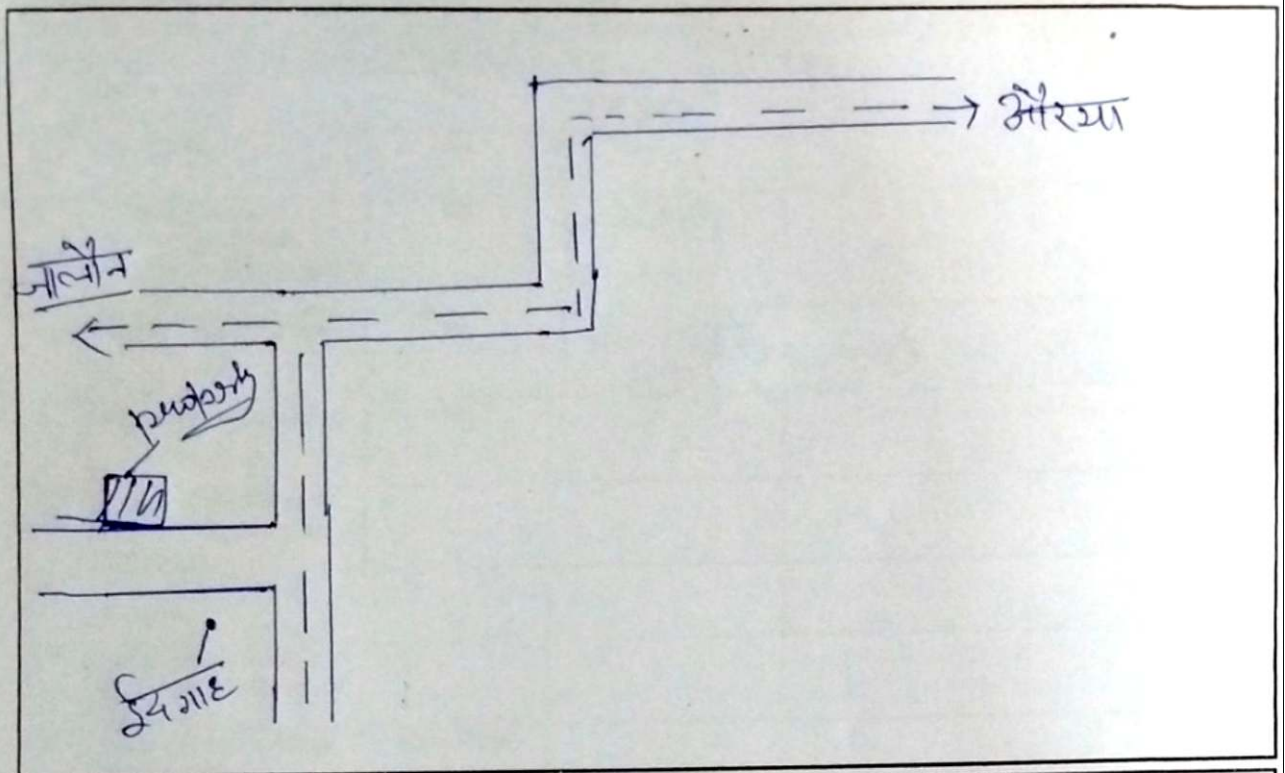

PROPERTY MARKET COMPARABLE RATE INFORMATION DETAILS

(Available for Sale or Transaction already happened in past)

S.No	Particulars	Subject Property	Comparable 1	Comparable 2	Comparable 3
1.	Name (source of information)	NA	1st floor		
2.	Contact No.	NA			
3.	Type of source of information (Seller/ Property dealer/ nearby people)	NA	Property Rate		
4.	Rates/ Price informed	NA	827387 8911 (11,500)		
5.	Rates Type (Sale/ Buy)	NA			
6.	Shape of the Property (Square, Rectangular, Irregular)				
7.	Area/ Size of the Property				
8.	Legal Status (clear, negative, weak)/ No. of owners				
9.	Location/ surrounding/ neighborhood comparison with the subject property (Similar, Lower, Better, Highly Better than the subject Property)	Base Case			
10.	Distance from the subject Property	0			
11.	Level of Land (Below/ On/ Above road level)				
12.	Frontage to depth ratio (Normal, Less, Large)				
13.	Approach road width				
14.	Present Use				
15.	Property Demarcation (Yes, No, Partly, Temporarily)				
16.	Other factors (Corner, 2 side open, North-East facing, Park facing, Legal/ Financial encumbrance, etc.)				
17.	Any other details/ Discussion held	NA			
18.	Present expected Sale Value of the overall property?				

UNDERTAKING BY THE CUSTOMER

I confirm that I have made the inspection of the subject property to the surveyor of R.K. Associates, which is the property in question for which the documents have been provided/ submitted by me. I further confirm that I have provided all the information related to the subject property and I have provided all its information to the surveyor to the best of my knowledge. I understand that any false or manipulative information provided by me will be considered as cheating with the professional organization since it will lead to incorrect valuation report and I'll be solely responsible for this unlawful act and will bear the charges for the changes/ modifications which have to undergo due to the false information. I also undertake that I have not given any cash or in kind to any member of R.K. Associates to influence the Value of the Property or favor any individual or organization and the same is not accepted or asked by the member of R.K. Associates. Any such act will lead to cancellation of the material prepared by R.K. Associates with forfeiting of the fees and I'll be completely responsible for its repercussions and legal actions taken for it.

IMPORTANT: We have not authorized any of our person/ Surveyor to take Cash or kind from the customers in any situation. In case Surveyor or any member of R.K. Associates asks for any money or kind from you then kindly please inform on number +91-9958632707, 0120-4110117. Our Valuation process is very stringent and we have multiple check points to ensure correct & error free reports to keep the lending agency risk free. In case Surveyor claims that he would be able to arbitrary effect the Valuation figures unfairly or as per your requirement & need, then he is making a false claim to you and we request you to complaint such act immediately on the number provided above.

Name	
Relationship with owner	Employee
Signature	<i>[Signature]</i>
Mobile No.	9273878911
Date	12/6/22

UNDERTAKING BY THE SURVEYOR

I confirm that I have carried out the Survey of the property properly as per the fair professional best practices and Valuation & Survey policy guidelines issued by R.K. Associates. I have not taken any cash or kind from the customer nor have I come into any kind of influence of the customer / bank for arbitrary providing the Property Valuation as per one's need. I further state that I have not given any assurances to the customer nor given any wrong or false information or statement. In case at any point of time it is found that I have done any kind of fraudulent activity in this case and misled the company then I understand its legal consequences and appropriate penal action which company can take against me. Also in regard to it any monetary or reputation loss will be recovered from me by the company.

For File No.	
Surveyor Name	Ravinder Singh
Signature	<i>[Signature]</i>
Date	12/6/22

UNDERTAKING BY THE PREPARER

I confirm that this Valuation Report is prepared as per the fair professional best practices and Valuation & Survey Policy Guidelines issued by the organization. I also confirm that without any personal interest, partiality or prejudice, I have worked on this Valuation assignment. Rates adopted for the asset is based on various facts, information collected from the site came to my knowledge during the course of the assignment and I have taken all sincere efforts to review, cross check & confirm this data/ information from all different angles using my prudent approach without any biasedness or pressure. I have prepared the report based on true facts & information as per best of my knowledge & case facts. I understand that any false information provided by me will lead to the incorrect valuation report and I'd be solely responsible for it and will bear the losses which will be put on the Company in form of monetary or reputation loss by its client or statutory bodies.

I also undertake that I did not come into any influence by the customer, Bank representative (officer or agent), colleagues, coworkers or any other person to arbitrary change the Valuation figures or facts unethically or illegitimately which may put the public money at risk which is in the form of Bank deposits.

In case at any point of time in future, if I am found guilty of illegitimately distorting the facts in the Valuation or any other professional services which company offers in the market on being influenced by the customer or Bank representative (officer or agent) or for whatsoever reason then I'd solely responsible of any such act and I understand that the Company can take appropriate legal action against me which may include suspension from the current roles & responsibilities or termination from the employment with immediate effect.

I also undertake that I have not taken any cash, favor or in kind from the customer for favoring any individual or organization by unfair means.

I also undertake that I'll not prepare any report on incomplete Survey form which is not properly filled as per the Company guidelines and in case I am preparing it which is creating an incorrect report then I'd be responsible for its consequences.

For File No.	
Preparer Name	
Signature	
Date	