

SCHEDULE OF DOOR & WINDOW		REMARKS
NO.	DESCRIPTION	
01	1200 x 2100	
02	1200 x 2100	
03	1200 x 2100	
04	1200 x 2100	
05	1200 x 2100	
06	1200 x 2100	
07	1200 x 2100	
08	1200 x 2100	
09	1200 x 2100	
10	1200 x 2100	
11	1200 x 2100	
12	1200 x 2100	
13	1200 x 2100	
14	1200 x 2100	
15	1200 x 2100	
16	1200 x 2100	
17	1200 x 2100	
18	1200 x 2100	
19	1200 x 2100	
20	1200 x 2100	

SPECIFICATIONS :-

1. FOR SPECIFICATION OF MATERIALS & WORKMANSHIP FOLLOW N.B.C. 1984.
2. GRADE OF CONC IS M-15 & GRADE OF STEEL IS Fe 415.
3. GRADE OF CONC IS M-15 & GRADE OF STEEL IS Fe 415.
4. GRADE OF CONC IS M-15 & GRADE OF STEEL IS Fe 415.
5. GRADE OF CONC IS M-15 & GRADE OF STEEL IS Fe 415.
6. GRADE OF CONC IS M-15 & GRADE OF STEEL IS Fe 415.
7. GRADE OF CONC IS M-15 & GRADE OF STEEL IS Fe 415.
8. GRADE OF CONC IS M-15 & GRADE OF STEEL IS Fe 415.
9. GRADE OF CONC IS M-15 & GRADE OF STEEL IS Fe 415.
10. GRADE OF CONC IS M-15 & GRADE OF STEEL IS Fe 415.
11. GRADE OF CONC IS M-15 & GRADE OF STEEL IS Fe 415.
12. GRADE OF CONC IS M-15 & GRADE OF STEEL IS Fe 415.
13. GRADE OF CONC IS M-15 & GRADE OF STEEL IS Fe 415.
14. GRADE OF CONC IS M-15 & GRADE OF STEEL IS Fe 415.
15. GRADE OF CONC IS M-15 & GRADE OF STEEL IS Fe 415.
16. GRADE OF CONC IS M-15 & GRADE OF STEEL IS Fe 415.
17. GRADE OF CONC IS M-15 & GRADE OF STEEL IS Fe 415.
18. GRADE OF CONC IS M-15 & GRADE OF STEEL IS Fe 415.
19. GRADE OF CONC IS M-15 & GRADE OF STEEL IS Fe 415.
20. GRADE OF CONC IS M-15 & GRADE OF STEEL IS Fe 415.

NOTES :-

1. ALL DIMENSIONS ARE IN MM. IF NOT STATED OTHERWISE.
2. FOLLOW WRITTEN DIMENSIONS ONLY.
3. ALL EXTERNAL WALLS ARE 250 TH & INTERNAL WALL ARE 125 TH. IF NOT STATED OTHERWISE.
4. DEPTH OF SUB RESERVOIR SHOULD NOT EXCEED THE DEPTH OF THE FOUNDATION OF MAIN BUILDING.

CERTIFICATE :-

I DO CERTIFY WITH FULL RESPONSIBILITY THAT THE BUILDING PLAN HAS BEEN DRAWN UP AS PER PROVISION OF C.M.C. BUILDING RULE 1997 HAS AMENDED TIME TO TIME AND THAT THE SITE CONDITIONS INCLUDING THE WIDTH OF ABUTTING ROAD CONFIRM WITH THE PLAN AND THAT IS A BUILDABLE SITE AND NOT A TANK OR FILLED UP LAND. THE BOUNDARY OF PLOT DOES SATISFY PHYSICALLY WITH THE SUBMITTED PLAN AND DOCUMENTS. ROAD WIDTH IN FRONT OF THE PREMISES ALSO PHYSICALLY ALSO AGREES WITH DOCUMENTS & PLAN. THE EXISTING STRUCTURE IS OCCUPIED BY THE OWNER AND THERE IS NO TENANT THERE IS FOOT PATH IN FRONT OF THE PREMISES.

SIG. OF ARCHITECT :-

STRUCTURAL CERTIFICATE :-

THE STRUCTURAL DESIGN & DRAWINGS OF BOTH FOUNDATION AND SUPER STRUCTURE OF THE BUILDING HAS BEEN MADE BY ME CONSIDERING ALL POSSIBLE LOADS INCLUDING THE SEISMIC LOAD AS PER THE N.B.C. OF INDIA & CERTIFIED THAT IT IS SAFE AND STABLE IN ALL RESPECT.

SIG. OF STRUCTURAL ENGG. :-

B.B.D-1/40

Chief Medical Officer

COMPLETION PLAN OF PRE NO 31 SHAKESPEARE SARAI WITH REFERENCE TO B.S PERMIT NO 155 (B-VII) DATED 7.10.94 AND SUBSEQUENTLY REGULARISED U/S RULE 2 DATED 29.6.98 AND U/S 402 DATED 2.12.99.

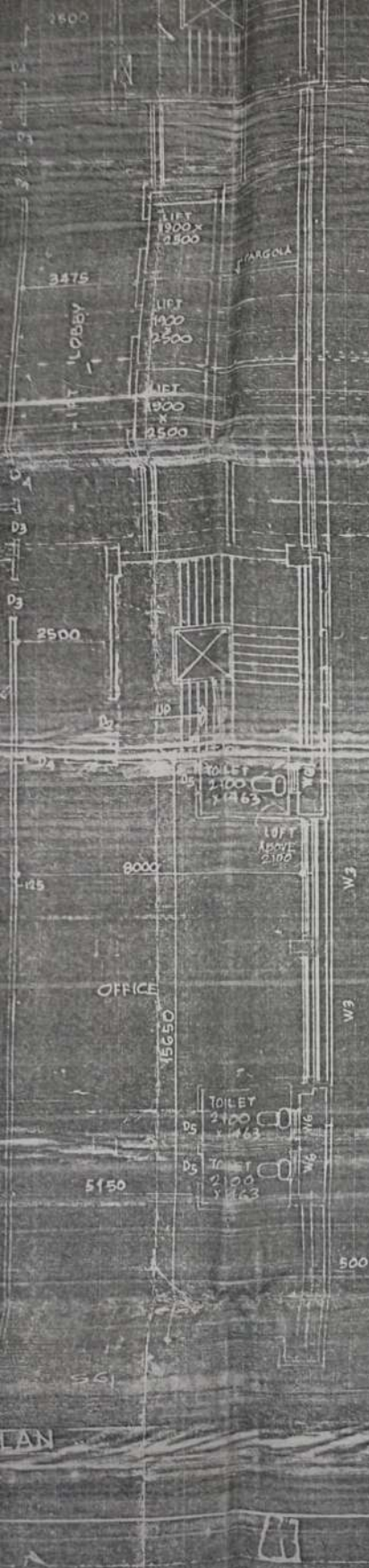

DEPTH OF SUG. RESERVOIR SHOULD NOT EXCEED THE DEPTH OF THE FOUNDATION OF MAIN BUILDING.

CERTIFICATE :-

I DO CERTIFY WITH FULL RESPONSIBILITY THAT THE BUILDING PLAN HAS BEEN DRAWN UP AS PER PROVISION OF C.M.C. BUILDING-RULE 1999 HAS AMENDED TIME TO TIME AND THAT THE SITE CONDITION INCLUDING THE WIDTH OF ABUTTING ROAD CONFIRM WITH THE PLAN AND THAT IS A BUILDABLE SITE AND NOT A TANK OR FILLED UP LAND. THE BOUNDARY OF PLOT DOES SATISFY PHYSICALLY WITH THE SUBMITTED PLAN AND DOCUMENTS. ROAD WIDTH IN FRONT OF THE PREMISES ALSO PHYSICALLY ALSO AGREES WITH DOCUMENTS & PLAN. THE EXISTING STRUCTURE IS OCCUPIED BY THE OWNER AND THERE IS NO TENANT THERE IS FOOT PATH IN FRONT OF THE PREMISES.

SIG. OF ARCHITECT.

STRUCTURAL CERTIFICATE :-

THE STRUCTURAL DESIGN & DRAWINGS OF BOTH FOUND AND SUPER STRUCTURE OF THE BUILDING HAS BEEN MADE BY ME CONSIDERING ALL POSSIBLE LOADS INCLUDING THE SEISMIC LOAD AS PER THE M.B.C. OF INDIA & CERTIFIED THAT IT IS SAFE AND STABLE IN ALL RESPECT.

SIG. OF STRUCTURAL ENGG. :-

COMPLETION PLAN OF PRE NO 31 SHAKESPEARE SARANI WITH REFERENCE TO B.S PERMIT NO 155 (B-VII) DATED 7.10.94 AND SUBSEQUENTLY REGULARISED U/S RULE 25 DATED 29.6.98 AND U/S 402 DATED 2.12.99

SIG. OF OWNER

SIG. OF ARCHITECT.

**PROPOSED ADDITION AND ALTERATION
AT 31, SHAKESPEARE SARANI,
CALCUTTA**

CONSULTANTS INDIA
15A CHITLA HUL ROAD
CALCUTTA - 700001
ARCHITECTS-ENGRS-PLNRS

11-10-54

Dated.....
Building Permit No. 155(A-2)
Date. 07. 10. 1994
Borough No. -7

NEW OTT ABBOTTOTTI
NO. 100 1
30 MAY 2000
FOR THE OTT ABBOTTOTTI