



ग्राहक की खुशी के लिए प्रतिबद्ध  
Committed to Customers' Delight

नेशनल बिल्डिंग्स कन्स्ट्रक्शन कार्पोरेशन लिमिटेड  
(भारत सरकार का उद्यम)

NATIONAL BUILDINGS CONSTRUCTION CORPORATION LIMITED  
(A Government of India Enterprise)



An IS/ISO 9001  
Company  
(For Consultancy &  
Project Management Division)

No.NBCC/RE/Pushp Vihar/2007/ 1306

16.8.07

The Managing Director,  
Consolidated Construction Consortium Ltd.,  
No.5, IInd Link street,  
CIT Colony, Mycapore,  
Chennai-600004  
Fax No.044-24990225

Kind Attention : Sh  
.S.Sivaramakrishnan

Sub: Allotment of built up space at (Lot No.VI) at 3<sup>rd</sup> floor measuring 9467 sft i.e.  
2<sup>nd</sup> floor Plate from West Side of NBCC Plaza, Pushp Vihar, New Delhi.

Ref: Your offer dated 14.08.07 for purchase of built up space vide NIT  
No.NBCC/RE/2007/27

Dear Sir,

This is to inform you that NBCC has accepted your offer for purchase of built up space at 3<sup>rd</sup> floor (Lot No.VI), i.e. 2<sup>nd</sup> floor plate from west side of building measuring 9467 sft at NBCC Plaza, Pushp Vihar, New Delhi for Rs.16,89,32,615.00 (Rupees Sixteen Crores Eighty Nine Lacs Thirty Two Thousand Six Hundred and Fifteen only) vide our NIT No.NBCC/RE/2007/27. You have deposited Rs.4,22,34,654/- (Rupees Four Crores Twenty Two Lacs Thirty Four Thousand Six Hundred and Fifty Four only) as EMD i.e. against 25% of the bid amount with NBCC through demand drafts alongwith the tender document.

You are requested to deposit balance 75% of the bid amount within 90 (Ninety) days of the date of booking by you i.e. latest upto 14.11.2007. In addition to the bid amount, you are required to pay allied charges as per terms of the tender document. The total amount payable by you is as under:

S.No.	Description	Amount payable in Rupees
1	Bid Amount	16,89,32,615.00
2	Advance maintenance charges for one quarter (applicable from date of letter of physical possession) @ Rs.20/- per sq.ft.per month	5,68,020.00
3	Total Amount Payable	16,95,06,635.00
4	Less paid as EMD	4,22,34,654.00
5	Balance amount payable	12,72,71,981.00

Other allied charges as per terms of tender documents shall also be charged to you. You may sign the agreement to sell with NBCC for this sale at any time in our office.

Thanking you,

Yours faithfully,

( V.K.Rustogi )  
General Manager (RE)

REAL ESTATE DIVISION

दूरभाष / Tel.: 91-11-24365326/32010506 Extn.-1501  
E-mail : re1.nbcc@nic.in

CORPORATE OFFICE

एनबीसीसी भवन, लोधी रोड, नई दिल्ली-110003

NBCC Bhawan, Lodhi Road, New Delhi-110003

दूरभाष ईपीएबीएक्स / Tel.: EPABX : 24367314-5, फैक्स / Fax : 91-11-24366995

Website : www.nbccindia.gov.in

NBCC HAS  
ZERO TOLERANCE  
FOR CORRUPTION!

Pl send a copy to  
H.O. -  
VMS to be -  
Shri Ngr - 11  
16/8

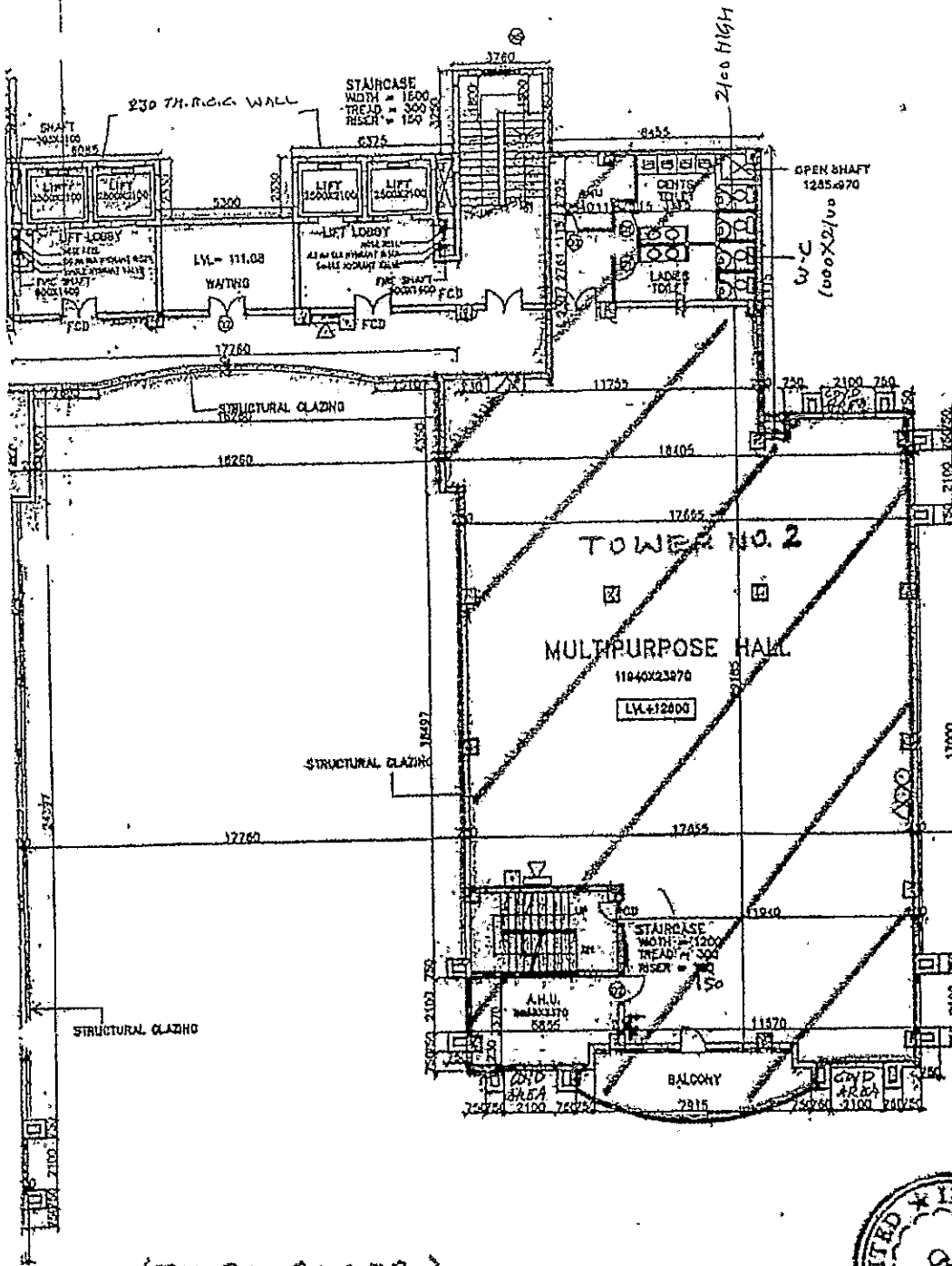

(THIRD FLOOR)  
West side



PROVIDED

PERSONS	GENTS		LADIES		GENTS
LOCATION	W.C.	WASH BASIN	URINAL	W.C.	WASH BASIN



*Rh*  
13/8/2015  
(R. Ravindarayan)