

O2 Chemicals Private Limited

Scale 16"=1 Mile

100KLPD Grain based Ethanol Plant with

2.5 mw Power Plant.

Name Of Company - O2 Chemicals Private Limited.

In Mouza Loharapara, JL No. 111,

P.S. - Suti, Dist - Murshidabad.

Area - 20.4557 ACRE



NOT TO SCALE

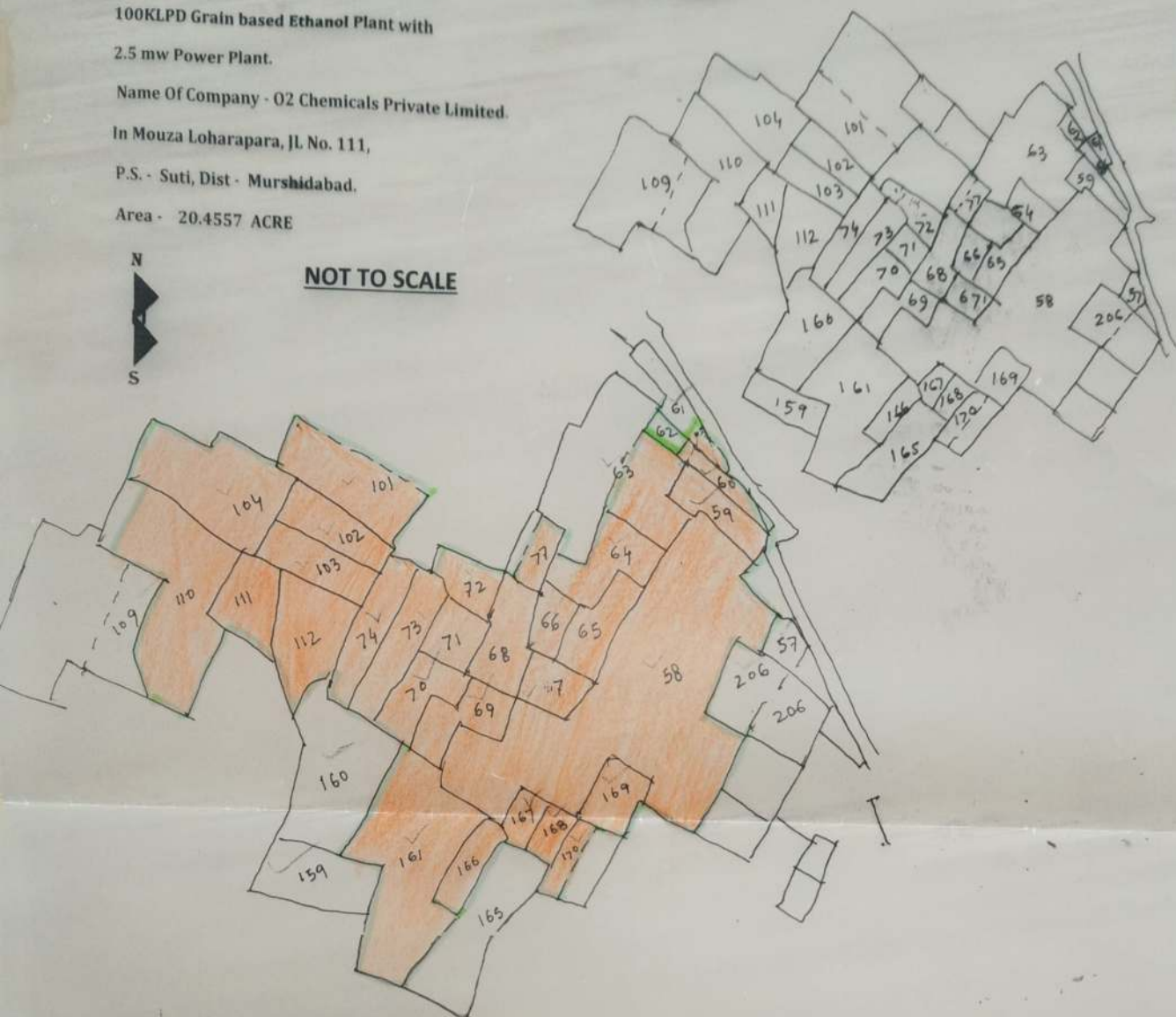

LAND SHEDULE FOR CONVERSION

| PLOT NO. | AREA IN ACRE | PLOT NO. | AREA IN ACRE |
|----------|--------------|----------|--------------|
| 74 | 0.6 | 77 | 0.2025 |
| 58 | 5.12 | 101 | 1.44 |
| 59 | 0.42 | 102 | 0.54 |
| 60 | 0.19 | 103 | 0.56 |
| 61 | 0.08 | 104 | 1.42 |
| 63 | 0.603 | | |
| 64 | 0.35 | 110 | 1.7308 |
| 65 | 0.44 | 111 | 0.47 |
| 66 | 0.29 | 112 | 0.79 |
| 67 | 0.28 | | |
| 68 | 0.57 | | |
| 69 | 0.31995 | 161 | 1.43 |
| 70 | 0.46 | 167 | 0.24 |
| 71 | 0.11445 | 168 | 0.23 |
| 72 | 0.33 | 169 | 0.41 |
| 73 | 0.58 | 170 | 0.245 |

10.7474

9.7083

TOTAL > 20.4557

REFERENCE

| | |
|---------------------------|--|
| SITE FOR PROJECT AREA | |
| PLOT NO. FOR PROJECT AREA | |
| AREA FOR PROJECT AREA | |

PREPARED BY -

S. R. Baidya
SURVEYOR
LOKHATH SURVEY CENTRE
Ward No. 1, Rajshahi, Dhaka

Regd No 1680107004