

REPORT FORMAT: V-L4 (RKA - Medium) | Version: 11.0_2022

CASE NO.: VIS (2023-24)-PL341-Q073-283-451

DATED: 11/09/2023

VALUATION REPORT

OF

NATURE OF ASSETS	BUILT-UP UNIT
CATEGORY OF ASSETS	COMMERCIAL
TYPE OF ASSETS	COMMERCIAL FLOOR UNIT

SITUATED AT
PLOT NO. 3, BLOCK K, BRAHM DATT TOWER, SECTOR-18, NOIDA, G.B.
NAGAR, UTTAR PRADESH, 201301

- Corporate Valuers
- Business/ Enterprise/ Equity Valuations
- Lender's Independent Engineers (LIE)
- Techno Economic Viability Consultants (TEV)
- Agency for Specialized Account Monitoring (ASM)
- Project Techno-Financial Advisers
- Chartered Engineers
- Industry/ Trade Rehabilitation Consultants
- NPA Management
- Panel Valuer & Techno Economic Consultants for PSU Banks

Report Prepared For
SH. RAMESH KUMAR SUNEJA

*Important - In case of any query/ issue/ concern or escalation you may please contact Incident Manager @
valuers@rkassociates.org. We will appreciate your feedback in order to improve our services.*

*NOTE: As per IBA Guidelines please provide your feedback on the report within 15 days of its submission after which
report will be considered to be accepted & correct.*

Valuation Terms of Services & Valuer's Important Remarks are available at www.rkassociates.org for reference.

CORPORATE OFFICE:

D-39, 2nd floor, Sector 2, Noida-201301

Ph - +91-0120-4110117, 4324647, +91 - 9958632707

E-mail - valuers@rkassociates.org | Website: www.rkassociates.org

PART A

SNAPSHOT OF THE ASSET/ PROPERTY UNDER VALUATION

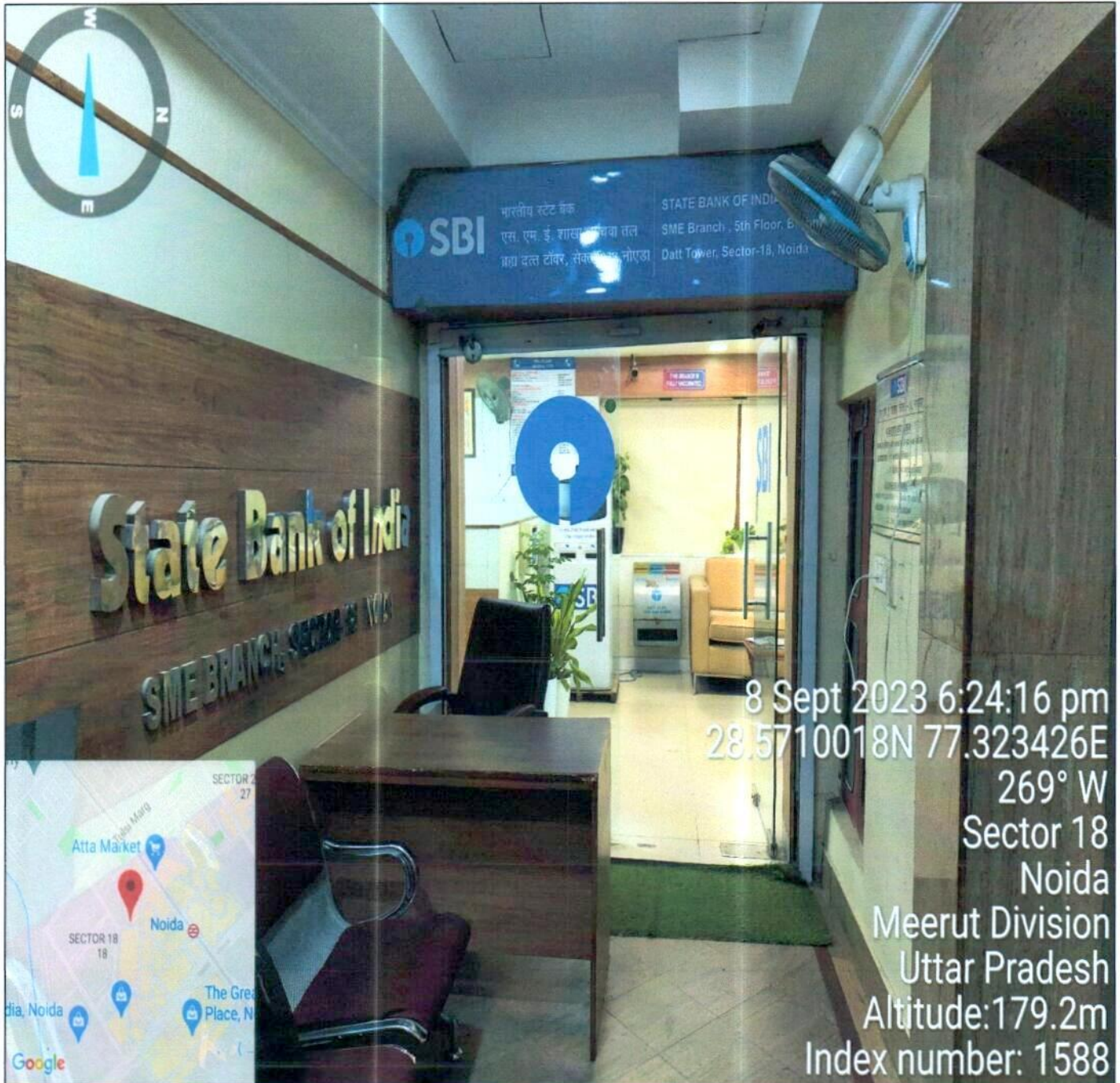

[Handwritten Signature]
R.K. Associates Valuers & Techno Engineering Consultants Pvt. Ltd.

PART B
SUMMARY OF THE VALUATION REPORT

S.NO.	CONTENTS	DESCRIPTION		
1.	GENERAL DETAILS			
i.	Report prepared for	Sh. Ramesh Kumar Suneja		
ii.	Work Order No. & Date	Via email Dated: 08 th September 2023		
iii.	Name of Borrower unit	Not known to us		
iv.	Name of Property Owner	M/s. Pawan Buildwell Pvt. Ltd		
v.	Address & Phone Number of the owner	Plot No. 3, Block K, Brahmhatt Tower, Sector-18, Noida, G.B. Nagar, Uttar Pradesh, 201301		
vi.	Type of the Property	Commercial Floor		
vii.	Type of Valuation Report	Commercial Floor value		
viii.	Report Type	Plain Asset Valuation		
ix.	Date of Inspection of the Property	8 September 2023		
x.	Date of Valuation Assessment	11 September 2023		
xi.	Date of Valuation Report	11 September 2023		
xii.	Property Shown By	Name	Relationship with Owner	Contact Number
		Mr. Praveen Chawla	Representative	+91-9599010507
xiii.	Purpose of the Valuation	For personal information purpose		
xiv.	Scope of the Report	Non Binding Opinion on General Prospective Valuation Assessment of the Property identified by Property owner or through its representative		
xv.	Out-of-Scope of Report	a) Verification of authenticity of documents from originals or cross checking from any Govt. depts. is not done at our end. b) Legal aspects of the property are out-of-scope of this report. c) Identification of the property is only limited to cross verification from its boundaries at site if mentioned in the provided documents. d) Getting cizra map or coordination with revenue officers for site identification is not done at our end. e) Measurement is only limited upto sample random measurement. f) Measurement of the property as a whole is not done at our end. g) Drawing Map & design of the property is out of scope of the work.		
xvi.	Documents provided for perusal	Documents Requested	Documents Provided	Documents Reference No.
		Total 05 Documents requested.	Total 01 Documents provided.	01
		Property Title document	Tripartite Agreement	Dated- 23 rd March 2012
		Last paid Electricity Bill	Yes	Dated- 9 th September

				2023
		Last paid Municipal Tax Receipt	---	---
		Copy of TIR	---	---
		Allotment Papers	---	---
xvii.	Identification of the property	<input type="checkbox"/>	Cross checked from boundaries of the property or address mentioned in the deed	
		<input checked="" type="checkbox"/>	Done from the name plate displayed on the property	
		<input checked="" type="checkbox"/>	Identified by the Owner's representative	
		<input checked="" type="checkbox"/>	Enquired from local residents/ public	
		<input type="checkbox"/>	Identification of the property could not be done properly	
		<input type="checkbox"/>	Survey was not done	

2. VALUATION SUMMARY

i.	Total Prospective Fair Market Value	Rs.7,04,00,000/-
ii.	Total Expected Realizable/ Fetch Value	Rs.5,98,40,000/-
iii.	Total Expected Distress/ Forced Sale Value	Rs.5,28,00,000/-

3. ENCLOSURES

a.	Part A	Snapshot of The Asset/ Property Under Valuation
b.	Part B	Valuation Report as per RKA Format Annexure-II
c.	Part C	Characteristics Description of The Asset
d.	Part D	Area Description of The Property
e.	Part E	Procedure of Valuation Assessments
f.	Enclosure 1	Price Trend references Of the Similar Related Properties Available on Public Domain.
g.	Enclosure 2	Google Map – Page No.
h.	Enclosure 3	Photographs – Pages x
i.	Enclosure 4	Copy of Circle Rate – Pages x
j.	Enclosure 5	Valuer's Important Remarks



PART C

CHARACTERISTICS DESCRIPTION OF THE ASSET

1. BRIEF DESCRIPTION OF THE PROPERTY UNDER VALUATION



Snapshot of the Asset/ Property Under Valuation

This opinion on valuation of the property in question is prepared for the commercial floor unit situated at the aforesaid address having total super built-up area admeasuring 3913.05 sq.ft. as per the copy of Tripartite Agreement provided to us.

The subject property is owned by M/S Pawan Buildwell Pvt Ltd, represented by Mr. Ramesh Kumar Suneja vide a tripartite agreement dated 20 March 2012 from M/S Som Datt Construction The land on which property is located is on 90 years lease with effect from 08.04.1997. At present the property is on 10-year lease with State Bank of India with effect from 01.07.2017 for a monthly rent of Rs 2,90,000/- for 1st five year and Rs 3,48,000/- for balance five years.

As per the condition of lease rent agreement, the owner has to take NOC from the lessee i.e., SBI Sector-18 SME Branch before disposing off of the property and also that SBI Sector-18 SME Branch will have the first right to buy the property and only in case SBI Sector-18 SME Branch decide not to buy the property than only any other buyer will be allowed to buy the property. Also, there is another condition that SBI Sector-18 SME Branch can cancel the lease agreement and vacate the premises by giving three months' notice but the lessor ie M/S. Pawan Buildwell does not have this liberty.

The subject property is located in the midst of developed commercial area of Sector -18, Noida and within the walking distance of Sector 18 metro station. However, it is learnt that fresh registries are not being done in that area for the properties which do not have parking space within their own complex

however the subjected property is already registered & leased so it will fetch higher value as compared to others properties in the area.

In case of discrepancy in the address mentioned in the property documents and the property shown to us at the site due to change in zoning or administrative level at the site or client misled the valuer by providing the fabricated document, the valuation should be considered of the property shown to us at the site of which the photographs are also attached. Our responsibility will be only related to the valuation of the property shown to us on the site and not regarding matching from the documents or searching the property from our own. Banker to verify from district administration/ tehsil level the identification of the property if it is the same matching with the document pledged.

This report only contains general assessment & opinion on the Guideline Value and the indicative, estimated Market Value of the property found on as-is-where basis on site for which the Bank/ customer has shown & asked us to conduct the Valuation for which photographs is also attached with the report. No legal aspects in terms of ownership or any other legal aspect is taken into consideration. It doesn't contain any due-diligence other than the valuation assessment of the property shown to us on site. Information/ data/ documents given to us by Bank/ client has been relied upon in good faith. This report doesn't contain any other recommendations of any sort.

2. GENERAL DESCRIPTION OF THE PROPERTY

i.	Names of the Legal Owner/s	Please refer to the Sale Agreement
ii.	Constitution of the Property	Lease Hold
iii.	Since how long owners owing the Property	More than 11 Years as per Tripartite Agreement
iv.	Year of Acquisition/ Purchase	2011
v.	Property presently occupied/ possessed by	Tenants

*NOTE: Please see point 6 of Enclosure: 5 – Valuer's Important Remarks.

3. LOCATION CHARACTERISTICS OF THE PROPERTY

i.	Nearby Landmark	Wave One Tower		
ii.	Postal Address of the Property	Plot No. 3, Block K, Brahm Datt Tower, Sector-18, Noida, G.B. Nagar, Uttar Pradesh, 201301		
iii.	Independent access/ approach to the property	Clear independent access is available		
iv.	Google Map Location of the Property with a neighborhood layout map	Enclosed with the Report		
		Coordinates or URL: 28°34'16.1"N 77°19'24.1"E		
v.	Description of adjoining property	Commercial		
vi.	Plot No. / Survey No.	Plot no. 3		
vii.	Village/ Zone	Sector – 18		
viii.	Sub registrar	Noida		
ix.	District	G.B. Nagar		
x.	City Categorization	Metro City		Urban developed
xi.	Characteristics of the locality	Good		Within high foot fall commercial market
xii.	Property location classification	Good location within locality	Near to Metro Station	Within Market
xiii.	Property Facing	East Facing		
xiv.	Details of the roads abutting the property			

	a) Main Road Name & Width	Captain Vijayant Thapar Marg	60 Ft
	b)Front Road Name & width	Sector-18 Road	50 Ft.
	c)Type of Approach Road	Cement Concrete Road	
	d)Distance from the Main Road	250 mtr.	
xv.	Is property clearly demarcated by permanent/ temporary boundary on site	Yes	
xvi.	Is the property merged or colluded with any other property	No, it is an independent single bounded property	
xvii.	Boundaries schedule of the Property		
a)	Are Boundaries matched	Yes from the available documents	
b)	Directions	As per Sale Deed/TIR	Actual found at Site
	East	Not Mentioned in Documents	Lift/Stairs
	West	Not Mentioned in Documents	Som Datt Tower
	North	Not Mentioned in Documents	Market
	South	Not Mentioned in Documents	Road

4. TOWN PLANNING/ ZONING PARAMETERS		
i.	Planning Area/ Zone	New Okhla Industrial Development Authority
ii.	Master Plan currently in force	NOIDA Master Plan - 2031
iii.	Municipal limits	NOIDA
iv.	Developmental controls/ Authority	NOIDA
v.	Zoning regulations	Commercial
vi.	Master Plan provisions related to property in terms of Land use	Commercial
vii.	Any conversion of land use done	NA
viii.	Current activity done in the property	Used as Commercial office
ix.	Is property usage as per applicable zoning	Yes
x.	Any notification on change of zoning regulation	NA
xi.	Street Notification	Commercial
xii.	Status of Completion/ Occupational certificate	No information provided
xiii.	Comment on unauthorized construction if any	Not Known to us
xiv.	Comment on Transferability of developmental rights	As per regulation of Noida
xv.	Comment on the surrounding land uses & adjoining properties in terms of uses	The surrounding properties are currently being used for Commercial purpose.
xvi.	Comment of Demolition proceedings if any	--
xvii.	Comment on Compounding/ Regularization proceedings	--
xviii.	Any information on encroachment	--
xix.	Is the area part of unauthorized area/ colony	No (As per general information available)

5. ECONOMIC ASPECTS OF THE PROPERTY		
i.	Reasonable letting value/ Expected market monthly rental	Approx. Rs.3,48,000/- per month
ii.	a) Is property presently on rent	Yes
	b) Number of tenants	01
	c) Since how long lease is in place	11 Years
	d) Status of tenancy right	Please refer to the attached documents
	e) Amount of monthly rent received	Rs.2,90,000/-
iii.	Taxes and other outgoing	Not known to us
iv.	Property Insurance details	No information shared by owner.
v.	Monthly maintenance charges payable	No information shared by owner.
vi.	Security charges, etc.	No information shared by owner.
vii.	Any other aspect	No

6. SOCIO - CULTURAL ASPECTS OF THE PROPERTY		
i.	Descriptive account of the location of the property in terms of social structure of the area in terms of population, social stratification, regional origin, age groups, economic levels, location of slums/squatter settlements nearby, etc.	Commercial area
ii.	Whether property belongs to social infrastructure like hospital, school, old age homes etc.	No

7. FUNCTIONAL AND UTILITARIAN SERVICES, FACILITIES & AMENITIES					
i.	Drainage arrangements		Yes		
ii.	Water Treatment Plant		NA		
iii.	Power Supply arrangements	Auxiliary	Yes		
		Permanent	Yes, D.G sets		
iv.	HVAC system		No		
v.	Security provisions		Yes, Private Security Guards.		
vi.	Lift/ Elevators		Yes		
vii.	Compound wall/ Main Gate		Yes		
viii.	Whether gated society		No		
ix.	Car parking facilities		Yes		
x.	Ventilation		Yes		
xi.	Internal development				
	Garden/ Park/ Land scraping	Water bodies	Internal roads	Pavements	Boundary Wall
	No	No	No	Yes	Yes

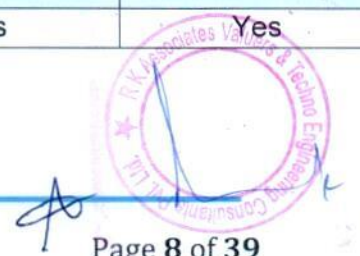

8.	INFRASTRUCTURE AVAILABILITY						
i.	Description of Aqua Infrastructure availability in terms of:						
	a) Water Supply	Yes from municipal connection					
	b) Sewerage/ sanitation system	Underground					
	c) Storm water drainage	Yes					
ii.	Description of other Physical Infrastructure facilities in terms of:						
	a) Solid waste management	Yes, by local authority					
	b) Electricity	Yes					
	c) Road and Public Transport connectivity	Yes					
	d) Availability of other public utilities nearby	Transport, Market, Hospital etc. available in close vicinity					
iii.	Proximity & availability of civic amenities & social infrastructure						
	School	Hospital	Market	Bus Stop	Railway Station	Metro	Airport
	~1 km.	~1 km.	Within market	~1 km.	~26 Km.	~300 mtr.	~32 km.
iv.	Availability of recreation facilities (parks, open spaces etc.)			Yes ample recreational facilities are available in the vicinity.			

9. MARKETABILITY ASPECTS OF THE PROPERTY:		
i.	Location attribute of the subject property	Very Good
ii.	Scarcity	Similar kind of properties are available on demand.
iii.	Market condition related to demand and supply of the kind of the subject property in the area	Good demand of such properties in the market.
iv.	Any New Development in surrounding area	None
v.	Any negativity/ defect/ disadvantages in the property/ location	NA
vi.	Any other aspect which has relevance on the value or marketability of the property	Good developed commercial area

10. ENGINEERING AND TECHNOLOGY ASPECTS OF THE PROPERTY:					
i.	Type of construction & design	Please refer to the attached specifications annexure			
ii.	Method of construction	Construction done based on daily hire mason & labourers using average quality material			
iii.	Specifications				
	a) Class of construction	Please refer to the attached specifications annexure			
	b) Appearance/ Condition of structures	Internal - RCC framed pillar beam column structure on RCC slab			
		External - RCC framed pillar beam column structure on RCC slab			
	c) Roof	<table><tr><th>Floors/ Blocks</th><th>Type of Roof</th></tr><tr><td>5th Floor</td><td>RCC</td></tr></table>	Floors/ Blocks	Type of Roof	5 th Floor
Floors/ Blocks	Type of Roof				
5 th Floor	RCC				

	d) Floor height	11ft.	
	e) Type of flooring	Vitrified Tiles, Ceramic Tiles	
	f) Doors/ Windows	Wooden framed doors & windows	
	g) Interior Finishing	Simple Plastered Walls	
	h) Exterior Finishing	Marble Cladding with Glass facade	
	i) Interior decoration/ Special architectural or decorative feature	Simple Plastered Walls	
	j) Class of electrical fittings	Normal quality fitting used	
	k) Class of sanitary & water supply fittings	Normal quality fitting used	
iv.	Maintenance issues	None	
v.	Age of building/ Year of construction	19 Years	2004
vi.	Total life of the structure/ Remaining life expected	65 years	46 years
vii.	Extent of deterioration in the structure	None	
viii.	Protection against natural disasters viz. earthquakes etc.	Structure built on RCC technique so it is assumed to be safe.	
ix.	Visible damage in the building if any	No visible damage observed	
x.	System of air conditioning	Yes, Cassette Ac	
xi.	Provision of firefighting	Yes	
xii.	Status of Building Plans/ Maps	Cannot comment since no approved map provided to us on our request	
	a) Authority approving the plan	---	
	b) Name of the office of the Authority	---	
	c) Is Building as per approved Map	Cannot comment since no approved map provided to us on our request.	
	d) Details of alterations/ deviations/ illegal construction/ encroachment noticed in the structure from the original approved plan	<input type="checkbox"/> Permissible Alterations	<input type="checkbox"/> Permissible Alterations
		<input type="checkbox"/> Not permitted alteration	<input type="checkbox"/> Not permitted alteration
	e) Is this being regularized	No information provided	

11. ENVIRONMENTAL FACTORS:		
i.	Use of environment friendly building materials like fly ash brick, other green building techniques if any	No information available.
ii.	Provision of rainwater harvesting	No
iii.	Use of solar heating and lighting systems, etc.	No
iv.	Presence of environmental pollution in the vicinity of the property in terms of industries, heavy traffic, etc. if any	Yes, normal vehicular pollution.



12. ARCHITECTURAL AND AESTHETIC QUALITY OF THE PROPERTY:		
i.	Descriptive account on whether the building is modern, old fashioned, etc., plain looking or with decorative elements, heritage value if applicable, presence of landscape elements, etc.	Modern structure



PART D

AREA DESCRIPTION OF THE PROPERTY

1.	Land Area considered for Valuation	NA, since it is a built-up unit	
	Area adopted on the basis of	NA	
	Remarks & observations, if any	NA	
2.	Constructed Area considered for Valuation (As per IS 3861-1966)	Built-up Area	3913.05 sq.ft.
	Area adopted on the basis of	Property documents & site survey both	
	Remarks & observations, if any	As per the tripartite agreement provided the total built-up are of the property is 3913.05 sq.ft. which is verified at the time of site visit.	

Note:

1. Area measurements considered in the Valuation Report pertaining to Land & Building is adopted from relevant approved documents or actual site measurement whichever is less. All area measurements are on approximate basis only.
2. Verification of the area measurement of the property is done based on sample random checking only.
3. Area of the large land parcels of more than 2500 sq. mtr or of uneven shape, is taken as per property documents verified with digital survey through google which has been relied upon.
4. Drawing Map, design & detailed estimation of the property/ building is out of scope of the Valuation services.



PART E
PROCEDURE OF VALUATION ASSESMENT

1.		GENERAL INFORMATION		
i.	Important Dates	Date of Inspection of the Property	Date of Valuation Assessment	Date of Valuation Report
		8 September 2023	11 September 2023	11 September 2023
ii.	Client	Sh. Ramesh Kumar Suneja		
iii.	Intended User	Sh. Ramesh Kumar Suneja		
iv.	Intended Use	To know the general idea on the market valuation trend of the property as per free market transaction. This report is not intended to cover any other internal mechanism, criteria, considerations of any organization as per their own need, use & purpose.		
v.	Purpose of Valuation	For personal information purpose		
vi.	Scope of the Assessment	Non binding opinion on the assessment of Plain Physical Asset Valuation of the property identified to us by the owner or through his representative.		
vii.	Restrictions	This report should not be referred for any other purpose, by any other user and for any other date other then as specified above. This is not a certification of ownership or survey number/ property number/ Khasra number which are merely referred from the copy of the documents provided to us.		
viii.	Manner in which the proper is identified	<input checked="" type="checkbox"/>	Done from the name plate displayed on the property	
		<input type="checkbox"/>	Identified by the owner	
		<input checked="" type="checkbox"/>	Identified by the owner's representative	
		<input type="checkbox"/>	Enquired from local residents/ public	
		<input type="checkbox"/>	Cross checked from the boundaries/ address of the property mentioned in the documents provided to us	
		<input type="checkbox"/>	Identification of the property could not be done properly	
		<input type="checkbox"/>	Survey was not done	
ix.	Type of Survey conducted	Full survey (inside-out with approximate measurements & photographs).		

2.	ASSESSMENT FACTORS		
i.	Valuation Standards considered	Mix of standards such as IVS and others issued by Indian authorities & institutions and improvised by the RKA internal research team as and where it is felt necessary to derive at a reasonable, logical & scientific approach. In this regard proper basis, approach, working, definitions considered is defined below which may have certain departures to IVS.	
ii.	Nature of the Valuation	Fixed Assets Valuation	
iii.	Nature/ Category/ Type/ Classification of Asset under Valuation	Nature	Category
		BUILT-UP UNIT	COMMERCIAL
			Type COMMERCIAL FLOOR UNIT

		Classification		Income/ Revenue Generating Asset	
iv.	Type of Valuation (Basis of Valuation as per IVS)	Primary Basis		Market Value & Govt. Guideline Value	
		Secondary Basis		On-going concern basis	
v.	Present market state of the Asset assumed (Premise of Value as per IVS)	Under Normal Marketable State			
		Reason: Asset under free market transaction state			
vi.	Property Use factor	Current/ Existing Use	Highest & Best Use <i>(in consonance to surrounding use, zoning and statutory norms)</i>	Considered for Valuation purpose	
		Commercial	Commercial	Commercial	
vii.	Legality Aspect Factor	Assumed to be fine as per copy of the documents & information produced to us. However Legal aspects of the property of any nature are out-of-scope of the Valuation Services. In terms of the legality, we have only gone by the documents provided to us in good faith. Verification of authenticity of documents from originals or cross checking from any Govt. deptt. have to be taken care by Legal expert/ Advocate.			
viii.	Land Physical Factors	Shape	Size	Layout	
		Rectangle	Medium	Good	
ix.	Property Location Category Factor	City Categorization	Locality Characteristics	Property location characteristics	Floor Level
		Metro City	Good	Near to Metro Station	5 th Floor
		Urban developed	Within high foot fall commercial market	Near to Highway	
			Within main city	Corner Plot	
		Property Facing			
		East Facing			
x.	Physical Infrastructure availability factors of the locality	Water Supply	Sewerage/ sanitation system	Electricity	Road and Public Transport connectivity
		Yes from municipal connection	Underground	Yes	Easily available

		Availability of other public utilities nearby	Availability of communication facilities
		Transport, Market, Hospital etc. are available in close vicinity	Major Telecommunication Service Provider & ISP connections are available
xi.	Social structure of the area (in terms of population, social stratification, regional origin, age groups, economic levels, location of slums/ squatter settlements nearby, etc.)	Medium Income Group	
xii.	Neighbourhood amenities	Good	
xiii.	Any New Development in surrounding area	None	
xiv.	Any specific advantage/ drawback in the property	Subject property is located on corner plot.	
xv.	Property overall usability/ utility Factor	Good	
xvi.	Do property has any alternate use?	None	
xvii.	Is property clearly demarcated by permanent/ temporary boundary on site	Yes demarcated properly	
xviii.	Is the property merged or colluded with any other property	No	
		Comments	
xix.	Is independent access available to the property	Clear independent access is available	
xx.	Is property clearly possessable upon sale	Yes but currently leased to State Bank of India and required NOC From bank in order to sale	
xxi.	Best Sale procedure to realize maximum Value (<i>in respect to Present market state or premise of the Asset as per point (iv) above</i>)	Fair Market Value	
		Free market transaction at arm's length wherein the parties, after full market survey each acted knowledgeably, prudently and without any compulsion.	
xxii.	Hypothetical Sale	Fair Market Value	

	transaction method assumed for the COMPUTATION of valuation	Free market transaction at arm's length wherein the parties, after full market survey each acted knowledgeably, prudently and without any compulsion.	
xxiii.	Approach & Method of Valuation Used	Approach of Valuation	Method of Valuation
		Built-up	Market Approach
			Market Comparable Sales Method
xxiv.	Type of Source of Information	Level 3 Input (Tertiary)	
xxv.	Market Comparable		
	References on prevailing market Rate/ Price trend of the property and Details of the sources from where the information is gathered (from property search sites & local information)	1.	Name: M/s. Expert Homes Contact No.: +91-7011348430 Nature of reference: Property Consultant Size of the Property: 2000 sq.ft. Location: Nearby Vicinity Rates/ Price informed: Around Rs. 17,000/- to Rs. 20,000/- per sq.ft. on super built-up area Any other details/ Discussion held: As per the discussion with the property dealer of the subject locality we came to know that there is availability of commercial space in that area. Within the above-mentioned range.
		2.	Name: M/s. HR AF Advisors Contact No.: +91-9354655916 Nature of reference: Property Consultant Size of the Property: 1018 sq.ft. Location: Nearby Vicinity Rates/ Price informed: Around Rs. 17,000/- to Rs. 19,000/- per sq.ft. on super built-up area Any other details/ Discussion held: As per the discussion with the property dealer of the subject locality we came to know that there is availability of office space in that area. Within the above-mentioned rate.
		NOTE: The given information above can be independently verified to know its authenticity.	
xxvi.	Adopted Rates Justification	As per our discussion with the property dealers and habitants of the subject location we have gathered the following information: - <ol style="list-style-type: none"> There is availability of office spaces in the surrounding locality (having similar size as our subject property). Rates for offices having size around 1018 sq.ft. will be within the range of Rs. 17,000/- - sq.ft. to Rs.20,000/- per sq.ft. on super built-up area. Rates for plots (having similar size as our subject property) will be around Rs. 17,000/- to Rs. 19,000/- per sq.ft. on super built-up area. Based on the above information and keeping in mind the availability of office spaces in subject locality we are of the view to adopt a rate of Rs. 18,000/- per sq.ft. on super built-up area for the purpose of this valuation assessment.	
		NOTE: We have taken due care to take the information from reliable sources. The given information above can be independently verified from the provided numbers to know its authenticity. However due to the nature of the information	

most of the market information came to knowledge is only through verbal discussion with market participants which we have to rely upon where generally there is no written record.
Related postings for similar properties on sale are also annexed with the Report wherever available.

xxvii.	Other Market Factors		
	Current Market condition	Normal	
		Remarks: NA	
		Adjustments (-/+): 0%	
	Comment on Property Salability Outlook	Easily sellable	
		Adjustments (-/+): 0%	
	Comment on Demand & Supply in the Market	Demand	Supply
		Good	Adequately available
		Remarks: Good demand of such properties in the market	
		Adjustments (-/+): 0%	
xxviii.	Any other special consideration	Reason: --	
		Adjustments (-/+): 0%	
xxix.	Any other aspect which has relevance on the value or marketability of the property	NA.	
		This Valuation report is prepared based on the facts of the property & market situation on the date of the survey. It is a well-known fact that the market value of any asset varies with time & socio-economic conditions prevailing in the region/ country. In future property market may go down, property conditions may change or may go worse, property reputation may differ, property vicinity conditions may go down or become worse, property market may change due to impact of Govt. policies or effect of domestic/ world economy, usability prospects of the property may change, etc. Hence before financing, Banker/ FI should take into consideration all such future risk while financing.	
		Adjustments (-/+): 0%	
xxx.	Final adjusted & weighted Rates considered for the subject property	Rs. 18,000/- per sq.ft. on super built-up area	
xxxi.	Considered Rates Justification	As per the thorough property & market factors analysis as described above, the considered estimated market rates appears to be reasonable in our opinion.	
xxxii.	Basis of computation & working		
	a. Valuation of the asset is done as found on as-is-where basis on the site as identified to us by client/ owner/ owner representative during site inspection by our engineer/s unless otherwise mentioned in the report.		
	b. Analysis and conclusions adopted in the report are limited to the reported assumptions, conditions and information came to our knowledge during the course of the work and based on the Standard Operating Procedures, Best Practices, Caveats, Limitations, Conditions, Remarks, Important Notes, Valuation TOR and definition of different nature of values.		
	c. For knowing comparable market rates, significant discreet local enquiries have been made from our side based on the hypothetical/ virtual representation of ourselves as both buyer and seller for the similar type of properties in the subject location and thereafter based on this information and various factors of		

- the property, rate has been judiciously taken considering the factors of the subject property, market scenario and weighted adjusted comparison with the comparable properties unless otherwise stated.
- d. References regarding the prevailing market rates and comparable are based on the verbal/ informal/ secondary/ tertiary information which are collected by our team from the local people/ property consultants/ recent deals/ demand-supply/ internet postings are relied upon as may be available or can be fetched within the limited time & resources of the assignment during market survey in the subject location. No written record is generally available for such market information and analysis has to be derived mostly based on the verbal information which has to be relied upon.
 - e. Market Rates are rationally adopted based on the facts of the property which came to our knowledge during the course of the assessment considering many factors like nature of the property, size, location, approach, market situation and trends and comparative analysis with the similar assets. During comparative analysis, valuation metrics is prepared and necessary adjustments are made on the subject asset.
 - f. The indicative value has been suggested based on the prevailing market rates that came to our knowledge during secondary & tertiary market research and is not split into formal & informal payment arrangements. Most of the deals takes place which includes both formal & informal payment components. Deals which takes place in complete formal payment component may realize relatively less actual transaction value due to inherent added tax, stamp registration liabilities on the buyer.
 - g. Secondary/ Tertiary costs related to asset transaction like Stamp Duty, Registration charges, Brokerage, Commission, Bank interest, Selling cost, Marketing cost, etc. pertaining to the sale/ purchase of this property are not considered while assessing the indicative estimated Market Value.
 - h. This report includes both, Govt. Guideline Value and Indicative Estimated Prospective Market Value as described above. As per the current market practice, in most of the cases, formal transaction takes place for an amount less than the actual transaction amount and rest of the payment is normally done informally.
 - i. Area measurements considered in the Valuation Report pertaining to asset/ property is adopted from relevant approved documents or sample site measurement whichever is less unless otherwise mentioned. All area measurements are on approximate basis only.
 - j. Verification of the area measurement of the property is done based on sample random checking only.
 - k. Area of the large land parcels of more than 2500 sq. mtr. or of uneven shape in which there can be practical difficulty in sample measurement, is taken as per property documents which has been relied upon unless otherwise stated.
 - l. Drawing, Map, design & detailed estimation of the property/ building is out of scope of the Valuation services.
 - m. Construction rates are adopted based on the present market replacement cost of construction and calculating applicable depreciation & deterioration factor as per its age, existing condition & specifications based on visual observation only of the structure. No structural, physical tests have been carried out in respect of it. No responsibility is assumed for latent defects of any nature whatsoever, which may affect value, or for any expertise required to disclose such conditions.
 - n. Construction rates are adopted based on the plinth area rates prevailing in the market for the structure as a whole and not based on item wise estimation or Bills of Quantity method unless otherwise stated.
 - o. The condition assessment and the estimation of the residual economic life of the structure are only based on the visual observations and appearance found during the site survey. We have not carried out any structural design or stability study; nor carried out any physical tests to assess structural integrity & strength.
 - p. Any kind of unpaid statutory, utilities, lease, interest or any other pecuniary dues on the asset or on its owners has not been factored in the Valuation.
 - q. This Valuation is conducted based on the macro analysis of the asset/ property considering it in totality and not based on the micro, component or item wise analysis. Analysis done is a general assessment and is neither investigative in nature nor an audit activity.
 - r. Valuation is done for the asset found on as-is-where basis which owner/ owner/representative/ client/

bank has shown to us on site of which some reference has been taken from the information/ data given in the copy of documents provided to us which have been relied upon in good faith and we have assumed that it to be true and correct.

xxxiii. ASSUMPTIONS

- Documents/ Information/ Data provided by the client/ property owner or his representative both written & verbally is true and correct without any fabrication and has been relied upon in good faith.
- Local verbal enquiries during micro market research came to our knowledge are assumed to be taken on record as true & factual.
- The assets and interests therein have been valued free and clear of any liens or encumbrances unless stated otherwise. No hidden or apparent conditions regarding the subject assets or their ownership are assumed to exist. No opinion of title is rendered in this report and a good title is assumed unless stated otherwise.
- It is assumed that the concerned Lender/ Financial Institution has asked for the valuation of that property after satisfying the authenticity of the documents given to us and for which the legal verification has been already taken and cleared by the competent Advocate before requesting for the Valuation report. I/ We assume no responsibility for the legal matters including, but not limited to, legal or title concerns.
- Payment condition during transaction in the Valuation has been considered on all cash bases which includes both formal & informal payment components as per market trend.
- Sale transaction method of the asset is assumed as Free market transaction without any compulsion unless otherwise mentioned while assessing Indicative & Estimated Fair Prospective Market Value of the asset unless otherwise stated.
- If this Valuation Report is prepared for the Flat/ dwelling unit situated in a Group Housing Society or Integrated Township then approvals, maps of the complete group housing society/ township is out of scope of this report. This valuation report is prepared for the specific unit based on the assumption that complete Group Housing Society/ Integrated Township is approved and complied with all relevant laws and the subject unit is also approved within the Group Housing Society/ Township.

xxxiv. SPECIAL ASSUMPTIONS

None

xxxv. LIMITATIONS

None

3.

VALUATION OF LAND

	Particulars	Govt. Circle/ Guideline Value	Indicative & Estimated Prospective Fair Market Value
a.	Prevailing Rate range	Rs.1,08,700/- per sq.mtr	Rs.17,000/- to Rs.19,000/- per sq.ft
b.	Deduction on Market Rate	---	---
c.	Rate adopted considering all characteristics of the property	Rs.1,08,700/- per sq.mtr	Rs.18,000/- per sq.ft
d.	Total Land Area considered (documents vs site survey whichever is less)	3913.05 sq.ft./ 363.53 sq.mtr	3913.05 sq.ft./ 363.53 sq.mtr
e.	Total Value of land (A)	363.53 sq. ft. x Rs.1,08,700/- per sq.mtr Rs.3,95,15,711/-	3913.05 sq.ft. x Rs.18,000/- per sq.ft Rs.7,04,34,900/-

4.

VALUATION COMPUTATION OF BUILDING STRUCTURE

NA, Since it is a Built-up Unit.

5.	CONSOLIDATED VALUATION ASSESSMENT OF THE ASSET		
S. No	Particulars	Govt. Circle/ Guideline Value	Indicative & Estimated Prospective Fair Market Value
a.	Land Value (A)	---	---
b.	Built-up Value (B)	Rs.3,95,15,711/-	Rs.7,04,34,900/-
c.	Additional Aesthetic Works Value (C)	NA	NA
d.	Total Add (A+B+C)	Rs.3,95,15,711/-	Rs.7,04,34,900/-
e.	Additional Premium if any	NA	NA
	Details/ Justification	NA	NA
f.	Deductions charged if any	---	---
	Details/ Justification	---	---
g.	Total Indicative & Estimated Prospective Fair Market Value	---	Rs.7,04,34,900/-
h.	Rounded Off	---	Rs.7,04,00,000/-
i.	Indicative & Estimated Prospective Fair Market Value in words	---	Rupees Seven Crore Four Lakh Only
j.	Expected Realizable Value (@ ~15% less)	---	Rs.6,58,75,000/-
k.	Expected Distress Sale Value (@ ~25% less)	---	Rs.5,28,00,000/-
l.	Percentage difference between Circle Rate and Fair Market Value	More than 20%	
m.	Likely reason of difference in Circle Value and Fair Market Value in case of more than 20%	Circle rates are determined by the District administration as per their own theoretical internal policy for fixing the minimum valuation of the property for property registration tax collection purpose and Market rates are adopted based on prevailing market dynamics found as per the discrete market enquiries which is explained clearly in Valuation assessment factors.	
n.	Concluding Comments/ Disclosures if any		
	a. We are independent of client/ company and do not have any direct/ indirect interest in the property.		
	b. This valuation has been conducted by R.K Associates Valuers & Techno Engineering Consultants (P)		

Ltd. and its team of experts.

- c. This Valuation is done for the property found on as-is-where basis as shown on the site by the Bank/ customer of which photographs is also attached with the report.
- d. Reference of the property is also taken from the copies of the documents/ information which interested organization or customer could provide to us out of the standard checklist of documents sought from them and further based on our assumptions and limiting conditions. All such information provided to us has been relied upon in good faith and we have assumed that it is true and correct. However we do not vouch the absolute correctness of the property identification, exact address, physical conditions, etc. based on the documents provided to us since property shown to us may differ on site Vs as mentioned in the documents or incorrect/ fabricated documents may have been provided to us.
- e. Legal aspects for eg. investigation of title, ownership rights, lien, charge, mortgage, lease, verification of documents from originals or from any Govt. department, etc. has to be taken care by legal experts/ Advocates and same has not been done at our end.
- f. The valuation of an asset is an estimate of the worth of that asset which is arrived at by the Valuer in his expert opinion after factoring in multiple parameters and externalities. This may not be the actual price of that asset and the market may discover a different price for that asset.
- g. This report only contains opinion based on technical & market information which came to our knowledge during the course of the assignment. It doesn't contain any recommendations.
- h. This report is prepared following our Standard Operating Procedures & Best Practices and will be subject to Limitations, Conditions, Valuer's Remarks, Important Notes, Valuation TOS and basis of computation & working as described above.
- i. The use of this report will become valid only after payment of full fees as per the Payment Terms. Using this report or any part content created in this report without payment of charges will be seen as misuse and unauthorized use of the report.

o. IMPORTANT KEY DEFINITIONS

Fair Value suggested by the competent Valuer is that prospective estimated amount in his expert & prudent opinion of the subject asset/ property without any prejudice after he has carefully & exhaustively evaluated the facts & information came in front of him or which he could reasonably collect during the course of the assessment related to the subject asset on an as-is, where-is basis in its existing conditions, with all its existing advantages & disadvantages and its potential possibilities which is just & equitable at which the subject asset/ property should be exchanged between a willing buyer and willing seller at an arm's length transaction in an open & unrestricted market, in an orderly transaction after proper marketing, wherein the parties, each acted knowledgeably, prudently without any compulsion on the date of the Valuation.

Fair Value without using the term "Market" in it describes that the value suggested by the Valuer may not mandatorily follow or may not be in complete consonance to the established Market in his expert opinion. It may or may not follow market dynamics. But if the suggested value by the valuer is not within the prevailing Market range or is assessed for an asset is located in an un-established Market then the valuer will give reasonable justification & reasoning that for what reasons the value suggested by him doesn't follow the prevailing market dynamics.

Fair Market Value suggested by the competent Valuer is that prospective estimated amount in his expert & prudent opinion of the subject asset/ property without any prejudice in consonance to the Market dynamics after he has carefully & exhaustively evaluated the facts & information came in front of him or which he could reasonably collect during the course of assessment related to the subject asset on an as-is, where-is basis

in its existing conditions, with all its existing advantages & disadvantages and its potential possibilities which is just & equitable at which the subject asset/ property should be exchanged between a willing buyer and willing seller at an arm's length transaction in an open & unrestricted market, in an orderly transaction after proper marketing, wherein the parties, each acted knowledgeably, prudently without any compulsion on the date of the Valuation.

Here the words "in consonance to the established Market" means that the Valuer will give opinion within the realms & dynamics of the prevailing market rates after exhaustively doing the micro market research. However due to the element of "Fair" in it, valuer will always look for the factors if the value should be better than the market realms which is just & equitable backed by strong justification and reasoning.

Market Value suggested by the competent Valuer is that prospective estimated amount which is average price of the similar comparable assets prevailing in an open & established market during the near period of the date of valuation at which the subject asset/ property should be exchanged between a willing buyer and willing seller on an as-is, where-is basis in its existing conditions, with all its existing advantages & disadvantages and its potential possibilities at an arm's length transaction in an open, established & unrestricted market, in an orderly transaction, wherein the parties, each acted without any compulsion on the date of the Valuation.

Using the term "Market Value" without "Fair" omits the elements of proper marketing, acting knowledgeably & prudently.

Market and market participants can be sentimental, inclined towards the transaction without the element of complete knowledge & prudence about facts or due diligence of the asset therefore "each acted knowledgeably, prudently" has been removed from the Market Value definition.

Realizable Value is that minimum prospective estimated value of the asset/ property which it may be able to fetch at the time of actual property transaction factoring in the element of discount due to the prospects of deep negotiations between the buyer & seller when the parties in-principally find Fair Market Value reasonable and sits together to close the deal and the transaction across the table. Discount percentage on the Fair Market Value due to negotiation will depend on the nature, size, various salability prospects of the subject asset, the needs of the buyer & the seller and kind of payment terms. In some of the cases Realizable and Fair Market Value may also be equal.

Distress Sale Value* is that value when the property is attached with any process such as mortgaged financing, financial or operational dues which is under any stress condition or situation and the stakeholders are under process of finding resolution towards it to save the property from being attached to a formal recovery process. In this type of sale, minimum fetch value assessed will always be less than the estimated Fair Market Value where the discount of percentage will depend upon various circumstances and factors such as nature, size, salability prospects of the property and kind of encumbrance on the property. In this type of sale, negotiation power of the buyer is always more than the seller and eagerness & pressure of selling the property will be more on the seller than the buyer.

Liquidation Value is the amount that would be realized when an asset or group of assets are sold due to any compulsion or constraints such as in a recovery process guided by statute, law or legal process, clearance sale or any such condition or situation thereof where the pressure of selling the asset/ property is very high to realize whatever maximum amount can be from the sale of the assets in a limited time for clearance of dues or due to closure of business. In other words, this kind of value is also called as forced sale value.

Difference between Cost, Price & Value: Generally, these words are used and understood synonymously. However, in reality each of these has a completely different meaning, premise and also having different definitions in professional & legal terms. Therefore, it is our professional responsibility to describe the definitions of these words to avoid ambiguity & confusion in the minds of the user of this report.

The **Cost** of an asset represents the actual amount spend in the construction/ actual creation of the asset.

The **Price** is the amount paid for the procurement of the same asset.

The **Value** is defined as the present worth of future rights in the property/ asset and is a hypothetical or notional price that buyers and sellers are most likely to conclude for a good or service. Value is not a fact, but an estimate of the likely price to be paid for a good or service at a given time in accordance with a particular definition of value.

Therefore, in actual for the same asset/ property, cost, price & value remain different since these terms have different usage & meaning.

p. **Enclosures with the Report:**

- Enclosure: I – Google Map Location
- Enclosure: II - References on price trend of the similar related properties available on public domain
- Enclosure: III - Photographs of the property
- Enclosure: IV -Copy of Circle Guideline Rate
- Enclosure: V- Important Property Documents
- Enclosure VI: Part D - Valuer's Important Remarks



IMPORTANT NOTES

DEFECT LIABILITY PERIOD - In case of any query/ issue or escalation you may please contact Incident Manager by writing at valuers@rkassociates.org. We try our level best to ensure maximum accuracy in the Calculations done, Rates adopted and various other data points & information mentioned in the report but still can't rule out typing, human errors, assessment or any other mistakes. In case you find any mistake, variation, discrepancy or inaccuracy in any data point mentioned in the report, please help us by bringing all such points into our notice in writing at valuers@rkassociates.org within 30 days of the report delivery, to get these rectified timely, failing which R.K Associates shouldn't be held responsible for any inaccuracy in any manner. Also, if we do not hear back anything from you within 30 days, we will assume that the report is correct in all respect and no further claim of any sort will be entertained thereafter. We would welcome and appreciate your feedback & suggestions in order to improve our services.

Our **DATA RETENTION POLICY** is of **ONE YEAR**. After this period we remove all the concerned records related to the assignment from our repository. No clarification or query can be answered after this period due to unavailability of the data.

COPYRIGHT FORMAT - This report is prepared on the copyright format of R.K Associates to serve our clients in the best possible way. Legally no one can copy or distribute this format without prior approval from R.K Associates. It is meant only for the organization as mentioned on the cover page of this report. Distribution or use of this format or any content of this report wholly or partially other than R.K Associates will be seen as unlawful act and necessary legal action can be taken against the defaulters.

IF REPORT IS USED FOR BANK/ FIs

NOTE: As per IBA Guidelines in case the valuation report submitted by the valuer is not in order, the banks / FIs shall bring the same to the notice of the valuer within 15 days of submission for rectification and resubmission. In case no such communication is received, it shall be presumed that the valuation report has been accepted.

At our end we have not verified the authenticity of any documents provided to us. Bank is advised to verify the genuineness of the property documents before taking any credit decision.

Valuation Terms of Services & Valuer's Important Remarks are available at www.rkassociates.org for reference.

SURVEY ANALYST	VALUATION ENGINEER	L1/ L2 REVIEWER
Amit Jaiswal	Amit Jaiswal	Anil Kumar
		



**ENCLOSURE: I - PRICE TRENDREFERENCES OF THE SIMILAR
RELATED PROPERTIES AVAILABLE ON PUBLIC DOMAIN**

HOUSING.COM Commercial In Noida

Search: Sector 18 X + Add

Home / Noida / Sector 18 / Office Space for sale in Sector 18 / 1018 sq.ft. Ready to use Office Space in Sector 18, Noida

1018 sq.ft Ready to use Office Space, Sector 18, Noida

Pocket D, Sector 18, Noida

₹1.52 Cr

Contact User

Commercial

Commercial

Commercial

+ 2 more

HOUSING.COM Commercial In Noida

Search: Sector 18 X + Add

Property Type: ₹0 - ₹5,00Cr 0 - 5000 Sq.Ft. Lease Type: 0 - 10 % p.a. Possession Sta... Listed By

Home / Noida / Commercial Property for sale in Sector 18, Noida

Last Updated: Sep 8, 2023

Showing 1 - 20 of 35

Commercial Property for Sale in Sector 18, Noida

Sort by: Relevance

Find premium commercial properties, including retail spaces, shops and offices, available for sale in Sector 18. Offering numerous... Read more

5.42% ROI Pre-leased Popular

₹4.65 Cr

Shop for sale in Sector 18

Pocket L, Sector 18, Noida

Price/Sq.Ft: ₹13.25K/Sq.Ft Carpet Area: 2,000 Sq.Ft Floors: GF, 3 Floors

Grab Offer →

(Handwritten signature and circular stamp of R.K. Associates Valuers & Techno Engineers Pvt. Ltd.)

ENCLOSURE: II – GOOGLE MAP LOCATION

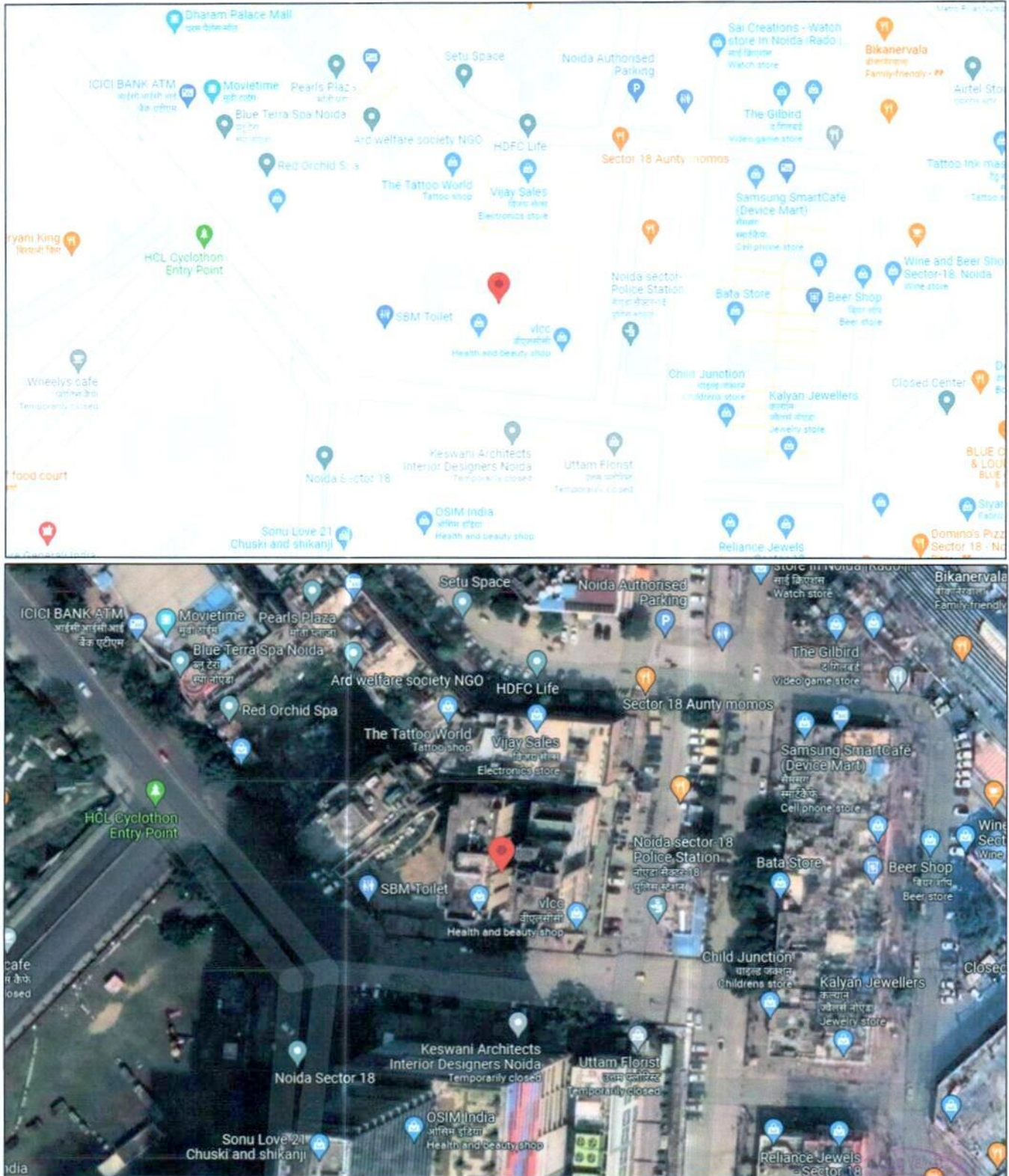

ENCLOSURE: III – PHOTOGRAPHS OF THE PROPERTY

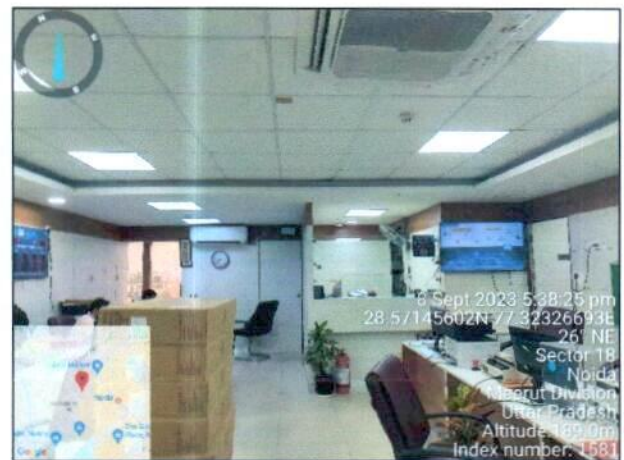

[Handwritten signature and circular stamp of R.K. Associates]



[Handwritten signature]

[Circular stamp: R.K. Associates Valuers & Techno Engineering Consultants (P) Ltd.]

ENCLOSURE: IV- COPY OF CIRCLE RATE

आवासीय भूखण्ड की प्रस्तावित दरें (नोएडा की श्रेणी परिवर्तन/उच्चीकरण पूर्व दर श्रेणी परिवर्तन/उच्चीकरण पश्चात मूल्यांकन सूची की वर्तमान दर तथा प्रस्तावित दर)

(दर प्रति वर्ग मीटर में)

श्रेणी	सैक्टर की वर्तमान श्रेणी	सैक्टर का क्रमांक	नोएडा प्राधिकरण की पूर्व बेसिक दर वर्तमान दर	12 मी0 तक चौड़ी सड़क पर मूल्यांकन सूची की वर्तमान बेसिक दर प्रस्तावित दर	12 मी0 से अधिक किन्तु 18 मी0 तक चौड़ी सड़क पर मूल्यांकन सूची की वर्तमान बेसिक दर प्रस्तावित दर	18 मी0 से अधिक किन्तु 24 मी0 तक चौड़ी सड़क पर मूल्यांकन सूची की वर्तमान बेसिक दर प्रस्तावित दर	24 मी0 से अधिक चौड़ी सड़क पर मूल्यांकन सूची की वर्तमान बेसिक दर प्रस्तावित दर
श्रेणी ए +	श्रेणी ए से ए + नई श्रेणी बनाई गई।	14ए, 15ए, 44 ब्लॉक ए व बी	92950 175000	103500 194250	108700 204000	113850 213700	119050 223400
श्रेणी ए	श्रेणी बी से ए किये गये सैक्टर	19, 47, 93ए, 93बी	64790 92950	72000 103500	75600 108700	79200 113850	82800 119050
	पूर्व से ए श्रेणी के सैक्टर	14, 16, 16ए, 16बी, 17, 18, 30, 35, 36, 38, 38ए, 39, 44 ए बी ब्लॉक से मिन 50, 51, 52, 94, 124	92950 92950	103500 103500	108700 108700	113850 113850	119050 119050
श्रेणी बी	श्रेणी सी से बी किये गये सैक्टर	11, 12, 22, 70, 71, 72, 73, 74, 75, 76, 77, 78	47180 64790	52500 72000	55150 75600	57750 79200	60400 82800
	पूर्व से बी श्रेणी के सैक्टर	15, 20, 21, 23, 24, 25, 25ए, 26, 27, 28, 29, 31, 32, 33, 34, 37, 40, 41, 46, 48, 49, 53, 55, 56, 61, 62, 82, 92, 93, 96, 97, 98, 99, 100, 105, 108, 122	64790 64790	72000 72000	75600 75600	79200 79200	82800 82800

उप निबन्धक-
प्रथम, नोएडा

उप निबन्धक-
द्वितीय, नोएडा

उप निबन्धक-
तृतीय, नोएडा

सहायक महानिरीक्षक निबन्धन
(प्रथम), गौतमबुद्ध नगर।

अपर जिलाधिकारी (वि0/रा0),
गौतमबुद्ध नगर।



ENCLOSURE: V – IMPORTANT PROPERTY DOCUMENTS



उत्तर प्रदेश UTTAR PRADESH AR 624424

SALE AGREEMENT

This SALE AGREEMENT is made at NOIDA on this 23rd April/2011 day of APRIL in the year 2011 [TWO THOUSAND ELEVEN] between the following parties:-

M/s Startouch (India) Private Limited [A Company incorporated under the provisions of Indian Companies Act, 1956] having its Registered Office situated at C-15, Flat No. 102, First Floor, Acharya Niketan, Delhi - 110091 through its Director, Sh. CHARANJIT WADHAWAN duly empowered by the Board of Directors vide their Board Resolution dated 16.02.2011 duly empowered by the Board of Directors vide their Board Resolution dated 16.02.2011 (Hereinafter called the VENDOR of the First part.)

A N D

M/s Pawan Buildwell Pvt. Ltd., A Company incorporated under the provisions of Indian Companies Act, having its Registered Office situated at 59-A, Lane C-5, Central Avenue, Sainik Farm, New Delhi through its Director, Sh. RAMESH KUMAR SUNEJA R/o 59-A Lane C-5, Central Avenue, Sainik Farm, New Delhi - 110062 duly authorized by Board Resolution dated 25.02.2011 (Hereinafter called the VENDEE of the Second part.)

For Pawan Buildwell Pvt. Ltd.
Ramesh Kumar Sunjeja
Director

For Star Touch India Pvt. Ltd.
Charanjit Wadhawan
Director

1

(The words and expressions VENDOR and VENDEE shall, unless the context does not so admit, mean and include their heirs, executors, administrators, representatives, successors and permitted assigns)

IN RESPECT OF

ALL THAT Commercial Office Space measuring an area of 3913.05 Sq. Ft. Super Built-up area, fully air conditioned and 100% Power back-up with Generators on 5th Floor in Brahm Datt Tower, Plot No. 3, Block K situated in Sector -18, NOIDA, Gautam Budh Nagar (U.P.) (Hereinafter referred to as Property).

WHEREAS the Vendor represented before the Vendee as under:-

- I. That he has attained the age of majority and competent to contract.
- II. That he is the sole and absolute owner and in possession of above mentioned **ALL THAT Commercial Office Space measuring an area of 3913.05 Sq. Ft. Super Built-up area, fully air conditioned and 100% Power back-up with Generators on 5th Floor in Brahm Datt Tower, Plot No. 3, Block K situated in Sector -18, NOIDA, Gautam Budh Nagar (U.P.)** being built by Som Datt Construction Company.
- III. That the Vendor acquired the **Property** by virtue of Sale Agreement dated 11.02.2003 duly executed by M/s Som Datt Construction Company. That the Vendor fulfills all the terms and conditions of the builder and has already made the full and final payment of the property to the builder.
- IV. That the **PROPERTY**, described here above, is free from all kinds of encumbrances, charges, liens, mortgages decree, surety, attachments, demands, injunctions, right of claim by way of sale, gift and also free from all legal disputes, injunctions and restraints.
- V. That the Vendor has clear title of the said property and is competent and entitled to sell it or dispose it off in any way or manner. If some body else claims any right, title and interest in the said property as owner or otherwise or raise any objection for the sale of the same to the Vendee or the nominees(s) of the Vendee, then he shall be liable and responsible to make good the losses thus suffered by the Vendee or the nominee(s) beside payment of damages as demanded by the Vendee.
- VI. That he is desirous to sell **ALL THAT Commercial Office Space measuring an area of 3913.05 Sq. Ft. Super Built-up area, fully air conditioned and 100% Power back-up with Generators on 5th Floor in Brahm Datt Tower, Plot No. 3, Block K situated in Sector -18, NOIDA, Gautam Budh Nagar (U.P.)** against the total valuable sale consideration of **Rs. 1,80,00,000/- [RUPEES ONE CRORE EIGHTY LAKH ONLY]**

AND WHEREAS the Vendee aforesaid believing the above said representations of the VENDOR to be true and correct, has agreed to purchase the said property

For Pawan Eudonell Pvt. Ltd.
Ramesh Kumar Sunjea

2
Director

For Star Touch India Pvt. Ltd.

[Signature] Director

ANNEXURE - B

FIRST TRANSFER

I/We hereby transfer / assign all the rights and liabilities under this Agreement in favour of

Name : PAWAN BUILDWELL PVT LTD

S/o : _____

Address : 59-A, LANE C-5, CENTRAL AVENUES,
SAIMR FARM NEW DELHI - 62

The above person is now the owner of the property.

For Star Touch India Pvt. Ltd.

[Signature]
Director

Name

S/o

Address

I/We hereby accept all rights and liabilities assigned under this Agreement in my / our favour by STAR TOUCH INDIA PVT LTD

For Pawan Buildwell Pvt. Ltd.

Ramesh Kumar Suneja
Director

Name

S/o

Address

Witness

[Signature]
S. K. Bhanija
810 Late Shri Govardhan Das
S. K. Bhanija
NIT Patiala
[Signature]
990, Sector 14, Gurgaon

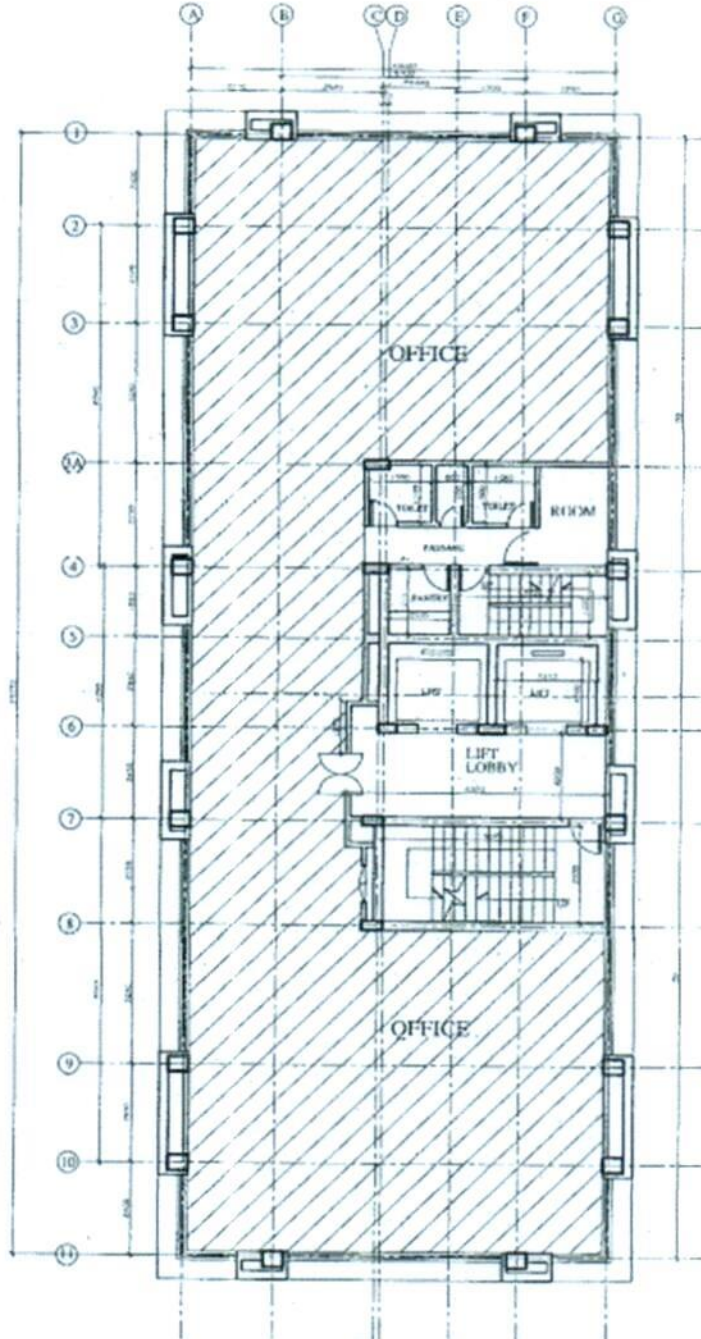

FIRST FLOOR PLAN
LVL + 56.50

BRAHM DATT TOWER
(SAME UPTO 5TH FLOOR)

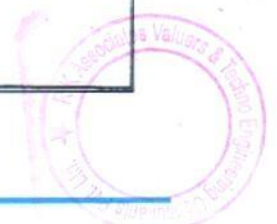

3. The Lessors(s) do and each of them doth hereby covenant with Lessee as follows:-
- On the lessee paying monthly rent hereby reserved and covenants and conditions herein contained and on the part of the Lessee to be observed the Lessee shall quietly hold, possess and enjoy the demised premises and every part thereof during the period of lease or any extension thereof without any interruption from or by the Lessor(s) or any person or persons lawfully or equitably claiming by/ through/ under or in trust for the Lessor/s or successors or assigns.
 - The Lessor(s), shall not nor shall he/they allow any person to use or carry on any noisy hazardous occupation or business in or upon any part of the said premises or any adjoining premises thereon which may cause annoyance or inconvenience to and/or otherwise likely to be prejudicial to the interest of the lessee at the demised premises.
 - The Lessor(s), during the lease or extension thereof shall pay all present and future municipal taxes assessments and/or other outgoing or impositions whatsoever payable by the owner and /or occupier in respect of the demised premises under the law for the time being in force and shall keep the lessee/s indemnified against all claims, demands, action, suits and proceedings in respect of the same.
 - The Lessor/s shall maintain at his/their cost adequate and continuous supply of electricity and hygienic, potable filtered and /or tube-well water by means of electrical water pumps and overhead tanks or otherwise for the use of the lessee in the demised and to operate and maintain the water pumps in proper condition at their cost.
 - The Lessor(s) at his/their own cost, shall effect major repairs to the demised premises and or replacement of plumbing, sanitary, electric, fixtures supplied by them, doors, windows glass panes as and when the need arises and upon the request from the lessee for such repairs etc. The Lessors shall keep the demised premises wind and water tight and maintain proper repair and condition, the electric, sanitary, water, fittings, equipments and appliances, pipelines, drains and sewers and execute all repairs to the demised premises as and when required and also whitewash, color painting of the interior and exterior of the demised premises at least once in every three years, including painting of the doors and windows.

Ramesh Kumar Suneja
Director

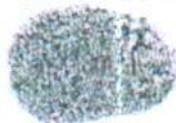

कुते भारतीय स्टेट बैंक
For STATE BANK OF INDIA
मुख्य प्रबंधक/Chief Manager
एनएच-1, बंगला, सेक्टर-18, नोएडा
SBI Branch, Sector 18, Noida

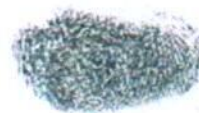



INDIA NON JUDICIAL
Government of Uttar Pradesh
e-Stamp



सत्यमेव जयते

Certificate No. : IN-UP03878359853043P
Certificate Issued Date : 25-Nov-2017 11:51 AM
Account Reference : SHCIL (FI)/ upshcil01/ NOIDA/ UP-GBN
Unique Doc. Reference : SUBIN-UPUPSHCIL0104666782024249P
Purchased by : PAWAN BUILDWELL PVT LTD
Description of Document : Article 35 Lease
Property Description : 5TH FLOOR, PLOT NO.K-3, BRAHAM DUTT TOWER, SECTOR-18, NOIDA
Consideration Price (Rs.) :
First Party : PAWAN BUILDWELL PVT LTD
Second Party : STATE BANK OF INDIA
Stamp Duty Paid By : PAWAN BUILDWELL PVT LTD
Stamp Duty Amount(Rs.) : 3,73,000
 (Three Lakh Seventy Three Thousand only)

.....Please write or type below this line.....

For Pawan Buildwell Pvt. Ltd.

Ramesh Kumar Sunjeja

Director

कुते भारतीय स्टेट बैंक
For STATE BANK OF INDIA

Ashwini

मुख्य प्रबंधक/Chief Manager
एनएचई हाउस, सेक्टर-18, नोएडा
SME Branch, Sector-18, Noida

0005188744

Statutory Alert:
1. The authenticity of this Stamp Certificate should be verified at "www.shoilestamp.com". Any discrepancy in the details on this Certificate and as available on the website renders it invalid.

PASHCHIMANCHAL VIDYUT VITRAN NIGAM LIMITED

पश्चिमंचल विद्युत वितरण निगम लि०

सहायता के लिए संपर्क करें / For Assistance Dial

कार्ड नं० / WhatsApp No:

1912
7859804803

विद्युत बीजक /Electricity Bill

खाता नं./Account No.	6156333000	क्षेत्र /Division	EUDD III NOIDA, DIV 141023)
नाम /Name	RAMESH KUMAR SUNEJA	उपक्षेत्र /Subdivision	SDD1410234
पिता/पति का नाम Father/Husband name		अनुमत भार /Sanctioned Load	20 KW
घर /Address	K 2 TOWER SEC 18 NOIDA, NOIDA, UP, IND	मीटर का संख्या/Meter S.No.	U026251
		टैरिफ /Tariff	LMV2
		आपूर्ति प्रकार /Supply Type	22
मोबाइल नंबर /Mobile No.	XXXXXX4400	भार सुरक्षा जमा /Security Deposit	2000
		दिशाना : डि लॉन्गिट्यूड Dirn Latit : Di Longitude	0
ईमेल /Email	XXXXXXX@gmail.com	संयोजन तिथि /Connection Date	01-JAN-1911

Scan & Pay your Bill

स्कैन करें और अपने बिल का भुगतान करें

बिल संख्या /Bill No.	615843130983	बिल आधार/Bill Basis	OK	दिए जाने वाले Due Date	23-SEP-2023
बिल की तिथि/Bill Date	09-SEP-2023	बिल दर/Billed Demand	20.92	दिए जाने वाले Due Date Rebate	344.17
बिल माह/Bill Month	SEP-2023	प्रगती सब्सिडी/Progressive Subsidy		दिए जाने वाले Payable By Due Date	36570
नेट बिल यूनिट/Net Billed Unit	3457	प्रगतीकरिता रशि Inoperative Amount	0	अच्छेतर दिनांक /Disconnection Date	30-SEP-2023

This bill will be considered as final notice under section 171 of Supply Code 2006. Supply can be disconnected at any date on non-payment of old dues.
इस बिल को अंतर्हीन स्थिति 2006 की धारा 171 के तहत अंतिम सूचित कर दिया जा रहा है। पुरानी देयता का भुगतान न करने पर आपूर्ति को किसी भी तिथि पर अंतर्हीन करी जा सकती है।

Details	Gross Amt	Amount	Subsidy	Amount	Details	Amount
ऊर्जा चार्ज /Energy Charges	25943.88	0.00	25943.88	परिश्रम स्वामित्व/Interest on Security	-85.00	
स्थिर मांग चार्ज /Fixed/Demand Charges	8472.60	0.00	8472.60	देय प्रतिभूति /Due Security	0	
न्यूनतम चार्ज /Min Charge	0.00	0.00	0.00	टी डी एस एम/TDS Amount	0	
विद्युत कर /Electricity Duty			2581.24	टी सी एस टैक्स/TCS Amount	0	
हरी ऊर्जा शुल्क /Green EC			0.00	सी जी एस टी/CGST	0	
अतिरिक्त मांग दण्ड /Excess Demand Penalty			0.00	एस जी एस टी/SGST	0	
कम पी एफ अतिरिक्त/Low P.F. Surcharge			0.00	वर्तमान बिजली भुगतान अतिरिक्त/Current LPSC	1.88	
अग्रिम समाधान/Provisional Adjustment			0.00	नेट करंट बिल /Net Current Bill	36914.60	
टैरिफ समायोजन /Tariff Adjustments			0.00	देय तिथि पूरा समाधान/Prev. Due Date Rebate Adj.	-367.9	
क्रेडिट /Credit			0	अग्रिम धनराशि /Arrear Amount	367.72	
डेबिट/Debit			0	पुरव्व बिजली भुगतान अतिरिक्त /Prev. Arrear LPSC	0.00	
विभिन्न शुल्क/ Misc Charges			0.00			
छूट/Rebate			0			
मुआवज़ा रशि /Compensation Amt				देय राशि /Payable Amount	36914	
किस्ता/Instalment			0.00			
अनर्पित चेक/Dishonor Cheque			0	अक्षरों में /In Words :	Thirty Six Thousand Nine Hundred Fourteen Rupees Only	
अनर्पित चार्ज /Dishonor Charge			0			
धरो निर्धारण /Thali Assessment			0			

Pay your bill online on - www.uppconline.in - अधिकृत सुविधा सभी उपभोक्ताओं को ऑनलाइन बिलों से प्राप्त कर सकते हैं। Fair price shops, e-Sundries, Jansevadika Kendra and through Vidyal Sahni and Motorwaders सहित बिजली व संबंधित सेवाएं प्राप्त की जा सकती हैं।
ऑनलाइन बिल देने और विद्युत सेवाओं और बिजली मीटर के रखरखाव से संबंधित सभी सेवाओं को प्राप्त किया जा सकता है। नीचे दी गई वेबसाइट पर Pay DDO/Cheque in favour of: EXECUTIVE ENGINEER-EUDD III NOIDA

Meter Badge Number	Meter Status	Recorded CWD	Previous Date	Previous Read	Current Date	Current Read	CWF	MF	Meter Unit	Period Months	Meter Remark
U026251	A		05-AUG-23 05.21	60783	05-SEP-23 00.00	64009	3226	1	3226 KWH	1	OK
U026251	A		05-AUG-23 05.21	23014	05-SEP-23 00.00	26471	3457	1	3457 KVAH	1	OK
U026251	A	20.92						1	20.92 KVA	1	OK

एकीकृत इकाई Assessed Unit	Opening Surplus Solar Units	0.00	Closing Surplus Solar Units	0.00	मीटर युनिट Meter Units	3457
एक बिजली बिल में बिजली बचाव (Energy Saved = Energy Produced) एक बिजली बिल में बिजली बचाव (Energy Saved = Energy Produced) To get electricity related services or give a missed call on 7859804803						
अंतिम भुगतान विवरण /Last Payment Details					अंतिम भुगतान विवरण/Current Payment Details	
अंतिम भुगतान रशि/Last Paid Amount					अंतिम भुगतान रशि/Paid Amount	
अंतिम भुगतान तिथि/Last Paid Date					अंतिम भुगतान तिथि/Paid Date	
					अंतिम भुगतान मोड/Payment Mode	
					अंतिम भुगतान रशि/Receipt No	
WARNING: DEMAND VIOLATED. Visit www.upcconline.com to enhance Load .System will increase Load if violated for 3 continuous months						

Printed By : As On Date: 11-Sep-23 11:58 AM

अधीनस्थ अभियंता EXECUTIVE ENGINEER - EUDD III NOIDA

ENCLOSURE: V – VALUER'S IMPORTANT REMARKS

1.	Valuation is done for the asset found on as-is-where basis which owner/ owner representative/ client/ bank has shown/ identified to us on the site unless otherwise mentioned in the report of which some reference has been taken from the information/ data given in the copy of documents provided to us and informed verbally or in writing out of the standard checklist of documents sought from the client & its customer which they could provide within the reasonable expected time out of the standard checklist of documents sought from them and further based on certain assumptions and limiting conditions. The information, facts, documents, data which has become primary basis of the report has been supplied by the client which has been relied upon in good faith and is not generated by the Valuer.
2.	The client/ owner and its management/ representatives warranted to us that the information they have supplied was complete, accurate and true and correct to the best of their knowledge. All such information provided to us either verbally, in writing or through documents has been relied upon in good faith and we have assumed that it is true & correct without any fabrication or misrepresentation. I/We shall not be held liable for any loss, damages, cost or expenses arising from fraudulent acts, misrepresentations, or willful default on part of the owner, company, its directors, employee, representative or agents.
3.	Legal aspects for eg. Investigation of title, ownership rights, lien, charge, mortgage, lease, sanctioned maps, verification of documents provided to us such as title documents, Map, etc. from any concerned Govt. office etc. have to be taken care by legal expert/ Advocate and same is not done at our end. It is assumed that the concerned Lender/ Financial Institution has asked for the valuation of that property after satisfying the authenticity of the documents given to us for which the legal verification has been already taken and cleared by the competent Advocate before requesting for the Valuation report. I/ We assume no responsibility for the legal matters including, but not limited to, legal or title concerns.
4.	In the course of the valuation, we were provided with both written and verbal information. We have however, evaluated the information provided to us through broad inquiry, analysis and review but have not carried out a due diligence or audit of the information provided for the purpose of this engagement. Our conclusions are based on the assumptions and other information provided to us by the client during the course of the assessment.
5.	Getting cizra map or coordination with revenue officers for site identification is a separate activity and is not part of the Valuation services and same has not been done in this report unless otherwise stated.
6.	Wherever any details are mentioned in the report in relation to any legal aspect of the property such as name of the owner, leases, etc. is only for illustration purpose and should not be construed as a professional opinion. Legal aspects are out of scope of this report. Details mentioned related to legal aspect are only based on the copy of the documents provided to us and whatever we can interpret as a non-legally trained person. This should be cross validated with a legal expert. We do not vouch any responsibility regarding the same.
7.	We have made certain assumptions in relation to facts, conditions & situations affecting the subject of, or approach to this exercise that has not been verified as part of the engagement rather, treated as "a supposition taken to be true". If any of these assumptions prove to be incorrect then our estimate on value will need to be reviewed.
8.	This is just an opinion report based on technical & market information having general assessment & opinion on the indicative, estimated Market Value of the property for which Bank has asked to conduct the Valuation. It doesn't contain any other recommendations of any sort including but not limited to express of any opinion on the suitability or otherwise of entering into any transaction with the borrower.
9.	We have relied on the data from third party, external sources & information available on public domain to conclude the valuation. These sources are believed to be reliable and therefore, we assume no liability for the truth or accuracy of any data, opinions or estimates furnished by others that have been used in this analysis. Where we have relied on the data, opinions or estimates from external sources, reasonable care has been taken to ensure that such data is extracted from authentic sources, however we still can't vouch its authenticity, correctness, or accuracy.
10.	Analysis and conclusions adopted in the report are limited to the reported assumptions, conditions and information came to our knowledge during the course of the work and based on the Standard Operating Procedures, Best Practices, Caveats, Limitations, Conditions, Remarks, Important Notes, Valuation TOR and definition of different nature of values.
11.	Value varies with the Purpose/ Date/ Asset Condition & situation/ Market condition, demand & supply, asset utility prevailing on a particular date/ Mode of sale. The indicative & estimated prospective Value of the asset given in this report is restricted only for the purpose and other points mentioned above prevailing on a particular date as mentioned in the report. If any of these points are different from the one mentioned aforesaid in the Report then this report should not be referred.
12.	Our report is meant ONLY for the purpose mentioned in the report and should not be used for any other purpose. The Report should not be copied or reproduced for any purpose other than the purpose for which it is prepared for. I/we do not take any responsibility for the unauthorized use of this report.
13.	We owe responsibility only to the authority/client that has appointed us as per the scope of work mentioned in the report. We will not be liable for any losses, claims, damages or liabilities arising out of the actions taken, omissions or advice given by any other person. In no event shall we be liable for any loss, damages, cost or expenses arising in any way from fraudulent acts, misrepresentations or willful default on part of the client or companies, their directors, employees or agents.
14.	This report is having limited scope as per its fields & format to provide only the general basic idea of the value of the property prevailing in the market based on the site inspection and documents/ data/ information provided by the client. The suggested indicative prospective estimated value should be considered only if transaction is happened as free market transaction.
15.	The sale of the subject property is assumed to be on an all cash basis. Financial arrangements would affect the price at which the property may sell for if placed on the market.
16.	The actual realizable value that is likely to be fetched upon sale of the asset under consideration shall entirely depend on the demand and supply of the same in the market at the time of sale.
17.	While our work has involved an analysis & computation of valuation, it does not include detailed estimation, design/ technical/ engineering/ financial/ structural/ environmental/ architectural/ compliance survey/ safety audit & works in accordance with generally accepted standards of audit & other such works. The report in this work is not investigative in nature. It is mere an opinion on the likely

	estimated valuation based on the facts & details presented to us by the client and third party market information came in front of us within the limited time of this assignment, which may vary from situation to situation.
18.	Where a sketched plan is attached to this report, it does not purport to represent accurate architectural plans. Sketch plans and photographs are provided as general illustrations only.
19.	Documents, information, data including title deeds provided to us during the course of this assessment by the client is reviewed only upto the extent required in relation to the scope of the work. No document has been reviewed beyond the scope of the work. These are not reviewed in terms of legal rights for which we do not have expertise. Wherever any information mentioned in this report is mentioned from the documents like owners name, etc., it is only for illustration purpose and may not necessary represent accuracy.
20.	The report assumes that the borrower/company/business/asset complies fully with relevant laws and regulations applicable in its area of operations and usage unless otherwise stated, and that the companies/business/assets is managed in a competent and responsible manner. Further, as specifically stated to the contrary, this report has given no consideration to matters of a legal nature, including issues of legal title and compliance with relevant laws, and litigations and other contingent liabilities that are not recorded/reflected in the documents/ details/ information/ data provided to us.
21.	This valuation report is not a qualification for accuracy of land boundaries, schedule (in physical terms), dimensions & identification. For this land/ property survey report can be sought from a qualified private or Govt. surveyor.
22.	This Valuation report is prepared based on the facts of the property on the date of the survey. Due to possible changes in market forces, socio-economic conditions, property conditions and circumstances, this valuation report can only be regarded as relevant as at the valuation date. Hence before financing, Banker/ FI should take into consideration all such future risk and should loan conservatively to keep the advanced money safe in case of the downward trend of the property value.
23.	Valuation of the same asset/ property can fetch different values under different circumstances & situations. For eg. Valuation of a running/ operational shop/ hotel/ factory will fetch better value and in case of closed shop/ hotel/ factory it will have considerable lower value. Similarly, an asset sold directly by an owner in the open market through free market transaction then it will fetch better value and if the same asset/ property is sold by any financier due to encumbrance on it, will fetch lower value. Hence before financing, Lender/ FI should take into consideration all such future risks while financing and take decision accordingly.
24.	Valuation is done for the property identified to us by the owner/ owner representative. At our end we have just visually matched the land boundaries, schedule (in physical terms) & dimensions of the property with reference to the documents produced for perusal. Method by which identification of the property is carried out is also mentioned in the report clearly. Responsibility of identifying the correct property to the Valuer/ its authorized surveyor is solely of the client/ owner for which Valuation has to be carried out. It is requested from the Bank to cross check from their own records/ information if this is the same property for which Valuation has to be carried out to ensure that owner has not misled the Valuer company or misrepresented the property due to any vested interest. Where there is a doubt about the precision position of the boundaries, schedule, dimensions of site & structures, it is recommended that a Licensed Surveyor be contacted.
25.	In India more than 70% of the geographical area is lying under rural/ remote/ non municipal/ unplanned area where the subject property is surrounded by vacant lands having no physical demarcation or having any display of property survey or municipal number / name plate on the property clearly. Even in old locations of towns, small cities & districts where property number is either not assigned or not displayed on the properties clearly and also due to the presence of multiple/ parallel departments due to which ownership/ rights/ illegal possession/ encroachment issues are rampant across India and due to these limitations at many occasions it becomes tough to identify the property with 100% surety from the available documents, information & site whereabouts and thus chances of error, misrepresentation by the borrower and margin of chances of error always persists in such cases. To avoid any such chances of error it is advised to the Bank to engage municipal/ revenue department officials to get the confirmation of the property to ensure that the property shown to Valuer/ Banker is the same as for which documents are provided.
26.	If this Valuation Report is prepared for the Flat/ dwelling unit situated in a Group Housing Society or Integrated Township then approvals, maps of the complete group housing society/ township is out of scope of this report and this report will be made for the specific unit based on the assumption that complete Group Housing Society/ Integrated Township and the subject unit must be approved in all respect.
27.	Due to fragmented & frequent change in building/ urban planning laws/ guidelines from time to time, different laws/ guidelines between regions/ states and no strict enforceability of Building Bye-Laws in India specially in non-metro and scale b & c cities & Industrial areas, property owners many times extend or make changes in the covered area/ layout from the approved/ applicable limits. There are also situations where properties are decades old when there was no formal Building Bye-Laws applicable the time when the construction must have been done. Due to such discrete/ unplanned development in many regions sometimes it becomes tough for the Valuer to determine the exact lawful situation on ground. Unless otherwise mentioned in the report, the covered area present on the site as per site survey will be considered in the Valuation.
28.	Area of the large land parcels of more than 2500 sq.mtr or of uneven shape in which there can be practical difficulty in sample measurement, is taken as per property documents which has been relied upon unless otherwise stated.
29.	Drawing Map, design & detailed estimation of the property/ building is out of scope of the Valuation services.
30.	Valuation is a subjective field and opinion may differ from consultant to consultant. To check the right opinion, it is important to evaluate the methodology adopted and various data point/ information/ factors/ assumption considered by the consultant which became the basis for the Valuation report before reaching to any conclusion.
31.	Although every scientific method has been employed in systematically arriving at the value, there is, therefore, no indisputable single value and the estimate of the value is normally expressed as falling within a likely range.
32.	Value analysis of any asset cannot be regarded as an exact science and the conclusions arrived at in many cases will, of necessity, be subjective and dependent on the exercise of individual judgment. Given the same set of facts and using the same assumptions, expert opinions may differ due to the number of separate judgment decisions, which have to be made. Therefore, there can be no standard formula to establish an indisputable exchange ratio. In the event of a transaction, the actual transaction value achieved may be higher or lower than our indicative analysis of value depending upon the circumstances of the transaction. The knowledge, negotiability and motivations of the buyers and sellers, demand & supply prevailing in the market and the applicability of a discount or

	premium for control will also affect actual price achieved. Accordingly, our indicative analysis of value will not necessarily be the price at which any agreement proceeds. The final transaction price is something on which the parties themselves have to agree. However, our Valuation analysis can definitely help the stakeholders to take informed and wise decision about the Value of the asset and can help in facilitating the arm's length transaction.
33.	This Valuation is conducted based on the macro analysis of the asset/ property considering it in totality and not based on the micro, component, or item wise analysis. Analysis done is a general assessment and is not investigative in nature.
34.	This report is prepared on the RKA V-L1 (Basic) Valuation format as per the client requirement and scope of work. This report is having limited scope as per its fields & format to provide only the general estimated & indicative basic idea of the value of the property prevailing in the market based on the information provided by the client. No detailed analysis, audit or verification has been carried out of the subject property. There may be matters, other than those noted in this report, which might be relevant in the context of the transaction and which a wider scope might uncover.
35.	This is just an opinion report and doesn't hold any binding on anyone. It is requested from the concerned Client/ Bank/ Financial Institution which is using this report for mortgaging the property that they should consider all the different associated relevant & related factors & risks before taking any business decision based on the content of this report.
36.	All Pages of the report including annexures are signed and stamped from our office. In case any paper in the report is without stamp & signature then this should not be considered a valid paper issued from this office.
37.	As per IBA Guidelines & Bank Policy, in case the valuation report submitted by the valuer is not in order, the banks / FIs shall bring the same to the notice of the valuer within 15 days of submission for rectification and resubmission. In case no such communication is received, it shall be presumed that the valuation report has been accepted.
38.	Defect Liability Period is 15 DAYS. We request the concerned authorized reader of this report to check the contents, data, information, and calculations in the report within this period and intimate us in writing at valuers@rkassociates.org within 15 days of report delivery, if any corrections are required or in case of any other concern with the contents or opinion mentioned in the report. If no intimation is received within 15 (Fifteen) days in writing from the date of issuance of the report, then it shall be considered that the report is complete in all respect and has been accepted by the client upto their satisfaction & use and further to which R.K Associates shall not be held responsible in any manner. After this period no concern/ complaint/ proceedings in connection with the Valuation Services will be entertained due to possible change in situation and condition of the property.
39.	Though adequate care has been taken while preparing this report as per its scope, but still we can't rule out typing, human errors, over sightedness of any information or any other mistakes. Therefore, the concerned organization is advised to satisfy themselves that the report is complete & satisfactory in all respect. Intimation regarding any discrepancy shall be brought into our notice immediately. If no intimation is received within 15 (Fifteen) days in writing from the date of issuance of the report, to rectify these timely, then it shall be considered that the report is complete in all respect and has been accepted by the client upto their satisfaction & use and further to which R.K Associates shall not be held responsible in any manner.
40.	Our Data retention policy is of ONE YEAR . After this period we remove all the concerned records related to the assignment from our repository. No clarification or query can be answered after this period due to unavailability of the data.
41.	This Valuation report is governed by our (1) Internal Policies, Processes & Standard Operating Procedures, (2) R.K Associates Quality Policy, (3) Valuation & Survey Best Practices Guidelines formulated by management of R.K Associates, (4) Information input given to us by the customer and (4) Information/ Data/ Facts given to us by our field/ office technical team. Management of R.K Associates never gives acceptance to any unethical or unprofessional practice which may affect fair, correct & impartial assessment and which is against any prevailing law. In case of any indication of any negligence, default, incorrect, misleading, misrepresentation or distortion of facts in the report then we request the user of this report to immediately or at least within the defect liability period to bring all such act into notice of R.K Associates management so that corrective measures can be taken instantly.
42.	R.K Associates never releases any report doing alterations or modifications by pen. In case any information/ figure of this report is found altered with pen then this report will automatically become null & void.
43.	We are fully aware that based on the opinion of value expressed in this report, we may be required to give testimony or attend court / judicial proceedings with regard to the subject assets, although it is out of scope of the assignment, unless specific arrangements to do so have been made in advance, or as otherwise required by law. In such event, the party seeking our evidence in the proceedings shall bear the cost/professional fee of attending court / judicial proceedings and my / our tendering evidence before such authority shall be under the applicable laws.
44.	The final copy of the report shall be considered valid only if it is in hard copy on the company's original letter head with proper stamp and sign on it of the authorized official upon payment of the agreed fees. User shall not use the content of the report for the purpose it is prepared for only on draft report, scanned copy, email copy of the report and without payment of the agreed fees. In such a case the report shall be considered as unauthorized and misused.

