

REPORT FORMAT: V-L2 (Medium - SBI) | Version: 12.0\_Nov.2022

CASE NO. VIS(2023-24)-PL734-634-990

Dated: 29.02.2024

# FIXED ASSETS VALUATION REPORT

OF

NATURE OF ASSETS	BUILT-UP UNIT
CATEGORY OF ASSETS	COMMERCIAL
TYPE OF ASSETS	COMMERCIAL OFFICE UNIT

SITUATED AT

OFFICE NO. CE-4011 & 3 CAR PARKING, BHARAT DIAMOND BOURSE  
COMPLEX, PLOT NO. C-28 AT G-BLOCK BANDRA COMPLEX, TALUKA-  
ANDHERI, MUMBAI – 400 051

- Corporate Valuers
- Business/ Enterprise/ Equity Valuations
- Lender's Independent Engineers (LIE)
- Techno Economic Viability Consultants (TEV)
- Agency for Specialized Airport Monitoring (ASM)
- Project Techno-Financial Advisors
- Chartered Engineers
- Industry/ Trade Rehabilitation Consultants
- NPA Management
- Panel Valuer & Techno Economic Consultants for PSU Banks

REPORT PREPARED FOR

STATE BANK OF INDIA, DIAMOND BRANCH, BKC, BANDRA EAST, MUMBAI

Report and Valuation Query/ issue or escalation you may please contact Incident Manager  
at [valuers@rkassociates.org](mailto:valuers@rkassociates.org). We will appreciate your feedback in order to improve our services.

NOTE: As per IBA & Bank's Guideline please provide your feedback on the report within 15 days of its submission  
after which report will be considered to be correct.

Valuation Terms of Services & Valuer's Important Remarks are available at [www.rkassociates.org](http://www.rkassociates.org) for reference.

**CORPORATE OFFICE:**

D-39, 2nd floor, Sector 2, Noida-201301

Ph - +91-0120-4110117, 4324647, +91 - 9958632707

E-mail - [valuers@rkassociates.org](mailto:valuers@rkassociates.org) | Website: [www.rkassociates.org](http://www.rkassociates.org)



**PART A**

**SNAPSHOT OF THE ASSET/ PROPERTY UNDER VALUATION**

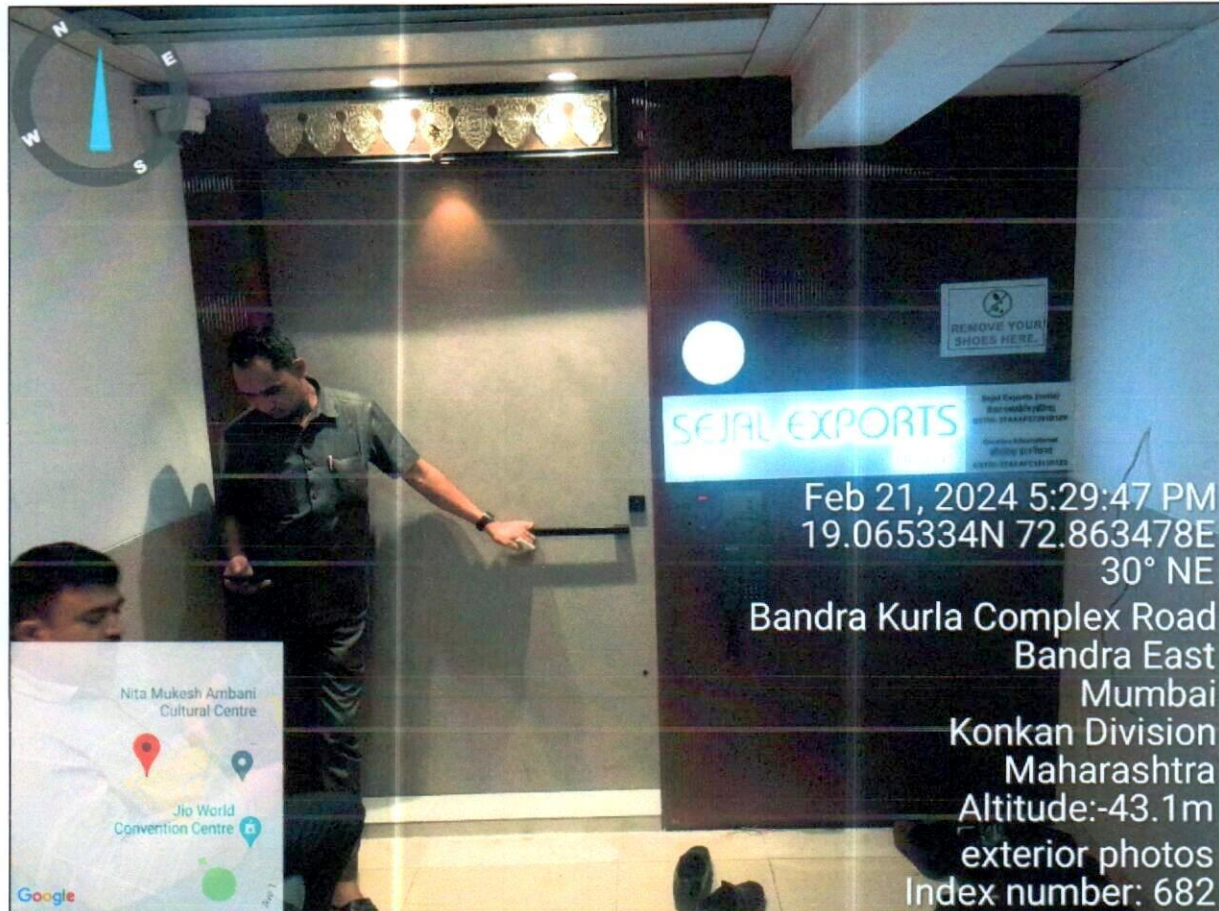

**SITUATED AT**

**OFFICE NO. CE-4011 & 3 CAR PARKING, BHARAT DIAMOND BOURSE  
COMPLEX, PLOT NO. C-28 AT G-BLOCK BANDRA COMPLEX, TALUKA-  
ANDHERI, MUMBAI – 400 051**

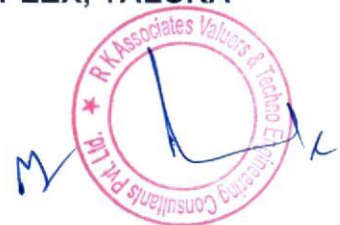



**PART B**

**SBI FORMAT OF OPINION REPORT ON VALUATION**

<b>Name &amp; Address of Branch</b>	State Bank of India, Diamond Branch, BKC, Bandra East, Mumbai
<b>Name of Customer (s)/ Borrower Unit</b>	M/s. Sejal Exports (India)
<b>Work Order No. &amp; Date</b>	Dated 31-02-2024

S.NO.	CONTENTS	DESCRIPTION		
<b>1.</b>	<b>INTRODUCTION</b>			
a.	Name of Property Owner	M/s. Sejal Exports (India) - Partner Mr. Rahul Chandulal Shah (as per copy of documents provided to us)		
	Address & Phone Number of the Owner	Address: Office No. CE-4011 & 3 Car Parking, Bharat Diamond Bourse Complex, Plot No. C-28 at G-Block Bandra Complex, Taluka- Andheri, Mumbai – 400 051		
b.	Purpose of the Valuation	For Value assessment of the asset for creating collateral mortgage for Bank Loan purpose		
c.	Date of Inspection of the Property	31-02-2024		
	Property Shown By	<b>Name</b>	<b>Relationship with Owner</b>	<b>Contact Number</b>
		Mr. Manish Shah	Representative	+91- 98920 56255
d.	Date of Valuation Report	29-02-2024		
e.	Name of the Developer of the Property	---		
	Type of Developer	EPC Contractor		

**2. PHYSICAL CHARACTERISTICS OF THE PROPERTY**

**BRIEF DESCRIPTION OF THE PROPERTY UNDER VALUATION**

This opinion on valuation report is prepared for the property situated at the aforesaid address. As per the copy of Sale Agreement provided to us, the built-up area of the subject property is 567.1 sq.mtr. / 6,102 sq.ft. and carpet area 4,271 sq.ft. along with three car parking spaces.

The subject property is a freehold property and was purchased through E-auction dated 31<sup>st</sup> January 2023. It is located high end commercial area near Neeta Mukesh Ambani Cultural Centre on Bandra Kurla Complex Road Mumbai. All the basic and civic amenities are available within the close proximity of the subject property. Although there is good demand for such property but the property can be owned by diamond merchant only.

This report only contains general assessment & opinion on the Guideline Value and the indicative, estimated Market Value of the property of which Bank/ customer asked us to conduct the Valuation for the property found on as-is-where basis as shown on the site by the Bank/ customer of which photographs is also attached with the report. No legal aspects in terms of ownership or any other legal aspect is taken into consideration. Even if any such information is mentioned in the report it is only referred from the information provided for which we do not assume any responsibility. Due care has been given while doing valuation assessment, but it doesn't contain any due-diligence or audit or verification of any kind other than the valuation computation of the property shown to us on site. Information/ data/ documents given to us by Bank/ client have been relied upon in good faith. This report doesn't contain any other recommendations of any sort.

In case of discrepancy in the address/ property number mentioned in the property documents and the property shown to us at the site due to change in zoning or administrative level at the site or the client misled the valuer by providing the fabricated/ incorrect document or information, the valuation should be considered of the property shown to us at the site by the client of which the photographs are also attached. In case of any doubt,



	best would be to contact the concerned authority/ district administration/ tehsil level for the identification of the property if the property depicted in the photographs in this report is same with the documents pledged.		
<b>a.</b>	<b>Location attribute of the property</b>		
i.	Nearby Landmark	Neeta Mukesh Ambani Cultural Centre	
ii.	Postal Address of the Property	Office No. CE-4011 & 3 Car Parking, Bharat Diamond Bourse Complex, Plot No. C-28 at G-Block Bandra Complex, Taluka- Andheri, Mumbai – 400 051	
iii.	Type of Land	Solid Land/ on road level	
iv.	Independent access/ approach to the property	Clear independent access is available	
v.	Google Map Location of the Property with a neighborhood layout map	Enclosed with the Report Coordinates or URL: 19°03'55.3"N 72°51'51.8"E	
vi.	Details of the roads abutting the property		
	(a) Main Road Name & Width	Bandra Kurla Complex Road	Approx. 100 ft. wide
	(b) Front Road Name & width	Bharat Diamond Bourse Internal Road	Approx. 20 ft. wide
	(c) Type of Approach Road	Bituminous Road	
	(d) Distance from the Main Road	Immediate	
vii.	Description of adjoining property	Its a Commercial complex/ market and all adjoining properties are used for commercial purpose	
viii.	Plot No. / Survey No.	C-28	
ix.	Zone/ Block	---	
x.	Sub registrar	Taluka- Andheri	
xi.	District	Mumbai	
xii.	Any other aspect	Getting cizra map or coordination with revenue officers for site identification is not covered in this Valuation services.	
	(a) List of documents produced for perusal ( <i>Documents has been referred only for reference purpose as provided. Authenticity to be ascertained by legal practitioner</i> )	<b>Documents Requested</b>	<b>Documents Provided</b>
		Total 03 documents requested.	Total 03 documents provided
		Property Title document	Sale Agreement
		Copy of TIR	---
		Last paid Electricity Bill	Last paid Electricity Bill
		--	CAM bill Receipt
			Dated: 09-05-2023
			Dated: 03-01-2024
			Dated: 01-01-2024
	(b) Documents provided by	<b>Bank</b>	
		<b>Name</b>	<b>Relationship with Owner</b>
		Mrs. Sejal	Banker
			+91- 79723 55189
	(c) Identification procedure followed of the property	<input type="checkbox"/> Identified by the owner <input checked="" type="checkbox"/> Identified by owner's representative <input checked="" type="checkbox"/> Done from the name plate displayed on the property <input type="checkbox"/> Cross checked from boundaries or address of the property mentioned in the deed <input type="checkbox"/> Enquired from local residents/ public <input type="checkbox"/> Identification of the property could not be done properly <input type="checkbox"/> Survey was not done	



## VALUATION ASSESSMENT

M/S. SEJAL EXPORTS (INDIA)

	(d) Type of Survey	Full survey (inside-out with approximate measurements & photographs).		
	(e) Is property clearly demarcated by permanent/ temporary boundary on site	Yes demarcated properly		
	(f) Is the property merged or colluded with any other property	No. It is an independent single bounded property		
	(g) City Categorization	Metro City	Urban	
	(h) Characteristics of the locality	Very Good	Within main city	
	(i) Property location classification	Good location within locality	On Wide Road	None
	(j) Property Facing	South Facing		
<b>b.</b>	<b>Area description of the Property</b>	<b>Land</b>	<b>Construction</b>	
	<i>Also please refer to Part-B Area description of the property. Area measurements considered in the Valuation Report is adopted from relevant approved documents or actual site measurement whichever is less, unless otherwise mentioned. Verification of the area measurement of the property is done only based on sample random checking.</i>		Built-up Area	
		NA	567.1 sq.mtr. / 6,102 sq.ft.	
<b>c.</b>	<b>Boundaries schedule of the Property</b>			
i.	Are Boundaries matched	Yes from the available documents		
ii.	<b>Directions</b>	<b>As per Sale Deed/TIR</b>	<b>Actual found at Site</b>	
	East	Not mentioned in the documents	Staircase	
	West	Not mentioned in the documents	CE-4013	
	North	Not mentioned in the documents	Lobby & Lift	
	South	Not mentioned in the documents	Lobby	
<b>3.</b>	<b>TOWN PLANNING/ ZONING PARAMETERS</b>			
a.	Master Plan provisions related to property in terms of Land use	Commercial		
	i. Any conversion of land use done	Not in scope of this report		
	ii. Current activity done in the property	Commercial purpose		
	iii. Is property usage as per applicable zoning	Yes, being used as commercial as per zoning		
	iv. Any notification on change of zoning regulation	No		
	v. Street Notification	Commercial		
b.	Provision of Building by-laws as applicable	<b>PERMITTED</b>	<b>CONSUMED</b>	
	i. FAR/FSI	----	----	
	ii. Ground coverage	----	----	
	iii. Number of floors	----	----	
	iv. Height restrictions	----	----	
	v. Front/ Back/Side Setback	----	----	
	vi. Status of Completion/ Occupational certificate	Completed	Obtained	
c.	Comment on unauthorized construction if any	No		





## VALUATION ASSESSMENT

### M/S. SEJAL EXPORTS (INDIA)

d.	Comment on Transferability of developmental rights	Free hold, complete transferable rights		
e.	i. Planning Area/ Zone	Mumbai Metropolitan Region Development Authority		
	ii. Master Plan Currently in Force	Mumbai Regional Plan		
	iii. Municipal Limits	BMC		
f.	Developmental controls/ Authority	Mumbai Metropolitan Region Development Authority		
g.	Zoning regulations	Commercial		
h.	Comment on the surrounding land uses & adjoining properties in terms of uses	Its a Commercial complex/ market and all adjoining properties are used for commercial purpose		
i.	Comment of Demolition proceedings if any	No		
i.	Comment on Compounding/ Regularization proceedings	No		
j.	Any other aspect	---		
	i. Any information on encroachment	No		
	ii. Is the area part of unauthorized area/ colony	No (As per general information available)		
4.	DOCUMENT DETAILS AND LEGAL ASPECTS OF THE PROPERTY			
a.	Ownership documents provided	Sale Agreement	---	---
b.	Names of the Legal Owner/s	M/s. Sejal Exports (India)		
c.	Constitution of the Property	Free hold, complete transferable rights		
d.	Agreement of easement if any	NA		
e.	Notice of acquisition if any and area under acquisition	No such information came in front of us and could not be found on public domain		
f.	Notification of road widening if any and area under acquisition	No such information came in front of us and could not be found on public domain		
g.	Heritage restrictions, if any	No		
h.	Comment on Transferability of the property ownership	Free hold, complete transferable rights		
i.	Comment on existing mortgages/ charges/ encumbrances on the property, if any	Yes	State Bank of India	
j.	Comment on whether the owners of the property have issued any guarantee (personal or corporate) as the case may be	No information available	NA	
k.	Building plan sanction:			
	i. Is Building Plan sanctioned	NA, since it is a built-up unit valuation.		
	ii. Authority approving the plan	NA		
	iii. Any violation from the approved Building Plan	NA		
	iv. Details of alterations/ deviations/ illegal construction/ encroachment noticed in the structure from the original approved plan	<input type="checkbox"/> Permissible Alterations	---	
		<input type="checkbox"/> Not permitted alteration	---	
l.	Whether Property is Agricultural Land if yes, any conversion is contemplated	No not an agricultural property		
m.	Whether the property SARFAESI complaint	Yes		
n.	i. Information regarding municipal taxes (property tax, water tax, electricity bill)	Property Tax	---	
		Water Tax	NA	
		Electricity Bill	03-01-2024	
	ii. Observation on Dispute or Dues if any in payment of bills/ taxes	No such information came to knowledge on site		
	iii. Is property tax been paid for this property	---		



iv.	Property or Tax Id No.	---
o.	Whether entire piece of land on which the unit is set up / property is situated has been mortgaged or to be mortgaged	No
p.	Qualification in TIR/Mitigation suggested if any	Legal opinion has to be given by Advocate/ legal expert.
q.	Any other aspect	Legal aspects, Title verification, Verification of authenticity of documents from originals or cross checking from any Govt. deptt. of the property is not covered under this valuation and have to be taken care by legal expert/ Advocate.  Wherever any details are mentioned in the report in relation to any legal aspect of the property such as name of the owner, leases, etc. is only for illustration purpose and this should not be construed as a professional opinion.
i.	Property presently occupied/ possessed by	Owner

\*NOTE: Please see point 6 of Enclosure: VIII – Valuer's Important Remarks

<b>5.</b>	<b>ECONOMIC ASPECTS OF THE PROPERTY</b>	
a.	Reasonable letting value/ Expected market monthly rental	~7-8 Lakh
b.	Is property presently on rent	No
i.	Number of tenants	NA
ii.	Since how long lease is in place	NA
iii.	Status of tenancy right	NA
iv.	Amount of monthly rent received	NA
c.	Taxes and other outgoing	---
d.	Property Insurance details	No information available
e.	Monthly maintenance charges payable	Rs.6,102/- Per Month
f.	Security charges, etc.	Rs.6,102/- Per Month
g.	Any other aspect	NA
<b>6.</b>	<b>SOCIO - CULTURAL ASPECTS OF THE PROPERTY</b>	
a.	Descriptive account of the location of the property in terms of Social structure of the area in terms of population, social stratification, regional origin, age groups, economic levels, location of slums/squatter settlements nearby, etc.	Very High Income group
b.	Whether property belongs to social infrastructure like hospital, school, old age homes etc.	No
<b>7.</b>	<b>FUNCTIONAL AND UTILITARIAN SERVICES, FACILITIES &amp; AMENITIES</b>	
a.	Description of the functionality & utility of the property in terms of:	
i.	Space allocation	Yes
ii.	Storage spaces	Yes
iii.	Utility of spaces provided within the building	Yes
iv.	Car parking facilities	Yes
v.	Balconies	No





<b>b. Any other aspect</b>													
i. Drainage arrangements		Yes											
ii. Water Treatment Plant		No											
iii. Power Supply arrangements		Permanent		Yes									
		Auxiliary		Yes, D.G sets									
iv. HVAC system		Yes											
v. Security provisions		Yes											
vi. Lift/ Elevators		Yes											
vii. Compound wall/ Main Gate		Yes											
viii. Whether gated society		Yes											
<b>Internal development</b>													
Garden/ Park/ Land scraping		Water bodies		Internal roads		Pavements		Boundary Wall					
Yes		No		Yes		Yes		Yes					
<b>8. INFRASTRUCTURE AVAILABILITY</b>													
<b>a. Description of Aqua Infrastructure availability in terms of:</b>													
i. Water Supply		Yes											
ii. Sewerage/ sanitation system		Underground											
iii. Storm water drainage		Yes											
<b>b. Description of other Physical Infrastructure facilities in terms of:</b>													
i. Solid waste management		Yes, by the local Authority											
ii. Electricity		Yes											
iii. Road and Public Transport connectivity		Yes											
iv. Availability of other public utilities nearby		Transport, Market, Hospital etc. available in close vicinity											
<b>c. Proximity &amp; availability of civic amenities &amp; social infrastructure</b>													
School		Hospital		Market		Bus Stop		Railway Station		Metro		Airport	
~0.5 km		~1 km		~1.5 km		~0.5 km		~2.5 km		~5 km		~10 km	
Availability of recreation facilities (parks, open spaces etc.)				Yes ample recreational facilities are available in the vicinity.									
<b>9. MARKETABILITY ASPECTS OF THE PROPERTY</b>													
<b>a. Marketability of the property in terms of</b>													
i. Location attribute of the subject property		Very Good											
ii. Scarcity		Similar kind of properties are easily available in this area.											
iii. Demand and supply of the kind of the subject property in the locality		Good demand of such properties in the market.											
iv. Comparable Sale Prices in the locality		Please refer to Part D: Procedure of Valuation Assessment											
b. Any other aspect which has relevance on the value or marketability of the property		No											
i. Any New Development in surrounding area		No				NA							
ii. Any negativity/ defect/ disadvantages in the property/ location		No				NA							
<b>10. ENGINEERING AND TECHNOLOGY ASPECTS OF THE PROPERTY</b>													
a. Type of construction		Structure		Slab		Walls							



		RCC	RCC	Brick walls + Glass façade
b.	Material & Technology used	Material Used		Technology used
		Grade A material		RCC Framed structure
c.	Specifications			
	i. Roof	Floors/ Blocks	Type of Roof	
		4 <sup>th</sup> Floor	RCC	
	ii. Floor height	10 ft.		
	iii. Type of flooring	Vitrified Tiles		
	iv. Doors/ Windows	Wooden & Glass Doors and Glass Windows		
	v. Class of construction/ Appearance/ Condition of structures	Exterior: Very Good Interior: Very Good		
	vi. Interior Finishing & Design	Designer coved roof, Designer textured walls		
	vii. Exterior Finishing & Design	Architecturally designed or elevated		
	viii. Interior decoration/ Special architectural or decorative feature	Beautifully & aesthetically designed interiors		
	ix. Class of electrical fittings	Internal / High quality fittings used		
	x. Class of sanitary & water supply fittings	Internal / High quality fittings used		
d.	Maintenance issues	No maintenance issue, structure is maintained properly		
e.	Age of building/ Year of construction	15 years	~2009	
f.	Total life of the structure/ Remaining life expected	70 years	~55 years subject to proper and timely maintenance	
g.	Extent of deterioration in the structure	No deterioration came into notice through visual observation		
h.	Structural safety	Structure built on RCC technique so it can be assumed as structurally stable. However no structural stability certificate is available		
i.	Protection against natural disasters viz. earthquakes etc.	Since this is a RCC structure so should be able to withstand moderate intensity earthquakes. Comments are been made only based on visual observation and not any technical testing.		
j.	Visible damage in the building if any	No visible damages in the structure		
k.	System of air conditioning	Fully centrally AC		
l.	Provision of firefighting	Fire Extinguishers available		
m.	Copies of the plan and elevation of the building to be included	NA		
11. ENVIRONMENTAL FACTORS				
a.	Use of environment friendly building materials like fly ash brick, other green building techniques if any	Regular building materials are used		
b.	Provision of rainwater harvesting	No		
c.	Use of solar heating and lighting systems, etc.	No		
d.	Presence of environmental pollution in the vicinity of the property in terms of industries, heavy traffic, etc. if any	Yes, regular vehicular pollution present		
12. ARCHITECTURAL AND AESTHETIC QUALITY OF THE PROPERTY				
a.	Descriptive account on whether the building is modern, old fashioned, etc., plain looking or with	Modern structure		

</





	decorative elements, heritage value if applicable, presence of landscape elements, etc.	
<b>13.</b>	<b>VALUATION</b>	
a.	Methodology of Valuation – Procedures adopted for arriving at the Valuation	Please refer to <b>Part D: Procedure of Valuation Assessment</b> of the report.
b.	Prevailing Market Rate/ Price trend of the Property in the locality/ city from property search sites	Please refer to <b>Part D: Procedure of Valuation Assessment</b> of the report and the screenshot annexure in the report, if available.
c.	Guideline Rate obtained from Registrar's office/ State Govt. gazette/ Income Tax Notification	Please refer to <b>Point 3 of Part D: Procedure of Valuation Assessment</b> of the report and the screenshot annexure in the report, if available.
d.	<b>Summary of Valuation</b>	For detailed Valuation calculation please refer to <b>Part D: Procedure of Valuation Assessment</b> of the report.
	<b>i. Guideline Value</b>	<b>Rs.18,56,68,540/-</b>
	<b>1. Land</b>	<b>NA</b>
	<b>2. Building / Built-up Unit</b>	<b>Rs.18,56,68,540/-</b>
	<b>ii. Indicative Prospective Estimated Fair Market Value</b>	<b>Rs.31,51,00,000/-</b>
	<b>iii. Expected Estimated Realizable Value</b>	<b>Rs.28,35,90,000/-</b>
	<b>iv. Expected Forced/ Distress Sale Value</b>	<b>Rs.25,20,80,000/-</b>
	<b>v. Valuation of structure for Insurance purpose</b>	<b>~Rs.25,00,00,000/-</b>
e.	<b>i. Justification for more than 20% difference in Market &amp; Circle Rate</b>	Circle rates are determined by the District administration as per their own theoretical internal policy for fixing the minimum valuation of the property for property registration tax collection purpose and Market rates are adopted based on prevailing market dynamics found as per the discrete market enquiries which is explained clearly in Valuation assessment factors.
	<b>ii. Details of last two transactions in the locality/ area to be provided, if available</b>	No authentic last two transactions details could be known. However prospective transaction details as per information available on public domain and gathered during site survey is mentioned in <b>Part D: Procedure of Valuation Assessment</b> of the report and the screenshots of the references are annexed in the report for reference.
<b>14.</b>	<b>Declaration</b>	<p>a. The information provided by us is true and correct to the best of our knowledge and belief.</p> <p>b. The analysis and conclusions are limited by the reported assumptions, limiting conditions, remarks.</p> <p>c. Firm have read the Handbook on Policy, Standards and Procedures for Real Estate Valuation by Banks and HFIs in India, 2009 issued by IBA and NHB, fully understood the provisions of the same and followed the provisions of the same to the best of our ability and this report is in conformity to the Standards of Reporting enshrined in the above Handbook as much as practically possible in the limited time available.</p> <p>d. Procedures and standards adopted in carrying out the valuation and is mentioned in Part-D of the report which may have certain departures to the said IBA and IVS standards in order to provide better, just &amp; fair valuation.</p> <p>e. No employee or member of R.K Associates has any direct/ indirect interest in the property.</p>



**VALUATION ASSESSMENT**

M/S. SEJAL EXPORTS (INDIA)

- f. Our authorized surveyor **Anit Bhanji** has visited the subject property on **21/2/2024** in the presence of the owner's representative with the permission of owner.
- g. Firm is an approved Valuer of the Bank.
- h. We have not been depanelled or removed from any Bank/Financial Institution/Government Organization at any point of time in the past.
- i. We have submitted the Valuation Report directly to the Bank.

**15. ENCLOSED DOCUMENTS**

a.	Layout plan sketch of the area in which the property is located with latitude and longitude	Google Map enclosed with coordinates
b.	Building Plan	Not Available
c.	Floor Plan	Not Available
d.	Photograph of the property (including geo-stamping with date) and owner (in case of housing loans, if borrower is available) including a "Selfie" of the Valuer at the site	Enclosed with the report along with other property photographs
e.	Certified copy of the approved / sanctioned plan wherever applicable from the concerned office	Not Available
f.	Google Map location of the property	Enclosed with the Report
g.	Price trend of the property in the locality/city from property search sites viz Magickbricks.com, 99Acres.com, Makan.com etc.	Enclosed with the Report
h.	Any other relevant documents/extracts (All enclosures & annexures to remain integral part & parcel of the main report)	i. Part C: Area Description of the Property ii. Part D: Procedure of Valuation Assessment iii. Google Map iv. References on price trend of the similar related properties available on public domain, if available v. Photographs of the property vi. Copy of Circle Rate vii. Important property documents exhibit viii. Annexure: VI - Declaration-Cum-Undertaking ix. Annexure: VII - Model Code of Conduct for Valuers x. Part E: Valuer's Important Remarks
i.	<b>Total Number of Pages in the Report with enclosures</b>	<b>43</b>





ENCLOSURE: I

**PART C**

**AREA DESCRIPTION OF THE PROPERTY**

1.	Land Area considered for Valuation	---	
	Area adopted on the basis of	NA	
	Remarks & observations, if any	NA	
2.	Constructed Area considered for Valuation (As per IS 3861-1966)	<b>Built-up Area</b>	567.1 sq.mtr. / 6,102 sq.ft.
	Area adopted on the basis of	Property documents & site survey both	
	Remarks & observations, if any	The area is considered as per the documents provided to us and has been cross verified by the measurement during the site survey.	

**Note:**

1. Area measurements considered in the Valuation Report pertaining to Land & Building is adopted from relevant approved documents or actual site measurement whichever is less. All area measurements are on approximate basis only.
2. Verification of the area measurement of the property is done based on sample random checking only.
3. Area of the large land parcels of more than 2500 sq.mtr or of uneven shape, is taken as per property documents verified with digital survey through google which has been relied upon.
4. Drawing Map, design & detailed estimation of the property/ building is out of scope of the Valuation services.





ENCLOSURE: II

**PART D**

**PROCEDURE OF VALUATION ASSESSMENT**

1.		GENERAL INFORMATION			
i.	Important Dates	Date of Appointment	Date of Inspection of the Property	Date of Valuation Assessment	Date of Valuation Report
		21 February 2024	21 February 2024	29 February 2024	29 February 2024
ii.	Client	State Bank of India, Diamond Branch, BKC, Bandra East, Mumbai			
iii.	Intended User	State Bank of India, Diamond Branch, BKC, Bandra East, Mumbai			
iv.	Intended Use	To know the general idea on the market valuation trend of the property as per free market transaction. This report is not intended to cover any other internal mechanism, criteria, considerations of any organization as per their own need, use & purpose.			
v.	Purpose of Valuation	For Value assessment of the asset for creating collateral mortgage for Bank Loan purpose			
vi.	Scope of the Assessment	Non binding opinion on the assessment of Plain Physical Asset Valuation of the property identified to us by the owner or through his representative.			
vii.	Restrictions	This report should not be referred for any other purpose, by any other user and for any other date other then as specified above. This report is not a certification of ownership or survey number/ property number/ Khasra number which are merely referred from the copy of the documents provided to us.			
viii.	Manner in which the proper is identified	<input type="checkbox"/>	Identified by the owner		
		<input checked="" type="checkbox"/>	Identified by owner's representative		
		<input checked="" type="checkbox"/>	Done from the name plate displayed on the property		
		<input type="checkbox"/>	Cross checked from boundaries or address of the property mentioned in the deed		
		<input type="checkbox"/>	Enquired from local residents/ public		
		<input type="checkbox"/>	Identification of the property could not be done properly		
		<input type="checkbox"/>	Survey was not done		
ix.	Is property number/ survey number displayed on the property for proper identification?	Yes.			
x.	Type of Survey conducted	Full survey (inside-out with approximate measurements & photographs).			

2.	ASSESSMENT FACTORS		
i.	Valuation Standards considered	Mix of standards such as IVS and others issued by Indian authorities & institutions and improvised by the RKA internal research team as and where it is felt necessary to derive at a reasonable, logical & scientific approach. In this regard proper basis, approach, working, definitions considered is defined below which may have certain departures to IVS.	
ii.	Nature of the Valuation	Fixed Assets Valuation	
iii.	Nature/ Category/ Type/ Classification of Asset under Valuation	<b>Nature</b>	<b>Category</b>
		BUILT-UP UNIT	COMMERCIAL
iv.	Type of Valuation (Basis of Valuation as per IVS)	<b>Type</b>	COMMERCIAL OFFICE UNIT
		<b>Classification</b>	Only business use asset
v.	Present market state of the Asset assumed (Premise of Value as per IVS)	Primary Basis	Market Value & Govt. Guideline Value
		Secondary Basis	On-going concern basis
		Under Normal Marketable State	
		<b>Reason:</b> Asset under free market transaction state	





# VALUATION ASSESSMENT

M/S. SEJAL EXPORTS (INDIA)

vi.	Property Use factor	Current/ Existing Use	Highest & Best Use (in consonance to surrounding use, zoning and statutory norms)	Considered for Valuation purpose
		Commercial	Commercial	Commercial
vii.	Legality Aspect Factor	Assumed to be fine as per copy of the documents & information produced to us. However Legal aspects of the property of any nature are out-of-scope of the Valuation Services. In terms of the legality, we have only gone by the documents provided to us in good faith. Verification of authenticity of documents from originals or cross checking from any Govt. depts. have to be taken care by Legal expert/ Advocate.		
viii.	Class/ Category of the locality	High Class (Very Good)		
ix.	Property Physical Factors	<b>Shape</b> Irregular	<b>Size</b> Medium	<b>Layout</b> Good Layout
x.	Property Location Category Factor	<b>City Categorization</b> Metro City	<b>Locality Characteristics</b> Very Good	<b>Property location characteristics</b> Good location within locality
		Urban developed	High End Within urban developed area	On Wide Road Not Applicable
		<b>Property Facing</b> South Facing		
xi.	Physical Infrastructure availability factors of the locality	<b>Water Supply</b>  Yes from municipal connection	<b>Sewerage/ sanitation system</b>  Underground	<b>Electricity</b>  Yes
		<b>Road and Public Transport connectivity</b>  Easily available		
		<b>Availability of other public utilities nearby</b>  Transport, Market, Hospital etc. are available in close vicinity		<b>Availability of communication facilities</b>  Major Telecommunication Service Provider & ISP connections are available
xii.	Social structure of the area (in terms of population, social stratification, regional origin, age groups, economic levels, location of slums/ squatter settlements nearby, etc.)	Very High Income group		
xiii.	Neighbourhood amenities	Good		
xiv.	Any New Development in surrounding area	No		
xv.	Any specific advantage in the property	The property is in High End Commercial Area designated specifically for diamond merchants.		
xvi.	Any specific drawback in the property	No		
xvii.	Property overall usability/ utility Factor	Very good		
xviii.	Do property has any alternate use?	No		





# VALUATION ASSESSMENT

M/S. SEJAL EXPORTS (INDIA)

xix.	Is property clearly demarcated by permanent/ temporary boundary on site	Demarcated with permanent boundary	
xx.	Is the property merged or colluded with any other property	No	
		Comments: ---	
xxi.	Is independent access available to the property	Clear independent access is available	
xxii.	Is property clearly possessable upon sale	Yes	
xxiii.	Best Sale procedure to realize maximum Value (in respect to Present market state or premise of the Asset as per point (iv) above)	<b>Fair Market Value</b> Free market transaction at arm's length wherein the parties, after full market survey each acted knowledgeably, prudently and without any compulsion.	
xxiv.	Hypothetical Sale transaction method assumed for the computation of valuation	<b>Fair Market Value</b> Free market transaction at arm's length wherein the parties, after full market survey each acted knowledgeably, prudently and without any compulsion.	
xxv.	Approach & Method of Valuation Used	<b>Land</b> <b>Approach of Valuation</b> NA	<b>Method of Valuation</b> NA
		<b>Built-up Unit</b> Market Approach	Market Comparable Sales Method
xxvi.	Type of Source of Information	Level 3 Input (Tertiary)	
xxvii.	<b>Market Comparable</b>		
	References on prevailing market Rate/ Price trend of the property and Details of the sources from where the information is gathered (from property search sites & local information)	1. Name: M/s. Goodwill Properties Contact No.: +91- 92222 22324 Nature of reference: Property Consultant Size of the Property: ~3800-4000 sq.ft. Location: Bharat Diamond Bourse Rates/ Price informed: Around Rs.48,000/- to Rs.52,000/- per sq.ft. Any other details/ Discussion held: As per the discussion with the property dealer of the subject locality we came to know that the rates for the property in the subject area are within the above-mentioned range.	
		2. Name: M/s. Anarock Property Consultant Contact No.: 022- 42934293 Nature of reference: Property Consultant Size of the Property: ~4500-4600 sq.ft. Location: Bharat Diamond Bourse Rates/ Price informed: Around Rs.47,000/- to Rs.51,000/- per sq.ft. Any other details/ Discussion held: As per the discussion with the property dealer of the subject locality we came to know that the rates for the property in the subject area are within the above-mentioned range.	
		<b>NOTE: The given information above can be independently verified to know its authenticity.</b>	
xxviii.	Adopted Rates Justification	As per our discussion with the property dealers we have gathered the following information:	



# VALUATION ASSESSMENT

M/S. SEJAL EXPORTS (INDIA)

Rates for the land plots in the subject locality are around Rs.47,000/- to Rs.52,000/- per sq.ft. along with 3 parking spaces.

Based on the above information and keeping in mind the availability of plots in subject locality we are of the view to adopt a rate of **Rs.50,000/- per sq.ft.** for the purpose of this valuation assessment.

**NOTE:** We have taken due care to take the information from reliable sources. The given information above can be independently verified from the provided numbers to know its authenticity. However due to the nature of the information most of the market information came to knowledge is only through verbal discussion with market participants which we have to rely upon where generally there is no written record. Related postings for similar properties on sale are also annexed with the Report wherever available.

xxix.	<b>Other Market Factors</b>					
	Current Market condition	Normal				
		<b>Remarks: ---</b>				
		<b>Adjustments (-/+): 0%</b>				
	Comment on Property Salability Outlook	Easily sellable				
		<b>Adjustments (-/+): 0%</b>				
	Comment on Demand & Supply in the Market	<table><tr><td><b>Demand</b></td><td><b>Supply</b></td></tr><tr><td>Good</td><td>Adequately available</td></tr></table>	<b>Demand</b>	<b>Supply</b>	Good	Adequately available
<b>Demand</b>	<b>Supply</b>					
Good	Adequately available					
		<b>Remarks: Good demand of such properties in the market</b>				
		<b>Adjustments (-/+): 0%</b>				
xxx.	Any other special consideration	<b>Reason: .</b>				
		<b>Adjustments (-/+): 0%</b>				
xxxi.	Any other aspect which has relevance on the value or marketability of the property	NA				
		Valuation of the same asset/ property can fetch different values under different circumstances & situations such as arm's length transaction Vs lien sale, distress sale, etc. Market value may change with change in market conditions due to political, socio-economic or local factors. It may appreciate or it may devalue. All such risks should be taken into consideration while taking any decision based on this report.				
		<b>Adjustments (-/+): 0%</b>				
xxxii.	<b>Final adjusted &amp; weighted Rates considered for the subject property</b>	<b>Rs.50,000/- per sq.ft.</b>				
xxxiii.	Considered Rates Justification	As per the thorough property & market factors analysis as described above, the considered estimated market rates appears to be reasonable in our opinion.				
xxxiv.	<b>Basis of computation &amp; working</b>					
	<ul style="list-style-type: none"><li>Valuation of the asset is done as found &amp; identified by the client/ owner/ owner representative to our engineers on site during site inspection unless otherwise mentioned in the report.</li><li>Analysis and conclusions adopted in the report are limited to the reported assumptions, conditions and information came to our knowledge during the course of the work and based on the Standard Operating Procedures, Best Practices, Caveats, Limitations, Conditions, Remarks, Important Notes, Valuation TOR and definition of different nature of values.</li><li>For knowing comparable market rates, significant discreet local enquiries have been made by us representing hypothetically as buyer or seller for the similar type of properties in the subject location. Based on this information and various factors of the property, a rate has been judiciously taken considering the factors of the subject property, market scenario and weighted adjusted comparison with the comparable properties unless otherwise stated.</li><li>References regarding the prevailing market comparable rates are based on the verbal/ informal/ secondary/ tertiary information collected by our team from the local people/ property consultants/ recent deals/ demand-supply/ internet postings. This third-party information is relied upon as available or can be fetched within the limited time &amp; resources of the assignment during market survey in the subject location. No written record is generally available for such market information and analysis has to be derived mostly based on</li></ul>					



the verbal information.

- Market Rates are rationally adopted based on the facts of the property which came to our knowledge during the course of the assessment considering many factors like nature of the property, size, location, approach, market situation and trends and comparative analysis with the similar assets. During comparative analysis, valuation metrics is prepared and necessary adjustments are made on the subject asset.
- The suggested indicative value is based on the prevailing market rates that came to our knowledge during secondary & tertiary market research and is not split into formal & informal payment arrangements. In Indian real estate sector most of the deals takes place includes both formal & informal payment components. Deals in complete formal payment component may realize relatively less value on transaction due to inherent added tax, stamp registration liabilities on the buyer.
- Secondary/ Tertiary costs related to asset transaction like Stamp Duty, Registration charges, Brokerage, Commission, Bank interest, Selling cost, Marketing cost, etc. pertaining to the sale/ purchase of this property are not considered while assessing the indicative estimated Market Value.
- This report includes both, Govt. Guideline Value and Indicative Estimated Prospective Market Value as described above. As per the current market practice, in most of the cases, formal transaction takes place for an amount less than the actual transaction amount and rest of the payment is normally done informally.
- Area measurements considered in the Valuation Report pertaining to asset/ property is adopted from relevant approved documents or sample site measurement whichever is less unless otherwise mentioned. All area measurements are on approximate basis only.
- Verification of the area measurement of the property is done based on sample random checking only.
- Area of the large land parcels of more than 2500 sq.mtr or of uneven shape in which there can be practical difficulty in sample measurement, is taken as per property documents which has been relied upon unless otherwise stated.
- Drawing, Map, design & detailed estimation of the property/ building is out of scope of the Valuation services.
- Construction rates are adopted based on the present market replacement cost of construction and calculating applicable depreciation & deterioration factor as per its age, existing condition & specifications based on visual observation only of the structure. No structural, physical tests have been carried out in respect of it. No responsibility is assumed for latent defects of any nature whatsoever, which may affect value, or for any expertise required to disclose such conditions.
- Construction rates are adopted based on the plinth area rates prevailing in the market for the structure as a whole and not based on item wise estimation or Bills of Quantity method unless otherwise stated.
- The condition assessment and the estimation of the residual economic life of the structure are only based on the visual observations and appearance found during the site survey. We have not carried out any structural design or stability study; nor carried out any physical tests to assess structural integrity & strength.
- Any kind of unpaid statutory, utilities, lease, interest or any other pecuniary dues on the asset or on its owners has not been factored in the Valuation.
- This Valuation is conducted based on the macro analysis of the asset/ property considering it in totality and not based on the micro, component or item wise analysis. Analysis done is a general assessment and is neither investigative in nature nor an audit activity.
- Valuation is done for the asset found on as-is-where basis which owner/ owner representative/ client/ bank has shown to us on site of which some reference has been taken from the information/ data given in the copy of documents provided to us which have been relied upon in good faith and we have assumed that it to be true and correct.
- The ownership, address in the report is only for illustration purpose which is taken from the documents provided to us. In case of any update in information, change of zoning, delimitation activity or inaccuracy in the documents or incorrect/ fabricated/ out-of-date documents provided to us or for any other reason beyond our control then we shall not be held responsible for it.

**xxxv. ASSUMPTIONS**

- Documents/ Information/ Data provided by the client/ property owner or his representative both written & verbally is true, complete, and correct without any fabrication and has been relied upon in good faith.
- Local verbal enquiries during micro market research came to our knowledge taken on record are assumed to be true & correct.
- The assets and interests valued are assumed to be free and clear of any liens or encumbrances unless stated otherwise. No hidden or apparent conditions regarding the subject assets or their ownership are



assumed to exist. No opinion of title is rendered in this report and a good title is assumed unless stated otherwise.

- d. If this valuation is for the Bank then it is assumed that the valuation has been asked only after satisfying the authenticity of the documents given to us and the legal verification has been already taken and cleared by the competent Advocate before requesting for the Valuation report. / We assume no responsibility for the legal matters including, but not limited to, legal or title concerns.
- e. Payment condition during transaction of the subject property in the Valuation has been considered on all cash bases which includes both formal & informal payment components as per market trend.
- f. Sale transaction method of the asset is assumed as Free market transaction without any compulsion unless otherwise mentioned while assessing Indicative & Estimated Fair Prospective Market Value of the asset unless otherwise stated.
- g. If this Valuation Report is prepared for the Flat/ dwelling unit situated in a Group Housing Society or Integrated Township then approvals, maps of the complete group housing society/ township is out of scope of this report. This valuation report is prepared for the specific unit based on the assumption that complete Group Housing Society/ Integrated Township is approved and complied with all relevant laws and the subject unit is also approved within the Group Housing Society/ Township.

xxxvi. **SPECIAL ASSUMPTIONS**

None

xxxvii. **LIMITATIONS**

None

3.	VALUATION OF BUILT-UP UNIT		
	Particulars	Govt. Circle/ Guideline Value	Indicative & Estimated Prospective Fair Market Value
a.	Prevailing Rate range	Rs.3,27,400/- per sq.mtr	Rs.47,000/- to Rs.52,000/- per sq.ft
b.	Rate adopted considering all characteristics of the property	Rs.3,27,400/- per sq.mtr	Rs.50,000/- per sq.ft
c.	Total Built-Up Area considered (documents vs site survey whichever is less)	567.1 sq.mtr. / 6,102 sq.ft.	567.1 sq.mtr. / 6,102 sq.ft.
d.	Total Value of land (A)	567.1 sq.mtr. x Rs.3,27,400/- per sq.mtr	6,102 sq.ft. x Rs.50,000/- per sq.ft
		<b>Rs.18,56,68,540/-</b>	<b>Rs.30,50,99,800/-</b>

4. **VALUATION COMPUTATION OF LAND**

NA, since it is a built-up unit valuation.

5.	VALUATION OF ADDITIONAL AESTHETIC/ INTERIOR WORKS IN THE PROPERTY		
S. No.	Particulars	Specifications	Depreciated Replacement Value
a.	Add extra for Architectural aesthetic developments, improvements (add lump sum cost)	----	Rs.1,00,00,000/-
b.	Add extra for fittings & fixtures (Doors, windows, wood work, cupboards, modular kitchen, electrical/ sanitary fittings)	----	----





c.	Add extra for services (Water, Electricity, Sewerage, Main gate, Boundary, Lift, Auxiliary power, AC, HVAC, Firefighting etc.)	----	----
d.	Add extra for internal & external development (Internal roads, Landscaping, Pavements, Street lights, Green area development, External area landscaping, Land development, Approach road, etc.)	----	----
e.	<b>Depreciated Replacement Value (B)</b>	----	<b>Rs.1,00,00,000/-</b>
f.	<b>Note:</b> <ul style="list-style-type: none"> <li>Value for Additional Building &amp; Site Aesthetic Works is considered only if it is having exclusive/ super fine work specification above ordinary/ normal work. Ordinary/ normal work value is already covered under basic rates above.</li> <li>Value of common facilities of society are not included in the valuation of Flat/ Built-up unit.</li> </ul>		

6. CONSOLIDATED VALUATION ASSESSMENT OF THE ASSET			
S. No.	Particulars	Govt. Circle/ Guideline Value	Indicative & Estimated Prospective Fair Market Value
1.	Land Value (A)	---	---
2.	Total Built-Up Unit (B)	Rs.18,56,68,540/-	Rs.30,50,99,800/-
3.	Additional Aesthetic Works Value (C)	---	Rs.1,00,00,000/-
4.	<b>Total Add (A+B+C)</b>	<b>Rs.18,56,68,540/-</b>	<b>Rs.31,50,99,800/-</b>
5.	Additional Premium if any	---	---
	Details/ Justification	---	---
6.	Deductions charged if any	---	---
	Details/ Justification	---	---
7.	<b>Total Indicative &amp; Estimated Prospective Fair Market Value</b>	---	<b>Rs.31,50,99,800/-</b>
8.	<b>Rounded Off</b>	---	<b>Rs.31,51,00,000/-</b>
9.	<b>Indicative &amp; Estimated Prospective Fair Market Value in words</b>	---	<b>Rupees Thirty-One Crore Fifty-One Lakh Only</b>
10.	<b>Expected Realizable Value (@ ~10% less)</b>	---	<b>Rs.28,35,90,000/-</b>
11.	<b>Expected Distress Sale Value (@ ~20% less)</b>	---	<b>Rs.25,20,80,000/-</b>
12.	<b>Percentage difference between Circle Rate and Fair Market Value</b>	More than 20%	
13.	<b>Concluding Comments/ Disclosures if any</b>		
	a. We are independent of client/ company and do not have any direct/ indirect interest in the property. b. This valuation has been conducted by R.K Associates Valuers & Techno Engineering Consultants (P) Ltd. and its team of experts. c. This Valuation is done for the property found on as-is-where basis as shown on the site by the Bank/ customer of which photographs is also attached with the report.		





- d. Reference of the property is also taken from the copies of the documents/ information which interested organization or customer could provide to us out of the standard checklist of documents sought from them and further based on our assumptions and limiting conditions. All such information provided to us has been relied upon in good faith and we have assumed that it is true and correct. However, we do not vouch the absolute correctness of the property identification, exact address, physical conditions, etc. based on the documents provided to us since property shown to us may differ on site Vs as mentioned in the documents or incorrect/ fabricated documents may have been provided to us.
- e. Legal aspects for eg. investigation of title, ownership rights, lien, charge, mortgage, lease, verification of documents from originals or from any Govt. department, etc. has to be taken care by legal experts/ Advocates and same has not been done at our end.
- f. The valuation of an asset is an estimate of the worth of that asset which is arrived at by the Valuer in his expert opinion after factoring in multiple parameters and externalities. This may not be the actual price of that asset and the market may discover a different price for that asset.
- g. This report only contains opinion based on technical & market information which came to our knowledge during the course of the assignment. It doesn't contain any recommendations.
- h. This report is prepared following our Standard Operating Procedures & Best Practices and will be subject to Limitations, Conditions, Valuer's Remarks, Important Notes, Valuation TOS and basis of computation & working as described above.
- i. The use of this report will become valid only after payment of full fees as per the Payment Terms. Using this report or any part content created in this report without payment of charges will be seen as misuse and unauthorized use of the report.

#### 14. IMPORTANT KEY DEFINITIONS

**Fair Value** suggested by the competent Valuer is that prospective estimated amount in his expert & prudent opinion of the subject asset/ property without any prejudice after he has carefully & exhaustively evaluated the facts & information came in front of him or which he could reasonably collect during the course of the assessment related to the subject asset on an as-is, where-is basis in its existing conditions, with all its existing advantages & disadvantages and its potential possibilities which is just & equitable at which the subject asset/ property should be exchanged between a willing buyer and willing seller at an arm's length transaction in an open & unrestricted market, in an orderly transaction after proper marketing, wherein the parties, each acted knowledgeably, prudently without any compulsion on the date of the Valuation.

**Fair Value** without using the term "Market" in it describes that the value suggested by the Valuer may not mandatorily follow or may not be in complete consonance to the established Market in his expert opinion. It may or may not follow market dynamics. But if the suggested value by the valuer is not within the prevailing Market range or is assessed for an asset is located in an un-established Market then the valuer will give reasonable justification & reasoning that for what reasons the value suggested by him doesn't follow the prevailing market dynamics.

**Fair Market Value** suggested by the competent Valuer is that prospective estimated amount in his expert & prudent opinion of the subject asset/ property without any prejudice in consonance to the Market dynamics after he has carefully & exhaustively evaluated the facts & information came in front of him or which he could reasonably collect during the course of assessment related to the subject asset on an as-is, where-is basis in its existing conditions, with all its existing advantages & disadvantages and its potential possibilities which is just & equitable at which the subject asset/ property should be exchanged between a willing buyer and willing seller at an arm's length transaction in an open & unrestricted market, in an orderly transaction after proper marketing, wherein the parties, each acted knowledgeably, prudently without any compulsion on the date of the Valuation. Here the words "in consonance to the established Market" means that the Valuer will give opinion within the realms & dynamics of the prevailing market rates after exhaustively doing the micro market research. However due to the element of "Fair" in it, valuer will always look for the factors if the value should be better than the market realms which is just & equitable backed by strong justification and reasoning.

**Market Value** suggested by the competent Valuer is that prospective estimated amount which is average price of the similar comparable assets prevailing in an open & established market during the near period of the date of valuation at which the subject asset/ property should be exchanged between a willing buyer and willing seller on an as-is, where-is basis in its existing conditions, with all its existing advantages & disadvantages and its potential possibilities at an arm's length transaction in an open, established & unrestricted market, in an orderly transaction, wherein the parties, each acted without any compulsion on the date of the Valuation. Using the term "Market Value" without "Fair" omits the elements of proper marketing, acting knowledgeably & prudently.





Market and market participants can be sentimental, inclined towards the transaction without the element of complete knowledge & prudence about facts or due diligence of the asset therefore "each acted knowledgeably, prudently" has been removed from the market Value definition.

**Realizable Value** is that minimum prospective estimated value of the asset/ property which it may be able to fetch at the time of actual property transaction factoring in the element of discount due to the prospects of deep negotiations between the buyer & seller when the parties in-principally find Fair Market Value reasonable and sits together to close the deal and the transaction across the table. Discount percentage on the Fair Market Value due to negotiation will depend on the nature, size, various salability prospects of the subject asset, the needs of the buyer & the seller and kind of payment terms. In some of the cases Realizable and Fair Market Value may also be equal.

**Distress Sale Value\*** is that value when the property is attached with any process such as mortgaged financing, financial or operational dues which is under any stress condition or situation and the stakeholders are under process of finding resolution towards it to save the property from being attached to a formal recovery process. In this type of sale, minimum fetch value assessed will always be less than the estimated Fair Market Value where the discount of percentage will depend upon various circumstances and factors such as nature, size, salability prospects of the property and kind of encumbrance on the property. In this type of sale, negotiation power of the buyer is always more than the seller and eagerness & pressure of selling the property will be more on the seller than the buyer.

**Liquidation Value** is the amount that would be realized when an asset or group of assets are sold due to any compulsion or constraints such as in a recovery process guided by statute, law or legal process, clearance sale or any such condition or situation thereof where the pressure of selling the asset/ property is very high to realize whatever maximum amount can be from the sale of the assets in a limited time for clearance of dues or due to closure of business. In other words, this kind of value is also called as forced sale value.

**Difference between Cost, Price & Value:** Generally, these words are used and understood synonymously. However, in reality each of these has a completely different meaning, premise and also having different definitions in professional & legal terms. Therefore, it is our professional responsibility to describe the definitions of these words to avoid ambiguity & confusion in the minds of the user of this report.

The **Cost** of an asset represents the actual amount spent in the construction/ actual creation of the asset.

The **Price** is the amount paid for the procurement of the same asset.

The **Value** is defined as the present worth of future rights in the property/ asset and is a hypothetical or notional price that buyers and sellers are most likely to conclude for a good or service. Value is not a fact, but an estimate of the likely price to be paid for a good or service at a given time in accordance with a particular definition of value.

Therefore, in actual for the same asset/ property, cost, price & value remain different since these terms have different usage & meaning.

15. **Enclosures with the Report:**

- Enclosure: III- Google Map
- Enclosure: IV- References on price trend of the similar related properties available on public domain, if available
- Enclosure: V- Photographs of the property
- Enclosure: VI- Copy of Circle Rate
- Enclosure: VII- Important property documents exhibit
- Enclosure: VIII- SBI Annexure: VI - Declaration-Cum-Undertaking
- Enclosure: IX- SBI Annexure: VII - Model Code of Conduct for Valuers
- Enclosure: X- Part E: Valuer's Important Remarks





### IMPORTANT NOTES

**DEFECT LIABILITY PERIOD** - In case of any query/ issue or escalation you may please contact Incident Manager by writing at [valuers@rkassociates.org](mailto:valuers@rkassociates.org). We try our level best to ensure maximum accuracy in the Calculations done, Rates adopted and various other data points & information mentioned in the report but still can't rule out typing, human errors, assessment or any other mistakes. In case you find any mistake, variation, discrepancy or inaccuracy in any data point mentioned in the report, please help us by bringing all such points into our notice in writing at [valuers@rkassociates.org](mailto:valuers@rkassociates.org) within 30 days of the report delivery, to get these rectified timely, failing which R.K Associates shouldn't be held responsible for any inaccuracy in any manner. Also, if we do not hear back anything from you within 30 days, we will assume that the report is correct in all respect and no further claim of any sort will be entertained thereafter. We would welcome and appreciate your feedback & suggestions in order to improve our services.

Our **DATA RETENTION POLICY** is of **ONE YEAR**. After this period we remove all the concerned records related to the assignment from our repository. No clarification or query can be answered after this period due to unavailability of the data.



**COPYRIGHT FORMAT** - This report is prepared on the copyright format of R.K Associates to serve our clients in the best possible way. Legally no one can copy or distribute this format without prior approval from R.K Associates. It is meant only for the organization as mentioned on the cover page of this report. Distribution or use of this format or any content of this report wholly or partially other than R.K Associates will be seen as unlawful act and necessary legal action can be taken against the defaulters.

### IF REPORT IS USED FOR BANK/ FIs

**NOTE:** As per IBA Guidelines in case the valuation report submitted by the valuer is not in order, the banks / FIs shall bring the same to the notice of the valuer within 15 days of submission for rectification and resubmission. In case no such communication is received, it shall be presumed that the valuation report has been accepted.

At our end we have not verified the authenticity of any documents provided to us. Bank is advised to verify the genuineness of the property documents before taking any credit decision.

Valuation Terms of Services & Valuer's Important Remarks are available at [www.rkassociates.org](http://www.rkassociates.org) for reference.

SURVEY ANALYST	VALUATION ENGINEER	L1/ L2 REVIEWER
Anit Bhanji	Manas Upmanyu	Anil Kumar
		



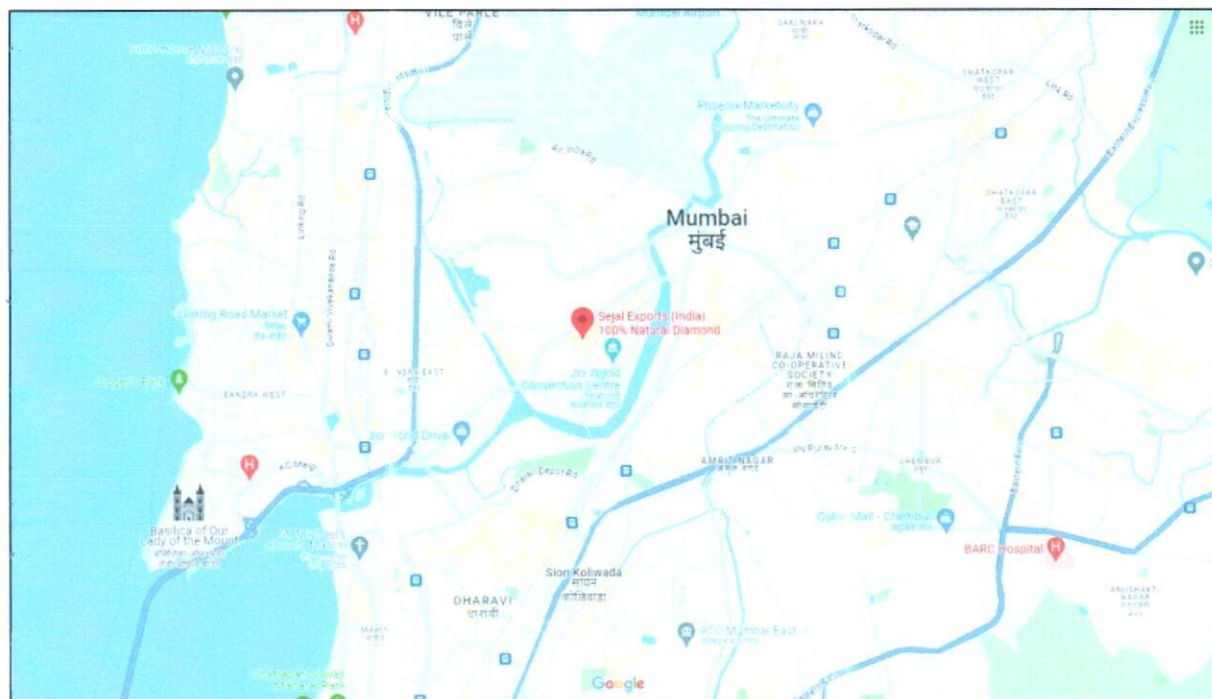



**ENCLOSURE: IV - REFERENCES ON PRICE TREND OF THE SIMILAR RELATED  
PROPERTIES AVAILABLE ON PUBLIC DOMAIN**

The first screenshot shows a listing for 'Naman Centre' in the Bandra Kurla Complex. The property is a pre-leased office space for sale, priced at ₹16 Cr (₹62,720/sqft) with a carpet area of 2,551 sqft (237 sqm). It offers a rental income of ₹10,00,000. The listing is from Fairdeal Realt... and was posted 1mo ago.

The second screenshot shows a listing for 'Wadhwa The Capital' in the Bandra Kurla Complex. The property is a pre-leased office space for sale, priced at ₹32 Cr (₹61,538/sqft) with a carpet area of 5,200 sqft (483 sqm). It offers a rental income of ₹19,00,000 and a 7.05% ROI. The listing is from WHITEROCK PROPER... and was posted 1mo ago.

*(Handwritten signature and circular stamp of R.K. Associates Valuers & Techno Engineering Consultants Pvt. Ltd.)*



## ENCLOSURE: V – PHOTOGRAPHS OF THE PROPERTY

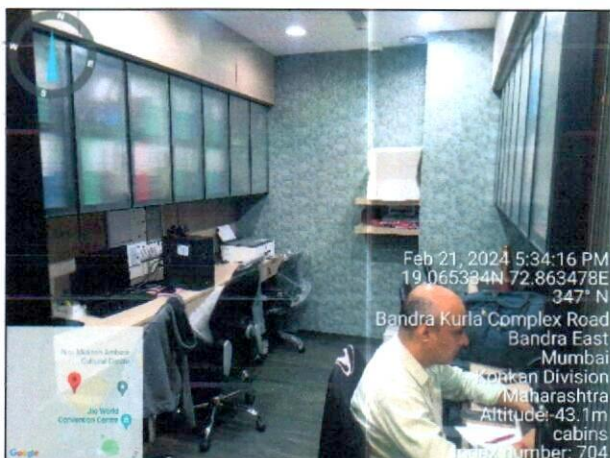
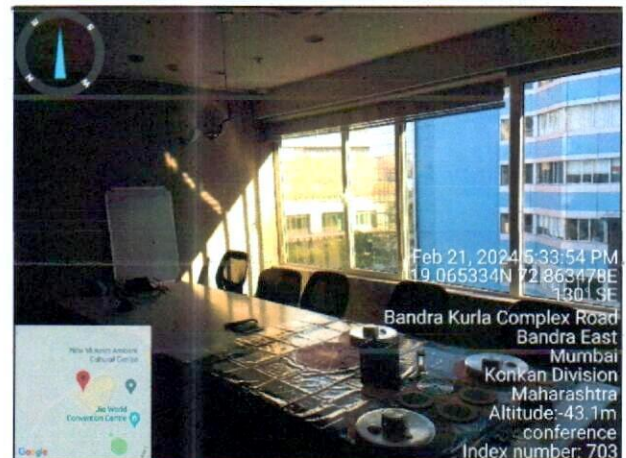
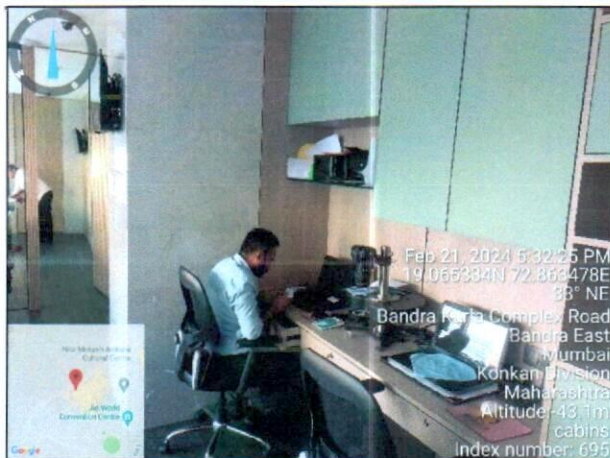

M



**ENCLOSURE: VI – COPY OF CIRCLE RATE**

**Department of Registration & Stamps**  
 Government of Maharashtra

**नोंदणी व मुद्रांक विभाग**  
 महाराष्ट्र शासन

**Registration and Stamp Department, Government of Maharashtra**  
 Market value rate sheet

Home Valuation Rules User Manual Close Feedback

Year: 2023-2024

Language: English

Selected District: Mumbai (suburb)  
 Select Village: Bandra-East (Andheri)  
 Search By: ☐ Survey no ☒ Location

Select	subdivision	open land	Residential Flats	Office	shops	Industrial	Unit (Sq./)
Survey No	29 165 -Land: Village Boundary on North and West, Western Expressway on East and Road from Khar Subway to Santacruz Chembur Link Road on South	70850	146620	168610	254000	151840	square meters
Survey No	29 166A-Bhubhag: Road from Khar Subway to Santacruz Chembur Link Road on North, Jayaprakash Road on South and D. P. Road, Railway to the West, Western Expressway to the East.	74750	156620	180110	205500	158060	square meters
Survey No	29 166B-Plot :- Income included in Bandra North Gulmohar Avenue Housing Project	78160	166430	188410	208030	166430	square meters
Survey No	29 166 - Surface: North Jaiprakash Road and D. P. Road, village boundary in the south and Railway in the west, Western Expressway in the east.	91380	181250	208440	226570	181250	square meters
Survey No	29 167A-FOLLOWING INCOME IN E BLOCK BANDRA KURLA COMPLEX.	150620	273400	327400	416500	273400	square meters

1 2



M



**ENCLOSURE VII: IMPORTANT PROPERTY DOCUMENTS EXHIBIT**

मूल्यांकन पत्रक : शहरी क्षेत्र - बांधीव :	
Valuation ID	2023060-29 09 Mar 2023 07:55:01 AM
मूल्यांकन वर्ष विभाग मूल विभाग उप मूल विभाग सर्वेक्षण सं. भू क्रमांक	2023 मुंबई, महाराष्ट्र, 31-कोरोनायाम, अक्षरी, भुवन, उदयेस मे एस टी रोड, सुईस व परिसर ही सी रोड व दक्षिण दिशा कुली कॉलेजवाला गट सि टी एस नंबर 4507
<b>वार्षिक मूल्य दर तक्केनुसार मूल्यदर क.</b>	
कुली जमीन 1675 sq ft	निचली सहायिका 323240/- कारगील 385310/- दुकान 453400/- औद्योगिक 536290/- सोडाबॉटलचे एकका शोरक पीपर
<b>बांधीव क्षेत्राची माहिती</b>	
बांधकाम क्षेत्र (Built up)	567 चौखर्चा फ्लॅट
बांधकामाचे वर्गीकरण	1-आय सी ड अक्षरी
एस्टिमेट केड	मिळकटीचा वापर मिळकटीचे घर मालकी
रक्त समुच्चय	करणीया कारणीया
सर्व्हे करारवा हाताशीमधील कारणीया व्याख्या "क - 2"	करणीया कारणीया
Sale Type - Free Sale	Free Sale Ex-Sub-Rent
Note: Rate of built up Property constructed at circular d.02/01/2018	
गणित नियम दर काढू	= 385% apply to rate = Rs. 385310/-
रक्त समुच्चयानुसार मूल्यदर	= 385% apply to rate = Rs. 385310/-
घरकतानुसार मिळकतीचा प्रति शे. पीपर मूल्यद	-> वार्षिक मूल्यदर * गुण्या जमिनीचा दर + घराचा आकार टक्केवारी + गुण्या जमिनीचा दर $\frac{385310 \times 100}{1675} + (\frac{100}{100} \times 385310) + 385310$ = Rs. 385310/-
A) मूल्य मिळकतीचे मूल्य	= वार्षिक घराची मूल्य दर + मिळकतीचे घर = 385310 * 567.1 = Rs. 218345800/-
B) बांधीव हाताने उत्पन्न होणारे घर बांधीव हाताने उत्पन्न मूल्य	= 41.82 * (385310 * 25.14%) = Rs. 402625.04
Applicable Rates	= 10.5 % A + B
<b>एकत्रित अंतिम मूल्य</b>	-> मूल्य मिळकतीचे मूल्य + बांधीव हाताने उत्पन्न होणारे घरकतानुसार मूल्य + एस्टिमेट केड मूल्य + एस्टिमेट केड मूल्य + एस्टिमेट केड मूल्य = A + B + C + D + E + F + G + H + I + J = 218345800 + 402625.04 + 385310 + 385310 + 385310 + 385310 + 385310 + 385310 + 385310 + 385310 = Rs. 222421085.04



बंदर-९

पुस्तक क्र. १/७०९ ९/२५

२०२३



<div style="display: flex; justify-content: space-around; align-items: center;"> <div style="text-align: center;"> <p>महाराष्ट्र शासन</p> <p>GOVERNMENT OF MAHARASHTRA</p> <p>ई-सुरक्षित बैंक व कोषागार पावती</p> <p>e-SECURED BANK &amp; TREASURY RECEIPT (e-SBTR)</p> </div> <div style="text-align: right;"> <p>16325279354560</p> </div> </div>	
<p>Bank/Branch: PNB/Oper. House/104210</p> <p>Pat Txn Id : 020121X6 2632</p> <p>Pat DtTime : 02-03-2023 12:21:21</p> <p>ChallanIdNo: 03006172123022750403</p> <p>District : 7103/MUMBAI</p>	<p>Stationery No: 16325279354560</p> <p>Print DtTime: 02-03-2023 12:21:21</p> <p>GRAS GRN : 16325279354560</p> <p>Office Name : PNB/Oper. House/104210</p>
<p>StDuty Schm: 003004651-75/Sale of Other NonJudicial Stamp</p> <p>StDuty Amt : R 1,85,34,000/- (Rs One, Eight, Five, Three Four, Zero Zero Zero only)</p>	
<p>RgnFee Schm: 003006331-70/Ordinary Collections (GR)</p> <p>RgnFee Amt : R 10,000/- (Rs Three Zero, Zero Zero Zero only)</p>	
<p>Article : 16/Certificate of Sale</p> <p>Prop Mvblty: Immovable</p> <p>Prop Descr : CHA011, 4 TOWER, EAST WING, 4TH FLOOR, 3 CANAL BANK, SUBURBAN AMBANI SOURSGO-BLOCK, BKC, MUMBAI, Maharashtra</p> <p>Consideration: 1,85,34,000/-</p>	
<p>Duty Payer: (PAN-AAA: 572018) SEJAL EXPORTS</p> <p>Other Party: (PAN-AAA: 07371A) OMKARA ASSETS RECONSTRUCTION PRIVATE LIMITED</p>	
<p>Bank official1 Name &amp; Signature</p> <p>Bank official2 Name &amp; Signature</p> <p>Space for customer/office use - Please write below</p>	
<div style="display: flex; justify-content: space-between;"> <div style="width: 45%;"> <p><i>Handwritten Signature</i></p> </div> <div style="width: 45%; text-align: right;"> <p><i>Handwritten Signature</i></p> </div> </div>	
<p>104210</p>	
<p>THE SEAL OF THE SUB REGISTRAR ANDHERI NO. 1</p> <p>मुंबई उपनगर, पश्चिम</p> <p>MUMBAI SUBURBAN DIST. ANDHERI NO. 1</p>	
<p>वदर-९</p> <p>16/09/23</p> <p>2023</p>	







**Appendix V**  
**Under Rule 9(6)**  
**SALE CERTIFICATE**  
**(FOR IMMOVABLE PROPERTY)**

**WHEREAS**  
 The undersigned being the Authorized Officer of Omkara Assets Reconstruction Private Limited (OARPL), a Company incorporated under the provisions of the Companies Act, 1956, and duly registered with Reserve Bank of India (RBI) as an Asset Reconstruction Company under Section 3 of the Securitisation And Reconstruction of Financial Assets And Enforcement Of Security Interest Act, 2002 (54 of 2002) ("The SARFAESI Act, 2002"); having CIN No U67100TZ2014PTC 020363 and its registered office at 9, M.P Nagar, 1st Street, Kongu Nagar Extn, Tirupur - 641607 and Corporate office at C/515, Kanakia Zillion, Junction of LBS Road and CST Road BKC Annexe Near Equinox, Kurla (West), Mumbai - 400070, acting in its capacity as a Trustee of Omkara PS 05/2017-18 Trust, Omkara PS 15/2018-19 Trust, Omkara PS 27/2019-20 Trust, Omkara PS 20/2020-21 Trust, Omkara PS 30/2020-21 and Omkara PS 02/2023-24 Trust and in exercise of the powers conferred under section 13 read with rule 9 of Security Interest (Enforcement) Rules, 2002 sold on behalf of Omkara Assets Reconstruction Private Limited (OARPL) and other consortium members being Secured Creditor, by way of Public E-Auction dated 31.01.2023 in favor of M/s Sejal Exports (India) (a Partnership Firm) having office at DX-7221, Bharat Diamond Bourse, "G" Block, Bandra Kurla Complex, Bandra (E), Mumbai 400051. ("the Purchaser"), the immovable property shown in the schedule below which was originally mortgaged in favor of erstwhile Andhra Bank, erstwhile Dena Bank, Bank of Baroda, Bank of India, Indian Bank, IDBI Bank, Union Bank of India & State Bank of India by M/s. Sanjivani Exports International Pvt. Ltd. towards the financial facility provided by the Secured Creditors. Thereafter erstwhile Andhra Bank, erstwhile Dena Bank, Bank of Baroda, Bank of India, Indian Bank & IDBI Bank has assigned entire outstanding debts along with underlying securities to Omkara Assets Reconstruction Private Limited under the provisions of the SARFAESI Act vide Assignment Agreement dated 03.01.2018, 14.12.2018, 31.03.2020, 31.12.2020, 31.03.2021 & 29.04.2023 respectively.

The undersigned acknowledges the receipt of total sale consideration of Rs.30,89,00,000 /- (Rupees Thirty Crore Eighty Nine Lakhs Only), the sale price in full and has handed over the Possession of the scheduled property as on 04.05.2023.

The Sale of the schedule property was made free from all encumbrances known to the secured creditors listed below on deposit of the money demanded by the undersigned.

APP-9

Sd/-	2009	2	24
2023			

1



Registered Office: No 9, M.P Nagar, First Street, Kongu Nagar Extn, Tirupur - 641607  
 Corporate Office: C/515, Kanakia Zillion, Junction of LBS Road & CST Road, BKC Annexe, Kurla (W), Mumbai - 400070. Tel: 022-26544000  
 Email: [mumbai@omkaraarc.com](mailto:mumbai@omkaraarc.com) / [www.omkaraarc.com](http://www.omkaraarc.com) / CIN: U67100TZ2014PTC020363





# VALUATION ASSESSMENT

M/S. SEJAL EXPORTS (INDIA)

**OMKARA**  
ASSETS RECONSTRUCTION PRIVATE LIMITED

**WITHOUT PREJUDICE**

Omkara/Mum/R0895/2022-23 1<sup>st</sup> February 2023

To,  
Sejal Exports (India)  
(Kind Attn: Mr. Rahul Chandul Shah)  
DC-7221, Bharat Diamond Bourse,  
Bandra Kurla Complex, Bandra (E),  
Mumbai 400051

**Sub: Sale Confirmation : E-Auction dated 31<sup>st</sup> January 2023 at 3:00 pm for Sale of Movable/ Immovable Assets under the Securitization and Reconstruction of Financial Assets and Enforcement of Security Interest Act, 2002 read with proviso to Rule 6(2) and 8(6) of the Security Interest (Enforcement) Rules, 2002 of Sanghavi Exports International Private Limited (in liquidation)**

Dear Sir,

In connection with above, we are pleased to inform you that your bid in respect of the auction of the following property of Rs. 30,89,00,000/- (Rupees Thirty Crores and Eighty Nine Lakhs only) is found highest and successful against benchmark Reserve price as under:

*All that premises bearing No. CE4011 admeasuring 4271.00 square feet carpet area equivalent to 6102.00 square feet saleable/built up area in C Tower, East Wing, 4th Floor and 3 number of car parking space in the compound of the building of the "Bharat Diamond Bourse Complex" constructed on all that piece and parcel of Land bearing Plot No. C-28 at G-Block Bandra Kurla Complex, situated and lying at CTS No. 4207, village Kulkarni, Taluka Andheri, Mumbai - 400051*

In this respect we acknowledge having received the following amounts:

Date	UTR No.	Amount (Rs.)	Remarks
27-01-2023	BKIDR52023012700722570	2,20,90,000/-	EMD
01-02-2023	BKIDR52023020100594848	5,51,35,000/-	25% of the Bid amount after EMD adjustment
	<b>Total</b>	<b>7,72,25,000/-</b>	

As per the terms of the bid document you are advised to remit balance i.e., Rs. 23,16,75,000/- (Rupees Twenty Three Crores Sixteen Lakhs and Seventy Five Thousand Only) i.e. 75% of the bid amount (after adjusting amount paid) within 15 days from the date of this confirmation i.e., on or before **15<sup>th</sup> February 2023**.

Thanking you.

Yours sincerely,

For Omkara Assets Reconstruction Pvt Ltd

  
Neelam Patel  
Chief Manager & Authorised Officer

बंदर-२

कुलका १ (२००) ८२५

२०२३

**Registered Office:** No. 9, M.P. Nagar, First Street, Kongu Nagar Extn. Tirupur - 641607.  
**Corporate Office:** C/515, Kanakia Zillon, Junction of LBS Road & CST Road, BKC Annexe, Kurla (W), Mumbai - 400070. Tel.: 022-26544000  
Email: mumbai@omkaraarc.com / www.omkaraarc.com / CIN: U67100TZ2014PTC020363









**Summary-2**

Date of Birth: 09/05/2023 9:36:36 AM  
 Date of Issue: 09/05/2023 9:36:36 AM  
 Date of Issue: 09/05/2023 9:36:36 AM

Sr.	Purchaser	Type	Verification no/Vendor	GRN Licence	Amount	Used At	Deface Number	Deface Date
1	SEJAL EXPORTS	eSBTR/Simple Receipt	030 6172023022750403	MH016186144202223S	18534000.00	SD	0000925026202324	09/05/2023
2		DHC		0505202300540	500	Rf	0505202300540D	09/05/2023
3	SEJAL EXPORTS	eSBTR/SimpleReceipt		MH016186144202223S	30000	Rf	0000925026202324	09/05/2023

SD Stamp Duty [RF-Registration Fee] [DHC Document Handling Charges]

Total Amount Payable: 18534000.00 + 500 + 30000 = 18534500.00

Payment Details:

Sr.	Purchaser	Type	Verification no/Vendor	GRN Licence	Amount	Used At	Deface Number	Deface Date
1	SEJAL EXPORTS	eSBTR/Simple Receipt	030 6172023022750403	MH016186144202223S	18534000.00	SD	0000925026202324	09/05/2023
2		DHC		0505202300540	500	Rf	0505202300540D	09/05/2023
3	SEJAL EXPORTS	eSBTR/SimpleReceipt		MH016186144202223S	30000	Rf	0000925026202324	09/05/2023

SD Stamp Duty [RF-Registration Fee] [DHC Document Handling Charges]

Total Amount Payable: 18534000.00 + 500 + 30000 = 18534500.00

Payment Details:

Sr.	Purchaser	Type	Verification no/Vendor	GRN Licence	Amount	Used At	Deface Number	Deface Date
1	SEJAL EXPORTS	eSBTR/Simple Receipt	030 6172023022750403	MH016186144202223S	18534000.00	SD	0000925026202324	09/05/2023
2		DHC		0505202300540	500	Rf	0505202300540D	09/05/2023
3	SEJAL EXPORTS	eSBTR/SimpleReceipt		MH016186144202223S	30000	Rf	0000925026202324	09/05/2023

SD Stamp Duty [RF-Registration Fee] [DHC Document Handling Charges]

Total Amount Payable: 18534000.00 + 500 + 30000 = 18534500.00

Payment Details:

Sr.	Purchaser	Type	Verification no/Vendor	GRN Licence	Amount	Used At	Deface Number	Deface Date
1	SEJAL EXPORTS	eSBTR/Simple Receipt	030 6172023022750403	MH016186144202223S	18534000.00	SD	0000925026202324	09/05/2023
2		DHC		0505202300540	500	Rf	0505202300540D	09/05/2023
3	SEJAL EXPORTS	eSBTR/SimpleReceipt		MH016186144202223S	30000	Rf	0000925026202324	09/05/2023

SD Stamp Duty [RF-Registration Fee] [DHC Document Handling Charges]

Total Amount Payable: 18534000.00 + 500 + 30000 = 18534500.00

Payment Details:

Sr.	Purchaser	Type	Verification no/Vendor	GRN Licence	Amount	Used At	Deface Number	Deface Date
1	SEJAL EXPORTS	eSBTR/Simple Receipt	030 6172023022750403	MH016186144202223S	18534000.00	SD	0000925026202324	09/05/2023
2		DHC		0505202300540	500	Rf	0505202300540D	09/05/2023
3	SEJAL EXPORTS	eSBTR/SimpleReceipt		MH016186144202223S	30000	Rf	0000925026202324	09/05/2023

SD Stamp Duty [RF-Registration Fee] [DHC Document Handling Charges]

Total Amount Payable: 18534000.00 + 500 + 30000 = 18534500.00

Payment Details:

Sr.	Purchaser	Type	Verification no/Vendor	GRN Licence	Amount	Used At	Deface Number	Deface Date
1	SEJAL EXPORTS	eSBTR/Simple Receipt	030 6172023022750403	MH016186144202223S	18534000.00	SD	0000925026202324	09/05/2023
2		DHC		0505202300540	500	Rf	0505202300540D	09/05/2023
3	SEJAL EXPORTS	eSBTR/SimpleReceipt		MH016186144202223S	30000	Rf	0000925026202324	09/05/2023

SD Stamp Duty [RF-Registration Fee] [DHC Document Handling Charges]

Total Amount Payable: 18534000.00 + 500 + 30000 = 18534500.00

Payment Details:

Sr.	Purchaser	Type	Verification no/Vendor	GRN Licence	Amount	Used At	Deface Number	Deface Date
1	SEJAL EXPORTS	eSBTR/Simple Receipt	030 6172023022750403	MH016186144202223S	18534000.00	SD	0000925026202324	09/05/2023
2		DHC		0505202300540	500	Rf	0505202300540D	09/05/2023
3	SEJAL EXPORTS	eSBTR/SimpleReceipt		MH016186144202223S	30000	Rf	0000925026202324	09/05/2023

SD Stamp Duty [RF-Registration Fee] [DHC Document Handling Charges]

Total Amount Payable: 18534000.00 + 500 + 30000 = 18534500.00

Payment Details:

Sr.	Purchaser	Type	Verification no/Vendor	GRN Licence	Amount	Used At	Deface Number	Deface Date
1	SEJAL EXPORTS	eSBTR/Simple Receipt						





# VALUATION ASSESSMENT

M/S. SEJAL EXPORTS (INDIA)

**BHARAT DIAMOND BOURSE**



REGULATED CENTRE OF INDIA

Bharat Diamond Bourse  
G Block, Bandra Kurla Complex, Bandra (East), Mumbai 400 051  
Maharashtra, India  
PAN No.: AAA-IB2358R GSTIN No.: 27AAACB2358R1Z9  
Tel: 022 3312 1700 / 3392 1500 Fax: 022 2652 2205  
Email: support@bdsindia.org Website: www.bdsindia.org  
CIN No.: U5139MH1984PL031717

## TAX INVOICE FOR CAM

Invoice No.: 57881  
Invoice Date: 01/01/2024  
Due Date: 31/01/2024

Bill To	Other Information
CO0159 - SANGHAVI EXPORTS INTERNATIONAL PVT. LTD. "CE-4011, Bharat Diamond Bourse", "BANDRA KURLA COMPLEX, BANDRA EAST" G Block, Mumbai - 400051 Maharashtra, India StateCode: Maharashtra (27) GSTIN:	Period From 01-01-24 To 31-03-24 Office No.: CE4011 Area Built up: 6,102.00 Reverse Charge Applicable: No IRN:

Sr No	Description of Service	HSN/SAC Code	Rate Per Sq. Ft. Per Month (INR)	Amount (INR)
1	CAM	998599	1.00	18,306.00
				Basic Amount 18,306.00
				SGST @ 9% 1,647.54
				CGST @ 9% 1,647.54
				Rounding -0.08
				<b>Invoice Total 21,601.00</b>
				<b>Arrears / (Credit) 330.00</b>
				<b>Total Including Arrears / (Credit) 21,931.00</b>

Arrears	
Principal	0.00
Interest	330.00
<b>Total</b>	<b>330.00</b>

Invoice Amount In Words: INR TWENTY-ONE THOUSAND SIX HUNDRED ONE ONLY

Amount In Words Including Arrears / (Credit): INR TWENTY-ONE THOUSAND NINE HUNDRED THIRTY-ONE ONLY

RTGS/NEFT Details as below:

Bank Name: INDUSIND BANK Branch: BKC IFSC No: INDB0000342 Account No: 150012341984

### Terms & Condition:

- Interest @15% p.a. will be charged on Outstanding amount, if payment is received after due date.
- Payment should be in favor of "Bharat Diamond Bourse".
- Payment will be accepted at Accounts Department, BOB Admin Office, Near Gate No. 4 at Bharat Diamond Bourse.
- Kindly mention all the details of payment on the back side of the cheque such as nature of payment along with month and Office numbers, Invoice number, contact number, amount of TDS deducted if any. Kindly provide the same details on Email ID: telacc@bdsindia.org or if payment is made online via NEFT, RTGS, IMPS etc.
- Kindly ignore arrears shown if already paid.
- Any Changes/Inclusion or GST Number on the Bill should be intimate to BOB Accounts Department within 10 working days of issue of Bill. No Changes/Inclusion or GST Number on the bill will be made after 10 working days of invoice generation date.
- Soft copy of digitally signed TDS certificate to be sent across to telacc@bdsindia.org and hard copy of the TDS certificate should be sent across to Accounts Department, BOB Admin Office, Near Gate No. 4 at Bharat Diamond Bourse.
- If you have any Queries please contact us at Support@bdsindia.org

### For BHARAT DIAMOND BOURSE

Signed by: SHEENA MAHALINGA SALIAN  
Date: 02/Jan/2024 16:09:10  
Location: MUMBAI  
Reason: CAM

Authorized Signatory

This file is signed using Digital Signature.

Page 1 of 1





<b>Customer Name:</b> M/S. GAJANAN IMAGING PRINT SOLUTIONS <b>Address:</b> Plot No. 38, 4th Road, Near Hotel Regal Enclave, Khar West, Mumbai - 400052. <b>Phone No.:</b> 022-35253164 <b>E-Mail ID:</b> info@gajanan.com		 <b>TATA POWER</b> <i>Lighting up Lives!</i>	
<b>Bill Number:</b> 93502188095 <b>Bill Month:</b> Dec 2023 <b>Bill Period:</b> 01.12.2023 to 31.12.2023 <b>Bill Date:</b> 03.01.2024		<b>Consumer No.:</b> 9000 0096 6701 <b>Category:</b> LT (B) / LT (COMMERCIAL) 20-50 KW <b>Meter No.:</b> 150002494 <b>Meter Status:</b> OK	
<b>Amount Due:</b> ₹ 29,708.00 <b>Net Other Charges:</b> ₹ -51.00 <b>Past Dues:</b> ₹ 0.00 <b>Total Amount Before Due Date:</b> ₹ 29,657.00		<b>Discount Date:</b> 10.01.2024 <b>Due Date:</b> 24.01.2024 <b>Supply Date:</b> 23.12.2023 <b>Type Of Supply:</b> Domestic	
<b>Amount By Discount Date:</b> ₹ 29,415.00 <b>Amount After Due Date:</b> ₹ 30,028.00 <b>Security Deposit Available:</b> ₹ 10,280.00 <b>Security Deposit Due:</b> ₹ 4,840.00			
*Due date is applicable for current bill only.			
For Advertisement enquiries please contact M/S. "GAJANAN IMAGING PRINT SOLUTIONS" email: gajananimagingprints@gmail.com			
		(ISO 14001:2015) (ISO 45001:2018) (ISO 9001:2015) GST No. 27AGZPT996K1ZR	
<ul style="list-style-type: none"> <li>* Offset / Designing / Variable Data Printing Solutions</li> <li>* Supply of Re-manufacture MICR Toner Cartridge</li> <li>* Supply Compatible Toner Cartridge</li> <li>* Cost to the per pages printer</li> <li>* Colour &amp; Black/White Rental Printer</li> </ul>		<b>Contact : 022 - 3525 3164</b>	
Your nearest offline payment centres Customer Relation Centre (MUMBAI TO SAT: 9:00 TO 17:00 HRS & SUNTHU: 10:00 TO 14:30 HRS; INDIA & 4TH SATURDAY: 9:00 TO 13:00 HRS) Shop no. S/L, Indira Square, Plot no 38, 4th Road, Near to Hotel Regal Enclave, Khar West, Mumbai 400052.			
<div style="display: flex; justify-content: space-between;"> <div> <b>MESSAGE TO CONSUMER</b>            To ensure seamless communication &amp; timely updates about bills &amp; imp. offers, kindly validate your contact detail by visiting your nearest Customer Relation Centre or call our toll-free no 18002095161 or reach out to us at customercare@tatapower.com         </div> <div style="text-align: right;">   <b>Nilesh Kane</b>            Chief - Distribution            (Mumbai Operations)         </div> </div>			
<div style="display: flex; align-items: center;"> <div> <b>RTGS/NFT Details:</b> Bank Name: Kotak Mahindra Bank Limited            Account No: TFCLTXXXXXX33XXX Sh. - XXXXXXXXXXXX denotes 12 digit consumer no.            IFSC Code: KKBK0000958 Account Type: Current Account         </div> </div>			
<b>THE TATA POWER COMPANY LIMITED</b>			
<b>Consumer Name:</b> GAJANANA EXPORTS INT. PVT LTD		<b>Consumer No.:</b> 9000 0096 6701	
<b>Bill No.</b> 93502188095	<b>Bill Date</b> 03.01.2024	<b>Bill Amount</b> ₹ 29,657.00	
<b>Cheque No.</b>	<b>Discount Date</b> 10.01.2024	<b>Amt by Disc Dt.</b> ₹ 29,415.00	
<b>Cheque Date</b>	<b>Due Date</b> 24.01.2024	<b>Amt After Due Dt.</b> ₹ 30,028.00	
Payment should be made by crossed cheque/DD in favour of "Tata Power CA NO. 9000 0096 6701". For multiple payments, write CA no & break-up of amount on back side of cheque. Please don't issue postdated or outstation cheques. Pls attach Payment Voucher.			



# VALUATION ASSESSMENT

M/S. SEJAL EXPORTS (INDIA)

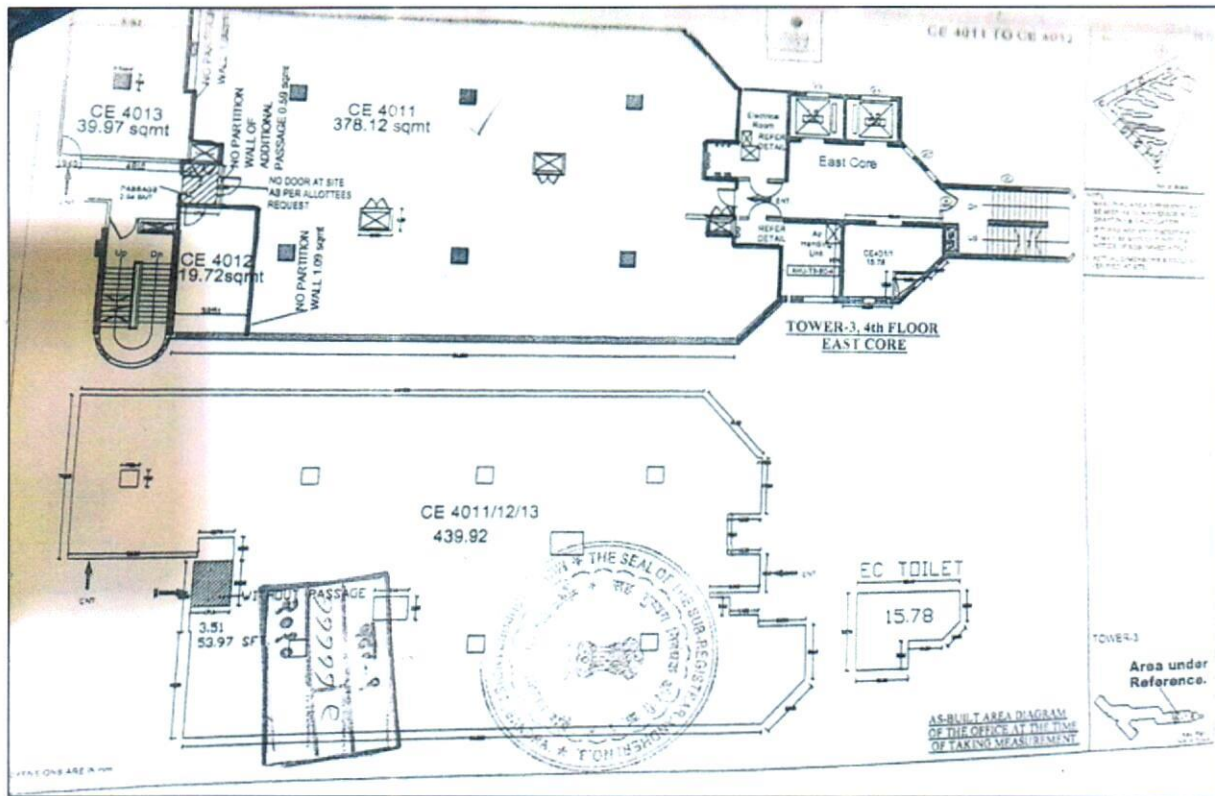



**ENCLOSURE VIII: ANNEXURE: VI - DECLARATION-CUM-UNDERTAKING**

- a Persons worked on this report are citizen of India.
- b No employee or member of R.K Associates has any direct/ indirect interest in the property or become so interested at any time during a period of three years prior to our appointment as valuer or three years after the valuation of assets was conducted by us.
- c The information furnished in our valuation report dated 29/2/2024 is true and correct to the best of our knowledge and belief and we have made an impartial and true valuation of the property.
- d Our authorized Engineer/ surveyor Mr. Anit Bhanji have personally inspected the property on 21/2/2024 the work is not subcontracted to any other valuation firm and is carried out by us.
- e We have not been depanelled/ delisted by any other bank and in case any such depanelment by other banks during my empanelment with you, we will inform you within 3 days of such depanelment.
- f We have not been removed/ dismissed from service/employment earlier.
- g We have not been convicted of any offence and sentenced to a term of imprisonment.
- h Company is not found guilty of misconduct in professional capacity.
- i Persons worked on this report are not declared to be unsound mind.
- j Company is not undischarged bankrupt or has not applied to be adjudicated as a bankrupt.
- k Company is not an undischarged insolvent.
- l No penalty is levied under section 271J of Income-tax Act, 1961 (43 of 1961) and time limit for filing appeal before Commissioner of Income tax (Appeals) or Income-tax Appellate Tribunal, as the case may be has expired, or such penalty has been confirmed by Income-tax Appellate Tribunal, and five years have not elapsed after levy of such penalty.
- m Company is not been convicted of an offence connected with any proceeding under the Income Tax Act 1961, Wealth Tax Act 1957 or Gift Tax Act 1958 and
- n Our PAN Card number/ GST number as applicable is **AAHCR0845G/ 09AAHCR0845G1ZP**.
- o We undertake to keep you informed of any events or happenings which would make us ineligible for empanelment as a valuer.
- p We have not concealed or suppressed any material information, facts and records and we have made a complete and full disclosure.
- q We have read the Handbook on Policy, Standards and procedure for Real Estate Valuation, 2009 of the IBA and has tried to apply the "Standards" enshrined for valuation in the Part-B of the above handbook to the best of our ability as much as practically possible in the limited time available.
- r We have read the International Valuation Standards (IVS) and the report submitted to the Bank for the respective asset class and has tried to apply the "Standards" as enshrined for valuation in the IVS in "General Standards" and "Asset Standards" as applicable to the best of our ability as much as practically possible in the limited time available.
- s Procedures and standards adopted in carrying out the valuation and is mentioned in Part-D of the report which may have certain departures to the said IBA and IVS standards in order to provide better, just & fair valuation.
- t We abide by the Model Code of Conduct for empanelment of valuer in the Bank.
- u The authorized Engineers of the company who has worked on the assignment has signed this valuation report.
- v The work is taken on the instructions of the Bank.
- w Further, we hereby provide the following information.

S. No.	Particulars	Valuer comment
1.	Background information of the asset being valued	This is a commercial office unit located at aforesaid address having total built-up area admeasuring 567.1 sq.mtr. / 6,102 sq.ft. along with 3 parking spaces as found on as-is-where basis which owner/ owner representative/ client/ bank has shown/ identified to us on the site physically unless otherwise mentioned in the report of which some reference has been taken from the information/ data given in the copy of documents provided to us and informed verbally and in writing.
2.	Purpose of valuation and appointing authority	Please refer to Part-D of the Report.



3.	Identity of the experts involved in the valuation	<b>Survey Analyst:</b> Er. Anit Bhanji <b>Valuation Engineer:</b> Er. Manas Upmanyu <b>L1/ L2 Reviewer:</b> Er. Anil Kumar	
4.	Disclosure of valuer interest or conflict, if any	No relationship with the borrower and no conflict of interest.	
5.	Date of appointment, valuation date and date of report	<b>Date of Appointment:</b>	<b>21/2/2024</b>
		<b>Date of Survey:</b>	<b>21/2/2024</b>
		<b>Valuation Date:</b>	<b>29/2/2024</b>
		<b>Date of Report:</b>	<b>29/2/2024</b>
6.	Inspections and/ or investigations undertaken	Yes, by our authorized Survey Engineer Anit Bhanji on 21/2/2024. Property was shown and identified by <b>Mr. Manish Shah</b> (+91- 98920 56255).	
7.	Nature and sources of the information used or relied upon	Please refer to Part-D of the Report. Level 3 Input (Tertiary) has been relied upon.	
8.	Procedures adopted in carrying out the valuation and valuation standards followed	Please refer to Part-D of the Report.	
9.	Restrictions on use of the report, if any	<p>Value varies with the Purpose/ Date/ Market &amp; Asset Condition &amp; Situation prevailing in the market. We recommend not to refer the indicative &amp; estimated prospective Value of the asset given in this report if any of these points are different from the one mentioned aforesaid in the Report.</p> <p>This report has been prepared for the purposes stated in the report and should not be relied upon for any other purpose. Our client is the only authorized user of this report and is restricted for the purpose indicated in this report. I/we do not take any responsibility for the unauthorized use of this report. During the course of the assignment, we have relied upon various information, data, documents in good faith provided by Bank/ client both verbally and in writing. If at any point of time in future it comes to knowledge that the information given to us is untrue, fabricated, misrepresented then the use of this report at very moment will become null &amp; void.</p> <p>This report only contains general assessment &amp; opinion on the indicative, estimated Market Value of the property for which Bank has asked to conduct the Valuation for the asset as found on as-is-where basis which owner/ owner representative/ client/ bank has shown/ identified to us on the site unless otherwise mentioned in the report of which some reference has been taken from the information/ data given in the copy of documents provided to us and informed verbally or in writing which has been relied upon in good faith. It doesn't contain any other recommendations of any sort including but not limited to express of any opinion on the suitability or otherwise of entering into any transaction with the borrower.</p> <p>This report is not a certification of ownership or survey number/ property number/ Khasra number which are merely referred from the copy of the documents provided to us.</p>	
10.	Major factors that were taken into account during the valuation	Please refer to Part A, B & C of the Report.	
11.	Major factors that were not taken into account during the valuation	Please refer to Part A, B & C of the Report.	

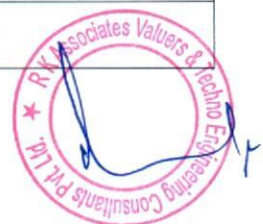



12.	<p>Caveats, limitations and disclaimers to the extent they explain or elucidate the limitations faced by valuer, which shall not be for the purpose of limiting his responsibility for the valuation report.</p>	<p>Please refer to Part E of the Report and Valuer's Important Remarks enclosed herewith or otherwise caveats, limitations and disclaimers are as per standard Insolvency &amp; Bankruptcy Board of India guidelines dated: 1.09.2020 for the matters not under scope of valuation such as legal, ownership, verification of the documents from originals or govt. departments, reliance on the documents/ details provided by the client which is assumed to be complete, accurate &amp; correct, engaging revenue deptt. officials for identification of the property or getting cizra map from the deptt. or acting as a Licensed surveyor, no liability assumed for the information collected from third party sources used in the report.</p> <p>Limitations: Reliance on market facts is done majorly on verbal enquiries where written records are not available. Opaque &amp; untransparent Indian real estate market where actual transaction and recorded transaction amount differs. No property number displayed on the property and have to rely on the property shown by the customer with due diligence as much practically possible.</p> <p>Standard Caveats, limitations and disclaimers as per IBBI and used in the report are uploaded on <a href="http://www.rkassociates.org">www.rkassociates.org</a></p>
-----	--	---

**Date: 29/2/2024**

**Place: Noida**



**(Authorized Person of R.K Associates Valuers & Techno Engg. Consultants (P) Ltd.)**



## ENCLOSURE IX: ANNEXURE: VII - MODEL CODE OF CONDUCT FOR VALUERS

### Integrity and Fairness

1. A valuer shall, in the conduct of his/its business, follow high standards of integrity and fairness in all his/its dealings with his/its clients and other valuers.
2. A valuer shall maintain integrity by being honest, straightforward, and forthright in all professional relationships.
3. A valuer shall endeavor to ensure that he/it provides true and adequate information and shall not misrepresent any facts or situations.
4. A valuer shall refrain from being involved in any action that would bring disrepute to the profession.
5. A valuer shall keep public interest foremost while delivering his services.

### Professional Competence and Due Care

6. A valuer shall render at all times high standards of service, exercise due diligence, ensure proper care and exercise independent professional judgment.
7. A valuer shall carry out professional services in accordance with the relevant technical and professional standards that may be specified from time to time.
8. A valuer shall continuously maintain professional knowledge and skill to provide competent professional service based on up-to-date developments in practice, prevailing regulations/guidelines and techniques.
9. In the preparation of a valuation report, the valuer shall not disclaim liability for his/its expertise or deny his/its duty of care, except to the extent that the assumptions are based on statements of fact provided by the company or its auditors or consultants or information available in public domain and not generated by the valuer.
10. A valuer shall not carry out any instruction of the client in so far as they are incompatible with the requirements of integrity, objectivity and independence.
11. A valuer shall clearly state to his client the services that he would be competent to provide and the services for which he would be relying on other valuers or professionals or for which the client can have a separate arrangement with other valuers.

### Independence and Disclosure of Interest

12. A valuer shall act with objectivity in his/its professional dealings by ensuring that his/its decisions are made without the presence of any bias, conflict of interest, coercion, or undue influence of any party, whether directly connected to the valuation assignment or not.
13. A valuer shall not take up an assignment if he/it or any of his/its relatives or associates is not independent in terms of association to the company.
14. A valuer shall maintain complete independence in his/its professional relationships and shall conduct the valuation independent of external influences.
15. A valuer shall wherever necessary disclose to the clients, possible sources of conflicts of duties and interests, while providing unbiased services.
16. A valuer shall not deal in securities of any subject company after any time when he/it first becomes aware of the possibility of his/its association with the valuation, and in accordance with the Securities and Exchange Board of India (Prohibition of Insider Trading) Regulations, 2015 or till the time the valuation report becomes public, whichever is earlier.
17. A valuer shall not indulge in "mandate snatching or offering" convenience valuations" in order to cater to a company or client's needs.
18. As an independent valuer, the valuer shall not charge success fee.
19. In any fairness opinion or independent expert opinion submitted by a valuer, if there has been a prior engagement in an unconnected transaction, the valuer shall declare the association with the company during the last five years.

### Confidentiality

20. A valuer shall not use or divulge to other clients or any other party any confidential information about the subject company, which has come to his/its knowledge without proper and specific authority or unless there is a legal or professional right or duty to disclose.





### Information Management

21. A valuer shall ensure that he/ it maintains written contemporaneous records for any decision taken, the reasons for taking the decision, and the information and evidence in support of such decision. This shall be maintained so as to sufficiently enable a reasonable person to take a view on the appropriateness of his/its decisions and actions.
22. A valuer shall appear, co-operate and be available for inspections and investigations carried out by the authority, any person authorised by the authority, the registered valuers organization with which he/it is registered or any other statutory regulatory body.
23. A valuer shall provide all information and records as may be required by the authority, the Tribunal, Appellate Tribunal, the registered valuers organization with which he/it is registered, or any other statutory regulatory body.
24. A valuer while respecting the confidentiality of information acquired during the course of performing professional services, shall maintain proper working papers for a period of three years or such longer period as required in its contract for a specific valuation, for production before a regulatory authority or for a peer review. In the event of a pending case before the Tribunal or Appellate Tribunal, the record shall be maintained till the disposal of the case.

### Gifts and hospitality.

25. A valuer or his/its relative shall not accept gifts or hospitality which undermines or affects his independence as a valuer.  
Explanation: For the purposes of this code the term 'relative' shall have the same meaning as defined in clause (77) of Section 2 of the Companies Act, 2013 (18 of 2013).
26. A valuer shall not offer gifts or hospitality or a financial or any other advantage to a public servant or any other person with a view to obtain or retain work for himself/ itself, or to obtain or retain an advantage in the conduct of profession for himself/ itself.

### Remuneration and Costs.

27. A valuer shall provide services for remuneration which is charged in a transparent manner, is a reasonable reflection of the work necessarily and properly undertaken, and is not inconsistent with the applicable rules.
28. A valuer shall not accept any fees or charges other than those which are disclosed in a written contract with the person to whom he would be rendering service.

### Occupation, employability and restrictions.

29. A valuer shall refrain from accepting too many assignments, if he/it is unlikely to be able to devote adequate time to each of his/ its assignments.
30. A valuer shall not conduct business which in the opinion of the authority or the registered valuer organisation discredits the profession.

### Miscellaneous

31. A valuer shall refrain from undertaking to review the work of another valuer of the same client except under written orders from the bank or housing finance institutions and with knowledge of the concerned valuer.
32. A valuer shall follow this code as amended or revised from time to time

Signature of the Authorized Person: \_\_\_\_\_

Name of the Valuation company: R.K Associates Valuers & Techno Engg. Consultants (P) Ltd.

Address of the Valuer: D-39, Sector-2, Noida-201301

Date: 29/2/2024

Place: Noida



ENCLOSURE: X

**PART E**

**VALUER'S IMPORTANT REMARKS**

1.	Valuation is done for the asset found on as-is-where basis which owner/ owner representative/ client/ bank has shown/ identified to us on the site unless otherwise mentioned in the report of which some reference has been taken from the information/ data given in the copy of documents provided to us and informed verbally or in writing out of the standard checklist of documents sought from the client & its customer which they could provide within the reasonable expected time out of the standard checklist of documents sought from them and further based on certain assumptions and limiting conditions. The information, facts, documents, data which has become primary basis of the report has been supplied by the client which has been relied upon in good faith and is not generated by the Valuer.
2.	The client/ owner and its management/ representatives warranted to us that the information they have supplied was complete, accurate and true and correct to the best of their knowledge. All such information provided to us either verbally, in writing or through documents has been relied upon in good faith and we have assumed that it is true & correct without any fabrication or misrepresentation. I/We shall not be held liable for any loss, damages, cost or expenses arising from fraudulent acts, misrepresentations, or willful default on part of the owner, company, its directors, employee, representative or agents.
3.	Legal aspects for eg. Investigation of title, ownership rights, lien, charge, mortgage, lease, sanctioned maps, verification of documents provided to us such as title documents, Map, etc. from any concerned Govt. office etc. have to be taken care by legal expert/ Advocate and same is not done at our end. It is assumed that the concerned Lender/ Financial Institution has asked for the valuation of that property after satisfying the authenticity of the documents given to us for which the legal verification has been already taken and cleared by the competent Advocate before requesting for the Valuation report. I/ We assume no responsibility for the legal matters including, but not limited to, legal or title concerns.
4.	In the course of the valuation, we were provided with both written and verbal information. We have however, evaluated the information provided to us through broad inquiry, analysis and review but have not carried out a due diligence or audit of the information provided for the purpose of this engagement. Our conclusions are based on the assumptions and other information provided to us by the client during the course of the assessment.
5.	Getting cizra map or coordination with revenue officers for site identification is a separate activity and is not part of the Valuation services and same has not been done in this report unless otherwise stated.
6.	Wherever any details are mentioned in the report in relation to any legal aspect of the property such as name of the owner, leases, etc. is only for illustration purpose and should not be construed as a professional opinion. Legal aspects are out of scope of this report. Details mentioned related to legal aspect are only based on the copy of the documents provided to us and whatever we can interpret as a non-legally trained person. This should be cross validated with a legal expert. We do not vouch any responsibility regarding the same.
7.	We have made certain assumptions in relation to facts, conditions & situations affecting the subject of, or approach to this exercise that has not been verified as part of the engagement rather, treated as "a supposition taken to be true". If any of these assumptions prove to be incorrect then our estimate on value will need to be reviewed.
8.	This is just an opinion report based on technical & market information having general assessment & opinion on the indicative, estimated Market Value of the property for which Bank has asked to conduct the Valuation. It doesn't contain any other recommendations of any sort including but not limited to express of any opinion on the suitability or otherwise of entering into any transaction with the borrower.
9.	We have relied on the data from third party, external sources & information available on public domain to conclude the valuation. These sources are believed to be reliable and therefore, we assume no liability for the truth or accuracy of any data, opinions or estimates furnished by others that have been used in this analysis. Where we have relied on the data, opinions or estimates from external sources, reasonable care has been taken to ensure that such data is extracted from authentic sources, however we still can't vouch its authenticity, correctness, or accuracy.
10.	Analysis and conclusions adopted in the report are limited to the reported assumptions, conditions and information came to our knowledge during the course of the work and based on the Standard Operating Procedures, Best Practices, Caveats, Limitations, Conditions, Remarks, Important Notes, Valuation TOR and definition of different nature of values.
11.	Value varies with the Purpose/ Date/ Asset Condition & situation/ Market condition, demand & supply, asset utility prevailing on a particular date/ Mode of sale. The indicative & estimated prospective Value of the asset given in this report is restricted only for the purpose and other points mentioned above prevailing on a particular date as mentioned in the report. If any of these points are different from the one mentioned aforesaid in the Report then this report should not be referred.
12.	Our report is meant ONLY for the purpose mentioned in the report and should not be used for any other purpose. The Report should not be copied or reproduced for any purpose other than the purpose for which it is prepared for. I/we do not take any responsibility for the unauthorized use of this report.
13.	We owe responsibility only to the authority/client that has appointed us as per the scope of work mentioned in the report. We will not be liable for any losses, claims, damages or liabilities arising out of the actions taken, omissions or advice given by any other person. In no event shall we be liable for any loss, damages, cost or expenses arising in any way from fraudulent acts, misrepresentations or willful default on part of the client or companies, their directors, employees or agents.
14.	This report is having limited scope as per its fields & format to provide only the general basic idea of the value of the property prevailing in the market based on the site inspection and documents/ data/ information provided by the client. The suggested indicative prospective estimated value should be considered only if transaction is happened as free market transaction.
15.	The sale of the subject property is assumed to be on an all cash basis. Financial arrangements would affect the price at which the property may sell for if placed on the market.



# VALUATION ASSESSMENT

M/S. SEJAL EXPORTS (INDIA)

16.	The actual realizable value that is likely to be fetched upon sale of the asset under consideration shall entirely depend on the demand and supply of the same in the market at the time of sale.
17.	While our work has involved an analysis & computation of valuation, it does not include detailed estimation, design/ technical/ engineering/ financial/ structural/ environmental/ architectural/ compliance survey/ safety audit & works in accordance with generally accepted standards of audit & other such works. The report in this work is not investigative in nature. It is mere an opinion on the likely estimated valuation based on the facts & details presented to us by the client and third party market information came in front of us within the limited time of this assignment, which may vary from situation to situation.
18.	Where a sketched plan is attached to this report, it does not purport to represent accurate architectural plans. Sketch plans and photographs are provided as general illustrations only.
19.	Documents, information, data including title deeds provided to us during the course of this assessment by the client is reviewed only upto the extent required in relation to the scope of the work. No document has been reviewed beyond the scope of the work. These are not reviewed in terms of legal rights for which we do not have expertise. Wherever any information mentioned in this report is mentioned from the documents like owners name, etc., it is only for illustration purpose and may not necessary represent accuracy.
20.	The report assumes that the borrower/company/business/asset complies fully with relevant laws and regulations applicable in its area of operations and usage unless otherwise stated, and that the companies/business/assets is managed in a competent and responsible manner. Further, as specifically stated to the contrary, this report has given no consideration to matters of a legal nature, including issues of legal title and compliance with relevant laws, and litigations and other contingent liabilities that are not recorded/reflected in the documents/ details/ information/ data provided to us.
21.	This valuation report is not a qualification for accuracy of land boundaries, schedule (in physical terms), dimensions & identification. For this land/ property survey report can be sought from a qualified private or Govt. surveyor.
22.	This Valuation report is prepared based on the facts of the property on the date of the survey. Due to possible changes in market forces, socio-economic conditions, property conditions and circumstances, this valuation report can only be regarded as relevant as at the valuation date. Hence before financing, Banker/ FI should take into consideration all such future risk and should loan conservatively to keep the advanced money safe in case of the downward trend of the property value.
23.	Valuation of the same asset/ property can fetch different values under different circumstances & situations. For eg. Valuation of a running/ operational shop/ hotel/ factory will fetch better value and in case of closed shop/ hotel/ factory it will have considerable lower value. Similarly, an asset sold directly by an owner in the open market through free market transaction then it will fetch better value and if the same asset/ property is sold by any financier due to encumbrance on it, will fetch lower value. Hence before financing, Lender/ FI should take into consideration all such future risks while financing and take decision accordingly.
24.	Valuation is done for the property identified to us by the owner/ owner representative. At our end we have just visually matched the land boundaries, schedule (in physical terms) & dimensions of the property with reference to the documents produced for perusal. Method by which identification of the property is carried out is also mentioned in the report clearly. Responsibility of identifying the correct property to the Valuer/ its authorized surveyor is solely of the client/ owner for which Valuation has to be carried out. It is requested from the Bank to cross check from their own records/ information if this is the same property for which Valuation has to be carried out to ensure that owner has not misled the Valuer company or misrepresented the property due to any vested interest. Where there is a doubt about the precision position of the boundaries, schedule, dimensions of site & structures, it is recommended that a Licensed Surveyor be contacted.
25.	In India more than 70% of the geographical area is lying under rural/ remote/ non municipal/ unplanned area where the subject property is surrounded by vacant lands having no physical demarcation or having any display of property survey or municipal number / name plate on the property clearly. Even in old locations of towns, small cities & districts where property number is either not assigned or not displayed on the properties clearly and also due to the presence of multiple/ parallel departments due to which ownership/ rights/ illegal possession/ encroachment issues are rampant across India and due to these limitations at many occasions it becomes tough to identify the property with 100% surety from the available documents, information & site whereabouts and thus chances of error, misrepresentation by the borrower and margin of chances of error always persists in such cases. To avoid any such chances of error it is advised to the Bank to engage municipal/ revenue department officials to get the confirmation of the property to ensure that the property shown to Valuer/ Banker is the same as for which documents are provided.
26.	If this Valuation Report is prepared for the Flat/ dwelling unit situated in a Group Housing Society or Integrated Township then approvals, maps of the complete group housing society/ township is out of scope of this report and this report will be made for the specific unit based on the assumption that complete Group Housing Society/ Integrated Township and the subject unit must be approved in all respect.
27.	Due to fragmented & frequent change in building/ urban planning laws/ guidelines from time to time, different laws/ guidelines between regions/ states and no strict enforceability of Building Bye-Laws in India specially in non-metro and scale b & c cities & Industrial areas, property owners many times extend or make changes in the covered area/ layout from the approved/ applicable limits. There are also situations where properties are decades old when there was no formal Building Bye-Laws applicable the time when the construction must have been done. Due to such discrete/ unplanned development in many regions sometimes it becomes tough for the Valuer to determine the exact lawful situation on ground. Unless otherwise mentioned in the report, the covered area present on the site as per site survey will be considered in the Valuation.
28.	Area of the large land parcels of more than 2500 sq.mtr or of uneven shape in which there can be practical difficulty in sample measurement, is taken as per property documents which has been relied upon unless otherwise stated.
29.	Drawing Map, design & detailed estimation of the property/ building is out of scope of the Valuation services.
30.	Valuation is a subjective field and opinion may differ from consultant to consultant. To check the right opinion, it is important to evaluate the methodology adopted and various data point/ information/ factors/ assumption considered by the consultant which became the basis for the Valuation report before reaching to any conclusion.

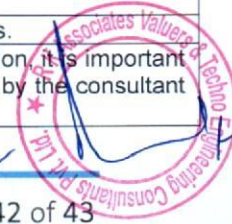



31.	Although every scientific method has been employed in systematically arriving at the value, there is, therefore, no indisputable single value and the estimate of the value is normally expressed as falling within a likely range.
32.	Value analysis of any asset cannot be regarded as an exact science and the conclusions arrived at in many cases will, of necessity, be subjective and dependent on the exercise of individual judgment. Given the same set of facts and using the same assumptions, expert opinions may differ due to the number of separate judgment decisions, which have to be made. Therefore, there can be no standard formula to establish an indisputable exchange ratio. In the event of a transaction, the actual transaction value achieved may be higher or lower than our indicative analysis of value depending upon the circumstances of the transaction. The knowledge, negotiability and motivations of the buyers and sellers, demand & supply prevailing in the market and the applicability of a discount or premium for control will also affect actual price achieved. Accordingly, our indicative analysis of value will not necessarily be the price at which any agreement proceeds. The final transaction price is something on which the parties themselves have to agree. However, our Valuation analysis can definitely help the stakeholders to take informed and wise decision about the Value of the asset and can help in facilitating the arm's length transaction.
33.	This Valuation is conducted based on the macro analysis of the asset/ property considering it in totality and not based on the micro, component, or item wise analysis. Analysis done is a general assessment and is not investigative in nature.
34.	This report is prepared on the RKA V-L1 (Basic) Valuation format as per the client requirement and scope of work. This report is having limited scope as per its fields & format to provide only the general estimated & indicative basic idea of the value of the property prevailing in the market based on the information provided by the client. No detailed analysis, audit or verification has been carried out of the subject property. There may be matters, other than those noted in this report, which might be relevant in the context of the transaction and which a wider scope might uncover.
35.	This is just an opinion report and doesn't hold any binding on anyone. It is requested from the concerned Client/ Bank/ Financial Institution which is using this report for mortgaging the property that they should consider all the different associated relevant & related factors & risks before taking any business decision based on the content of this report.
36.	All Pages of the report including annexures are signed and stamped from our office. In case any paper in the report is without stamp & signature then this should not be considered a valid paper issued from this office.
37.	As per IBA Guidelines & Bank Policy, in case the valuation report submitted by the valuer is not in order, the banks / FIs shall bring the same to the notice of the valuer within 15 days of submission for rectification and resubmission. In case no such communication is received, it shall be presumed that the valuation report has been accepted.
38.	<b>Defect Liability Period is 15 DAYS.</b> We request the concerned authorized reader of this report to check the contents, data, information, and calculations in the report within this period and intimate us in writing at <a href="mailto:valuers@rkassociates.org">valuers@rkassociates.org</a> within 15 days of report delivery, if any corrections are required or in case of any other concern with the contents or opinion mentioned in the report. If no intimation is received within 15 (Fifteen) days in writing from the date of issuance of the report, then it shall be considered that the report is complete in all respect and has been accepted by the client up to their satisfaction & use and further to which R.K Associates shall not be held responsible in any manner. After this period no concern/ complaint/ proceedings in connection with the Valuation Services will be entertained due to possible change in situation and condition of the property.
39.	Though adequate care has been taken while preparing this report as per its scope, but still we can't rule out typing, human errors, over sightedness of any information or any other mistakes. Therefore, the concerned organization is advised to satisfy themselves that the report is complete & satisfactory in all respect. Intimation regarding any discrepancy shall be brought into our notice immediately. If no intimation is received within 15 (Fifteen) days in writing from the date of issuance of the report, to rectify these timely, then it shall be considered that the report is complete in all respect and has been accepted by the client upto their satisfaction & use and further to which R.K Associates shall not be held responsible in any manner.
40.	Our Data retention policy is of <b>ONE YEAR</b> . After this period we remove all the concerned records related to the assignment from our repository. No clarification or query can be answered after this period due to unavailability of the data.
41.	This Valuation report is governed by our (1) Internal Policies, Processes & Standard Operating Procedures, (2) R.K Associates Quality Policy, (3) Valuation & Survey Best Practices Guidelines formulated by management of R.K Associates, (4) Information input given to us by the customer and (4) Information/ Data/ Facts given to us by our field/ office technical team. Management of R.K Associates never gives acceptance to any unethical or unprofessional practice which may affect fair, correct & impartial assessment and which is against any prevailing law. In case of any indication of any negligence, default, incorrect, misleading, misrepresentation or distortion of facts in the report then we request the user of this report to immediately or at least within the defect liability period to bring all such act into notice of R.K Associates management so that corrective measures can be taken instantly.
42.	R.K Associates never releases any report doing alterations or modifications by pen. In case any information/ figure of this report is found altered with pen then this report will automatically become null & void.
43.	We are fully aware that based on the opinion of value expressed in this report, we may be required to give testimony or attend court / judicial proceedings with regard to the subject assets, although it is out of scope of the assignment, unless specific arrangements to do so have been made in advance, or as otherwise required by law. In such event, the party seeking our evidence in the proceedings shall bear the cost/professional fee of attending court / judicial proceedings and my / our tendering evidence before such authority shall be under the applicable laws.
44.	The final copy of the report shall be considered valid only if it is in hard copy on the company's original letter head with proper stamp and sign on it of the authorized official upon payment of the agreed fees. User shall not use the content of the report for the purpose it is prepared for only on draft report, scanned copy, email copy of the report and without payment of the agreed fees. In such a case the report shall be considered as unauthorized and misused.