

# BRIHANMUMBAI MUNICIPAL CORPORATION TREE AUTHORITY

Office of the Supdt .of Gardens  
Veermata Jijabai Bhosale Udyan,  
Penguin Building , 2<sup>nd</sup> Floor  
Dr.Ambedkar Road, Byculla (East),  
Mumbai-400 027.

To,  
M/s. Kanhere Associates LLP  
301, 3<sup>rd</sup> Floor , Phoenix Building ,  
457 , S.V.Road , Girgaon ,  
Mumbai- 400 004.

Dy.S.G./C/ 06 /CC-06/Prop/DD/II/MDG/ 6513  
Date:- 28/08/2023

Sub : Permission for Cutting & Transplanting of trees are coming in the proposed redevelopment of C.S.no.2 / 71 of Parel Sewree Div , situated at Mahadev Palav Marg, Parel , Mumbai in 'F/South' ward.

Sir/ Madam,

Please refer to your Nil dt. 24.04.2023 for granting permission for Cutting & Transplanting of trees are coming in the proposed redevelopment of C.S.no.2 / 71 of Parel Sewree Div, situated at Mahadev Palav Marg, Parel , Mumbai in 'F/South' ward. has been considered by the has been considered by the Hon. Municipal Commissioner & Chairman, Tree Authority under Section 8(6) of The Maharashtra (Urban Areas) Protection & Preservation of Trees Act 1975, as modified up to January 2018 vide **Municipal Commissioner Sanctioned No. MDG /6513 dt.19.07.2023.**

Hence, You are hereby directed to plant 02 (Two) in lieu of (As per section 8(5)(a) of MPPT (Amendment Act 2021) **Cutting 01** (One) no. of trees (Tree no.-01) & **Transplanting 02** (Two) nos. of trees (Tree no.-02, 03) within 15 days from the execution of trees Cutting & Transplanting.

You are requested to inform the Jr.Tree officer / Hort .Asstt. of concern ward about the date and time of cutting of trees as per permission, so that the representative of this office will remain present to ensure the work carried out properly Jr.Tree office/ Hort. Asstt 'F/South' ward whose contact no is - 8805526858

The remaining Nil nos.of trees shall be **Retained** as it is as per plan attached.

Whoever fells any tree or causes any tree to be felled in contraventions of the provisions of the Act or without reasonable excuse fails to comply with any order issued or condition imposed by the Tree Officer or the Tree Authority or voluntarily obstructs any member of the Tree Authority or the Tree Officer or any Officers and Servants subordinate to him in the discharge of their functions under this Act, shall, on conviction, be punished with the fine of not less than one thousand rupees which may extend upto five thousand rupees for every offense and also with imprisonment for a term of not less than one week. which may extent up to one year. The felling or causing of felling of each tree without the permission of the Tree Authority shall constitute a separate offense.

As per provision under section 19 (b) you are directed to plant trees in open spaces as well as R.G. area as per the norms of Tree Authority before getting occupation /completion certificate of the propose work.



As per direction of the Tree Authority, you are hereby directed to submit the photographs taken while transplanting of tree and the C.D. of the transplantation of the tree you are also requested to plant indigenous variety of tree having height of 6' & above. The list of indigenous variety of trees is enclosed herewith for your ready reference and compliance.

Thanking you.

Yours faithfully,



**Supdt. of Gardens  
& Tree Officer**



4-59

The permission for Cutting of 01 trees (Tree Sr.no. 01) & Tree Branches trimming of 01 trees (Tree Sr.no. 01) for Transplanting of 02 trees (Tree sr.no. 02, 03) and for Retaining of Nil tree (Tree Sr.no. Nil) is granted vide M.C. sanction no. MDG/ GS13 dt. 19-07-2023

Supd. of Gardens & Tree Officer

SITE U/R

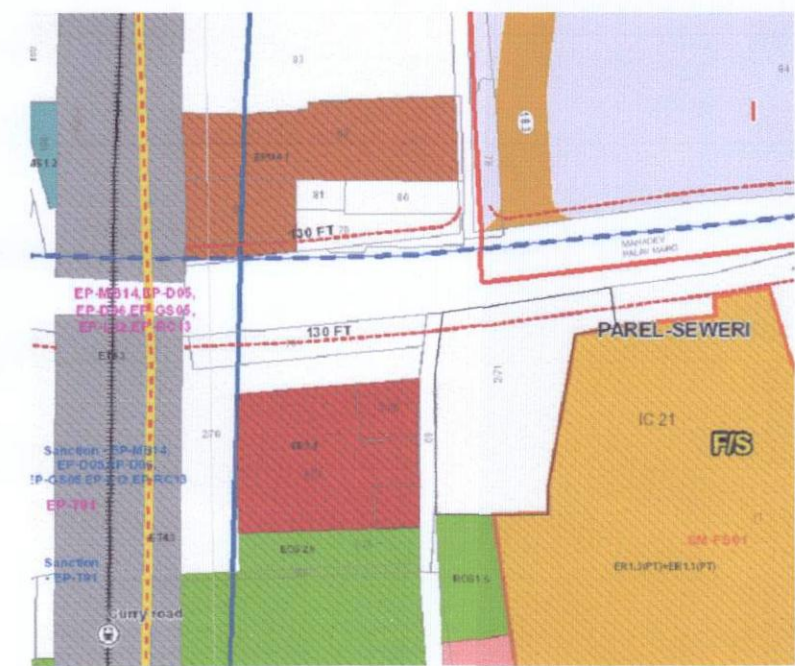

LOCATION PLAN  
SCALE :- 1:2500

- LEGENDS:
- 1) PLOT BOUNDARIES SHOWN
  - 3) SHORE PILE / EXCAVATION LINE SHOWN
  - 3) TREES TO BE CUT SHOWN
  - 4) TREES TO BE TRANSPLANT SHOWN

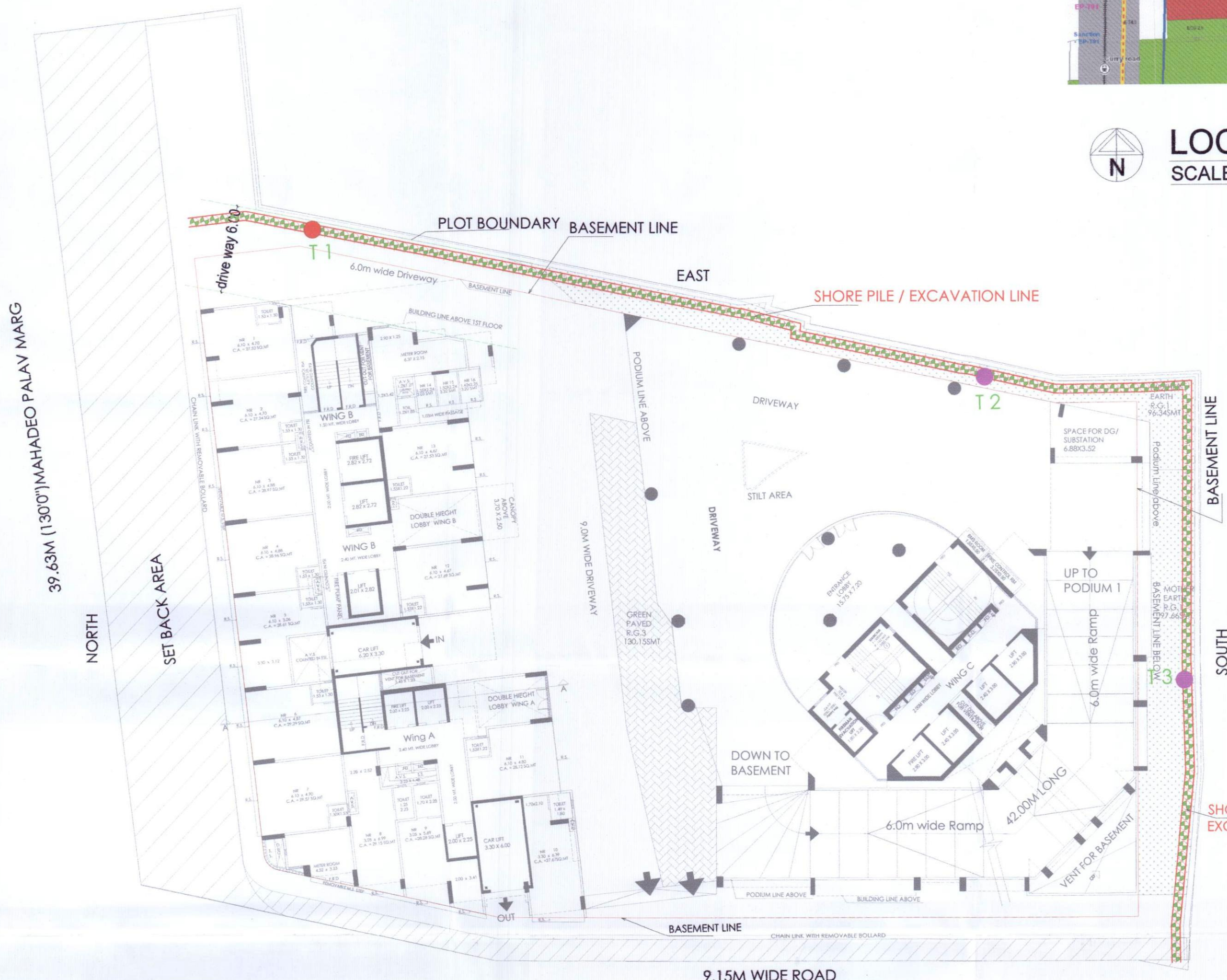

GROUND FLOOR PLAN  
SCALE:1:100

PROFORMA - A			
AREA STATEMENT		AREA IN SQ. MT	
1. GROUND AREA OF PLOT		3593.10	
2. TOTAL PLOT AREA		3593.10	
3. TOTAL PLOT AREA		3593.10	
4. TOTAL PLOT AREA		3593.10	
5. TOTAL PLOT AREA		3593.10	
6. TOTAL PLOT AREA		3593.10	
7. TOTAL PLOT AREA		3593.10	
8. TOTAL PLOT AREA		3593.10	
9. TOTAL PLOT AREA		3593.10	
10. TOTAL PLOT AREA		3593.10	
11. TOTAL PLOT AREA		3593.10	
12. TOTAL PLOT AREA		3593.10	
13. TOTAL PLOT AREA		3593.10	
14. TOTAL PLOT AREA		3593.10	
15. TOTAL PLOT AREA		3593.10	
16. TOTAL PLOT AREA		3593.10	
17. TOTAL PLOT AREA		3593.10	
18. TOTAL PLOT AREA		3593.10	
19. TOTAL PLOT AREA		3593.10	
20. TOTAL PLOT AREA		3593.10	
21. TOTAL PLOT AREA		3593.10	
22. TOTAL PLOT AREA		3593.10	
23. TOTAL PLOT AREA		3593.10	
24. TOTAL PLOT AREA		3593.10	
25. TOTAL PLOT AREA		3593.10	
26. TOTAL PLOT AREA		3593.10	
27. TOTAL PLOT AREA		3593.10	
28. TOTAL PLOT AREA		3593.10	
29. TOTAL PLOT AREA		3593.10	
30. TOTAL PLOT AREA		3593.10	
31. TOTAL PLOT AREA		3593.10	
32. TOTAL PLOT AREA		3593.10	
33. TOTAL PLOT AREA		3593.10	
34. TOTAL PLOT AREA		3593.10	
35. TOTAL PLOT AREA		3593.10	
36. TOTAL PLOT AREA		3593.10	
37. TOTAL PLOT AREA		3593.10	
38. TOTAL PLOT AREA		3593.10	
39. TOTAL PLOT AREA		3593.10	
40. TOTAL PLOT AREA		3593.10	
41. TOTAL PLOT AREA		3593.10	
42. TOTAL PLOT AREA		3593.10	
43. TOTAL PLOT AREA		3593.10	
44. TOTAL PLOT AREA		3593.10	
45. TOTAL PLOT AREA		3593.10	
46. TOTAL PLOT AREA		3593.10	
47. TOTAL PLOT AREA		3593.10	
48. TOTAL PLOT AREA		3593.10	
49. TOTAL PLOT AREA		3593.10	
50. TOTAL PLOT AREA		3593.10	
51. TOTAL PLOT AREA		3593.10	
52. TOTAL PLOT AREA		3593.10	
53. TOTAL PLOT AREA		3593.10	
54. TOTAL PLOT AREA		3593.10	
55. TOTAL PLOT AREA		3593.10	
56. TOTAL PLOT AREA		3593.10	
57. TOTAL PLOT AREA		3593.10	
58. TOTAL PLOT AREA		3593.10	
59. TOTAL PLOT AREA		3593.10	
60. TOTAL PLOT AREA		3593.10	
61. TOTAL PLOT AREA		3593.10	
62. TOTAL PLOT AREA		3593.10	
63. TOTAL PLOT AREA		3593.10	
64. TOTAL PLOT AREA		3593.10	
65. TOTAL PLOT AREA		3593.10	
66. TOTAL PLOT AREA		3593.10	
67. TOTAL PLOT AREA		3593.10	
68. TOTAL PLOT AREA		3593.10	
69. TOTAL PLOT AREA		3593.10	
70. TOTAL PLOT AREA		3593.10	
71. TOTAL PLOT AREA		3593.10	
72. TOTAL PLOT AREA		3593.10	
73. TOTAL PLOT AREA		3593.10	
74. TOTAL PLOT AREA		3593.10	
75. TOTAL PLOT AREA		3593.10	
76. TOTAL PLOT AREA		3593.10	
77. TOTAL PLOT AREA		3593.10	
78. TOTAL PLOT AREA		3593.10	
79. TOTAL PLOT AREA		3593.10	
80. TOTAL PLOT AREA		3593.10	
81. TOTAL PLOT AREA		3593.10	
82. TOTAL PLOT AREA		3593.10	
83. TOTAL PLOT AREA		3593.10	
84. TOTAL PLOT AREA		3593.10	
85. TOTAL PLOT AREA		3593.10	
86. TOTAL PLOT AREA		3593.10	
87. TOTAL PLOT AREA		3593.10	
88. TOTAL PLOT AREA		3593.10	
89. TOTAL PLOT AREA		3593.10	
90. TOTAL PLOT AREA		3593.10	
91. TOTAL PLOT AREA		3593.10	
92. TOTAL PLOT AREA		3593.10	
93. TOTAL PLOT AREA		3593.10	
94. TOTAL PLOT AREA		3593.10	
95. TOTAL PLOT AREA		3593.10	
96. TOTAL PLOT AREA		3593.10	
97. TOTAL PLOT AREA		3593.10	
98. TOTAL PLOT AREA		3593.10	
99. TOTAL PLOT AREA		3593.10	
100. TOTAL PLOT AREA		3593.10	

PROFORMA - B		
CONTENTS OF SHEET		
SECTION BB		
DESCRIPTION OF PROPOSAL & PROPERTY		
PROPOSED REDEVELOPMENT OF EXISTING BUILDING KNOWN AS "KAMGAR SWA-SADAN CO-OP. HOUSING SOCIETY LTD." SITUATED ON PROPERTY BEARING C.S.NO.2/71 OF PAREL SEWERI DIVISION, AT MAHADEV PALAY MARG, CURRY ROAD, MUMBAI - 400012 IN F/SOUTH WARD.		
PLANS FOR IOD		
THIS DOCUMENT IS DIGITALLY SIGNED AND PHYSICAL SIGN IS NOT REQUIRED. APPROVAL SUBJECT TO CONDITIONS MENTIONED IN THIS OFFICE LETTER UNDER AUTOCOR FILE NO. P-12547/2022(2/71)F/SOUTH-PAREL-SEWERI		
S.E.(BP)-XI	A.E.(BP)-V	E.E.(BP) City-III
NAME OF APPLICANT / DEVELOPER		
M/S RATNARAJ BLESSING MILESTONE		
NAME OF LICENSED SURVEYOR		SIGNATURE OF ARCHITECT
KANHERE ASSOCIATES LLP		SAURABH SATISH JADHAV
304, 3RD FLOOR, PHOENIX BUILDING, 457, S.V.P. ROAD, GIRGAON, MUMBAI - 400004		LICENSE SURVEYOR S.D. JADHAV LIC NO. J188/L5



## List of Indigenous variety of trees

Sr No.	Common Name	Botanical Name
1	Wad	Ficus bengalensis
2	Pimpal	Ficus religiosa
3	Umber	Ficus glomerata
4	Kanchan	Bauhinia purpurea
5	Kadamb	Anthocephalus indicus
6	Gunj	Adenanthera pavonia
7	Palas	Butea monosperma
8	Neem	Azardirachta indica
9	Mahogani	Swietenia mahigani
10	Mahua	Madhuca indica
11	Bahava	Cassia fistula
12	Sag	Tectona grandis
13	Arjun	Terminalia arjuna
14	Ain	Terminalia crenulata
15	Kinjal	Terminalia paniculata
16	Sita Ashok	Saraca indica
17	Undal	Calophyllum inophyllum
18	Nagkesar	Mesuaferrea
19	Champak	Magnolia Sps.
20	Shivan	Gmelina arborea
21	Shirish	Albigia lebek
22	Bakul	Mimusops elengi
23	Beal	Aegle marmelos
24	Taman	Lagerstroemia speciosa
25	Hirda	Terminalia chebula
26	Beheda	Terminalia belerica
27	Coconut	Cocos nucifera
28	Awla	Emblica officinallis
29	Khair	Acacia catechu
30	Tetu	Oroxylum indicum
31	Chinch	Tamarandus indicum
32	Putranjva	Putranjiva roxburghii
33	Jangli Badam	Sterculia foetida
34	Bibba	Semecarpus anacardium
35	Thevetia	Thevetia peruvians
36	Ritha	Sapindus laurifollius
37	Chandan	Santalum album
38	Kumbha	Careya arborea
39	Fishtail palm	Caryota urens
40	Khajur	Phoenix sylvestre
41	Chafa	Plumeria rubra

\*\*Having circumference of 1' above and height of 15' above, as per Tree Authority's resolution no.500, dt.18.03.2011