

BASEMENT PLAN

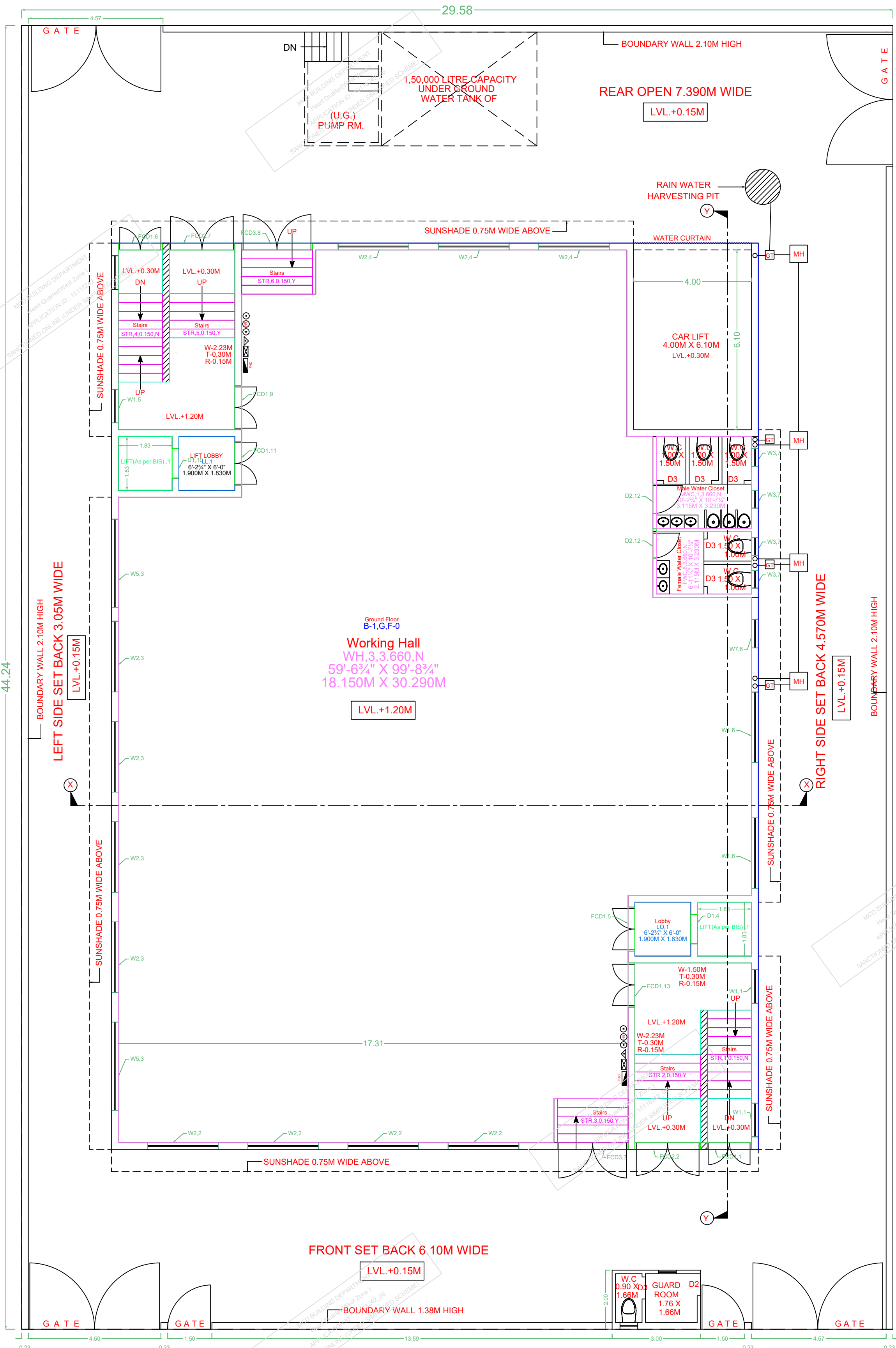

GROUND FLOOR PLAN

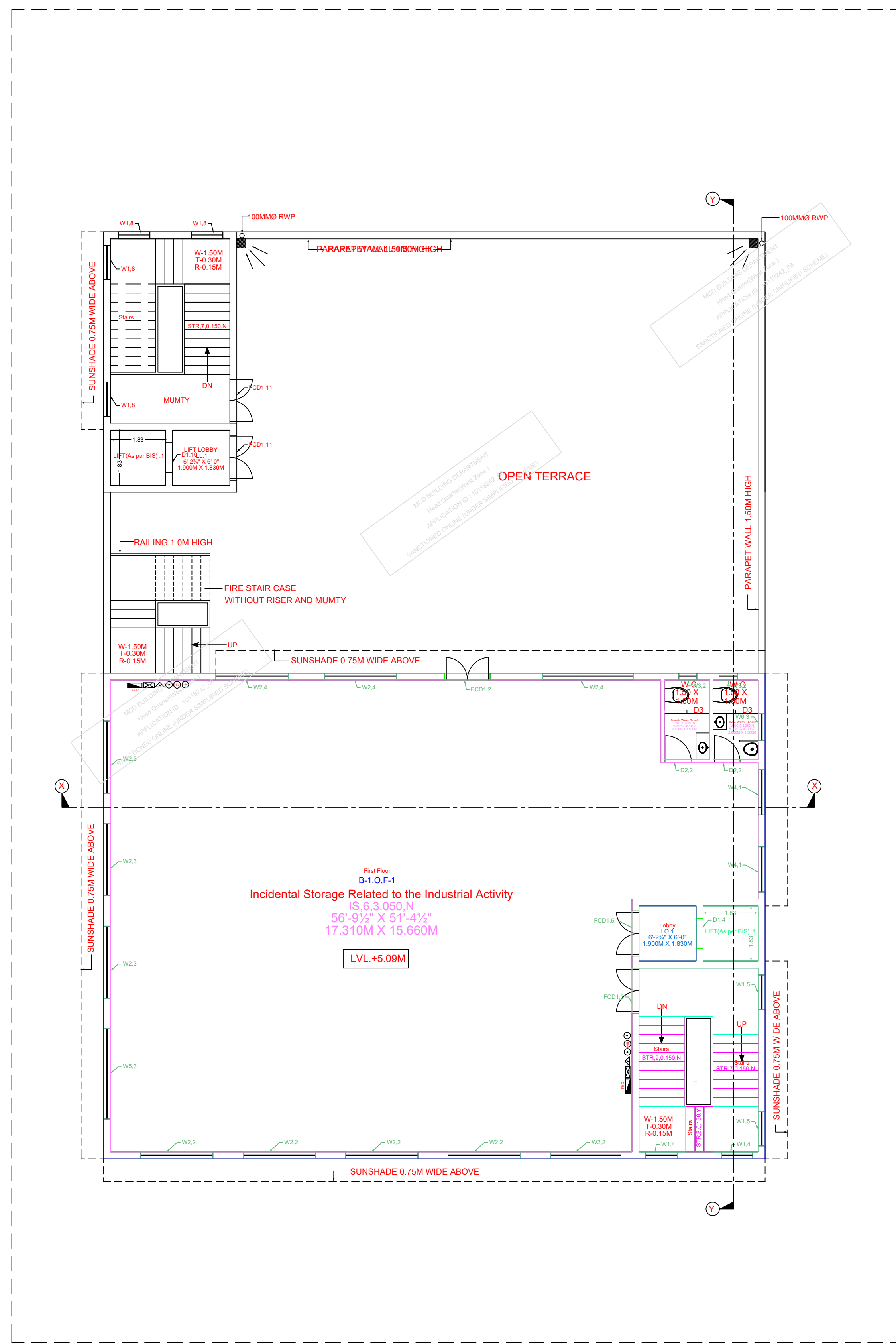

FIRST FLOOR PLAN

MULBA CERTIFICATE :

- CERTIFIED THAT ERECTION/RE-ERECTION, DEMOLITION OR MATERIAL ALTERNATION IN ANY OF THE DAMAGE/ SANITARY WORK SHALL BE CARRIED OUT EXECUTED BY ME UNDER MY SUPERVISION/OF BUILDING NO.-21, ON 1/IN PLOT/SHED AND I/WE CERTIFY THAT ALL THE MATERIAL (TYPE & GRADE) AND WORKMANSHIP OF THE WORK SHALL BE IN ACCORDANCE WITH THE SPECIFICATIONS SUBMITTED ALONG WITH THE WORK, AND SHALL BE CARRIED OUT ACCORDING TO STRUCTURAL DESIGN APPROVED IN SANCTIONED PLANS AND WHICH ALSO INCLUDES THE SERVICES LIKE, SANITARY, WATER SUPPLY, ELECTRICAL AND FIRE SAFETY NO NON-COMPOUNDING DEVIATIONS SHALL BE CARRIED OUT DURING THE COURSE OF CONSTRUCTION.
- CERTIFIED THAT THE DEBRIS DURING THE CONSTRUCTION WILL BE REMOVED ON WEEKLY BASIS. IF THE SAME IS NOT DONE, IN THAT CASE LOCAL BODY SHALL REMOVE THE MULBA/DEBRIS AND THE COST WITH PENALTY BE RECOVERED FROM ME/US.
- CERTIFIED THAT DURING CONSTRUCTION/I/WE SHALL PROPERLY SCREEN THE CONSTRUCTION SITE OFF THE MAIN ROAD BY MEANS OF ERECTING A SCREEN WALL NOT LESS THAN 8 FEET, IN HEIGHT FROM GROUND LEVEL WHICH SHALL BE PAINTED TO AVOID UNPLEASANT LOOK FROM THE ROAD SIDE. IN ADDITION TO THIS, A NET OR SOME OTHER PROTECTIVE MATERIAL SHALL BE HOISTED AT THE FACADE OF THE BUILDING TO ENSURE THAT ANY FALLING MATERIAL REMAINS WITHIN THIS PROTECTED AREA.
- CERTIFIED THAT NOISE RELATED ACTIVITIES WOULD NOT BE TAKEN UP FOR CONSTRUCTION AT NIGHT DURING 10 P.M. TO 6 A.M.

CERTIFICATE FOR INCORPORATION OF GREEN BUILDING FEATURES

- I/WE CERTIFY THAT THE BUILDING PLANS SUBMITTED FOR APPROVAL SATISFY THE GREEN BUILDING PROVISIONS GIVEN IN CHAPTER 10, AND THE INFORMATION GIVEN THEREIN IS FACTUALLY CORRECT TO THE BEST OF MY KNOWLEDGE AND UNDERSTANDING.
- WATER CONSERVATION AND MANAGEMENT
    - RAIN WATER HARVESTING (BY RECHARGE)
    - WASTE WATER RECYCLE AND REUSE
    - REDUCTION OF HARDSCAPE
    - SOLAR ENERGY UTILIZATION
  - INSTALLATION OF SOLAR ASSISTED WATER HEATING SYSTEMS
  - ENERGY EFFICIENCY
    - ENERGY EFFICIENCY IN HVAC SYSTEMS
  - WASTE MANAGEMENT
    - SEGREGATION OF WASTE

MECHANICALLY VENTILATION

- WHERE THE LIGHT AND VENTILATION REQUIREMENTS AREA NOT MEET THROUGH DAY LIGHTING & NATURAL VENTILATION THE SAME SHALL BE ENSURED THROUGH ARTIFICIAL LIGHTING AND MECHANICAL VENTILATION AS PER PART VIII BUILDING SERVICES SECTION 4, LIGHTING AND VENTILATION OF NATIONAL BUILDING CODE OF INDIA PUBLISHED BY THE INDIAN STANDARDS INSTITUTE THE LATEST VERSION OF THE NATIONAL BUILDING CODE OF INDIA SHALL BE TAKEN IN TO ACCOUNT AT THE TIME OF ENFORCEMENT OF THE BUILDING BYE-LAWS.

STRUCTURAL STABILITY CERTIFICATE :

- CERTIFIED THAT THE BUILDING PLANS SUBMITTED TO THE AUTHORITY/ CONCERNED LOCAL BODY SHALL BE DESIGNED FOR SAFETY REQUIREMENTS.
- IT IS ALSO CERTIFIED THAT THE STRUCTURAL DESIGN SHALL BE BASED ON NATIONAL BUILDING CODE, INCLUDING SAFETY FROM NATURAL HAZARDS BASED ON SOIL CONDITIONS (AS PER SOIL INVESTIGATION REPORT NO. MCA/DRA/SK/2024/04 DATED 17-03-2024 PREPARED BY MODCON CREATIVE SKETCHER PVT. LTD. WILL BE TAKEN IN TO CONSIDERATION AND WOULD BE DULY INCORPORATED IN STRUCTURAL DRAWINGS OF THE BUILDING TO BE CONSTRUCTED.

NOTE:-

PERMISSIBLE HEIGHT = 15.0 MTRS  
PROPOSED HEIGHT = 14.93 MTRS

WHENEVER NECESSARY

TOILET REQUIREMENTS FOR INDUSTRIAL BUILDING

NUMBER OF WORKERS = 7 NOS. MALE - 7, FEMALE - 0  
FOR GENTS :- REQUIREMENT AS PER N.B.C. STANDARDS  
W.C. :- 1 FOR 1 TO 15 PERSONS = 1/15 x = NOS.  
WASH BASIN :- 1 FOR 1 TO 15 PERSONS = 1/15 x = NOS.  
URINALS. :- 1 FOR 1 TO 15 PERSONS = 1/15 x = NOS.  
FOR LADIES :- REQUIREMENT AS PER N.B.C. STANDARDS  
W.C. :- 1 FOR 1 TO 12 PERSONS = 1/12 x = NOS.  
WASH BASIN :- 1 FOR 1 TO 25 PERSONS = 1/25 x = NOS.

NOTE:-

- ARTIFICIAL LIGHT & MECHANICAL VENTILATION SHALL BE APPROVED AS PER BUILDING BYE-LAW/ M.P.D. 2021

NOTE FOR BASEMENT

THE WALLS AND FLOOR OF THE BASEMENT SHALL BE MADE TIGHT AND BE SO DESIGNED THAT THE EFFECT OF SURROUNDING SOIL AND MOISTURE IF ANY BE TAKEN INTO ACCOUNT IN DESIGN AND DAMP PROOFING TREATMENT IS GIVEN.

DPCC CERTIFICATE:-

IT IS CERTIFIED THAT ALL COMPLIANCES OF DPCC WILL BE ADHERED DURING THE CONSTRUCTION.

DPCC NOTE:-

- WE WILL REGISTERED THE PROJECT WITH DPCC BEFORE COMMENCEMENT AT SITE.
- OUR TRADE USE IN WHITE CATEGORY HENCE NOC IS NOT REQUIRED.

WINDOW'S TABLE

W1	1.200	1.500
W2	2.400	1.800
W3	0.600	1.000
W4	1.500	1.800
W5	3.000	0.600
W6	0.800	1.000
V1	2.400	0.600
V2	0.970	0.600
W7	0.970	1.800

DOOR'S TABLE

FCD1	1.500	2.400
FCD2	2.230	2.400
FCD3	2.400	2.400
D1	1.000	2.400
D2	0.900	2.400
D3	0.750	2.400

NOTE FOR CIF

TRADE USE IS LIGHT ENGINEERING WORKS HENCE NO. OF WORKERS REQUIRED LESS THAN 8 THEREFOR C.I.F. NOC NOT REQUIRED.

NOTE FOR TREE

THERE IS NO EXISTING TREE IN AND AROUND THE PLOT.

NOTE FOR DELHI FIRE SERVICES

DFS OBSERVATIONS AND RECOMMENDATIONS VIDE LETTER NO. F6/DFS/MS/BP/2024/87 DATE 21-03-2024 ID NO. 10118242 HAS BEEN INCORPORATED IN THE PROPOSAL.

WATER HARVESTING CERTIFICATE :

- CERTIFICATE THAT THE BUILDING PLANS SUBMITTED FOR APPROVAL SATISFY THE WATER HARVESTING REQUIREMENTS AS WELL AS MINIMUM ANTICIPATED DISCHARGE OF WASTE WATER STIPULATED UNDER CLAUSE 22.4.1, 22.4.2 AND THE INFORMATION GIVEN THERE IN IS FACTUALLY CORRECT TO THE BEST OF OUR KNOWLEDGE AND UNDERSTANDING.
- WASTE WATER RECYCLING SYSTEM SHALL BE INCORPORATE AT SITE. THE RECYCLED WATER SHALL BE USED FOR HORTICULTURE PURPOSE.

PROJECT TITLE

**PROPOSED BUILDING PLANS FOR CONSTRUCTION OF A INDUSTRIAL BUILDING ON PLOT NO. 21, BLOCK-A, SITUATED AT REWARI LINE INDUSTRIAL AREA, PHASE-I KNOWN AS MAYA PURI , PHASE -I, NEW DELHI - 110064**

OWNER'S NAME

**SH. RAJIV ANAND**

SCALE

1 : 100

DRG. TITLE

SUB. DRG.

SHEET NO.

1

DATE

28-03-2024

ARCHITECT



RANENDER MALHOTRA  
CA/2005/35064  
3G/202, N.I.T. FARIDABAD  
PHONE : 9811732627

OWNERS SIGNATURE

1.

STRUCTURAL ENGINEER

SUSHIL KUMAR  
SE-29  
HOUSE NO. 37, STREET NO.-3  
ARJUN NAGAR WEST, DELHI-110051

