



Form C
Government of India
Food Safety and Standards Authority of India
License under FSS Act, 2006



अनुज्ञप्ति संख्या / License Number: 10012026000059



- | | |
|---|--|
| 1. Name & Registered Office address of Licensee / अनुज्ञप्तिधारी के पंजीकृत कार्यालय का नाम और पता: | K.P. SOLVEX PRIVATE LIMITED
VILLAGE - HARSHMAU, NIWARI (MP),
Tikamgarh, Madhya Pradesh-472442 |
| 2. Address of Authorized Premises / प्राधिकृत परिसर का पता: | VILLAGE - HARSHMAU, NIWARI (MP), Niwari,
Tikamgarh, Madhya Pradesh-472442 |
| 3. Kind of Business / कारोबार का प्रकार: | Manufacturer - General Manufacturing
Manufacturer - Substances Added to Food
Manufacturer - Vegetable oil and processing units |
| 4. Dairy Business Details / डेयरी कारोबार विवरण हेतु: | No |
| 5. Category of License / अनुज्ञप्ति का वर्ग: | Central License |

This license is granted under and is subject to the provisions of FSS Act, 2006 all of which must be complied with by the licensee. / यह अनुज्ञप्ति खाद्य संरक्षा और मानक अधिनियम, 2006 के अधीन अनुदत्त की गई और वह अधिनियम के उपबंधों के अध्यादीन है जिनका अनुज्ञप्तिधारी द्वारा अवश्य पालन किया जाना चाहिए।

Place / स्थान: FSSAI Mumbai

Designated Officer

Issued On / दिनांक: 04-04-2025 (Renewal License)

Valid Upto: / वैधता: 25-05-2030 (For details, refer Annexure)

Annexures:

1. Product Annexure
2. Validity Annexure
3. Non-Form C Annexure
4. Conditions Of License

Note:

1. Application for renewal of License can be filed as early as 180 days prior to expiry date of License. You can file application for renewal or modification of License by login into FSSAI's Food Safety Compliance System(<https://foscos.fssai.gov.in>) with your user id and password or call us at 1800112100 for any clarification.
2. This License is only to commence or carry on food businesses and not for any other purpose.
3. This is computer generated license and doesn't require any signature or stamp by authority.
4. Communications from FoSCoS are being sent to kpxxxxxxxxxxxxxxxxxxcom , kpxxxxxxxxxxxxxxxxxxcom , kpxxxxxxxxxxxxxxxxxxcom and 94xxxxx237 , 99xxxxx496 , 87xxxxx071.To update these details, visit FoSCoS portal.

Product Annexure



Form C
Government of India
Food Safety and Standards Authority of India
License under FSS Act, 2006



अनुज्ञप्ति संख्या / License Number: **10012026000059**

Kind Of Business: Manufacturer - Vegetable oil and processing units

Sl.No.	Food Category	Sub-Food Category	Product	Oil Type
1	02 - Fats and oils, and fat emulsions	02.1 - Fats and oils essentially free from water	Refined Soyabean Oil [02.1.2]	Refined Oils
Kind Of Business: Manufacturer - Vegetable oil and processing units				
2	02 - Fats and oils, and fat emulsions	02.1 - Fats and oils essentially free from water	Refined Mustard/Rapeseed Oil [02.1.2]	Refined Oils
Kind Of Business: Manufacturer - Vegetable oil and processing units				
3	02 - Fats and oils, and fat emulsions	02.1 - Fats and oils essentially free from water	Refined Sesame Oil [02.1.2]	Refined Oils
Kind Of Business: Manufacturer - Vegetable oil and processing units				
4	02 - Fats and oils, and fat emulsions	02.1 - Fats and oils essentially free from water	Refined Cottonseed Oil [02.1.2]	Refined Oils
Kind Of Business: Manufacturer - Vegetable oil and processing units				
5	02 - Fats and oils, and fat emulsions	02.1 - Fats and oils essentially free from water	Refined Maize (Corn) oil [02.1.2]	Refined Oils
Kind Of Business: Manufacturer - Vegetable oil and processing units				
6	02 - Fats and oils, and fat emulsions	02.1 - Fats and oils essentially free from water	Refined Rice Bran Oil [02.1.2]	Refined Oils
Kind Of Business: Manufacturer - Vegetable oil and processing units				
7	02 - Fats and oils, and fat emulsions	02.1 - Fats and oils essentially free from water	Refined Palm Oil [02.1.2]	Refined Oils
Kind Of Business: Manufacturer - Vegetable oil and processing units				
8	02 - Fats and oils, and	02.1 - Fats and oils	Refined Safflower Oil	Refined Oils

Sl.No.	Food Category	Sub-Food Category	Product	Oil Type																												
	fat emulsions	essentially free from water	[02.1.2]																													
Kind Of Business: Manufacturer - Vegetable oil and processing units																																
9	02 - Fats and oils, and fat emulsions	02.1 - Fats and oils essentially free from water	Refined Linseed Oil [02.1.2]	Refined Oils																												
Kind Of Business: Manufacturer - Vegetable oil and processing units																																
10	02 - Fats and oils, and fat emulsions	02.1 - Fats and oils essentially free from water	Refined Groundnut Oil [02.1.2]	Refined Oils																												
Kind Of Business: Manufacturer - Vegetable oil and processing units																																
11	02 - Fats and oils, and fat emulsions	02.1 - Fats and oils essentially free from water	Refined Sunflower Oil [02.1.2]	Refined Oils																												
Kind Of Business: Manufacturer - Vegetable oil and processing units																																
12	02 - Fats and oils, and fat emulsions	02.1 - Fats and oils essentially free from water	Rapeseed oil (toria oil) or mustard oil (sarson ka tel) [02.1.2]	Solvent Extracted Oils																												
<table border="1"> <thead> <tr> <th>Name of oil bearing material</th><th>From Seed/ Nut/Cake</th><th>Crude</th><th>Neutralized</th><th>Neutralized & Bleached</th><th>Refined</th><th>De-Oil Meal</th><th>Edible Flour</th><th>Kind of Business</th></tr> </thead> <tbody> <tr> <td>MUSTARD</td><td>SEED/ CAKE</td><td>Yes</td><td>No</td><td>No</td><td>No</td><td>Yes</td><td>Yes</td><td>Manufacturer - Vegetable oil and processing units</td></tr> </tbody> </table> <p>Details of factory(s) used by miller or solvent extractor for processing oil bearing material produced/procured or for refining solvent extracted oil:</p> <table border="1"> <thead> <tr> <th>Name</th><th>Address</th><th>State</th><th>District</th><th>Postal Pin-Code</th></tr> </thead> <tbody> <tr> <td>K.P.SOLVEX PRIVATE LIMITED</td><td>NIWARI</td><td>Madhya Pradesh</td><td>Tikamgarh</td><td>472442</td></tr> </tbody> </table>					Name of oil bearing material	From Seed/ Nut/Cake	Crude	Neutralized	Neutralized & Bleached	Refined	De-Oil Meal	Edible Flour	Kind of Business	MUSTARD	SEED/ CAKE	Yes	No	No	No	Yes	Yes	Manufacturer - Vegetable oil and processing units	Name	Address	State	District	Postal Pin-Code	K.P.SOLVEX PRIVATE LIMITED	NIWARI	Madhya Pradesh	Tikamgarh	472442
Name of oil bearing material	From Seed/ Nut/Cake	Crude	Neutralized	Neutralized & Bleached	Refined	De-Oil Meal	Edible Flour	Kind of Business																								
MUSTARD	SEED/ CAKE	Yes	No	No	No	Yes	Yes	Manufacturer - Vegetable oil and processing units																								
Name	Address	State	District	Postal Pin-Code																												
K.P.SOLVEX PRIVATE LIMITED	NIWARI	Madhya Pradesh	Tikamgarh	472442																												
13	02 - Fats and oils, and fat emulsions	02.1 - Fats and oils essentially free from water	Soyabean oil [02.1.2]	Solvent Extracted Oils																												
<table border="1"> <thead> <tr> <th>Name of oil bearing material</th><th>From Seed/ Nut/Cake</th><th>Crude</th><th>Neutralized</th><th>Neutralized & Bleached</th><th>Refined</th><th>De-Oil Meal</th><th>Edible Flour</th><th>Kind of Business</th></tr> </thead> <tbody> <tr> <td>SOYABEAN</td><td>SEED</td><td>Yes</td><td>No</td><td>No</td><td>No</td><td>Yes</td><td>Yes</td><td>Manufacturer - Vegetable oil and processing units</td></tr> </tbody> </table> <p>Details of factory(s) used by miller or solvent extractor for processing oil bearing material produced/procured or for refining solvent extracted oil:</p> <table border="1"> <thead> <tr> <th>Name</th><th>Address</th><th>State</th><th>District</th><th>Postal Pin-Code</th></tr> </thead> <tbody> </tbody> </table>					Name of oil bearing material	From Seed/ Nut/Cake	Crude	Neutralized	Neutralized & Bleached	Refined	De-Oil Meal	Edible Flour	Kind of Business	SOYABEAN	SEED	Yes	No	No	No	Yes	Yes	Manufacturer - Vegetable oil and processing units	Name	Address	State	District	Postal Pin-Code					
Name of oil bearing material	From Seed/ Nut/Cake	Crude	Neutralized	Neutralized & Bleached	Refined	De-Oil Meal	Edible Flour	Kind of Business																								
SOYABEAN	SEED	Yes	No	No	No	Yes	Yes	Manufacturer - Vegetable oil and processing units																								
Name	Address	State	District	Postal Pin-Code																												

Sl.No.	Food Category	Sub-Food Category	Product	Oil Type
	K.P.SOLVEX PRIVATE LIMITED	NIWARI	Madhya Pradesh Tikamgarh	472442

Oil Capacity		
Sl.No.	Oil Type	Capacity
1	Solvent Extracted Oils	60.00 Tonnes/day
2	Refined Oils	50.00 Tonnes/day

Kind Of Business: Manufacturer - General Manufacturing

Production Capacity(MT / Day): 150

Sl.No.	Food Category	Sub-Food Category	Product	Kind of Business
1	06 - Cereals and cereal products, derived from cereal grains, from roots and tubers, pulses, legumes and pith or soft core of plam tree, excluding bakery wares of food category 7.0	06.8 - Soybean products (excluding soybean-based seasonings, and condiments of food category 12.9)	Textured Soy Protein (Soy Bari or Soy Chunks or Soy Granules) [06.8]	Manufacturer - General Manufacturing
2	06 - Cereals and cereal products, derived from cereal grains, from roots and tubers, pulses, legumes and pith or soft core of plam tree, excluding bakery wares of food category 7.0	06.2 - Flours and starches (including soybean powder)	Solvent Extract Soya Flour [06.2.1]	Manufacturer - General Manufacturing
3	06 - Cereals and cereal products, derived from cereal grains, from roots and tubers, pulses, legumes and pith or soft core of plam tree, excluding bakery wares of food category 7.0	06.1 - Whole, broken, or flaked grain, including rice	Pulses (Lentil (Masur), Black gram (Urd), Green gram (Moong), Bengal gram (Chana or Chick pea) or Kabuli chana or Chhole or (green chick pea) hara chana, Red gram (Arhar), Horse gram (Kulthi), Field bean (Black, Brown, White), Sem, Peas dry (Matra), Soybean, Rajmah or Double beans or Broad beans or Black beans, Lobia or black eyed beans or black eyed white lobia, Moth bean (matki)) [06.1]	Manufacturer - General Manufacturing

Kind Of Business: Manufacturer - Substances Added to Food

Production Capacity(MT / Day): 10

Sl.No.	Food Category	Sub-Food Category	Product	Kind of Business
1	99 - Substances added to food	99.1 - Food Additives	LECITHINS	Manufacturer - Substances Added to Food

Validation And Renewal Annexure

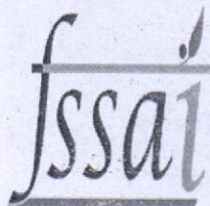

Form C
Government of India
Food Safety and Standards Authority of India
License under FSS Act, 2006



अनुज्ञप्ति संख्या / License Number: 10012026000059

Validity From	Validity Upto	Issued On	Fee Paid	Type	Issuing Authority
26-05-2015	25-05-2020	22-05-2015	38100 INR	Renewal	Central Licensing Authority
26-05-2020	25-05-2025	16-06-2020	37500 INR	Renewal	Central Licensing Authority
26-05-2020	25-05-2025	10-03-2021	1000 INR	Modification	Central Licensing Authority
26-05-2025	25-05-2030	04-04-2025	44250 INR	Renewal	Central Licensing Authority

Suspension History

S.No	History	Date
N/A		

Current Status of License: License Issued

Note:

1. Application for renewal of License can be filed as early as 180 days prior to expiry date of License. You can file application for renewal or modification of License by login into FSSAI's Food Safety Compliance System(<https://foscos.fssai.gov.in>) with your user id and password or call us at 1800112100 for any clarification.
2. FSSAI vide order number 15(31)2020/FoSCoS/RCD/FSSAIpt1-Part(4) dated 11th January 2023 allowed Instant Renewal of License / Registration.
3. FSSAI vide order number 15(31)2020/FoSCoS/RCD/FSSAI dated 29th October 2021 has allowed the renewal of Licenses / Registration till 180 days of the expiry date subject to payment of penalty.
4. Modification* (if any) denotes the change in the Authority. Issuing Authority mentioned along with Modification* is the Jurisdictional Authority with effect from the date of issuance of modified license.

Non-Form C Annexure



Government of India
Food Safety and Standards Authority of India
License under FSS Act, 2006



अनुज्ञप्ति संख्या / License Number: **10012026000059**

Person in charge of operations

Name:	AJAI KUMAR SINGH	Qualification:	BE CHEMICAL
Contact No:	8795601071	Mobile No:	8795601071
Email-ID:	kpsolvex@hotmail.com		
Address :	VILLAGE - HARSHMAU, NIWARI (MP) - 472442		
State:	Madhya Pradesh	District:	Tikamgarh
Pin Code:	472442	Photo Id Card:	Aadhar Card
Photo Id No:	379161336043	Photo Id Expiry Date:	N/A
FoSTaC No:	AMACOVID2032563739		

Person responsible for complying with conditions of license(The person must be same as mentioned in Form IX, as per FSS Regulations, 2011)

Name:	AJAI KUMAR SINGH	Qualification:	BE CHEMICAL
Contact No:	8795601071	Mobile No:	8795601071
Email-ID:	kpsolvex@hotmail.com		
Address :	VILLAGE - HARSHMAU, NIWARI (MP) - 472442		
State:	Madhya Pradesh	District:	Tikamgarh
Pin Code:	472442	Photo Id Card:	Aadhar Card
Photo Id No:	379161336043	Photo Id Expiry Date:	N/A

Place / स्थान: FSSAI Mumbai

Designated Officer

Issued On / दिनांक: 04-04-2025 (Renewal License)

Note: Any change in above details shall be immediately communicated to authorities. You can apply for modification of license for updation of details without any cost through Food Safety Compliance System (<https://foscos.fssai.gov.in>)

Condition of License

All Food Business operators shall ensure that the following conditions are complied with at all times during the course of its Food Business.

Food Business Operators Shall:

1. Display a true copy of the license granted in Form C shall at all time at a prominent place in the premises.
2. Give necessary access to licensing authorities or their authorized personnel to the premises.
3. Inform authorities about any change or modifications in activities.
4. Employ at least one technical person to supervise the production process. The person supervising the production process shall possess at least a degree in science with Chemistry/ Bio-chemistry/ Food and nutrition/ Microbiology or a degree or diploma in Food Technology/ Dairy Technology/ Dairy Microbiology/ Dairy chemistry/ Dairy engineering/ Oil technology/ Veterinary science/ Hotel management & Catering technology or any degree or diploma in any other discipline related to the specific requirement of the business from a recognized university or institute or equivalent.
5. Furnish periodic annual return 1st April to 31 st March, with in 31 st May of each year. For collection/ handling/manufacturing of milk and milk product half yearly return also to be furnished as specified.
6. Ensure that no product other than the product indicated in the license /registration is produced in the unit.
7. Maintain factory's sanitary and hygienic standards and workers hygiene as specified in the schedule-4 according to the category of food business.
8. Maintain daily records of production, raw materials utilization and sales separately.
9. Ensure that the source and standards of raw material used are of optimum quality.
10. Food business operator shall not manufacture , store or expose for sale or permit the sale of any article of food in any premises not effectively separated to the satisfaction of the licensing authority from any privy, urine, sullage ,drain or place of storage of foul and waste matter
11. Ensure clean-in-place system (whatever necessary) for regular cleaning of machine & equipment.
12. Ensure testing of relevant chemical and/or microbiological contaminants in food products in accordance with these regulation as frequency as required on the basis of historical data and risk assessment to ensure production and delivery of safe food through own or NABLaccredited/FSSAI recognized labs atleast once in six month.
13. Ensure that as much as possible the required temperature shall be maintained throughout the supply chain from the place of procurement or sourcing till it reaches the end consumer including chilling, transportation, storage etc.
14. The Manufacturer/ Importer/ Distributer shall buy and sell food products only from, or to , licensed / registered vendors and maintain record thereof.

Other Condition

1. Proprietors of hotels, restaurants and other food stalls who sell or expose for sale savouries, sweets or other article of food shall put up a notice board containing separates lists of the articles which have been cooked in ghee, edible oil, vanaspati and other fats for the information of the intending purchasers.
2. Food business operator selling cooked or prepared food shall display a notice board containing the nature of articles being exposed for sale.
3. Every manufacture (including ghani operator) or wholesale dealer in butter ,ghee ,vanaspti ,edible oils, solvent extracted oil, de oiled meal, edible flour and any other fats shall minimum a register showing the quantity of manufactured, received or sold, nature of oil seed used and quantity of de oiled meal and edible flour used etc. as applicable and the destination of each consignment of the substances sent out from his factory or place of business, and shall present such register for inspection whenever required to do so by the licensing authority.
4. No producer or manufacturer or vegetable oil ,edible oil and their products shall be edible for license under this act ,unless he has own laboratory facility for analytical testing of samples
5. Every sale and movement of stocks of solvents- extracted oil , 'semi refined' or 'raw grade I' , edible groundnut flour or edible coconut flour ,or both by the producer shall be a sale or movement of stocks directly to a registered user and not to any other person ,and no such sale or movement shall be effected through any third party.
6. Every quantity of solvent-extracted oil ,edible groundnut flour or edible coconut flour ,or both purchased by a registered user shall be used by him in his own factory entirely for the purpose intended and shall not be re-sold or otherwise transferred to any other person :
Provided that nothing in this sub-clause shall apply to the sale or movement of the following:-
 1. Karanjia oil
 2. Kusum oil
 3. Mahua oil
 4. Neem oil
 5. Tamarind seed oil
 6. Edible groundnut flour bearing the I.S.I certification mark
 7. Edible coconut flour bearing the I.S.I certificate mark
7. No food business operator shall sell or distribute or offer for sale or dispatch or deliver to any person for purpose of sale any edible oil which is not packed, marked and labeled in the manner specified in the regulations unless specifically exempted from this condition vide notification in the official Gazette issued in the public interest by food safety commissioners in specific circumstances and for a specific period and for reason to be recorded in writing.

11 MAY 1968
 PALLMAY TRACK
 MANY DUB. JN.

CLASSIFICATION OF STRUCTURES		
NO.	DESCRIPTION	AREA (SQ. M)
1	SE PLANT	25.50 x 12.50
2	PREPATORY	20.50 x 15.50
3	FINISHED SECTION	50.50 x 15.50
4	GO DOWN	60.50 x 15.50
5	GO DOWN	60.50 x 15.50
6	OFFICE	15.50 x 28.00
7	LAB	15.50 x 28.00
8	GO DOWN	15.50 x 28.00
9	GO DOWN	42.00 x 18.00
10	GO DOWN	42.00 x 18.00
11	GO DOWN	30.00 x 28.00
12	WORK-SHOP	50.00 x 28.00
13	PLATFORM	3.00 x 4.00
14	COURT-YARD	15.00 x 15.00
15	WATER-WELL	0.60 x 0.30
16	PLATE FORM	0.60 x 0.30
17	LABOR-ROOM	15.00 x 28.00
18	OFFICE	15.00 x 28.00
19	OFFICE	15.00 x 28.00
20	GATE ROOM	0.30 x 0.30
21	GATE COMPLEX	0.30 x 0.30
22	FINISH-BRIDGE	10.00 x 0.30
23	HEAD-STORE	10.00 x 0.30
24	FUEL-STORE	10.00 x 0.30
25	STEEL YARD	50.00 x 10.00
26	SHADE GO DOWN	18.00 x 18.00
27	MAKANA REPAIR	18.00 x 18.00
28	REPAIR	18.00 x 18.00
29	REPAIR	18.00 x 18.00
30	GO DOWN	18.00 x 18.00
31	GO DOWN	18.00 x 18.00
32	GO DOWN	18.00 x 18.00
33	GO DOWN	18.00 x 18.00
34	GO DOWN	18.00 x 18.00
35	GO DOWN	18.00 x 18.00
36	GO DOWN	18.00 x 18.00
37	GO DOWN	18.00 x 18.00
38	GO DOWN	18.00 x 18.00
39	GO DOWN	18.00 x 18.00
40	GO DOWN	18.00 x 18.00
41	GO DOWN	18.00 x 18.00
42	GO DOWN	18.00 x 18.00
43	GO DOWN	18.00 x 18.00
44	GO DOWN	18.00 x 18.00
45	GO DOWN	18.00 x 18.00
46	GO DOWN	18.00 x 18.00
47	GO DOWN	18.00 x 18.00
48	GO DOWN	18.00 x 18.00
49	GO DOWN	18.00 x 18.00
50	GO DOWN	18.00 x 18.00
51	GO DOWN	18.00 x 18.00
52	GO DOWN	18.00 x 18.00
53	GO DOWN	18.00 x 18.00
54	GO DOWN	18.00 x 18.00
55	GO DOWN	18.00 x 18.00
56	GO DOWN	18.00 x 18.00
57	GO DOWN	18.00 x 18.00
58	GO DOWN	18.00 x 18.00
59	GO DOWN	18.00 x 18.00
60	GO DOWN	18.00 x 18.00
61	GO DOWN	18.00 x 18.00
62	GO DOWN	18.00 x 18.00
63	GO DOWN	18.00 x 18.00
64	GO DOWN	18.00 x 18.00
65	GO DOWN	18.00 x 18.00
66	GO DOWN	18.00 x 18.00
67	GO DOWN	18.00 x 18.00
68	GO DOWN	18.00 x 18.00
69	GO DOWN	18.00 x 18.00
70	GO DOWN	18.00 x 18.00
71	GO DOWN	18.00 x 18.00
72	GO DOWN	18.00 x 18.00
73	GO DOWN	18.00 x 18.00
74	GO DOWN	18.00 x 18.00
75	GO DOWN	18.00 x 18.00
76	GO DOWN	18.00 x 18.00
77	GO DOWN	18.00 x 18.00
78	GO DOWN	18.00 x 18.00
79	GO DOWN	18.00 x 18.00
80	GO DOWN	18.00 x 18.00
81	GO DOWN	18.00 x 18.00
82	GO DOWN	18.00 x 18.00
83	GO DOWN	18.00 x 18.00
84	GO DOWN	18.00 x 18.00
85	GO DOWN	18.00 x 18.00
86	GO DOWN	18.00 x 18.00
87	GO DOWN	18.00 x 18.00
88	GO DOWN	18.00 x 18.00
89	GO DOWN	18.00 x 18.00
90	GO DOWN	18.00 x 18.00
91	GO DOWN	18.00 x 18.00
92	GO DOWN	18.00 x 18.00
93	GO DOWN	18.00 x 18.00
94	GO DOWN	18.00 x 18.00
95	GO DOWN	18.00 x 18.00
96	GO DOWN	18.00 x 18.00
97	GO DOWN	18.00 x 18.00
98	GO DOWN	18.00 x 18.00
99	GO DOWN	18.00 x 18.00
100	GO DOWN	18.00 x 18.00

TITLE - DETAILS OF LAYOUT OF PLANT	SCALE: 1:400
DESCRIPTION AND LAYOUT OF THE BUILDING-GODOWN	OIL-TANK ETC. OF THE PLANT.

PREPARED BY
K.L. ANIRWAR-B.E. CIVIL.
NIWAR1-DISTT. TIKAMGARH [MP]

MANAGING-DIRECTOR:-
 MRS. K. P. SOLVER
 PLOT NO. MIHARI
 VILL. HARSH-NAR
 TEH. NIWARI
 DIST. T. KAMARAH
 (M.D.) 472442.

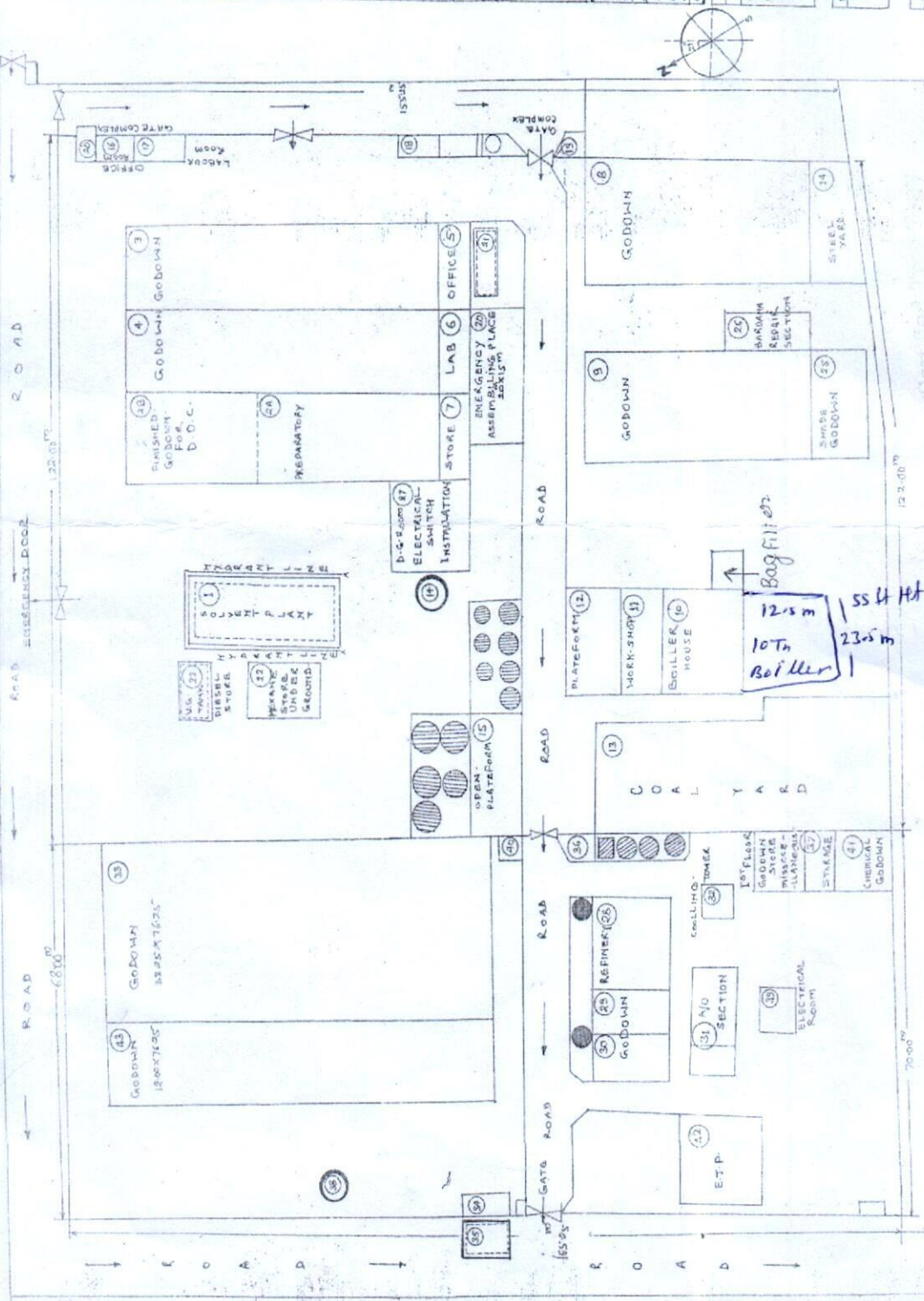

Director

A hand-drawn map of a property. The map shows a large rectangular area with a horizontal dimension of 180' and a vertical dimension of 30' H. The area is divided into several sections. On the left, there is a section labeled '60' and '1' shed'. To the right of this, there is a section labeled '30' H' and 'Godown'. Above the main area, there are two smaller rectangular sections. The top-left section is labeled '25'' and '10' shed'. The top-right section is labeled '25'' and '12' shed'. Below the main area, there is a section labeled '50' and '180''.

KP Solvex Pvt Ltd



Plant Incharge
Shrikant Trivedi
7828117222



DESCRIPTION OF STRUCTURE			
Sl. No	It	DESCRIPTION	AREA-MXM
1	1	S.E. PLANT 35H	28.50X12.50
2	2A	PREPARATORY ✓	40.00X15.00
3	2B	FINISHED-SECTION ✓	20.00X15.00
4	3	GODOWN ✓ 30 ft H	60.00X15.00
5	4	GODOWN ✓ 30 ft H	60.00X15.00
6	5	OFFICE ✓ G+F	15.00X08.00
7	6	LAB G+F	15.00X08.00
8	7	STORE ✓ G+F	15.00X08.00
9	8	GODOWN ✓ 30 ft H	45.00X15.00
10	9	GODOWN ✓ 30 ft H	45.00X18.00
11	10	BOILER-HOUSE 30 H	30.00X28.00
12	11	WORK-SHOP 30 H	30.00X08.00
13	12	PLATFORM 30 ft H	
14	13	GOAL-YARD	50.00X20.00
15	14	WATER-WELL ✓	9.00φ 9.00 HT.
16	15	PLATE FORM ✓	15.00X10.00
17	16	ROOM	06.00X03.00
18	17	LABOUR-ROOM	15.00X03.00
19	18	OFFICE [MEETING] G+F	12.00X03.00
20	19	GATE ROOM	03.00X03.00
21	20	GATE-COMPLEX	03.00X03.00
22	21	WEIGH-BRIDGE	10.00X03.00
23	22	HEXANE-STORE [U.G.]	10.00X05.00
24	23	DIESEL-STORE [U.G.]	10.00X03.50
25	24	STEELYARD	15.00X10.00
26	25	SHADE GODOWN	18.00X12.00
27	26	BARDANA-REPAIR	18.00X04.00
28	27	D.G.-ROOM ✓	12.00X18.00
29	28	REFINERY 40 ft H	16.00X16.00
30	29	GODOWN 12 ft H	16.00X08.00
31	30	GODOWN 12 ft H	16.00X08.00
32	31	A/O SECTION	10.00X07.00
33	32	COOLING-TOWER	10.00X08.00
34	33	GODOWN 30 ft H	33.25X76.25
35	34	OFFICE	12.00X04.00
36	35	WEIGH-BRIDGE G+F	12.00X05.00
37	36	GATE-ROOM	04.00X04.00
38	37	GODOWN-STORE	10.00X12.00
39	38	WATER WELL	14.00φ 11.00 HT.
40	39	ELECTRICAL-ROOM	10.00X08.00
41	40	GATE ROOM	03.00X03.50
42	41	CHEMICAL-GODOWN	10.00X05.00
43	42	E.T. PLANT 100 KL	13.00X13.00
44	43	GODOWN - 30' H	12.00X76.25

TITLE :- DETAILS OF LAYOUT OF PLANT
SCALE: 1:400
DESCRIPTION AND LAYOUT PLAN
OF THE BUILDING-GODOWN
OIL-TANK ETC. OF THE PLANT.



ISSUED BY MADHYA PRADESH

State Transport Department

TIKAMGARH DTO

FORM 38

[See Rule 62(1)]

CERTIFICATE OF FITNESS

(Applicable in the case of transport vehicles only)



Vehicle No: **MP07N3127** (Goods Carrier) is certified as complying with the provisions of the Motor vehicles Act, 1988 and the rules made there under.

Registration No : MP07N3127
Application No : MP240522V3698552
Inspection Fee Receipt No : MP240522C3936689
Receipt Date : 22-May-2024
Chassis No : ALEN236166
Engine No : ALEN113579
Seating Capacity : 6 (Including Driver)
Type of Body : OPEN BODY
Manufacturing Year : 1989
Category of Vehicle : HGV
Inspected on : 22-May-2024

Certificate will expire on : 12-Jun-2025

Next Inspection Due : 14-Apr-2025

Date

Printed on : 03-Jun-2024 15:10:41

Inspected by (ANKIT UPADHYAY)

Signature of Inspecting Authority
TIKAMGARH DTO

टीकमगढ़ (म.प्र.)

ISSUED BY MADHYA PRADESH



State Transport Department

TIKAMGARH DTO

FORM 38

[See Rule 62(1)]

CERTIFICATE OF FITNESS

(Applicable in the case of transport vehicles only)



Vehicle No: **MP071784** (Goods Carrier) is certified as complying with the provisions of the Motor vehicles Act, 1988 and the rules made there under.

Registration No : MP071784
Application No : MP240528V1389329
Inspection Fee Receipt No : MP240528C7489292
Receipt Date : 28-May-2024
Chassis No : ALEP243762
Engine No : ALEP120918
Seating Capacity : 6 (Including Driver)
Type of Body : TANKER
Manufacturing Year : 1990
Category of Vehicle : HGV
Inspected on : 30-May-2024

Certificate will expire on : 14-Jun-2025

Next Inspection Due : 16-Apr-2025

Date

Printed on : 03-Jun-2024 15:10:40

Inspected by (ANKIT UPADHYAY)

Signature of Inspecting Authority

TIKAMGARH DTO

टीकमगढ़ (म.प्र.)



ISSUED BY MADHYA PRADESH

State Transport Department

TIKAMGARH DTO

FORM 38

[See Rule 62(1)]

CERTIFICATE OF FITNESS

(Applicable in the case of transport vehicles only)

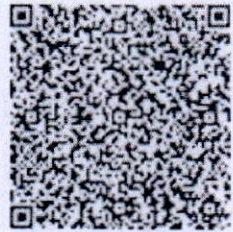

Vehicle No: **MP07A6966** (Goods Carrier) is certified as complying with the provisions of the Motor vehicles Act, 1988 and the rules made there under.

Registration No : MP07A6966
Application No : MP240528V5389453
Inspection Fee Receipt No : MP240528C2489384
Receipt Date : 28-May-2024
Chassis No : SPE257912
Engine No : SPE137263
Seating Capacity : 7 (Including Driver)
Type of Body : TIPPER
Manufacturing Year : 1991
Category of Vehicle : HGV
Inspected on : 30-May-2024

Certificate will expire on : 14-Jun-2025
Next Inspection Due : 16-Apr-2025
Date

Printed on : 03-Jun-2024 15:10:41

Inspected by (ANKIT UPADHYAY)

Signature of Inspecting Authority
TIKAMGARH DTO
(म.प्र.)



ISSUED BY MADHYA PRADESH

State Transport Department

TIKAMGARH DTO

FORM 38

[See Rule 62(1)]

CERTIFICATE OF FITNESS

(Applicable in the case of transport vehicles only)

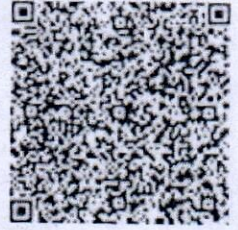

Vehicle No: MP07N3128(Goods Carrier) is certified as complying with the provisions of the Motor vehicles Act, 1988 and the rules made there under.

Registration No : MP07N3128
Application No : MP240522V9719601
Inspection Fee Receipt No : MP240522C0043460
Receipt Date : 22-May-2024
Chassis No : ALEN236167
Engine No : ALEN113274
Seating Capacity : 6 (Including Driver)
Type of Body : OPEN BODY
Manufacturing Year : 1989
Category of Vehicle : HGV
Inspected on : 22-May-2024

Certificate will expire on : 12-Jun-2025

Next Inspection Due : 14-Apr-2025

Date

Printed on : 03-Jun-2024 15:10:41

Inspected by (ANKIT UPADHYAY)

Signature of Inspecting Authority

TIKAMGARH DTO

टीकमगढ़ (म.प्र.)